

PRELIMINARY PLAT

BUFFALO FARMS

SUBDIVISION DATA:
GROSS SUBDIVISION AREA: 120.42 ACRES
CURRENT ZONING: RUC-194 LOTS: 1
NUMBER OF COMMERCIAL LOTS: 1
NUMBER OF RESIDENTIAL LOTS: 1
NUMBER OF SINGLE FAMILY LOTS: 478
GROSS COMMON AREA: 11.83 ACRES

DEVELOPER:
BUFFALO DEVELOPMENT GROUP, LLC
YUKON, OK 73099

DRAWN BY:
GRUBBS CONSULTING, LLC
YUKON, OKLAHOMA 73099
(405) 285-0641

BEING A PART OF THE NORTHWEST QUARTER (NW 1/4) OF SECTION EIGHTEN (18), TOWNSHIP ELEVEN (11) NORTH, RANGE FOUR (4) WEST OF THE INDIAN MERIDIAN, OKLAHOMA CITY, OKLAHOMA COUNTY, OKLAHOMA

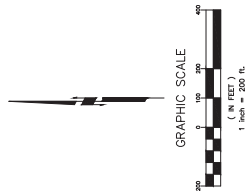
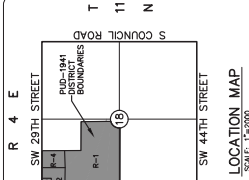

LEGEND	
B/A	BUILDING LINE
U/E	PUBLIC UTILITY EASEMENT
P/E	PROPOSED EASEMENT
R/W	RIGHT OF WAY
A/E	ASPHALT EASEMENT
C/A	COMMON AREA

- PLAT NOTES:
1. MAINTENANCE OF COMMON AREAS IS THE RESPONSIBILITY OF THE PROPERTY OWNERS ASSOCIATION.
 2. A SIDEWALK IS REQUIRED IN EACH LOT WHERE THE LOT AREA IS GREATER THAN 10,000 SQ. FT. SIDEWALKS SHALL BE CONSTRUCTED OF CONCRETE OR ASPHALT AND SHALL BE OCCUPANCY FOR THE AFFECTED LOT.

GRUBBS CONSULTING, LLC
CIVIL ENGINEERING & LAND PLANNING
YUKON, OK 73099
PHONE: (405) 285-0641
FAX: (405) 285-0649
GRUBBS CONSULTING, LLC CERTIFICATE OF AUTHORIZATION NO. CA 5115 EXP. 06/30/24

