

**A RESOLUTION OF THE PLANNING COMMISSION OF THE CITY OF OKLAHOMA CITY AMENDING THE COMPREHENSIVE PLAN, REMOVING THE AGRICULTURAL PRESERVE LAND USE TYPOLOGY AREA LAYER AND CHANGING THE BASE LAND USE TYPOLOGY AREA DESIGNATION FROM RURAL-LOW INTENSITY TO RURAL-MEDIUM INTENSITY ON AN APPROXIMATELY 15.57-ACRE TRACT LOCATED WEST OF S. CIMARRON ROAD AND NORTH OF SW 15<sup>th</sup> ST.**

**WHEREAS**, Oklahoma Statutes, Title 11, § 47-101 *et seq.*, provides that the Planning Commission of the City of Oklahoma City may adopt and amend a Comprehensive Plan to guide the development of the city, including policies for guiding development within specified areas of the City; and

**WHEREAS**, on July 9, 2015, the Oklahoma City Planning Commission adopted planokc as the Comprehensive Plan of the City of Oklahoma City and amended the plan on December 14, 2017 and on October 22, 2020; and

**WHEREAS**, on July 21, 2015, the City Council adopted planokc as the Comprehensive Plan of the City of Oklahoma City and received amendments to the plan on January 11, 2018 and on January 19, 2021; and

**WHEREAS**, planokc provides long range policy direction for land use, transportation, economic development, housing, public services, and natural and cultural resources; and

**WHEREAS**, planokc's Land Use Plan identifies the appropriate intensity of development for each part of the city, and identifies areas designated for the provision of urban services, concentrations of commercial, industrial and employment uses, and preservation of rural and natural areas through the use of Land Use Typology Areas (LUTAs); and

**WHEREAS**, planokc provides instructions for individuals who wish to request an amendment to the Land Use Typology Areas map or policies within the plan as conditions in an area change; and

**WHEREAS**, an application, concerning an area located west of S. Cimarron Road and north of SW 15th St., was received requesting the removal of the Agricultural Preserve LUTA layer and changing the base LUTA designation from Rural-Low Intensity to Rural-Medium Intensity; and

**WHEREAS**, the purposes of the Agricultural Preserve layer are to maintain large scale acreages used primarily for agricultural purposes and to appropriately designate and preserve large areas of floodplain, consistent with planokc's intent to avoid developing within or modification of 100 year floodplains; and

**WHEREAS**, the Rural-Medium Intensity designation allows for large-lot residential at higher density (2-acres or more) than Rural-Low Intensity; and

## Attachment 1

### Map of Amendment Area

**Case Number:** CPA-2023-00001

**Location:** West of S. Cimarron Road and north of SW 15th St.

**Size:** 15.57 acres +/-

**Amendment:** Remove the Agricultural Preserve Land Use Typology Area (LUTA) layer and change the base LUTA designation from Rural-Low Intensity to Rural-Medium Intensity.

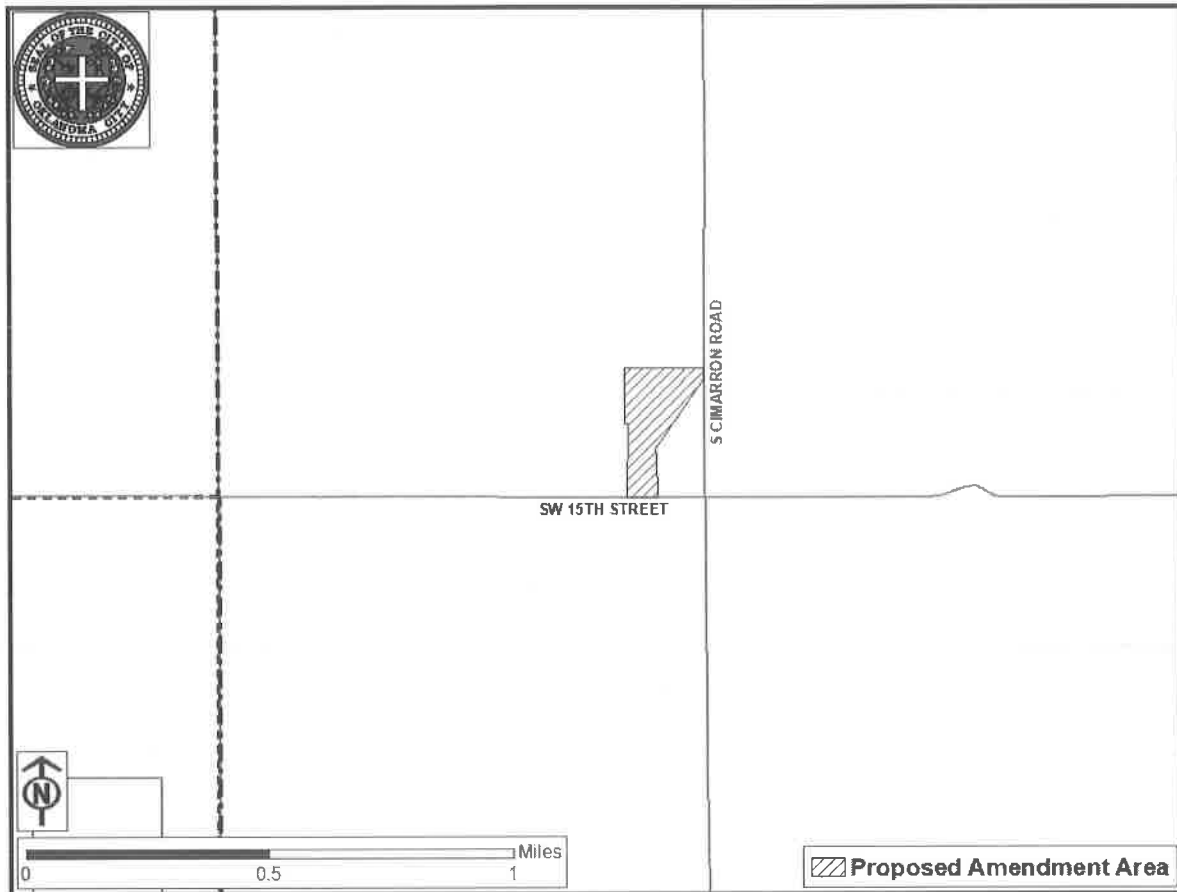

**WHEREAS**, on February 23, 2023, the Planning Commission considered a request to amend the Comprehensive Plan map and found that the request to remove the Agricultural Preserve Land Use Typology Area layer and change the Rural-Low Intensity base LUTA designation to Rural-Medium Intensity on the subject site was appropriate.

**NOW, THEREFORE BE IT RESOLVED**, that the Planning Commission of The City of Oklahoma City does hereby amend the Comprehensive Plan, removing the Agricultural Preserve Land Use Typology Area layer and changing the base Land Use Typology Area designation from Rural-Low Intensity to Rural-Medium Intensity on an approximately 15.57-acre tract located west of S. Cimarron Road and north of SW 15th St. as shown in Attachment 1.

**ADOPTED** by the Planning Commission of the City of Oklahoma City on this 9<sup>th</sup> day of March, 2023.

ATTEST:

Secretary

Chairperson

**APPROVED** as to form and legality.

Assistant Municipal Counsel

