



The City of Oklahoma City
Planning Department, Subdivision and Zoning
420 West Main Street, Suite 910, Oklahoma City, Oklahoma, 73102
Phone: (405) 297-2623 – Web: <https://www.okc.gov>

APPLICATION FOR SPUD ReZONING

Simplified Planned Unit Development District
Community Health Centers of Oklahoma

Project Name

5301 S Dimple Ave Dr

Address / Location of Property (Provide County name & parcel no. if unknown)

Staff Use Only:	1455
Case No.: SPUD	
File Date:	25Aug'22
Ward No.:	4
Nbhd. Assoc.:	Highland Park HOA
School District:	Mid Del
Extg Zoning:	R-1
Overlay:	

11.29 acres

ReZoning Area (Acres or Square Feet)

Changing zoning from School (R-1) to (SPUD) to allow the use of a Community Health Center

Summary Purpose Statement / Proposed Development

REQUIREMENTS FOR SUBMITTAL:

- ☐ 1.) One (1) Typed Legal Description of Proposed Rezoning area in MS Word file (.doc or .docx) format.
- ☐ 2.) One (1) copy of Recorded Deed(s), with Exhibit(s), listing current Property Owner in .pdf format.
- ☐ 3.) One (1) copy of Letter of Authorization from Property Owner listing Designated Representative if Applicant is not the Property Owner of record.
- ☐ 4.) One (1) copy of Property Owners Report listing all property owners who own property within a 300-foot buffer area of the property to be rezoned. The list **MUST** include the mailing address and the legal description of their property and **MUST** be current to within 30 days of the date of submittal of the application. A minimum of 10 separate individual property owners is required. If there are less than 10 individual owners within the 300-foot buffer, the radius must be extended by increments of 100 feet until the list contains no less than 10 owners. Provide One (1) PDF (.pdf) file version, AND one (1) MS Excel (.xls or .xlsx) file version.
- ☐ 5.) One (1) Signed and Notarized copy of "Affirmation" that the Property Owners Report listings are true and correct unless the list is prepared by a Certified Abstractor or County official.
- ☐ 6.) One (1) Typed Prepared copy of Proposed Master Design Statement in an MS Word file (.doc or .docx) file format.
- ☐ 7.) One (1) Proposed Master Development Plan Map in a PDF (.pdf) file format. Reference Submittal checklist for specific details.
- ☐ 8.) Maps, Site Plan, Survey Exhibits, Photographs, or other supporting illustrations must be 600dpi minimum resolution, and in a .pdf file format. Photographic file formats (.jpeg, .png, .tiff, etc..) of drawings, maps, or other documents will not be accepted.
- ☐ 9.) A filing fee of **\$1800.00** must be remitted within One (1) business day of submittal confirmation. (Online payment available / preferred.) (Make check payable to "City Treasurer")

Property Owner Information (if other than Applicant):

Midwest City-Del City Public Schools

Name

7217 SE 15th

Mailing Address

Midwest City, OK 73130

City, State, Zip Code

405-737-4461

Phone

rcobb@mid-del.net

Email

Signature of Applicant

Community Health Centers of Oklahoma

Applicant's Name (please print)

P.O. Box 30589

Applicant's Mailing Address

Oklahoma City, OK

City, State, Zip Code

405-924-9495

Phone

jpettis@communityhealthok.org

Email

Submit your Application by Email to Subdivisionandzoning@OKC.gov

Compressed files (.zip, etc..) or links to FileShare services (Dropbox, etc..) can not be accepted for security purposes.

Legal Description

UNPLTD PT SEC 19 11N 2W 000 000 PT SE4 SEC 19 11N 2W BEG 660FT W OF NE/C OF
SE4 S600FT W820FT N600FT E TO BEG CONT 11ACRS MORE OR LESS EXEMPT

BOOK 3816 PAGE 450

WARRANTY DEED

Corporation Form

Know All Men by These Presents:

That The Great Midwest Corporation an Oklahoma Corp.

a corporation duly organized and existing under and by virtue of the laws of the State of Oklahoma, whose

principal place of business is in Oklahoma

County, State of Oklahoma, party of the first part, in consideration of the

sum of Ten and No/100----- DOLLARS (\$ 10.00)

and other valuable considerations, in hand paid, the receipt of which is hereby acknowledged, does hereby Grant,

Bargain, sell and Convey unto Independent School District Number 52

of Oklahoma County, State of Oklahoma, part

of the second part, the following described real property and premises situate in Oklahoma

County, State of Oklahoma, to-wit:

A Parcel of Land lying and being in the City of Oklahoma City, County Of Oklahoma State of Oklahoma; more particularly described as being in the N $\frac{1}{2}$, SE $\frac{1}{2}$, Section 19, T11N, R2W, described as follows:

Beginning at the NE corner of the W $\frac{1}{2}$, NE $\frac{1}{2}$, SE $\frac{1}{2}$, Section 19, T11N, R2W, Thence S 0° 00' 14" W a distance of 600.0 Feet; thence N 89° 56' 00" W a distance of 820.0 Feet; thence N 0° 00' 14" E a distance of 600.0 Feet; thence S 89° 56' 00" E a distance of 820.0 Feet to the point of beginning.

Said parcel contains 11.062+ acres more or less.



together with all the improvements thereon and appurtenances thereunto belonging and warrant the title to the same.

TO HAVE AND TO HOLD said described premises unto the said party of the second part, their heirs and assigns forever free, clear and discharged of and from all former grants, charges, taxes, judgments, mortgages and other liens and encumbrances of whatsoever nature.

IN WITNESS WHEREOF, the said party of the first part hereto has caused these presents to be signed in its name

by its President, its corporate seal affixed, and attested by its Secretary at Oklahoma City,

Oklahoma, this 11th day of March, 19 69

THE GREAT MIDWEST CORPORATION

President

Attest: B.L. Katzene Secretary

STATE OF OKLAHOMA

COUNTY OF Oklahoma

SS:

CORPORATION ACKNOWLEDGMENT
Oklahoma Form

Before me, the undersigned, a Notary Public, in and for said County and State on this 11th day of

March, 19 69, personally appeared James C. Ray

to me known to be the identical person who subscribed the name of the maker thereof to the foregoing instrument as its

President and acknowledged to me that he executed the same as his free and voluntary act and deed and as the free and voluntary act and deed of such corporation, for the uses and purposes therein set forth.

Given under my hand and seal of office the day and year last above written.

My Commission expires October 28, 1971

Notary Public



LETTER OF AUTHORIZATION

The undersigned property owner hereby acknowledges that Ms. Isabella Lawson is a designated representative and able to act on my behalf in all manners relating to my application for municipal approvals and do all things necessary for the advancement of such application with respect to the property at the following location 5301 S. Dimple Drive, in Oklahoma City, Oklahoma effective March 4th, 2022. My signature below indicates my acknowledgment that I have read the foregoing, or that it has been read to me, and that I understand and do not object to Ms. Isabella Lawson applying on my behalf and receiving municipal approval under my name from the City of Oklahoma City at the above referenced property, which I own.

I understand that for municipal approval to be given an agreement between the City of Oklahoma City and I, which outlines the rules, regulations, and ordinances of the Zoning Department, is to be submitted signed and notarized along with this Letter of Authorization.

Midwest City - Del City Public Schools
Property Owner, Printed Name

405-737-4461

Property Owner, Telephone

7217 SE 15th St.
Property Owner, Street Address

rcobb@mid-del.net
Property Owner, Email Address

Midwest City, OK 73130
Property Owner, City State Zip

[Signature]
Property Owner, Signature

8/5/22

Date

State of Oklahoma
County of
Oklahoma

The foregoing instrument was acknowledged before me this 5th day of August, 2022,
by Richard Cobb who is personally known to me or who has produced a
_____ as identification, and ☒ who did (☐ did not) take an oath.

[Signature]
Notary Public, Signature





GREAT News!
Annual Oklahoma Tax Commission audit
findings reveal accurate assessments

[Read more](#)

Larry Stein Oklahoma County Assessor (405) 713-1200 - Public Access System

Home	Contact Us	Guest Book	Map Search	New Search				
Real Property Display - Screen Produced 8/25/2022 6:05:39 AM								
Account: R143851870		Type: Exempt	bing maps	Location: 5301 S DIMPLE DR				
Building Name/Occupant: HIGHLAND PARK ELEMENTRY SCHOOL		Map Parcel		OKLAHOMA CITY				
Owner Name 1: INDEPENDENT SD 52		1/4 section #: 1474						
Owner Name 2:		Parent Acct:						
Owner Name 3:		Tax District: TXD 252						
Billing Address: 0		School System: Mid-Del #52						
City, State, Zip: , 00000		Land Size: 11.29 Acres						
Country: (If noted)		Lot Dimensions: Width Depth						
Personal Property		Land Value: 0		Treasurer: Click to View Taxes				
Sect 19-T11N-R2W Qtr SE UNPLTD PT SEC 19 11N 2W Block 000 Lot 000		Subdivision Sales						
Full Legal Description: UNPLTD PT SEC 19 11N 2W 000 000 PT SE4 SEC 19 11N 2W BEG 660FT W OF NE/C OF SE4 S600FT W820FT N600FT E TO BEG CONT 11ACRS MORE OR LESS EXEMPT								
Photo & Sketch (if available)		Comp Sales Address/Date/Price Report Coming Soon						
		No comparable sales returned.						
Value History								
Year	Market Value	Taxable Mkt Value	Gross Assessed	Exemption	Net Assessed	Millage	Est. Tax	Tax Savings
2022	0	0	0	0	0	124.74	0.00	0.00
2021	0	0	0	0	0	124.74	0.00	0.00
2020	0	0	0	0	0	128.23	0.00	0.00
2019	0	0	0	0	0	124.82	0.00	0.00
2018	0	0	0	0	0	124.79	0.00	0.00
-- -- > > [1/5]								
Property Account Status/Adjustments/Exemptions								
Account #	Grant Year	Exemption Description			Amount			
R143851870	2018	Exempt			100			
R143851870	2000	5% Capped Account			0			
Property Deed Transaction History ()								
Date	Type	Book	Page	Price	Grantor	Grantee		
11/11/1911	>	Historical	0000	0000	0	INDEPENDENT SD 52		
Last Mailed Notice of Value (N.O.V.) Information/History								
Year	Date	Market Value	Taxable Market Value	Gross Assessed	Exemption	Net Assessed		
No Notice of Value N.O.V. records returned.								
Property Building Permit History								
Issued	Permit #	Provided by	Bldg #	Description	Est Construction Cost		Status	
11/12/2014	10467437	OKLAHOMA CITY	1	Remodeled	50,000		Inactive	
5/10/2012	10443050	OKLAHOMA CITY	1	Commercial	60,000		Inactive	
5/16/2002	10238198	OKLAHOMA CITY	1	Remodeled	225,000		Inactive	
7/3/2001	10238197	OKLAHOMA CITY	1	Other	162,000		Inactive	
6/3/1999	10238199	OKLAHOMA CITY	1	Remodeled	75,000		Inactive	
Click button on building number to access detailed information:								

	Bldg #	Vacant/Improved Land	Bldg Description	Year Built	SqFt	# Stories
	1	Improved	School - Elementary/Secondary	1977	1	1 Stories

08.19.2022

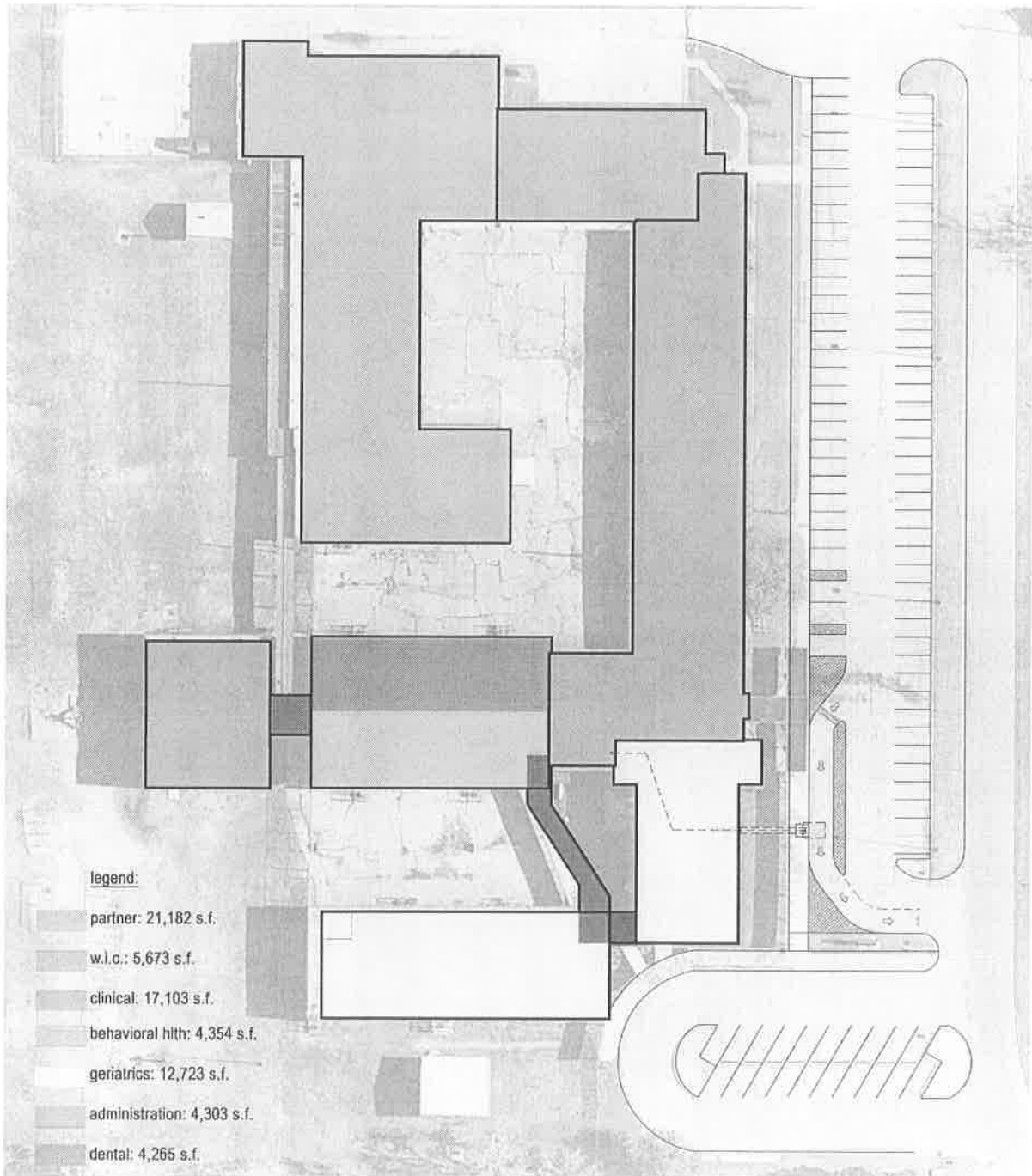

site plan
1"=50'-0"

1
N

C.H.C.I. Highland Park

MASS ARCHITECTS.
BIG IDEAS.

08.19.2022

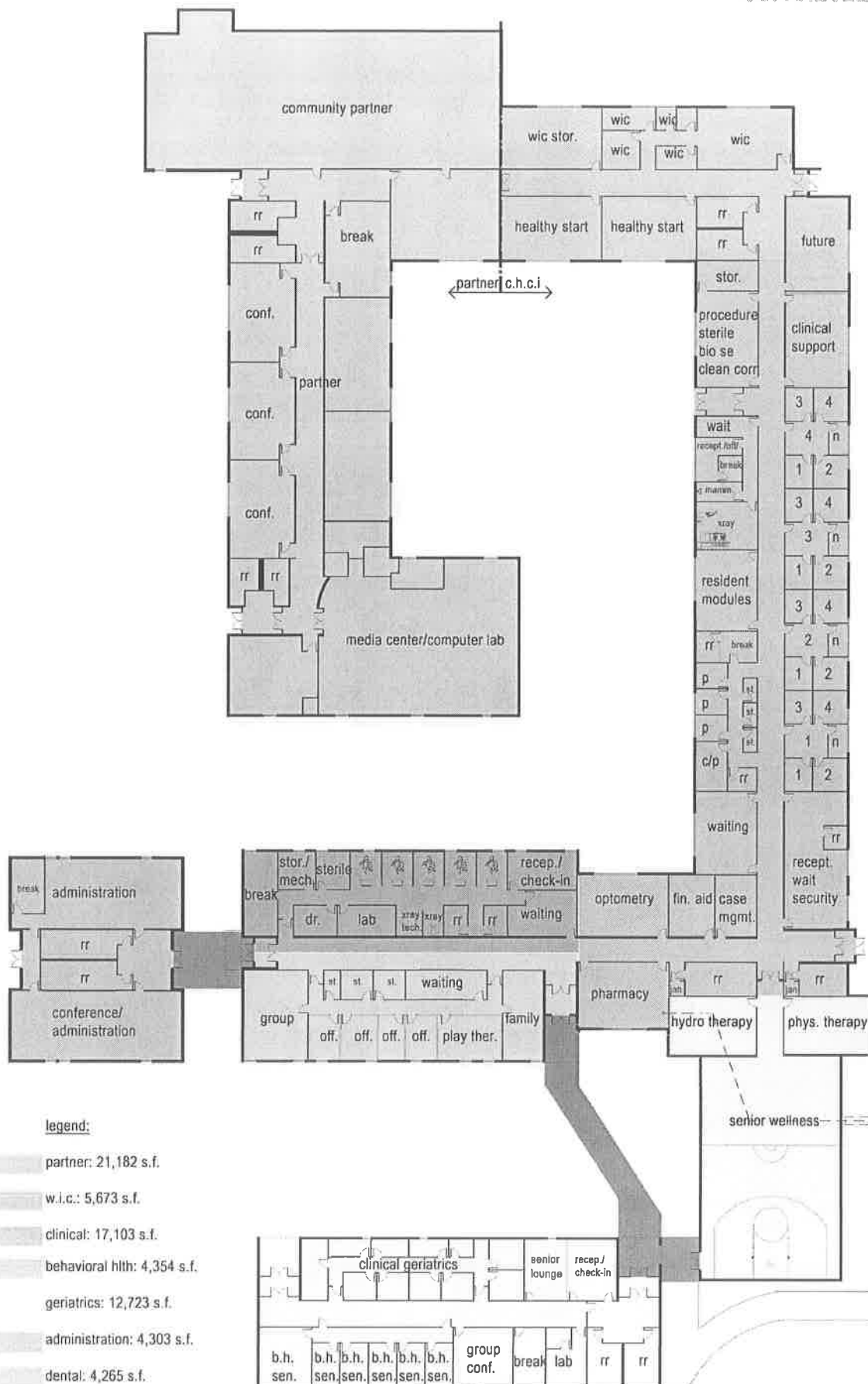

floor plan

1/32"=1'-0"



C.H.C.I. Highland Park

MASS ARCHITECTS.
BIG IDEAS.

THE CITY OF OKLAHOMA CITY
SIMPLIFIED PLANNED UNIT DEVELOPMENT
SPUD-(number)
MASTER DESIGN STATEMENT

August 25, 2022

PREPARED BY:

Community Health Centers of Oklahoma
Isabella Lawson and John A. Pettis, Jr.
12716 NE 36th St
Oklahoma City, OK 73084
405-924-9495
jpettis@communityhealthok.org

SPUD-(number) MASTER DESIGN STATEMENT

This document serves as the Master Design Statement and fulfills the ordinance requirements for the Simplified Planned Unit Development (Chapter 59, Section 14150.B of the Oklahoma City Municipal Code, 2020, as amended).

I. Special Development Regulations:

The following Special Development Regulations and/or limitations are placed upon the development of the Simplified Planned Unit Development. Planning and zoning regulations will be those that are in effect at the time of development of this Simplified Planned Unit Development; provided, however, that the density and or intensity of the SPUD shall not be increased. Development is when a permit is issued for any construction or addition to any structure on a development tract. Certain zoning districts are referred to as a part of the Special Development Regulations of this Simplified Planned Unit Development. For purposes of interpretation of these Special Development Regulations, the operative and controlling language and regulations of such zoning districts shall be the language and regulations applicable to the referenced zoning districts as contained in the City of Oklahoma City's Planning and Zoning Code as such exists at the time of development of this Simplified Planned Unit Development. In the event of conflict between provisions of this SPUD and any of the provisions of the Oklahoma City Municipal Code, as amended ("Code"), in effect at the time a permit is applied for with respect to any lot, block, tract and/or parcel of land subject to this SPUD, the provisions of the Code shall prevail and be controlling; provided however, that in the event of a conflict between the Special Use and Development Regulations specifically negotiated as a part of this SPUD and the provisions of the Code in effect at the time a permit is applied for with respect to any lot, block, tract and/or parcel of land subject to this SPUD, such Special Use and Development Regulations of this SPUD shall prevail and be controlling.

1. This site will be developed in accordance with the regulation of the **C-3 Community District** (OKC Zoning Ordinance, 2020, as amended), except that the following restrictions will apply:

The following use(s) will be the only use(s) permitted on this site:

Low Impact Institutional: Neighborhood Related (8250.14)
Administration and Professional Office (8300.1)
Moderate Impact Institutional (8250.15)
Child Care Center (8300.25)
Medical Services: General (8300.52)
Medical Services: Restricted (8300.53)
Library Services and Community Centers (8250.11)

2. **Maximum Building Height:**

No change from existing

3. Maximum Building Size:

73,000sqft

4. Maximum Number of Buildings:

No change from existing

5. Building Setback Lines

Front Yard: No change from existing

Rear Yard: No change from existing

Side Yard: No change from existing

Corner Side Yard: No change from existing

6. Sight-proof Screening:

No change from existing

7. Landscaping:

No change from existing

8. Signs:

8.1 Free standing accessory signs No change from existing

8.2 Attached signs No change from existing

8.3 Non-Accessory Signs No change from existing

8.4 Electronic Message Display signs No change from existing

9. Access: No change from existing

10. Sidewalks No change from existing

II. Other Development Regulations:

1. Architecture: No change from existing

2. **Open Space:** No change from existing
3. **Street Improvements:** No street improvements are required
4. **Site Lighting:** No change from existing
5. **Dumpsters:** No change from existing
6. **Parking:** No change from existing
7. **Maintenance:** No change from existing
8. **Drainage:** No change from existing
9. **Other:**

III. Supporting Documents

Exhibit A: Legal Description

Exhibit B: Site Plan

Larry Stein Oklahoma County Assessor's Office



Ownership Radius Report

This Non-Official Report is for Account Number R143851870 and is a 300-foot radius from the outside of the polygon. If the minimum number of different owners was not reached it was extended by 100-foot increments until the required number of different owners was reached, or the maximum distance was reached. This report does not constitute a legal survey or document, for definitive description of real property and ownership; consult the deeds recorded in the Oklahoma County Clerks Office. Official Record of this Certified Radius Report will expire 30 days from the date of creation stamped on the back of this sheet.

STATE OF OKLAHOMA } ss:
COUNTY OF OKLA

I, the duly elected, qualified and acting
County Assessor, in and for the County
and State aforesaid, do hereby certify that
the within and foregoing is a full, true and
complete copy of 300 ft Radius Right
filed in the office of the County Assessor
on the 23 day of Aug, 20 22
Given under my hand and official seal this
23 day of Aug, 20 22
County Assessor
Deputy

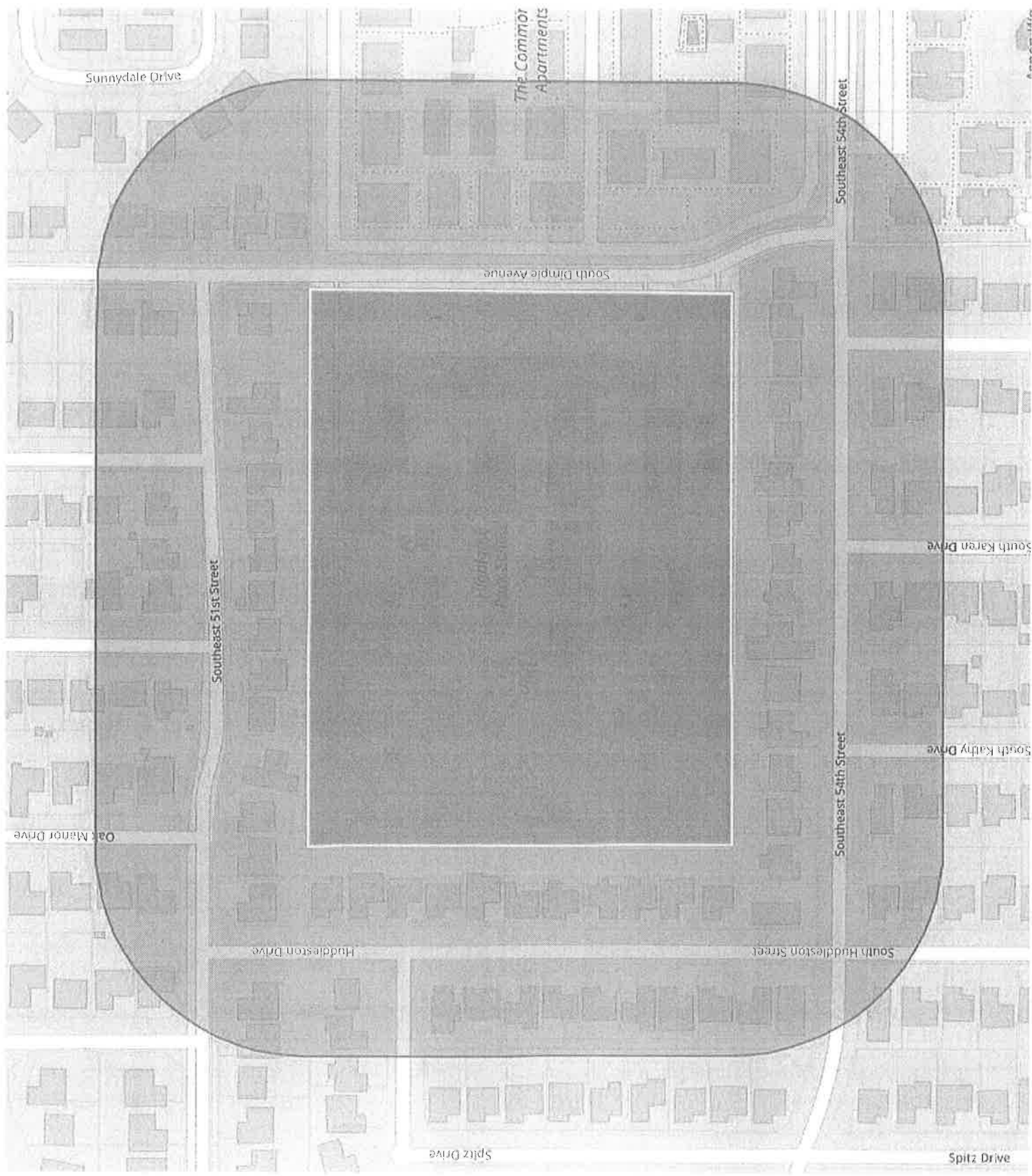

Oklahoma County Assessor's
300ft Radius Report
8/23/2022

accountno	name1	name2	mailingaddress1	city	state	zipcode	subname	block	lot	legal	location
R14990110	WILSON RICKY F & SHARON K		PO BOX 987	SAPULPA	OK	74067	MIDWEST HEIGHTS REPLAT	002	003	MIDWEST HEIGHTS REPLAT 002 003	5509 S KATHY DR OKLAHOMA CITY
R148631150	MENDOZA ERNESTO		5508 S HUDDLESTON DR	OKLAHOMA CITY	OK	73135-2324	MIDWEST HGTS SEC 2 REPLAT	006	003	MIDWEST HGTS SEC 2 006 003 003	5508 S HUDDLESTON DR OKLAHOMA CITY
R149901420	HOPKINS MARGARET A		5508 S KATHY DR	OKLAHOMA CITY	OK	73135-2328	MIDWEST HEIGHTS REPLAT	003	003	MIDWEST HEIGHTS REPLAT 003 003	5508 S KATHY DR OKLAHOMA CITY
R149901490	WARD WINZELLA		5509 S KAREN ST	OKLAHOMA CITY	OK	73135-2325	MIDWEST HEIGHTS REPLAT	003	010	MIDWEST HEIGHTS REPLAT 003 010	5509 S KAREN ST OKLAHOMA CITY
R149901280	VAN SINGEL DAVID A		2633 NW 16TH CT	EDMOND	OK	73012	MIDWEST HEIGHTS REPLAT	002	020	MIDWEST HEIGHTS REPLAT 002 020	5508 S KAREN ST OKLAHOMA CITY
R149901020	MOSS INA ROSHAWN		5508 S DIMPLE DR	OKLAHOMA CITY	OK	73135-2302	MIDWEST HEIGHTS REPLAT	001	003	MIDWEST HEIGHTS REPLAT 001 003	5508 S DIMPLE DR OKLAHOMA CITY
R149901100	VENABLE DONALD G TRS	VENABLE DONALD G REV LIV TRUST	11513 QUEENSBURY CT	YUKON	OK	73099	MIDWEST HEIGHTS REPLAT	002	002	MIDWEST HEIGHTS REPLAT 002 002	5505 S KATHY DR OKLAHOMA CITY
R148631140	CREAGER RHONDA M		5504 S HUDDLESTON DR	OKLAHOMA CITY	OK	73135-2324	MIDWEST HGTS SEC 2 REPLAT	006	002	MIDWEST HGTS SEC 2 006 002 002	5504 S HUDDLESTON DR OKLAHOMA CITY
R149901410	HALTOM DOUGLAS L		2002 CECIL ST	WAYNOKA	OK	73860-1273	MIDWEST HEIGHTS REPLAT	003	002	MIDWEST HEIGHTS REPLAT 003 002	5504 S KATHY DR OKLAHOMA CITY
R149901500	DENNY MICHAEL F TRS	DENNY MICHAEL F REVOCABLE TRUST	400 COUNTRY LN	MIDWEST CITY	OK	73130-6830	MIDWEST HEIGHTS REPLAT	003	011	MIDWEST HEIGHTS REPLAT 003 011	5505 S KAREN ST OKLAHOMA CITY
R148631230	COLEMAN EIKO K		5505 S HUDDLESTON DR	OKLAHOMA CITY	OK	73135-2323	MIDWEST HGTS SEC 2 REPLAT	007	002	MIDWEST HGTS SEC 2 007 002 002	5505 S HUDDLESTON DR OKLAHOMA CITY
R149901290	TAPLEY PEGGY SUE		5504 S KAREN ST	OKLAHOMA CITY	OK	73135-2326	MIDWEST HEIGHTS REPLAT	002	021	MIDWEST HEIGHTS REPLAT 002 021	5504 S KAREN ST OKLAHOMA CITY
R149901320	GAINEY COLLETTE L		5505 S DIMPLE DR	OKLAHOMA CITY	OK	73135-2301	MIDWEST HEIGHTS REPLAT	002	024	MIDWEST HEIGHTS REPLAT 002 024	5505 S DIMPLE DR OKLAHOMA CITY
R149901010	CHEERS MATTHEW		3200 GLENHAVEN DR	MIDWEST CITY	OK	73110	MIDWEST HEIGHTS REPLAT	001	002	MIDWEST HEIGHTS REPLAT 001 002	5504 S DIMPLE DR OKLAHOMA CITY
R148631130	MIDDLETON LENZIE		5508 S HUDDLESTON DR	OKLAHOMA CITY	OK	73135	MIDWEST HGTS SEC 2 REPLAT	006	001	MIDWEST HGTS SEC 2 006 001 001	5508 S HUDDLESTON DR OKLAHOMA CITY
R149901090	SIMS JOHN G & TINA K		5501 S KATHY DR	OKLAHOMA CITY	OK	73135-2327	MIDWEST HEIGHTS REPLAT	002	001	MIDWEST HEIGHTS REPLAT 002 001	5501 S KATHY DR OKLAHOMA CITY
R149901400	EDWARDS TIMOTHY H & HOLLY		5500 S KATHY DR	OKLAHOMA CITY	OK	73135-2328	MIDWEST HEIGHTS REPLAT	003	001	MIDWEST HEIGHTS REPLAT 003 001	5500 S KATHY DR OKLAHOMA CITY
R149901510	NELSON SHARLET		5501 S KAREN ST	OKLAHOMA CITY	OK	73135	MIDWEST HEIGHTS REPLAT	003	012	MIDWEST HEIGHTS REPLAT 003 012	5501 S KAREN ST OKLAHOMA CITY
R149901300	WOODRUM STEPHEN P JR		5500 S KAREN ST	OKLAHOMA CITY	OK	73135-2326	MIDWEST HEIGHTS REPLAT	002	022	MIDWEST HEIGHTS REPLAT 002 022	5500 S KAREN ST OKLAHOMA CITY
R149901310	C A O PROPERTIES LLC		2800 SW 135TH ST	OKLAHOMA CITY	OK	73170-5139	MIDWEST HEIGHTS REPLAT	002	023	MIDWEST HEIGHTS REPLAT 002 023	5501 S DIMPLE DR OKLAHOMA CITY
R149901000	GRIFFITH JANICE L		4200 SE 54TH ST	DEL CITY	OK	73135-2416	MIDWEST HEIGHTS REPLAT	001	001	MIDWEST HEIGHTS REPLAT 001 001	4200 SE 54TH ST OKLAHOMA CITY
R148631220	NGUYEN TOMI		5017 SE 58TH PL	DEL CITY	OK	73135-4414	MIDWEST HGTS SEC 2 REPLAT	007	001	MIDWEST HGTS SEC 2 007 001 001	5501 S HUDDLESTON DR OKLAHOMA CITY
R142541630	5537 SP LLC		68 JAY ST, Unit 201	BROOKLYN	NY	11201	MIDWEST HEIGHTS REPLAT	008	000	MIDWEST HEIGHTS 008 000 000 000	5537 S SUNNYLANE RD OKLAHOMA CITY
R148631590	HENKE TAMMY A		5425 S HUDDLESTON DR	OKLAHOMA CITY	OK	73135-2321	MIDWEST HGTS SEC 2 REPLAT	009	010	MIDWEST HGTS SEC 2 009 010 010	3841 SE 54TH ST OKLAHOMA CITY
R148631600	WIDFIELD NANCY A		5420 SPITZ DR	OKLAHOMA CITY	OK	73135-2344	MIDWEST HGTS SEC 2 REPLAT	009	011	MIDWEST HGTS SEC 2 009 011 011	5420 SPITZ DR OKLAHOMA CITY
R148631580	CRAVENS BARBARA M		3512 SAN LEON CT	DEL CITY	OK	73115-1748	MIDWEST HGTS SEC 2 REPLAT	009	009	MIDWEST HGTS SEC 2 009 009 009	5421 S HUDDLESTON DR OKLAHOMA CITY

Oklahoma County Assessor's
300ft Radius Report
8/23/2022

R148631110	WEST DAWNIELLE ADRIAWN		4009 SE 54TH ST	OKLAHOMA CITY	OK	73135	MIDWEST HGTS SEC 2	005	012	MIDWEST HGTS SEC 2 005	5420 S HUDDLESTON DR OKLAHOMA CITY
R148631120	MULL PROPERTIES LLC		7201 N CLASSEN BLVD STE 100	OKLAHOMA CITY	OK	73116-7133	MIDWEST HGTS SEC 2	005	013	MIDWEST HGTS SEC 2 005	3905 SE 54TH ST OKLAHOMA CITY
R149901650	CHEEK DONALD LEON		3909 SE 54TH ST	OKLAHOMA CITY	OK	73135-2307	MIDWEST HEIGHTS REPLAT	004	014	MIDWEST HEIGHTS REPLAT 004 014	3909 SE 54TH ST OKLAHOMA CITY
R149901640	HODGE DEIDRA		3913 SE 54TH ST	OKLAHOMA CITY	OK	73135-2307	MIDWEST HEIGHTS REPLAT	004	013	MIDWEST HEIGHTS REPLAT 004 013	3913 SE 54TH ST OKLAHOMA CITY
R149901630	HOOKS ROSALINN		4001 SE 54TH ST	DEL CITY	OK	73135-2309	MIDWEST HEIGHTS REPLAT	004	012	MIDWEST HEIGHTS REPLAT 004 012	4001 SE 54TH ST OKLAHOMA CITY
R149901620	DEAN JACKIE L JR		4005 SE 54TH ST	DEL CITY	OK	73135-2309	MIDWEST HEIGHTS REPLAT	004	011	MIDWEST HEIGHTS REPLAT 004 011	4005 SE 54TH ST OKLAHOMA CITY
R149901610	WEST DAWNIELLE		4009 SE 54TH ST	OKLAHOMA CITY	OK	73135	MIDWEST HEIGHTS REPLAT	004	010	MIDWEST HEIGHTS REPLAT 004 010	4009 SE 54TH ST OKLAHOMA CITY
R149901600	LARSON JESSICA L		4013 SE 54TH ST	DEL CITY	OK	73135	MIDWEST HEIGHTS REPLAT	004	009	MIDWEST HEIGHTS REPLAT 004 009	4013 SE 54TH ST OKLAHOMA CITY
R149901590	MASTIN LUCINDA GAIL		4017 SE 54TH ST	DEL CITY	OK	73135-2309	MIDWEST HEIGHTS REPLAT	004	008	MIDWEST HEIGHTS REPLAT 004 008	4017 SE 54TH ST OKLAHOMA CITY
R149901580	HENRY BOBBY L & JOYCE C		4101 SE 54TH ST	DEL CITY	OK	73135-2311	MIDWEST HEIGHTS REPLAT	004	007	MIDWEST HEIGHTS REPLAT 004 007	4101 SE 54TH ST OKLAHOMA CITY
R149901570	FIREFLY INVESTMENTS LLC		2805 SW 91ST ST	OKLAHOMA CITY	OK	73159	MIDWEST HEIGHTS REPLAT	004	006	MIDWEST HEIGHTS REPLAT 004 006	4105 SE 54TH ST OKLAHOMA CITY
R149901560	SQUARE 1 ENTERPRISES INC		PO BOX 5585	EDMOND	OK	73083	MIDWEST HEIGHTS REPLAT	004	005	MIDWEST HEIGHTS REPLAT 004 005	4109 SE 54TH ST OKLAHOMA CITY
R149901550	KNYSH OLENA		4113 SE 54TH ST	OKLAHOMA CITY	OK	73135	MIDWEST HEIGHTS REPLAT	004	004	MIDWEST HEIGHTS REPLAT 004 004	4113 SE 54TH ST OKLAHOMA CITY
R149901540	BAKER RONALD A & FRANCINE		4117 SE 54TH ST	DEL CITY	OK	73135-2311	MIDWEST HEIGHTS REPLAT	004	003	MIDWEST HEIGHTS REPLAT 004 003	4117 SE 54TH ST OKLAHOMA CITY
R149901530	MCNEIL MARIA		4121 SE 54TH ST	DEL CITY	OK	73135-2311	MIDWEST HEIGHTS REPLAT	004	002	MIDWEST HEIGHTS REPLAT 004 002	4121 SE 54TH ST OKLAHOMA CITY
R149901520	LOGAN VICTORIA L		4125 SE 54TH ST	DEL CITY	OK	73135-2311	MIDWEST HEIGHTS REPLAT	004	001	MIDWEST HEIGHTS REPLAT 004 001	4125 SE 54TH ST OKLAHOMA CITY
R148631610	GAUTT KATRINA		5416 SPITZ DR	OKLAHOMA CITY	OK	73135-2344	MIDWEST HGTS SEC 2	009	012	MIDWEST HGTS SEC 2 009	5416 SPITZ DR OKLAHOMA CITY
R148631570	CAMPBELL RANDOLPH		5417 S HUDDLESTON DR	OKLAHOMA CITY	OK	73135-2321	MIDWEST HGTS SEC 2	005	008	MIDWEST HGTS SEC 2 005	5417 S HUDDLESTON DR OKLAHOMA CITY
R148631100	PRINCE BENNIE C & MONICA M		5416 S HUDDLESTON DR	OKLAHOMA CITY	OK	73135-2322	MIDWEST HGTS SEC 2	005	011	MIDWEST HGTS SEC 2 005	5416 S HUDDLESTON DR OKLAHOMA CITY
R148631620	BRADSHAW CHUN CHA UV TRUST	BRADSHAW CHUN CHA UV TRUST	5412 SPITZ DR	OKLAHOMA CITY	OK	73135-2344	MIDWEST HGTS SEC 2	009	013	MIDWEST HGTS SEC 2 009	5412 SPITZ DR OKLAHOMA CITY
R148631090	WOODS BRANDI		5412 S HUDDLESTON DR	OKLAHOMA CITY	OK	73135-2322	MIDWEST HGTS SEC 2	005	010	MIDWEST HGTS SEC 2 005	5412 S HUDDLESTON DR OKLAHOMA CITY
R148631560	NGUYEN NICHOLAS N & LOAN THI REV LIV TRUST		6315 SE 160TH ST	OKLAHOMA CITY	OK	73165	MIDWEST HGTS SEC 2	009	007	MIDWEST HGTS SEC 2 009	5413 S HUDDLESTON DR OKLAHOMA CITY
R148631630	FRENCH CHARLES R & DEBORAH T		5408 SPITZ DR	OKLAHOMA CITY	OK	73135-2344	MIDWEST HGTS SEC 2	009	014	MIDWEST HGTS SEC 2 009	5408 SPITZ DR OKLAHOMA CITY
R148631080	RILEY ROBERT & PATRICIA D		5408 S HUDDLESTON DR	OKLAHOMA CITY	OK	73135-2322	MIDWEST HGTS SEC 2	005	009	MIDWEST HGTS SEC 2 005	5408 S HUDDLESTON DR OKLAHOMA CITY
R148631550	MID DEL PROPERTIES 2 LLC		909 JET DR	MIDWEST CITY	OK	73110-2761	MIDWEST HGTS SEC 2	009	006	MIDWEST HGTS SEC 2 009	5409 S HUDDLESTON DR OKLAHOMA CITY
R148631640	HOUSTON SHERRI PAULIN		5404 SPITZ DR	OKLAHOMA CITY	OK	73135-2344	MIDWEST HGTS SEC 2	009	015	MIDWEST HGTS SEC 2 009	5404 SPITZ DR OKLAHOMA CITY

Oklahoma County Assessor's
300ft Radius Report
8/23/2022

R148631070	FARROW SANDRA K	SWALLWOOD ISAAC V SR	1907 N PIATT AVE	WICHITA	KS	67214-1831	MIDWEST HGTS SEC 2	005	008	MIDWEST HGTS SEC 2 005	5404 S HUDDLESTON DR OKLAHOMA CITY
R148631540	CASSIL DANNY R	COLDIRON MARK D	12800 SAINT ANDREWS DR	OKLAHOMA CITY	OK	73120-8815	MIDWEST HGTS SEC 2	009	005	MIDWEST HGTS SEC 2 009	5405 S HUDDLESTON DR OKLAHOMA CITY
R148631650	LOGAN ANTHONY L		5400 SPITZ DR	OKLAHOMA CITY	OK	73135-2344	MIDWEST HGTS SEC 2	009	016	MIDWEST HGTS SEC 2 009	5400 SPITZ DR OKLAHOMA CITY
R148631060	BARBEE RONNIE & REBECCA		951 SWITCHGRASS WAY	NEWCASTLE	OK	73065	MIDWEST HGTS SEC 2	005	007	MIDWEST HGTS SEC 2 005	5400 S HUDDLESTON DR OKLAHOMA CITY
R148631530	PRAIRIE PROPERTY SOLUTIONS LLC		PO BOX 515	OKLAHOMA CITY	OK	73101	MIDWEST HGTS SEC 2	009	004	MIDWEST HGTS SEC 2 009	5401 S HUDDLESTON DR OKLAHOMA CITY
R148631660	GUNTER LLOYD L II & SUNG S		5316 SPITZ DR	OKLAHOMA CITY	OK	73135-2346	MIDWEST HGTS SEC 2	009	017	MIDWEST HGTS SEC 2 009	5316 SPITZ DR OKLAHOMA CITY
R148631050	DANG MICHELLE		4300 SE 16TH ST	DEL CITY	OK	73115	MIDWEST HGTS SEC 2	005	006	MIDWEST HGTS SEC 2 005	5320 S HUDDLESTON DR OKLAHOMA CITY
R148631520	LARSON RHONDA JOY		5321 S HUDDLESTON DR	OKLAHOMA CITY	OK	73135	MIDWEST HGTS SEC 2	009	003	MIDWEST HGTS SEC 2 009	5321 S HUDDLESTON DR OKLAHOMA CITY
R148631670	SIMONS MILTON A & BARBARA M		5312 SPITZ DR	OKLAHOMA CITY	OK	73135-2346	MIDWEST HGTS SEC 2	009	018	MIDWEST HGTS SEC 2 009	5312 SPITZ DR OKLAHOMA CITY
R148631510	MAYNARD JAMES OTIS		5317 S HUDDLESTON DR	OKLAHOMA CITY	OK	73135-2303	MIDWEST HGTS SEC 2	009	002	MIDWEST HGTS SEC 2 009	5317 S HUDDLESTON DR OKLAHOMA CITY
R148631040	MILLER CHARLES R & SANG UN		4015 SE 86TH PL	DEL CITY	OK	73135-1745	MIDWEST HGTS SEC 2	005	005	MIDWEST HGTS SEC 2 005	5316 S HUDDLESTON DR OKLAHOMA CITY
R148631030	MARKOWSKI HOLDINGS LLC		1409 KUEHNER DR, Unit 197	SIMI VALLEY	CA	93063	MIDWEST HGTS SEC 2	005	004	MIDWEST HGTS SEC 2 005	5312 S HUDDLESTON DR OKLAHOMA CITY
R148631680	PAM TRUONG X		2413 MONTE CAVALLIO CIR	OKLAHOMA CITY	OK	73170-3226	MIDWEST HGTS SEC 2	009	019	MIDWEST HGTS SEC 2 009	5308 SPITZ DR OKLAHOMA CITY
R148631500	3816 SPITZ DR LLC		6915 N CLASSEN BLVD, Unit A	OKLAHOMA CITY	OK	73116	MIDWEST HGTS SEC 2	009	001	MIDWEST HGTS SEC 2 009	3816 SPITZ DR OKLAHOMA CITY
R148631020	SPRATT REALTY & MANAGEMENT LLC		5112 CINDERELLA DR	OKLAHOMA CITY	OK	73128-8932	MIDWEST HGTS SEC 2	005	003	MIDWEST HGTS SEC 2 005	5308 S HUDDLESTON DR OKLAHOMA CITY
R148631010	RIVERS CHRISTINE		5304 S HUDDLESTON DR	OKLAHOMA CITY	OK	73135-2320	MIDWEST HGTS SEC 2	005	002	MIDWEST HGTS SEC 2 005	5304 S HUDDLESTON DR OKLAHOMA CITY
R148631710	MONREAL MEDINA JOSE C	TOVAR MUNOZ CLAUDIA J	3809 SPITZ DR	OKLAHOMA CITY	OK	73135-2339	MIDWEST HGTS SEC 2	010	003	MIDWEST HGTS SEC 2 010	3809 SPITZ DR OKLAHOMA CITY
R148631700	THORNTON ANNETTE TRS	THORNTON ANNETTE REV TRUST	3813 SPITZ DR	OKLAHOMA CITY	OK	73135-2339	MIDWEST HGTS SEC 2	010	002	MIDWEST HGTS SEC 2 010	3813 SPITZ DR OKLAHOMA CITY
R148631690	ST HILAIRE LAWRENCE J		3817 SPITZ DR	OKLAHOMA CITY	OK	73135-2339	MIDWEST HGTS SEC 2	010	001	MIDWEST HGTS SEC 2 010	3817 SPITZ DR OKLAHOMA CITY
R148631000	ADAMS MONTELO		5300 S HUDDLESTON DR	OKLAHOMA CITY	OK	73135	MIDWEST HGTS SEC 2	005	001	MIDWEST HGTS SEC 2 005	5300 S HUDDLESTON DR OKLAHOMA CITY
R143851870	INDEPENDENT SD 52		0	Unknown	NO	00000	UNPLTD PT SEC 19 11N 2W	000	000	UNPLTD PT SEC 19 11N 2W 000 000 PT SEC 19 11N 2W BEG 660FT W OF NE/C OF SE4 S600FT W820FT N500FT E TO BEG CONT 11ACRS MORE OR LESS EXEMPT	5301 S DIMPLE DR OKLAHOMA CITY

Oklahoma County Assessor's
300ft Radius Report
8/23/2022

R142541600	BELMONT APARTMENT PARTNERS LLC		444 EAST 58TH ST, Unit 3C	NEW YORK	NY	10022	MIDWEST HEIGHTS	000	000	MIDWEST HEIGHTS BLK A DESC BEG 200FT W OF NE/C SEC 19 11N 2W TH W434.51FT S509.97FT TH LEFT ON CURVE SLY 83.42FT SE10FT RIGHT ON CURVE SLY 102.92FT SE35.65FT E477.04FT NE35.32FT NS92FT W150FT N103FT T	4215 SE 53RD ST OKLAHOMA CITY
R146842170	JMTF INVESTMENTS LLC		PO BOX 423	TUTTLE	OK	73089	ROBERTS SOUTH HIGHLAND SEC 2	010	011	ROBERTS SOUTH HIGHLAND SEC 2 010 011	5204 S DIMPLE DR OKLAHOMA CITY
R146842240	PCW PROPERTIES LLC		PO BOX 893131	OKLAHOMA CITY	OK	73189	ROBERTS SOUTH HIGHLAND SEC 2	011	007	ROBERTS SOUTH HIGHLAND SEC 2 011 007	4016 SE 51ST ST OKLAHOMA CITY
R146842270	CLARK WALTER L	CLARK LINDA A	4004 SE 51ST ST	DEL CITY	OK	73135-2206	ROBERTS SOUTH HIGHLAND SEC 2	011	010	ROBERTS SOUTH HIGHLAND SEC 2 011 010	4004 SE 51ST ST OKLAHOMA CITY
R146842260	LOWREY JOHN C & JANE E		4608 SE 51ST ST	DEL CITY	OK	73135-2206	ROBERTS SOUTH HIGHLAND SEC 2	011	009	ROBERTS SOUTH HIGHLAND SEC 2 011 009	4008 SE 51ST ST OKLAHOMA CITY
R146842250	WALKER DEMETRI & ERIKA M		4012 SE 51ST ST	OKLAHOMA CITY	OK	73135-2206	ROBERTS SOUTH HIGHLAND SEC 2	011	008	ROBERTS SOUTH HIGHLAND SEC 2 011 008	4012 SE 51ST ST OKLAHOMA CITY
R146842280	PACHECO JINETTE		4000 SE 51ST ST	OKLAHOMA CITY	OK	73135	ROBERTS SOUTH HIGHLAND SEC 2	011	011	ROBERTS SOUTH HIGHLAND SEC 2 011 011	4000 SE 51ST ST OKLAHOMA CITY
R146842230	SCHER SANDY J & MICHELLE A		14450 S SANTA FE AVE	EDMOND	OK	73025-1802	ROBERTS SOUTH HIGHLAND SEC 2	011	006	ROBERTS SOUTH HIGHLAND SEC 2 011 006	4020 SE 51ST ST OKLAHOMA CITY
R1452011030	CUZA LESTER PADILLA		3912 SE 51ST ST	OKLAHOMA CITY	OK	73135	LEONHARDT'S OAKWOOD MANOR SEC 1	001	004	LEONHARDT'S OAKWOOD MANOR SEC 1 001 004 LOT 4 BLK 1 EX BEG SW/C LOT 4 BLK 1 TH ELY ALONG SOUTH LINE OF LOT 4 9.42FT TH NELY 62.6FT TO BOUNDARY OF LOT 3 & LOT 4 BLK 1 TH SWLY 65.5FT TO BEG PLUS BEG NE/C	3912 SE 51ST ST OKLAHOMA CITY
R146842160	MILLER AARON D	MILLER DONNA	5200 S DIMPLE DR	OKLAHOMA CITY	OK	73135-2134	ROBERTS SOUTH HIGHLAND SEC 2	010	010	ROBERTS SOUTH HIGHLAND SEC 2 010 010	5200 S DIMPLE DR OKLAHOMA CITY
R146842220	SYLBER MANAGEMENT LLC		2628 NW 159TH ST	EDMOND	OK	73013	ROBERTS SOUTH HIGHLAND SEC 2	011	005	ROBERTS SOUTH HIGHLAND SEC 2 011 005	4100 SE 51ST ST OKLAHOMA CITY
R152012010	LUIS DEBORAH MARLENE TRS	LUIS JOHN TRS	63 TOWN SQUARE CIR, Unit 104	STAFFORD	VA	22554	LEONHARDT'S OAKWOOD MANOR SEC 1	002	002	LEONHARDT'S OAKWOOD MANOR SEC 1 002 002	3728 SE 51ST ST OKLAHOMA CITY
R152012000	LEWIS LINDA LEE		3732 SE 51ST ST	DEL CITY	OK	73135-2224	LEONHARDT'S OAKWOOD MANOR SEC 1	002	001	LEONHARDT'S OAKWOOD MANOR SEC 1 002 001	3732 SE 51ST ST OKLAHOMA CITY
R146842210	CHOUHURY GOLAM M	RICH TERESA L	4104 SE 51ST ST	DEL CITY	OK	73135-2208	ROBERTS SOUTH HIGHLAND SEC 2	011	004	ROBERTS SOUTH HIGHLAND SEC 2 011 004	4104 SE 51ST ST OKLAHOMA CITY
R152011000	MADDEN PHILIP	WILLIAMS ASHLEY	3900 SE 51ST ST	DEL CITY	OK	73135-2228	LEONHARDT'S OAKWOOD MANOR SEC 1	001	001	LEONHARDT'S OAKWOOD MANOR SEC 1 001 001	3900 SE 51ST ST OKLAHOMA CITY
R152011010	CROWDER MAHOGANY N		3904 SE 51ST ST	DEL CITY	OK	73135-2228	LEONHARDT'S OAKWOOD MANOR SEC 1	001	002	LEONHARDT'S OAKWOOD MANOR SEC 1 001 002	3904 SE 51ST ST OKLAHOMA CITY

R152011020	DELGADO PABLO D						3908 SE 51ST ST	OKLAHOMA CITY	OK	73135	LEONHARDT'S OAKWOOD MANOR SEC 1	001	003	3908 SE 51ST ST OKLAHOMA CITY
R146842200	JEFFREY BOB A & DONNA R						4108 SE 51ST ST	DEL CITY	OK	73135-2208	ROBERTS SOUTH HIGHLAND SEC 2	011	003	4108 SE 51ST ST OKLAHOMA CITY
R120321380	BRAISHER TONY C						2300 SW 105TH CT	OKLAHOMA CITY	OK	73170	SUNNYDALE	003	005	4204 SE 51ST TER OKLAHOMA CITY
R146842190	TYSON CHARLES D						4112 SE 51ST ST	DEL CITY	OK	73135-2208	ROBERTS SOUTH HIGHLAND SEC 2	011	002	4112 SE 51ST ST OKLAHOMA CITY
R146842180	VEALS AARON D						3704 KEITH CT	OKLAHOMA CITY	OK	73135-2208	ROBERTS SOUTH HIGHLAND SEC 2	011	001	4116 SE 51ST ST OKLAHOMA CITY
R120321390	SHAPIRO JULIE L						4200 SE 51ST TER	DEL CITY	OK	73135	SUNNYDALE	003	006	4200 SE 51ST TER OKLAHOMA CITY
R146842150	GAINES PROPERTIES LLC						5111 NW 25TH ST	OKLAHOMA CITY	OK	73103	ROBERTS SOUTH HIGHLAND SEC 2	010	009	5116 S DIMPLE DR OKLAHOMA CITY
R120321400	NIL SINE LABORE LLC						3205 NW 175TH PL	EDMOND	OK	73012	SUNNYDALE	003	007	5117 SUNNYDALE DR OKLAHOMA CITY
R146841270	OLSON DANNY & TAWANA						PO BOX 55818	OKLAHOMA CITY	OK	73155-0818	ROBERTS SOUTH HIGHLAND SEC 2	006	017	5117 KATHY DR OKLAHOMA CITY
R146842140	SEDEY VERINDER						107 N WICKINNEY ST STE A	RICHARDSON	TX	75081	ROBERTS SOUTH HIGHLAND SEC 2	010	008	5112 S DIMPLE DR OKLAHOMA CITY
R146841780	SCOLES MARGUERITE T						5112 S KAREN ST	OKLAHOMA CITY	OK	73135-2214	ROBERTS SOUTH HIGHLAND SEC 2	008	017	5112 S KAREN ST OKLAHOMA CITY
R146841790	GAINES PROPERTIES LLC						5111 NW 25TH ST	OKLAHOMA CITY	OK	73103	ROBERTS SOUTH HIGHLAND SEC 2	008	018	5113 S DIMPLE DR OKLAHOMA CITY
R152018000	AGUILERA JAVIER MORAGA						5120 OAK MANOR DR	OKLAHOMA CITY	OK	73135	LEONHARDT'S OAKWOOD MANOR SEC 1	008	001	5120 OAK MANOR DR OKLAHOMA CITY
R152017060	FENIMORE JESSICA						5120 OAKCLIFF DR	OKLAHOMA CITY	OK	73135	LEONHARDT'S OAKWOOD MANOR SEC 1	007	007	5120 OAKCLIFF DR OKLAHOMA CITY
R152017070	KING TSA E						5121 OAK MANOR DR	OKLAHOMA CITY	OK	73135-2237	LEONHARDT'S OAKWOOD MANOR SEC 1	007	008	5121 OAK MANOR DR OKLAHOMA CITY
R120321410	CHESSER JUDITH LOU						2101 WESTBURY DR, Unit 28	YUKON	OK	73099	SUNNYDALE	003	008	5113 SUNNYDALE DR OKLAHOMA CITY
R146841450	LESSLEY SHARON L TRS						1212 S AIR DEPOT BLVD, Unit 45	MIDWEST CITY	OK	73110	ROBERTS SOUTH HIGHLAND SEC 2	007	018	4013 SE 51ST ST OKLAHOMA CITY
R146841460	RUCKER GERALDINE						PO BOX 95383	OKLAHOMA CITY	OK	73143-5383	ROBERTS SOUTH HIGHLAND SEC 2	007	019	4017 SE 51ST ST OKLAHOMA CITY
R146841470	SKEDEE PROPERTIES LLC						PO BOX 14783	OKLAHOMA CITY	OK	73113-0783	ROBERTS SOUTH HIGHLAND SEC 2	007	020	4021 SE 51ST ST OKLAHOMA CITY
R146841260	GONZALEZ DAVID ANDREW						13809 CHARLEMAGNE AVE	BELFLOWER	CA	90706-2327	ROBERTS SOUTH HIGHLAND SEC 2	006	016	5113 KATHY DR OKLAHOMA CITY
R146842130	KIM KI HOON						5108 S DIMPLE DR	OKLAHOMA CITY	OK	73135-2132	ROBERTS SOUTH HIGHLAND SEC 2	010	007	5108 S DIMPLE DR OKLAHOMA CITY

Oklahoma County Assessor's
300ft Radius Report
8/23/2022

R146841770	LUCAS SARAH A		5108 S KAREN ST	OKLAHOMA CITY	OK	73135-2214	ROBERTS SOUTH: HIGHLAND SEC 2	008	016	ROBERTS SOUTH HIGHLAND SEC 2 008 016	5108 S KAREN ST OKLAHOMA CITY
R146841800	KAZEN PROPERTIES LLC		5350 S WESTERN AVE, Unit 400	OKLAHOMA CITY	OK	73109-4531	ROBERTS SOUTH HIGHLAND SEC 2	008	019	ROBERTS SOUTH HIGHLAND SEC 2 008 019	5109 S DIMPLE DR OKLAHOMA CITY
R152017080	BODINE KENNETH R TRS	BODINE KENNETH R LIVING TRUST	5117 OAK MANOR DR	OKLAHOMA CITY	OK	73135-2237	LEONHARDTS OAKWOOD MANOR SEC 1	007	009	LEONHARDTS OAKWOOD MANOR SEC 1 007 009	5117 OAK MANOR DR OKLAHOMA CITY
R152017050	JOHNSON ADRIENNE M		5116 OAKCLIFF DR	OKLAHOMA CITY	OK	73135-2250	LEONHARDTS OAKWOOD MANOR SEC 1	007	006	LEONHARDTS OAKWOOD MANOR SEC 1 007 006	5116 OAKCLIFF DR OKLAHOMA CITY
R152018010	DAVIS MICHAEL S SUCC TRS	DAVIS VIRGIL & STEVE REV TRUST	5115 OAK MANOR DR	OKLAHOMA CITY	OK	73135	LEONHARDTS OAKWOOD MANOR SEC 1	008	002	LEONHARDTS OAKWOOD MANOR SEC 1 008 002	5115 OAK MANOR DR OKLAHOMA CITY
R120321420	TRAN HUNG	NGUYEN TUYEN	5109 SUNNYDALE DR	OKLAHOMA CITY	OK	73135-2145	SUNNYDALE	003	009	SUNNYDALE 003 009	5109 SUNNYDALE DR OKLAHOMA CITY
R146841440	BAKER RALPH A		10925 BLACK JACK RIDGE RD	OKLAHOMA CITY	OK	73150-4316	ROBERTS SOUTH HIGHLAND SEC 2	007	017	ROBERTS SOUTH HIGHLAND SEC 2 007 017	5108 KATHY DR OKLAHOMA CITY
R146841480	NIMITZ PROPERTIES 7 LLC		1530 SW 89TH ST, Unit A1	OKLAHOMA CITY	OK	73159	ROBERTS SOUTH HIGHLAND SEC 2	007	021	ROBERTS SOUTH HIGHLAND SEC 2 007 021	5109 S KAREN ST OKLAHOMA CITY
R146841250	LESSLEY SHARON L TRS	LESSLEY RICKY LEE TRS	1212 S AIR DEPOT BLVD, Unit 45	MIDWEST CITY	OK	73110	ROBERTS SOUTH HIGHLAND SEC 2	006	015	ROBERTS SOUTH HIGHLAND SEC 2 006 015	5109 KATHY DR OKLAHOMA CITY
R146841210	CALTON DENVER W		5100 S DIMPLE DR	OKLAHOMA CITY	OK	73135-2132	ROBERTS SOUTH HIGHLAND SEC 2	010	006	ROBERTS SOUTH HIGHLAND SEC 2 010 006	0 UNKNOWN OKLAHOMA CITY
R146841760	FARLEY JANETTE	C/O CHRISTY RICHMOND	1804 SE 16TH ST	MOORE	OK	73160-8020	ROBERTS SOUTH HIGHLAND SEC 2	008	015	ROBERTS SOUTH HIGHLAND SEC 2 008 015	5104 S KAREN ST OKLAHOMA CITY
R146841810	KAZEN PROPERTIES LLC		5350 S WESTERN AVE, Unit 400	OKLAHOMA CITY	OK	73109-4531	ROBERTS SOUTH HIGHLAND SEC 2	008	020	ROBERTS SOUTH HIGHLAND SEC 2 008 020	0 UNKNOWN OKLAHOMA CITY