

PRELIMINARY PLAT

of  
**MAGNOLIA HARBOR**

BEING A PART OF THE NE¼ OF SEC. 26, T12N, R5W, L1M,  
AN ADDITION TO OKLAHOMA CITY, CANADIAN COUNTY, OKLAHOMA

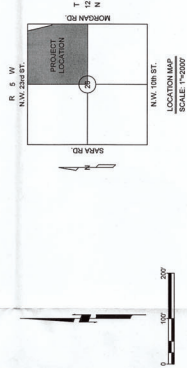

- UTILITY LEGEND**
- EXISTING SANITARY RIVER LINE
  - PROPOSED SANITARY RIVER LINE
  - EXISTING BURIED SANITARY RIVER LINE
  - PROPOSED BURIED SANITARY RIVER LINE
  - PROPOSED FIRE HYDRANT

- LEGEND**
- P.O.C. = POINT OF COMMENCEMENT
  - W.C. = WEST CORNER
  - R.V. = RIGHT OF WAY
  - L.V. = LIMITS OF NO ACCESS
  - B.L. = BUILDING LIMIT LINE
  - D.S. = PRIVATE DRAINAGE & PUBLIC UTILITY EASEMENT
  - D.S. = PRIVATE DRAINAGE & PUBLIC UTILITY EASEMENT



**OWNER/DEVELOPER**  
DELA HOMES  
11111 N. 11TH ST.  
NORMAN, OK 73071  
(405) 884-5443

**ENGINEER**  
J. E. SHERIDAN, INC.  
11111 N. 11TH ST.  
NORMAN, OK 73071  
(405) 884-5443

TOTAL ACRES = 155.028  
TOTAL LOTS = 620  
PRELIMINARY PLAT

**MAGNOLIA HARBOR**

