

# FINAL PLAT of

## THE TRIBUTARY

BEING A PART OF THE NW1/4, SEC. 24, T13N, R3W, I.M.  
AN ADDITION TO THE CITY OF OKLAHOMA CITY, OKLAHOMA COUNTY, OKLAHOMA

LEGEND:  
POC = POINT OF COMMENCEMENT  
POB = POINT OF BEGINNING  
RW = RIGHT OF WAY  
LWA = LIMITS OF NO ACCESS  
NR = NOT RADIAL  
UE = PUBLIC UTILITY EASEMENT  
D & UE = DRAINAGE & UTILITY EASEMENT

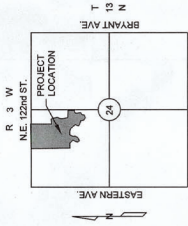

• DENOTES RND. #3 BAR W/CAP  
STAMPED JAA 1464 UNLESS  
OTHERWISE NOTED  
○ DENOTES SET #3 BAR W/CAP  
STAMPED JAA 1464 UNLESS  
OTHERWISE NOTED  
△ DENOTES SET #3 BAR W/CAP  
SHINER UNLESS OTHERWISE  
NOTED

BASIS OF BEARING:  
Grid North as established by state plane datum (Oklahoma State Plane North Zone MGRS)  
Grid North as established by state plane datum (Oklahoma State Plane North Zone MGRS)  
Page 1271 and Book 13371, Page 1788. Bearings must be rotated 000°00'24" counter-clockwise  
to match the bearings shown on the unrecorded plat HEPNER HILLS ADDITION.

### NOTES:

1. All landowners within street rights-of-way, and aerial landscaping with its irrigation system, shall be maintained by the Property Owners Association within THE TRIBUTARY.
2. Maintenance of all common areas and private drainage easements within THE TRIBUTARY shall be the responsibility of the Property Owners Association. No structures, storage of material, grading, fill, or other obstructions, including fences, either temporary or permanent, that may cause a blockage of flow or an adverse effect on the functioning of this storm water facility, shall be placed within the common areas intended for the use of the storm water facility. The storm water facility shall be maintained in accordance with the standards set forth in the City of Oklahoma City Storm Water Code, which standards shall be maintained in accordance with the standards set forth in the City of Oklahoma City Storm Water Code, which standards shall be maintained in accordance with the standards set forth in the City of Oklahoma City Storm Water Code.

| Line # | Length | Direction   |
|--------|--------|-------------|
| L1     | 37.80' | N50°31'35"W |
| L2     | 32.23' | S88°43'22"W |

| Curve # | Length  | Radius  | Tangent | Chord Length | Chord Direction | Delta      |
|---------|---------|---------|---------|--------------|-----------------|------------|
| C1      | 105.05' | 131.75' | 55.50'  | 102.29'      | S09°41'40"W     | 045°41'05" |
| C2      | 105.84' | 123.33' | 57.09'  | 103.47'      | S07°31'02"W     | 050°02'22" |
| C3      | 105.84' | 300.00' | 82.45'  | 159.01'      | S10°47'14"E     | 039°44'11" |
| C4      | 224.63' | 400.00' | 115.35' | 221.59'      | S10°04'03"E     | 032°10'34" |
| C5      | 259.60' | 200.00' | 151.72' | 241.75'      | S37°09'50"E     | 074°22'08" |
| C6      | 437.03' | 525.00' | 232.07' | 424.52'      | S09°30'03"E     | 047°41'42" |
| C7      | 1.74'   | 25.00'  | 0.87'   | 1.74'        | S24°39'00"E     | 002°35'44" |
| C8      | 18.29'  | 25.00'  | 10.16'  | 18.82'       | S00°34'08"E     | 044°12'39" |
| C9      | 120.59' | 50.00'  | 130.90' | 93.42'       | S47°33'03"E     | 135°11'23" |
| C10     | 110.70' | 50.00'  | 99.97'  | 89.44'       | N07°04'56"W     | 129°51'26" |
| C11     | 9.89'   | 50.00'  | 4.95'   | 9.87'        | N09°10'36"W     | 011°15'54" |
| C12     | 21.03'  | 25.00'  | 11.18'  | 20.41'       | N09°44'53"W     | 048°11'23" |

### TYPICAL SIGHT TRIANGLE

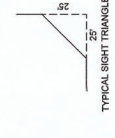

\*\*\*\*\* NOTE \*\*\*\*\*  
THIS SURVEY MEETS THE MINIMUM STANDARDS FOR THE PRACTICE OF LAND SURVEYING AS ADOPTED BY THE OKLAHOMA STATE BOARD OF REGISTRATION FOR LAND SURVEYORS. THE SURVEYOR HAS CONDUCTED A VISUAL INSPECTION OF THE TRIBUTARY AND HAS DETERMINED THAT THE TRIBUTARY MEETS THE REQUIREMENTS OF THE OKLAHOMA STATE STATUTES.

