

Traffic and Transportation Commission

April 18, 2022

Passenger Loading Zone
Ward 6

V-A. Applicant: Gary W Noland, P.E., Smith Roberts Baldischwiler, LLC, 100 NE 5 Street, Oklahoma City, OK 73104
Municipal Code §32-296, §32-297, §32-299, §32-300, §32-304, §32-401 and §32-402

Request: Full-time passenger loading zone on the north side of W Sheridan Avenue from approximately 128 feet west to 201 feet west of the west curb line of N Robinson Avenue.

<u>Traffic Data:</u>	<u>East/West</u>
Street Name:	W Sheridan Avenue
Street Typology:	Storefront*
bikewalkokc Designation:	Tier 2 facility (bicycle lane) from N Western Avenue to Joe Carter Avenue
Street Width:	44 feet, four lanes, two-way, curbed, undivided
Existing Traffic Controls:	Traffic signals on W Sheridan Avenue at N Hudson Avenue and at N Robinson Avenue with mid-block pedestrian crossing signal approximately 490 feet west of N Robinson Avenue.
Parking Controls:	No parking anytime (both sides)
Traffic Volume:	6,478 vehicles per day (vpd)(2018)(ACOG)
Speed Limit:	30 mph
DPS Collision Data: (January 2020 to December 2020)	One collision recorded at N Robinson Avenue and W Sheridan Avenue. No collisions recorded in the vicinity of the requested lay-by.

* planokc defines “storefront” street typology as, “destination streets that have concentrated amounts of retail, dining and/or entertainment, and subsequently carry the largest amount of pedestrian traffic. Key characteristics of this street typology are expanded pedestrian zones, on-street parking and streetcar routes.”

Summary: Gary W Noland, P.E., with Smith Roberts Baldischwiler, LLC, on behalf of their client, Devon Headquarters, LLC, submitted a request for a full-time passenger loading zone within a proposed layby to be built on the north side of W Sheridan Avenue from approximately 128 feet west to 201 feet west of the west curb line of N Robinson Avenue. The requested full-time passenger loading zone will encompass the full limits of the proposed layby.

Between N Hudson Avenue and N Robinson Avenue, W Sheridan Avenue is a 44 foot wide, four lane, two-way, curbed, undivided roadway and is classified as a storefront roadway in planokc, which is the City’s latest comprehensive plan as adopted by the City Council on July 9, 2015. The speed limit on W Sheridan Avenue is 30 miles per hour (mph).

Oklahoma Department of Public Safety (DPS) records show one (1) collision at N Robinson Avenue and W Sheridan Avenue and no collisions on W Sheridan Avenue between N Robinson Avenue and N Hudson Avenue in 2020, which is the most recent substantially complete year for which statistical data is available.

Analysis:

The illustration provided shows the layby will have a total length of 73 feet and a paved width of eight (8) feet. The applicant is requesting designation of the proposed layby for use as passenger loading zone on a full-time basis.

In his letter, Mr. Noland indicates his client is also seeking codesignation of the requested passenger loading zone as a valet loading zone. Establishing a passenger loading zone codesignated as a valet loading zone is a necessary first step toward obtaining approval to operate a valet parking service on public right-of-way within Oklahoma City. The final step in this process is the approval of an administrative revocable permit to operate a valet service within an existing valet loading zone.

Mr. Noland's request for codesignation of the requested passenger loading zone as a valet loading zone is presented in the next item in this agenda.

Recommendation: Action on this matter is at the discretion of the Commission.

Staff notes that, if approved, the passenger loading zone cannot be reserved for any specific user. This zone will be freely available for the short-term passenger loading needs of the public. The applicant has requested that the zone be in effect on a full-time basis. §32-300 limits the times and days when commercial and/or passenger loading zones are in effect. §32-300 states, "All parking limit regulations, unless otherwise specifically provided herein, shall be in force and effect between the hours of 8:00 a.m. and 6:00 p.m. except Sundays and holidays."

The request to designate it as a full-time passenger loading zone will preclude it from being used for any purpose other than passenger loading. Without approval for use as a passenger loading zone on a full-time basis, the area will be available for public parking purposes outside the hours of 8:00 a.m. to 6:00 p.m. weekdays and holidays.

Next Actions: Unless appealed, the decision of the Traffic and Transportation Commission regarding the passenger loading zone is final.

Traffic Management Division
SC:sc

§ 32-296. Definitions.

The following words, terms and phrases, when used in this article, shall have the meanings ascribed to them in this section, except where the context clearly indicates a different meaning:

- (1) Business loop means the area bounded on the north by the north curblane of North 6th Street; on the east by the east curblane of Santa Fe; on the south by the south curblane of Interstate 40; and on the west by the west curblane of Dewey Avenue.
- (2) Derelict vehicle means:
 - a. a vehicle which is in a state of dilapidation and not in operating condition;
 - b. a vehicle upon which a current license plate is not displayed;
 - c. a vehicle from which tires or wheels have been removed or deflated;
 - d. a vehicle which has obviously been abandoned and left on any street by the owner of the vehicle.
- (3) **Holidays means the following days and dates only:** each Saturday; each Sunday; New Year's Day on January 1; Martin Luther King Day on the third Monday of January; President's Day on the third Monday in February; Memorial Day on the last Monday in May; Independence Day on July 4; Labor Day on the first Monday in September; Veterans' Day on November 11; Thanksgiving Day on the fourth Thursday in November; Christmas on December 25; the Monday before Christmas if Christmas is on a Tuesday, the Friday after Christmas if Christmas is on a Thursday; if any such holiday other than a Saturday at any time falls on a Saturday, the preceding Friday shall be a holiday in that year, and, if any such holiday other than Sunday at any time falls on Sunday, the succeeding Monday shall be a holiday in that year.

(Code 1970, § 34-84; Code 1980, § 32-296; Ord. No. 23679, § 1, 8-26-08)

Cross reference— Definitions and rules of construction generally, § 1-2.

§ 32-297. Parking signs required.

The Director shall cause the erection of appropriate signs giving notice of any parking time limits or parking regulations imposed by law. No such regulations shall be effective unless said signs are erected and in place at the time of any alleged offense.

(Code 1970, § 34-93; Code 1980, § 32-297)

§ 32-299. - Parking time limits not exclusive.

The provisions of this article imposing a time limit on parking shall not relieve any person from the duty to observe other and more restrictive provisions prohibiting or limiting the stopping, standing, or parking of vehicles in specified places or at specified times.

(Code 1970, § 34-92; Code 1980, § 32-299)

§ 32-300. - Hours when restricted parking applies.

All parking limit regulations, unless otherwise specifically provided herein, shall be in force and effect between the hours of 8:00 a.m. and 6:00 p.m. except Sundays and holidays. The provisions of this article regulating vehicular parking upon the streets shall have no application on Sundays and holidays unless the particular regulation specifically provides that it shall apply at all times.

(Code 1970, § 34-85; Code 1980, § 32-300)

§ 32-304. - Stopping, standing or parking prohibited in specified places.

- (a) No person shall stop, stand, or park a vehicle, except in emergencies or when necessary to avoid conflict with other traffic or in compliance with law or the directions of a Police Officer or traffic control device in any of the following places:
- (1) on a sidewalk;
 - (2) in front of a public or private driveway;
 - (3) within an intersection;
 - (4) within 15 feet of a fire hydrant or blocking a fire lane;
 - (5) on a crosswalk;
 - (6) within 20 feet of a crosswalk at an intersection;
 - (7) within 30 feet upon the approach to any flashing beacon, stop sign, or traffic control signal located at the side of a roadway;
 - (8) between a safety zone and the adjacent curb or within 30 feet of points on the curb immediately opposite the ends of a safety zone, unless a different length by signs or markings erected by the City;
 - (9) within 50 feet of the nearest rail of a railroad crossing;
 - (10) within 20 feet of the driveway entrance to any fire station and on the side of the street opposite the entrance to any fire station within 75 feet of said entrance (when properly signposted);
 - (11) alongside or opposite any street excavation or construction when stopping, standing, or parking would obstruct traffic;
 - (12) on the roadway side of any vehicle stopped or parked at the edge or curb of a street;
 - (13) upon any bridge or other elevated structure upon a highway or within a highway tunnel;
 - (14) at any place where official signs prohibit stopping, standing or parking;
 - (15) on any center median or any non-residential property planting strip;
 - (16) in any designated loading zone in violation of official posted signage, including but not limited to any passenger loading zone, commercial loading zone, valet loading zone, bus stop, taxicab stand, or carriage stand.
- (b) No person shall move a vehicle not lawfully under his control into any such prohibited area or an unlawful distance away from a curb.
- (c) The owner or operator of a vehicle or its cargo that obstructs the regular flow of traffic shall make every reasonable effort to remove the obstructing vehicle or cargo from the roadway so the regular flow of traffic is not blocked. This subsection shall not apply to:
- (1) Collisions resulting in the injury or death of any person; and/or
 - (2) Collision involving vehicles transporting "Hazardous material" as defined by state law and/or the United States Department of Transportation; and
 - (3) Nothing in this subsection shall be construed to relieve any person from complying with any duties as required by Article III, Sections 32-146 through 32-151, inclusive.
- (d) Any person who violates the provisions of this section shall be guilty of a Class "a" offense.

(Code 1970, § 34-101; Code 1980, § 32-304; Ord. No. 23641, § 1, 7-15-08; Ord. No. 24121, § 1, 8-17-10; Ord. No. 24417, § 3, 2-21-12)

State law reference— Stopping, standing or parking prohibited in specified places, 47 O.S. § 11-1003.

§ 32-401. - Definitions.

The following words, terms and phrases, when used in this article, shall have the meanings ascribed to them in this section, except where the context clearly indicates a different meaning:

- (1) Commercial loading zones means all curb loading zones authorized and regularly used exclusively for the loading and unloading of merchandise for storage, trade, shipment or resale.
- (2) Passenger loading zones means all loading zones authorized and used regularly and other passenger common carrier vehicles.
- (3) Valet loading zone means a passenger loading zone, that has been designated by the Commission as a location where (1) a valet parking service may operate and (2) any other driver may expeditiously load and unload passengers.
- (4) Valet parking service is a business operated or service provided, within a designated valet loading zone, by any person or entity whereby the driver of a passenger vehicle leaves the vehicle on the public right-of-way for the operator of the service to park at another location and return to the driver upon demand.

(Code 1970, § 34-131; Code 1980, § 32-401; Ord. No. 23642, § 1, 7-15-08)

Cross reference— Definitions and rules of construction generally, § 1-2.

§ 32-402. - Curb loading zones generally.

- (a) The Director or designee shall recommend the location of all loading zones on public streets in such places and in such number as he/she shall determine to be of the greatest benefit and convenience to the public, and every such loading zone shall be designated by appropriate signs.
- (b) The Commission is hereby authorized to review the Director's recommendation and approve or deny the location of valet, passenger and commercial curb loading zones and shall cause the Public Works Department to place and maintain appropriate signs indicating the zones and stating the times during which the provisions of this section are applicable.
- (c) No person shall stand or park a vehicle in violation of such signs.

(Code 1970, §§ 34-132, 34-137; Code 1980, § 32-402; Ord. No. 23642, § 1, 7-15-08)



RECEIVED BY
March 28, 2022
Traffic Mgmt. Div.

100 NE 5th Street
Oklahoma City, OK 73104
Telephone (405) 418-2288 Fax (405) 418-2289

March 28, 2022

Mr. Stuart Chai, PE
City Traffic Engineer
City of Oklahoma City
420 W. Main Street, 6th Floor
Oklahoma City, OK 73104

**Re: Updated Request for Traffic Commission Consideration for a Passenger Loading Zone Lay-by and Valet at the Devon Energy Center
333 West Sheridan Ave.
Oklahoma City, Oklahoma**

Dear Mr. Chai,

On behalf of our client, Devon Headquarters, LLC we submit this request for consideration to install a passenger loading zone lay-by and valet for Devon Energy Center located at 333 West Sheridan Ave. The passenger loading zone will be constructed behind the north curb of Sheridan Ave. and will include a 72.69-foot wide by 8-foot lay-by with a 5-foot wide by 20-foot-long accessible aisle with flush curb along the north side at the east end for passenger loading and valet. This loading zone will be in effect at a full-time basis. The attached Exhibits indicate the location of the requested loading/unloading zone and valet.

We request that this item be placed on the next possible Traffic & Transportation Commission docket for consideration and approval. Plans for this lay-by have been submitted to The City of Oklahoma City Public Works Department through the citizens permit portal and the project number assigned to the plans is PD-3114. Should you have any questions or comments or require additional information, please contact me by e-mail at e-mail address redacted or at 405-574-6856.

Sincerely,

A handwritten signature in blue ink, appearing to read "Gary W. Noland", is written over a light blue circular stamp.

Gary W. Noland, PE
Smith Roberts Baldischwiler, LLC



Devon Energy Corporation
333 West Sheridan Avenue
Oklahoma City, OK 73102-5015

405 235 3611 Phone
www.devonenergy.com

RECEIVED BY

March 28, 2022

Traffic Mgmt. Div.

March 28, 2022

Mr. Stuart Chai, PE
City Traffic Engineer
City of Oklahoma City
420 W. Main Street, 6th Floor
Oklahoma City, OK 73104

Re: Letter of Authorization for Traffic Commission Submittal
Lay-by for Valet Parking Drop-off at the Devon Energy Center
333 West Sheridan Avenue, Oklahoma City, Oklahoma 73102

Dear Mr. Chai,

As the owner/representative of Devon Headquarters, LLC at 333 W. Sheridan Ave., I am writing to inform you that I support the proposed valet and passenger loading zone on the north side of West Sheridan Avenue, and I authorize Miles Architecture, LLC and SRB, LLC to represent Devon Headquarters, LLC as representative/agent for the processing of this submittal to the City of Oklahoma City and the Oklahoma City Traffic and Transportation Commission. Please contact me at the phone number provided above if you have any questions, comments, or require additional information.

Sincerely,

A handwritten signature in black ink, appearing to read "Zafar Ali". The signature is fluid and cursive, with a large, stylized "Z" and "A".

Zafar Ali
Vice President
Devon Headquarters, LLC



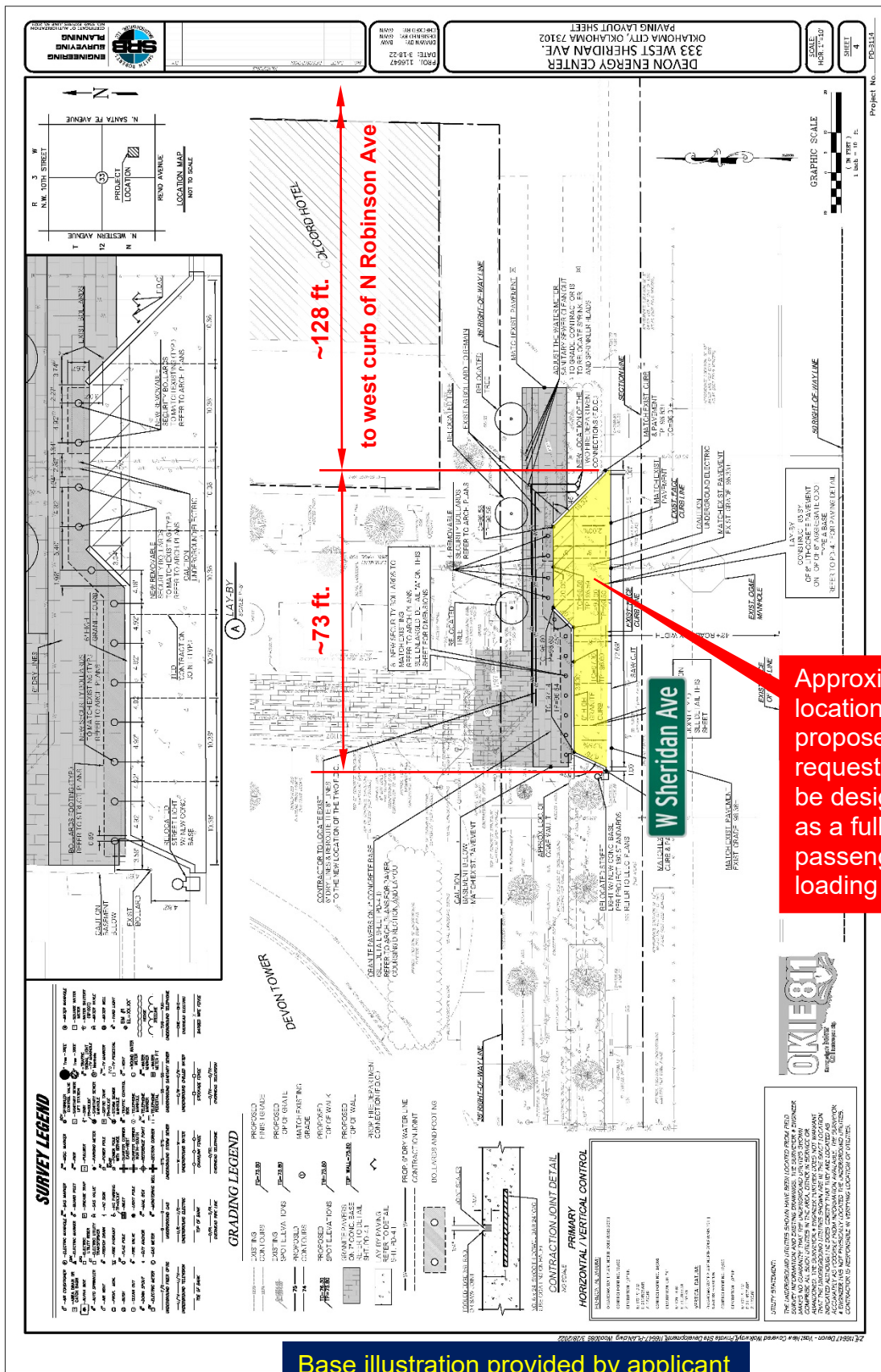

Cc: Gary Noland, P.E., SRB, LLC



Base illustration provided by applicant

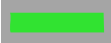

W Sheridan Avenue Area Traffic Control Map

- 
Speed Limits (as depicted)
- 
Traffic controls (as depicted)
- 
Existing curb loading zones (as depicted)
- 
Requested full-time passenger loading zone (as depicted)



Looking east on W Sheridan Avenue toward N Robinson Avenue.



Looking west on W Sheridan Avenue from the west side of N Robinson Avenue. The traffic signal is at the pedestrian crossing midway between N Robinson Avenue and N Hudson Avenue.