

Case No: DA-26405 Applicant: Johnson & Associates, LLC on behalf of Native Warehousing, LLC
Location: 13020 W. Reno Ave., 321 S. Cemetery Rd., and 345 S. Cemetery Rd.

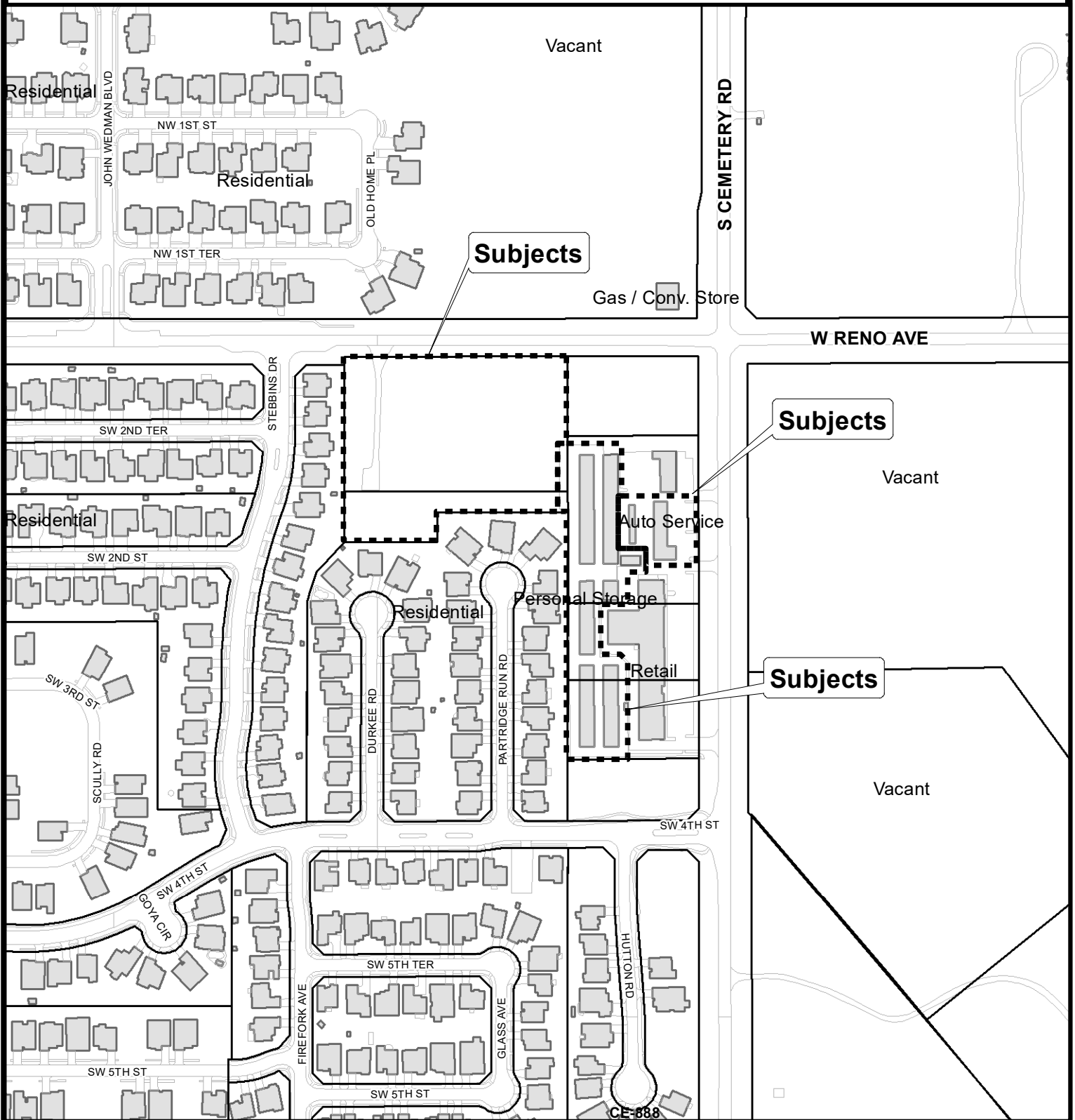

The City of
OKLAHOMA CITY

Application for Lot Split / Deed Approval



0 150 300
Feet