

Case No: PC-10735 Applicant: Premium Land, LLC c/o Crafton Tull
Existing Zoning: AA Proposed zoning: R-1
Location: 5808 NW 159th St.

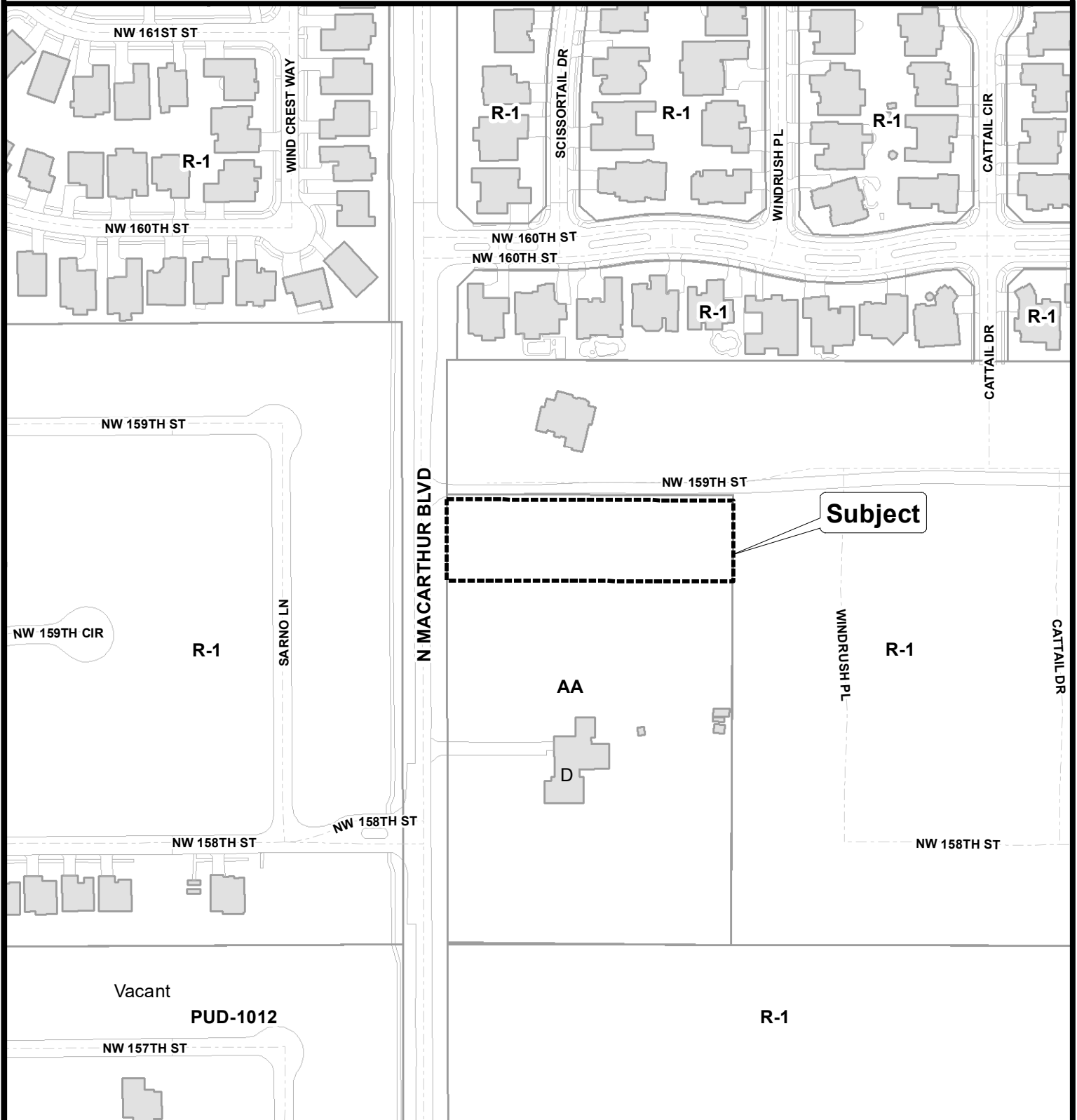

Note: "Subject" is located approximately 2,100' south of NW 164th St.



The City of
OKLAHOMA CITY

Rezoning Application



0 100 200
Feet