

Case No: C-7374 Preliminary Plat of Bel-Air Park Section 3  
Developer: Ram Dam Development, LLC  
Engineer: Crafton Tull

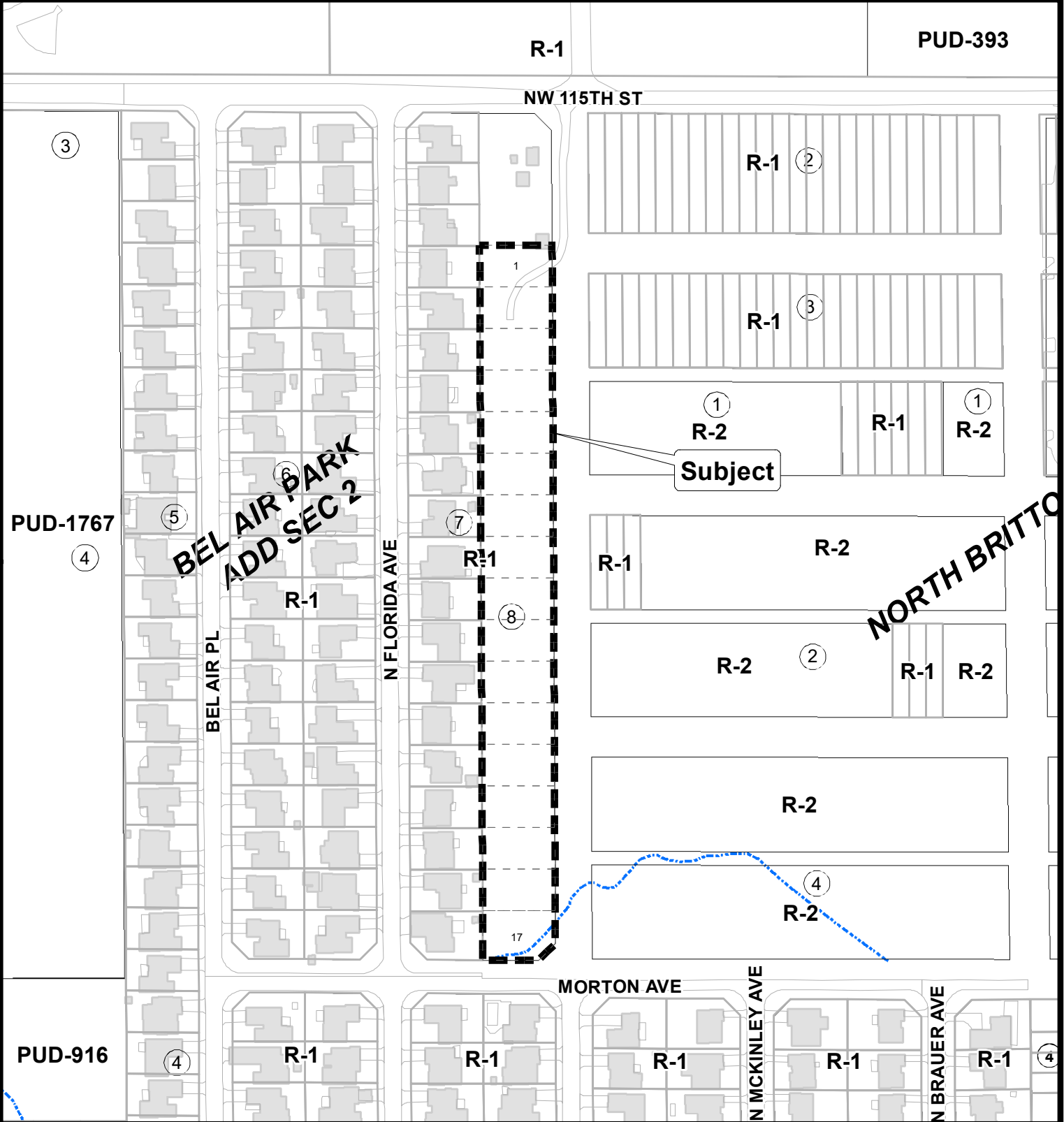

Note: "Subject" is located approximately 2,536' east of N. Pennsylvania Ave.

Preliminary Plat  
Application



The City of  
OKLAHOMA CITY



0 100 200  
Feet