

NOTICE IS HEREBY GIVEN, that the City Council of Oklahoma City will hold a public hearing on a proposed ordinance, establishing Special Permit No. SP-590 to operate Use Unit 8250.19 Transitional Mental Health Residential Facilities in the AA Agricultural District. A public hearing will be held by the City Council on December 31, 2024. **The City Council meets in the Council Chamber, Third Floor, Municipal Building, 200 North Walker Avenue, Oklahoma City, Oklahoma, beginning at 8:30 a.m.**

Agenda and case materials are available online at <https://okc.primegov.com/public/portal>.

Under the terms of said ordinance, the limits of and boundaries of Special Permit No. SP-590 would be extended to include the following described property:

LEGAL DESCRIPTION:

TRACT "A": A TRACT OF LAND LYING IN THE SOUTHEAST QUARTER (SE/4) OF SECTION NINE (9), TOWNSHIP TWELVE (12) NORTH, RANGE TWO (2) WEST OF THE INDIAN MERIDIAN, OKLAHOMA COUNTY, OKLAHOMA, BEING MORE PARTICULARLY DESCRIBED AS FOLLOWS: COMMENCING AT THE SOUTHWEST CORNER OF THE SOUTHEAST QUARTER (SE/4) OF SAID SECTION NINE (9); THENCE S89°44'42"E, ALONG THE SOUTH LINE OF SAID SOUTHEAST QUARTER (SE/4), A DISTANCE OF 531.31 FEET TO THE POINT OF BEGINNING; THENCE N00°41'23"W, PARALLEL WITH THE WEST LINE OF SAID SOUTHEAST QUARTER (SE/4), A DISTANCE OF 1502.07 FEET; THENCE S89°44'42"E, PARALLEL WITH THE SOUTH LINE OF SAID SOUTHEAST QUARTER (SE/4), A DISTANCE OF 1160.00 FEET; THENCE S00°41'23"E, PARALLEL WITH THE WEST LINE OF SAID SOUTHEAST QUARTER (SE/4), A DISTANCE OF 905.63 FEET; THENCE N89°44'42"W, PARALLEL WITH THE SOUTH LINE OF SAID SOUTHEAST QUARTER (SE/4), A DISTANCE OF 780.08 FEET; THENCE S37°43'13"W A DISTANCE OF 323.42 FEET TO A POINT OF CURVATURE; THENCE SOUTHERLY ALONG A CURVE TO THE LEFT HAVING A RADIUS OF 210.00 FEET (SAID CURVE BEING SUBTENDED BY A CHORD WHICH BEARS S18°30'55"W A DISTANCE OF 138.16 FEET) AN ARC DISTANCE OF 140.78 FEET; THENCE S00°41'23"E, PARALLEL WITH THE WEST LINE OF SAID SOUTHEAST QUARTER (SE/4), A DISTANCE OF 81.56 FEET; THENCE S35°34'34"E A DISTANCE OF 35.38 FEET; THENCE S00°41'23"E, PARALLEL WITH THE WEST LINE OF SAID SOUTHEAST QUARTER (SE/4), A DISTANCE OF 98.24 FEET TO A POINT ON THE SOUTH LINE OF SAID SOUTHEAST QUARTER (SE/4); THENCE N89°44'42"W, ALONG SAID SOUTH LINE, A DISTANCE OF 153.74 FEET TO THE POINT OF BEGINNING. **AND TRACT "B":** A TRACT OF LAND LYING IN THE SOUTHEAST QUARTER (SE/4) OF SECTION NINE (9), TOWNSHIP TWELVE (12) NORTH, RANGE TWO (2) WEST OF THE INDIAN MERIDIAN, OKLAHOMA COUNTY, OKLAHOMA, BEING MORE PARTICULARLY DESCRIBED AS FOLLOWS: COMMENCING AT THE SOUTHWEST CORNER OF THE SOUTHEAST QUARTER (SE/4) OF SAID SECTION NINE (9); THENCE S89°44'42"E, ALONG THE SOUTH LINE OF SAID SOUTHEAST QUARTER (SE/4), A DISTANCE OF 685.05 FEET TO THE POINT OF BEGINNING; THENCE N00°41'23"W, PARALLEL WITH THE WEST LINE OF SAID SOUTHEAST QUARTER (SE/4), A DISTANCE OF 98.24 FEET; THENCE N35°34'34"W A DISTANCE OF 35.38 FEET; THENCE N00°41'23"W, PARALLEL WITH THE WEST LINE OF SAID SOUTHEAST QUARTER (SE/4), A DISTANCE OF 81.56 FEET TO A POINT OF CURVATURE; THENCE NORTHERLY ALONG A CURVE TO THE RIGHT HAVING A RADIUS OF 210.00 FEET (SAID CURVE BEING SUBTENDED BY A CHORD WHICH BEARS N18°30'55"E A DISTANCE OF 138.16 FEET) AN ARC DISTANCE OF 140.78 FEET; THENCE N37°43'13"E A DISTANCE OF 323.42 FEET; THENCE S89°44'42"E,

PARALLEL WITH THE SOUTH LINE OF SAID SOUTHEAST QUARTER (SE/4), A DISTANCE OF 780.08 FEET; THENCE S00°41'23"E, PARALLEL WITH THE WEST LINE OF SAID SOUTHEAST QUARTER (SE/4), A DISTANCE OF 427.60 FEET; THENCE S65°24'48"W A DISTANCE OF 401.90 FEET TO A POINT ON THE SOUTH LINE OF SAID SOUTHEAST QUARTER (SE/4); THENCE N89°44'42"W, ALONG SAID SOUTH LINE, A DISTANCE OF 638.76 FEET TO THE POINT OF BEGINNING.

Any person having any interest in the proposed Special Permit may appear before the City Council in the **COUNCIL CHAMBER** on the above date set for hearing and show cause why the proposed Special Permit should or should not be carried out in accordance with said ordinance. Any person may make a written protest by filing the same with the Office of the City Clerk, Second Floor, 200 North Walker Avenue, Oklahoma City, Oklahoma 73102.

Dated this 3rd day of December 2024.

SEAL

Amy K. Simpson

Amy K. Simpson, City Clerk



NOTICE OF REQUEST FOR SPECIAL PERMIT

CASE NUMBER: SP-590

PROPOSED SPECIAL PERMIT USE UNIT: 8250.19 Transitional Mental Health Residential Facilities

LOCATION OF PROPERTY: 6501 NE 50th Street

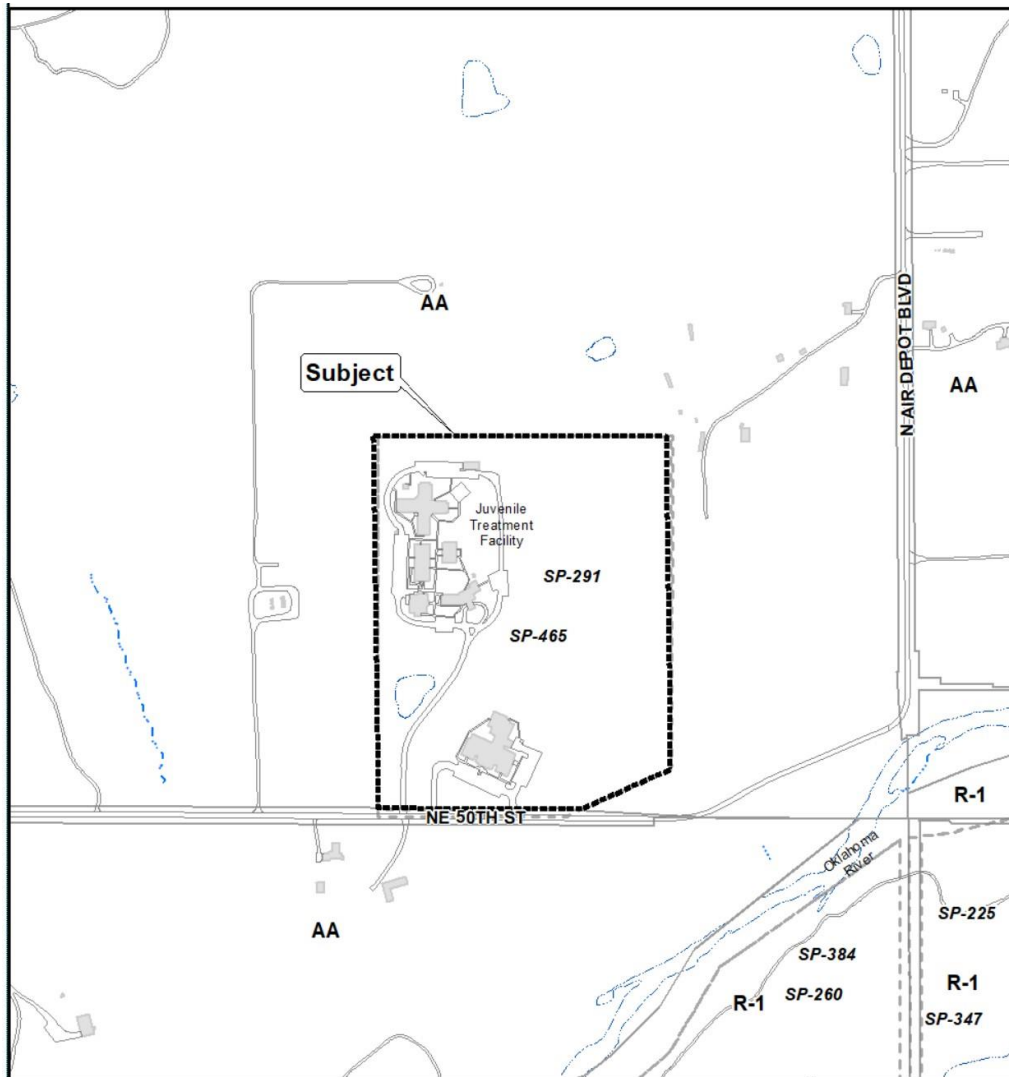

BRIEF DESCRIPTION OF PROPOSED SPECIAL PERMIT:

AA Agricultural District creates and preserves areas intended primarily for agricultural purposes. It permits low intensity residential development along with certain essential commercial and institutional uses.

Should you have any questions or concerns regarding this application please call:

The City of Oklahoma City

Planning Department

420 West Main Street, Suite 910

Oklahoma City, Oklahoma 73102

(405) 297-2623

(405) 297-2495

(405) 297-2289

subdivisionandzoning@okc.gov

FOR PUBLICATION ONLY

CASE NUMBER: SP-590

LOCATION: 6501 NE 50th Street

NOTICE IS HEREBY GIVEN, that the City Council of Oklahoma City will hold a public hearing on a proposed ordinance, establishing Special Permit No. SP-590 to operate Use Unit 8250.19 Transitional Mental Health Residential Facilities in the AA Agricultural District. A public hearing will be held by the City Council on December 31, 2024. **The City Council meets in the Council Chamber, Third Floor, Municipal Building, 200 North Walker Avenue, Oklahoma City, Oklahoma beginning at 8:30 a.m.**

Agenda and case materials are available online at <https://okc.primegov.com/public/portal>.

Under the terms of said ordinance, the limits of and boundaries of Special Permit No. SP-590 would be extended to include the following described property:

LEGAL DESCRIPTION:

TRACT "A": A TRACT OF LAND LYING IN THE SOUTHEAST QUARTER (SE/4) OF SECTION NINE (9), TOWNSHIP TWELVE (12) NORTH, RANGE TWO (2) WEST OF THE INDIAN MERIDIAN, OKLAHOMA COUNTY, OKLAHOMA, BEING MORE PARTICULARLY DESCRIBED AS FOLLOWS: COMMENCING AT THE SOUTHWEST CORNER OF THE SOUTHEAST QUARTER (SE/4) OF SAID SECTION NINE (9); THENCE S89°44'42"E, ALONG THE SOUTH LINE OF SAID SOUTHEAST QUARTER (SE/4), A DISTANCE OF 531.31 FEET TO THE POINT OF BEGINNING; THENCE N00°41'23"W, PARALLEL WITH THE WEST LINE OF SAID SOUTHEAST QUARTER (SE/4), A DISTANCE OF 1502.07 FEET; THENCE S89°44'42"E, PARALLEL WITH THE SOUTH LINE OF SAID SOUTHEAST QUARTER (SE/4), A DISTANCE OF 1160.00 FEET; THENCE S00°41'23"E, PARALLEL WITH THE WEST LINE OF SAID SOUTHEAST QUARTER (SE/4), A DISTANCE OF 905.63 FEET; THENCE N89°44'42"W, PARALLEL WITH THE SOUTH LINE OF SAID SOUTHEAST QUARTER (SE/4), A DISTANCE OF 780.08 FEET; THENCE S37°43'13"W A DISTANCE OF 323.42 FEET TO A POINT OF CURVATURE; THENCE SOUTHERLY ALONG A CURVE TO THE LEFT HAVING A RADIUS OF 210.00 FEET (SAID CURVE BEING SUBTENDED BY A CHORD WHICH BEARS S18°30'55"W A DISTANCE OF 138.16 FEET) AN ARC DISTANCE OF 140.78 FEET; THENCE S00°41'23"E, PARALLEL WITH THE WEST LINE OF SAID SOUTHEAST QUARTER (SE/4), A DISTANCE OF 81.56 FEET; THENCE S35°34'34"E A DISTANCE OF 35.38 FEET; THENCE S00°41'23"E, PARALLEL WITH THE WEST LINE OF SAID SOUTHEAST QUARTER (SE/4), A DISTANCE OF 98.24 FEET TO A POINT ON THE SOUTH LINE OF SAID SOUTHEAST QUARTER (SE/4); THENCE N89°44'42"W, ALONG SAID SOUTH LINE, A DISTANCE OF 153.74 FEET TO THE POINT OF BEGINNING. **AND TRACT "B":** A TRACT OF LAND LYING IN THE SOUTHEAST QUARTER (SE/4) OF SECTION NINE (9), TOWNSHIP TWELVE (12) NORTH, RANGE TWO (2) WEST OF THE INDIAN MERIDIAN, OKLAHOMA COUNTY, OKLAHOMA, BEING MORE PARTICULARLY DESCRIBED AS FOLLOWS: COMMENCING AT THE SOUTHWEST CORNER OF THE SOUTHEAST QUARTER (SE/4) OF SAID SECTION NINE (9); THENCE S89°44'42"E, ALONG THE SOUTH LINE OF SAID SOUTHEAST QUARTER (SE/4), A DISTANCE OF 685.05 FEET TO THE POINT OF BEGINNING; THENCE N00°41'23"W, PARALLEL WITH THE WEST LINE OF SAID SOUTHEAST QUARTER (SE/4), A DISTANCE OF 98.24 FEET; THENCE N35°34'34"W A DISTANCE OF 35.38 FEET; THENCE N00°41'23"W, PARALLEL WITH THE WEST LINE OF SAID SOUTHEAST QUARTER (SE/4), A DISTANCE OF 81.56 FEET TO A POINT OF CURVATURE; THENCE NORTHERLY ALONG A CURVE TO THE RIGHT

HAVING A RADIUS OF 210.00 FEET (SAID CURVE BEING SUBTENDED BY A CHORD WHICH BEARS N18°30'55"E A DISTANCE OF 138.16 FEET) AN ARC DISTANCE OF 140.78 FEET; THENCE N37°43'13"E A DISTANCE OF 323.42 FEET; THENCE S89°44'42"E, PARALLEL WITH THE SOUTH LINE OF SAID SOUTHEAST QUARTER (SE/4), A DISTANCE OF 780.08 FEET; THENCE S00°41'23"E, PARALLEL WITH THE WEST LINE OF SAID SOUTHEAST QUARTER (SE/4), A DISTANCE OF 427.60 FEET; THENCE S65°24'48"W A DISTANCE OF 401.90 FEET TO A POINT ON THE SOUTH LINE OF SAID SOUTHEAST QUARTER (SE/4); THENCE N89°44'42"W, ALONG SAID SOUTH LINE, A DISTANCE OF 638.76 FEET TO THE POINT OF BEGINNING.

BRIEF DESCRIPTION OF PROPOSED SPECIAL PERMIT:

AA Agricultural District creates and preserves areas intended primarily for agricultural purposes. It permits low intensity residential development along with certain essential commercial and institutional uses.

Any person having any interest in the proposed Special Permit may appear before the City Council in the **COUNCIL CHAMBER** on the above date set for hearing and show cause why the proposed Special Permit should or should not be carried out in accordance with said ordinance. Any person may make written protest by filing the same with the Office of the City Clerk, Second Floor, 200 North Walker Avenue, Oklahoma City, Oklahoma 73102.

For further information call (405) 297-2623.

Dated this 3rd day of December 2024.

SEAL

Amy K. Simpson, City Clerk

