

***** ** *****														
16-Nov-22														
CITY OF OKC CIVIC CENTER														
OKLAHOMA CITY, OK														
CHANGE ORDER 1: RFI 8 NEW FLASHING AT PARAPET														
FSB														
CODE	DESCRIPTION				QUANTITY	UNIT	cost	MATERIAL	cost	LABOR	cost	EQUIPMENT	cost	SUB-CONTR.
***** ** *****														
DIV. 4	MASONRY	SPEC						MATERIAL		LABOR		EQUIPMENT		SUB-CONT.
***** ** *****														
4000	RFI 8 New Flashing at Parapet					SF		0.00		0.00		0.00		8,910.00 EPS
TOTALS:								0.00		0.00		0.00		8,910.00
***** ** *****														
SUMMARY								MATERIAL		LABOR		EQUIPMENT		SUB-CONT.
***** ** *****														
DIV. 4	MASONRY							0.00		0.00		0.00		8,910.00
TOTALS ("On-Job Cost")								0.00		0.00		0.00		8,910.00
***** ** *****														
ESTIMATE SUMMARY														
TOTAL MATERIAL								0.00						
TOTAL LABOR (PAYROLLS)								0.00						
TOTAL EQUIPMENT & MISC								0.00						
TOTAL SUB-CONTRACT								8,910.00						
SUB-TOTAL (ON-JOB COST)								8,910.00						
SALES TAX ON MATERIALS								FACTOR:	0.0863	0.00				
TAX ON PAYROLLS								FACTOR:	35%	0.00				
FRINGES ON PAYROLLS								FACTOR:	14%	0.00				
1010	ALL INSURANCE EXCEPT BUILDER RISK							FACTOR:	11.15	134.00				
1011	BUILDER'S RISK ON INCREASE TO TIME							FACTOR:	0.015	0.00				
BUILDERS RISK ON CHANGE ORDER AMOUNT									0.015	12.61				
1008	SPECIAL COVERAGES - INSURANCE									0.00				
1070	BUILDING PERMITS & FEES							FACTOR:	0.28 SF	0.00				
SUB-TOTAL (ACTUAL COST)								9,056.61						
1030	BOND PREMIUM - SUBCONTRACTORS							FACTOR:	3 %	267.00				
1020	BOND PREMIUM - GENERAL CONTRACT									99.00				
MAINTENANCE BOND										15.60				
SUB-TOTAL (ADJUSTED JOB COST)								9,438.21						
OVERHEAD/PROFIT						15 %		1,416.00						
TOTAL								10,854.21						



Elevated Pavers & Stone

4 NE 10th Street #428 Oklahoma City, OK 73104

www.okEPS.com

PROJECT PROPOSAL

PROJECT: Civic Center Music Hall Exterior Restoration
Oklahoma City, OK

Scope: Additional Flashing at Parapets

Pricing Request: PR02

Date: 11/11/2022

EPS will supply, except as noted, all material, labor, supervision and equipment to remove and apply new flashing at the parapet caps. All quantities are based on the attached marked-up drawing.

Scope of Work

Remove existing flashing and install new low flashing per detail 5/A500 and EPS11.2 in response to RFI008.

Clarifications & Bid Assumptions

1. This proposal will be listed as part of the contract documents.
2. Reference EPS Subcontract dated 4/5/22 for additional clarification.
3. Sales tax is included.
4. Costs of permits, if required, are excluded.
5. Elevated Pavers & Stone is a certified Woman Owned Business in the state of Oklahoma.

Pricing

EPS will perform the above stated scopes of work for the following cost:

Price: \$ 8,910.00

Thank you for the opportunity to submit this proposal. We are confident that you will be pleased with EPS's execution of this project in regards to safety, quality, workmanship, and compliance with the construction schedule. For additional information or clarification, I may be reached at (405) 301-9669.

Nathan Ritter
EPS

11/11/2022

Date

Flashing Dimensions

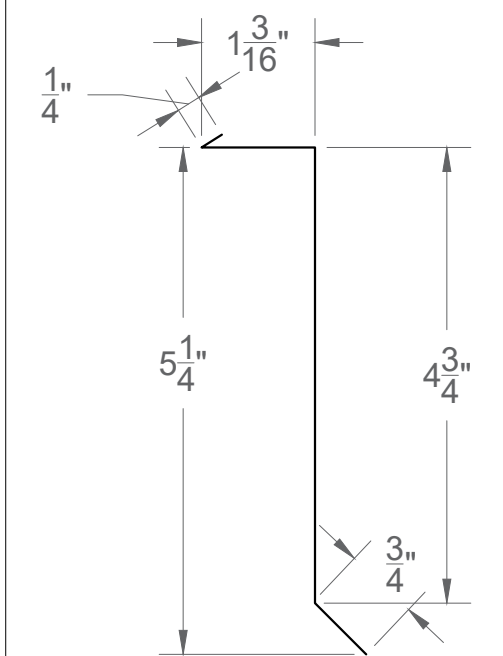

01 Low Parapet Flashing

EPS11.2 Scale: 6" = 1'-0"

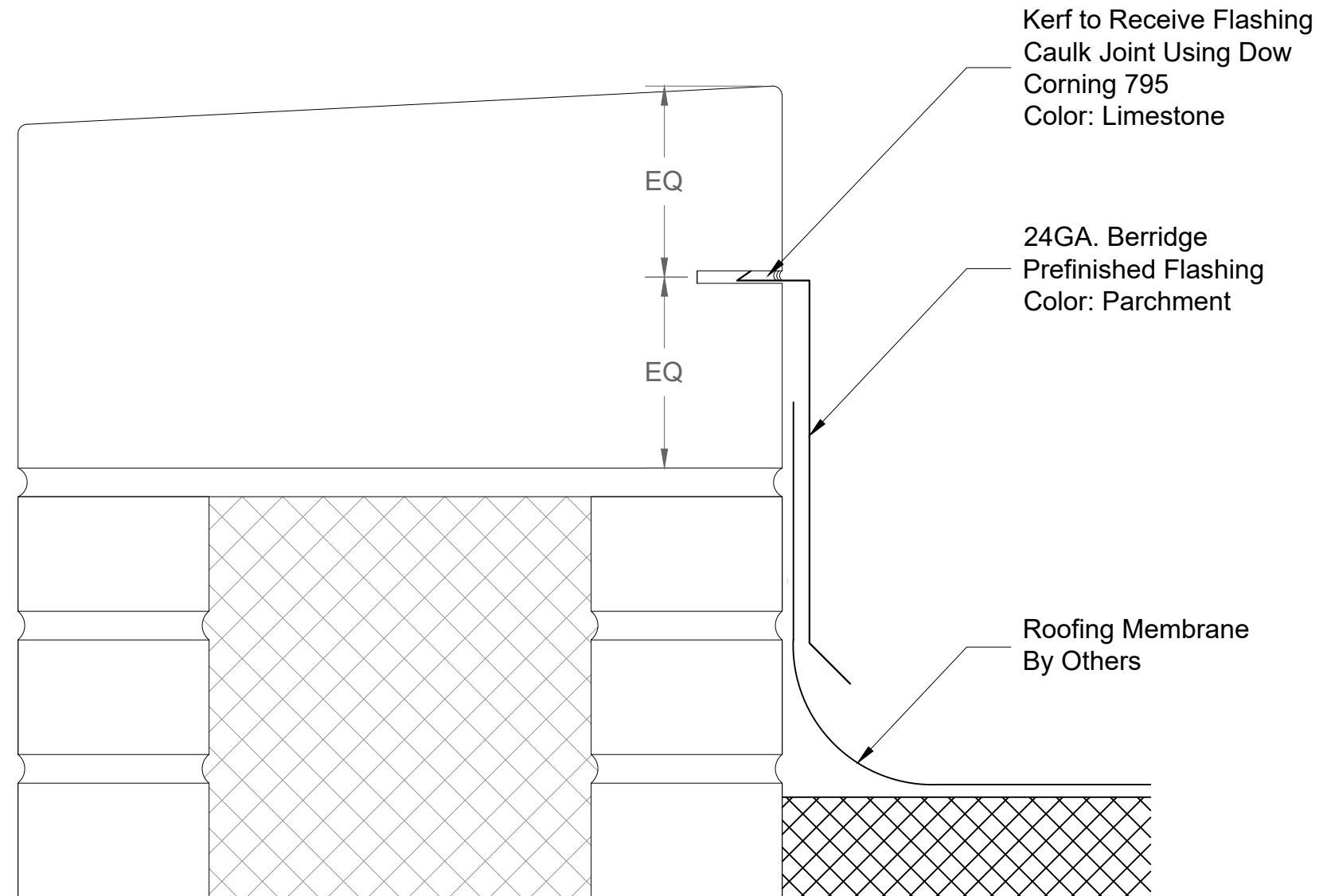

Elevated Pavers & Stone

4 NE 10th Street #428 Oklahoma City, OK 73104

www.okEPS.com

Date	08.16.22
Job Name	CCMH Exterior Renovation
Rev. No.	REV 2
Drawing No.	EPS11.2

***** ** *****														
16-Nov-22														
CITY OF OKC CIVIC CENTER														
OKLAHOMA CITY, OK														
CHANGE ORDER 2: ADD SEALANT TO HORIZONTAL SURFACES														
FSB														
CODE	DESCRIPTION				QUANTITY	UNIT	cost	MATERIAL	cost	LABOR	cost	EQUIPMENT	cost	SUB-CONTR.
***** ** *****														
DIV. 4	MASONRY	SPEC						MATERIAL		LABOR		EQUIPMENT		SUB-CONT.
***** ** *****														
4000	ADD SEALANT TO HORIZONTAL SURFACE OF PARAPET CAP							0.00		0.00		0.00		8,680.00 EPS

TOTALS:							0.00		0.00		0.00		8,680.00	
***** ** *****														
SUMMARY							MATERIAL		LABOR		EQUIPMENT		SUB-CONT.	
***** ** *****														
DIV. 4	MASONRY						0.00		0.00		0.00		8,680.00	

TOTALS ("On-Job Cost")							0.00		0.00		0.00		8,680.00	
***** ** *****														
ESTIMATE SUMMARY														
TOTAL MATERIAL							0.00							
TOTAL LABOR (PAYROLLS)							0.00							
TOTAL EQUIPMENT & MISC							0.00							
TOTAL SUB-CONTRACT							8,680.00							

SUB-TOTAL (ON-JOB COST)							8,680.00							
SALES TAX ON MATERIALS						FACTOR:	0.0863	0.00						
TAX ON PAYROLLS						FACTOR:	35%	0.00						
FRINGES ON PAYROLLS						FACTOR:	14%	0.00						
1010	ALL INSURANCE EXCEPT BUILDER RISK					FACTOR:	11.15	134.00						
1011	BUILDER'S RISK ON INCREASE TO TIME					FACTOR:	0.015	0.00						
BUILDERS RISK ON CHANGE ORDER AMOUNT							0.015	12.61						
1008	SPECIAL COVERAGES - INSURANCE							0.00						
1070	BUILDING PERMITS & FEES					FACTOR:	0.28 SF	0.00						

SUB-TOTAL (ACTUAL COST)							8,826.61							
1030	BOND PREMIUM - SUBCONTRACTORS					FACTOR:	3 %	260.00						
1020	BOND PREMIUM - GENERAL CONTRACT							99.00						
MAINTENANCE BOND								15.60						

SUB-TOTAL (ADJUSTED JOB COST)							9,201.21							
OVERHEAD/PROFIT 15 %							1,380.00							

TOTAL							10,581.21							



Elevated Pavers & Stone

4 NE 10th Street #428 Oklahoma City, OK 73104

www.okEPS.com

PROJECT PROPOSAL

PROJECT: Civic Center Music Hall Exterior Restoration
Oklahoma City, OK

Scope: Sealer Application on Parapet Caps

Pricing Request: PR03

Date: 11/11/2022

EPS will supply, except as noted, all material, labor, supervision and equipment to apply sealer on the horizontal surface of all parapet caps. All quantities are based on the attached marked-up drawing.

Scope of Work

Apply Drylok Siloxane 7 Penetrating Sealer on the horizontal surface of all parapet caps.

Clarifications & Bid Assumptions

1. This proposal will be listed as part of the contract documents.
2. Reference EPS Subcontract dated 4/5/22 for additional clarification.
3. Sales tax is included.
4. Costs of permits, if required, are excluded.
5. Elevated Pavers & Stone is a certified Woman Owned Business in the state of Oklahoma.

Pricing

EPS will perform the above stated scopes of work for the following cost:

Price: **\$8,680.00**

Thank you for the opportunity to submit this proposal. We are confident that you will be pleased with EPS's execution of this project in regards to safety, quality, workmanship, and compliance with the construction schedule. For additional information or clarification, I may be reached at (405) 301-9669.

Nathan Ritter
EPS

11/11/2022

Date

CHANGE ORDER 3: REPAIR PARAPET CAPS

COST CODE	DESCRIPTION	QUANTITY	UNIT	MATERIAL COST	LABOR COST	EQUIPMENT COST
DIV. 4	MASONRY SPEC			MATERIAL	LABOR	EQUIPMENT
	REPAIR AND PATCH SPALLING AT PARAPET CAPS	SF		0.00	0.00	0.00
	TOTALS:			0.00	0.00	0.00
	SUMMARY			MATERIAL	LABOR	EQUIPMENT
DIV. 4	MASONRY			0.00	0.00	0.00
	TOTALS ("On-Job Cost")			0.00	0.00	0.00
	ESTIMATE SUMMARY					
	TOTAL MATERIAL			0.00		
	TOTAL LABOR (PAYROLLS)			0.00		
	TOTAL EQUIPMENT & MISC			0.00		
	TOTAL SUB-CONTRACT			29,700.00		
	SUB-TOTAL (ON-JOB COST)			29,700.00		
	SALES TAX ON MATERIALS	FACTOR:	0.0863	0.00		
	TAX ON PAYROLLS	FACTOR:	35%	0.00		
	FRINGES ON PAYROLLS	FACTOR:	14%	0.00		
1010	ALL INSURANCE EXCEPT BUILDER RISK	FACTOR:	11.15	413.00		
1011	BUILDER'S RISK ON INCREASE TO TIME BUILDERS RISK ON CHANGE ORDER AMOUNT	FACTOR:	0.015	0.00		
			0.015	38.86		
1008	SPECIAL COVERAGES - INSURANCE			0.00		
1070	BUILDING PERMITS & FEES	FACTOR:	0.28 SF	0.00		
	SUB-TOTAL (ACTUAL COST)			30,151.86		
1030	BOND PREMIUM - SUBCONTRACTORS	FACTOR:	3 %	891.00		
1020	BOND PREMIUM - GENERAL CONTRACT MAINTENANCE BOND			306.00		
				48.10		
	SUB-TOTAL (ADJUSTED JOB COST)			31,396.96		
	OVERHEAD/PROFIT	15 %		4,710.00		
	TOTAL			36,106.96		

***** ** *****

29-Nov-22

CITY OF OKC CIVIC CENTER
OKLAHOMA CITY, OK

CHANGE ORDER 4: FLYHOUSE CORNERS REPAIR

FSB

CODE	DESCRIPTION	QUANTITY	UNIT	cost	MATERIAL	cost	LABOR	cost	EQUIPMENT	cost	SUB-CONTR.
DIV. 4	MASONRY	SPEC			MATERIAL		LABOR		EQUIPMENT		SUB-CONT.
	RESET LIMESTONE IN SE CORNER		SF		0.00		0.00		0.00		9,150.00 EPS
	VERTICAL CRACK REPAIR		100 LF		0.00		0.00		0.00	190	19,000.00 APPROX.
TOTALS:					0.00		0.00		0.00		28,150.00
	SUMMARY				MATERIAL		LABOR		EQUIPMENT		SUB-CONT.
DIV. 4	MASONRY				0.00		0.00		0.00		28,150.00
TOTALS ("On-Job Cost")					0.00		0.00		0.00		28,150.00
ESTIMATE SUMMARY											
	TOTAL MATERIAL				0.00						
	TOTAL LABOR (PAYROLLS)				0.00						
	TOTAL EQUIPMENT & MISC				0.00						
	TOTAL SUB-CONTRACT				28,150.00						
SUB-TOTAL (ON-JOB COST)					28,150.00						
	SALES TAX ON MATERIALS		FACTOR:	0.0863	0.00						
	TAX ON PAYROLLS		FACTOR:	35%	0.00						
	FRINGES ON PAYROLLS		FACTOR:	14%	0.00						
1010	ALL INSURANCE EXCEPT BUILDER RISK		FACTOR:	11.15	1,227.00						
1011	BUILDER'S RISK ON INCREASE TO TIME		FACTOR:	0.015	0.00						
	BUILDERS RISK ON CHANGE ORDER AMOUNT			0.015	115.51						
1008	SPECIAL COVERAGES - INSURANCE				0.00						
1070	BUILDING PERMITS & FEES		FACTOR:	0.28 SF	0.00						
SUB-TOTAL (ACTUAL COST)					29,492.51						
1030	BOND PREMIUM - SUBCONTRACTORS		FACTOR:	3 %	845.00						
1020	BOND PREMIUM - GENERAL CONTRACT				1,466.00						
	MAINTENANCE BOND				143.00						
SUB-TOTAL (ADJUSTED JOB COST)					31,946.51						
OVERHEAD/PROFIT 15 %					4,792.00						
TOTAL					36,738.51						

CITY OF OKC CIVIC CENTER
OKLAHOMA CITY, OK

12-Jan-23

CHANGE ORDER 5: DOOR MODIFICATION

FSB

CODE	DESCRIPTION	QUANTITY	UNIT	cost	MATERIAL	cost	LABOR	cost	EQUIPMENT	cost	SUB-CONTR.
DIV. 1	GENERAL CONDITIONS										
PAGE 1											
1101	SUPERVISION /TRUCK	1.5	WKS		0.00	2,100	3,150.00	500	750.00		0.00 *
1115	SAFETY INSPECTOR	0.3488372	MO.		0.00		0.00		0.00	750	262.00 *
1137	PROJECT FENCE REMOBILIZATION		LF		0.00		0.00		0.00		2,000.00 *
1157	FIELD OFFICE SUPPLIES	0.5	MO.	800.00	400.00	35.00	18.00		0.00		0.00 *
1161	ICE/WATER	0.5	MO.	50.00	25.00	50.00	25.00		0.00		0.00 *
TOTALS:					425.00		3,193.00		750.00		2,262.00
DIV. 1	GENERAL CONDITIONS-TOOLS/EQUIPME SPEC				MATERIAL		LABOR		EQUIPMENT		SUB-CONT.
1203	SMALL TOOLS		FORMULA		0.00		0.00		166.00		0.00 *
1211	GAS/TRUCK EXPENSE		FORMULA		300.52		0.00		0.00		0.00 *
TOTALS:					300.52		0.00		166.00		0.00
DIV. 8	DOORS, WINDOWS, GLASS, HARDWARE SPEC				MATERIAL		LABOR		EQUIPMENT		SUB-CONT.
8100	TEMP DUST/WEATHER CONTROL		EA	500.00	0.00	480.00	0.00	200	0.00		0.00 *
8101	VERTICAL FRAME PIECES				-2,239.00		IN CONTRACT		IN CONTRACT		0.00 *
8101	ADD AUTO OPERATOR		PC		4,377.00		960.00		450.00		0.00 *
8103	WELD FRAMES		HRS		0.00		0.00		0.00		6,375.00 JOHSTON
	DECORATIVE TRIM				NEXT CO		0.00		0.00		0.00 *
TOTALS:					2,138.00		960.00		450.00		6,375.00
DIV. 9	FINISHES		SPEC		MATERIAL		LABOR		EQUIPMENT		SUB-CONT.
9100	METALLIC PAINT				0.00		0.00		0.00		7,948.00 ADVANCED
9110	PAINT INTERIOR OF FRAMES				0.00		0.00		0.00		8,600.00 ADVANCED
TOTALS:					0.00		0.00		0.00		16,548.00
SUMMARY					MATERIAL		LABOR		EQUIPMENT		SUB-CONT.
DIV. 1	GENERAL CONDITIONS				425.00		3,193.00		750.00		2,262.00
DIV. 1	TOOLS & EQUIPMENT				300.52		0.00		166.00		0.00
DIV. 8	DOORS, WINDOWS, GLASS				2,138.00		960.00		450.00		6,375.00
DIV. 9	FINISHES				0.00		0.00		0.00		16,548.00
TOTALS ("On-Job Cost")					2,863.52		4,153.00		1,366.00		25,185.00
ESTIMATE SUMMARY											
TOTAL MATERIAL					2,863.52						
TOTAL LABOR (PAYROLLS)					4,153.00						
TOTAL EQUIPMENT & MISC					1,366.00						
TOTAL SUB-CONTRACT					25,185.00						
SUB-TOTAL (ON-JOB COST)					33,567.52						
SALES TAX ON MATERIALS					FACTOR: 0.0863		246.98				
TAX ON PAYROLLS					FACTOR: 35%		1,453.55				
FRINGES ON PAYROLLS					FACTOR: 14%		581.42				
1010	ALL INSURANCE EXCEPT BUILDER RISK				FACTOR: 11.15		736.00				
1011	BUILDER'S RISK ON INCREASE TO TIME				FACTOR: 0.015		1,530.00				
BUILDERS RISK ON CHANGE ORDER AMOUNT					0.015		69.31				
1008	SPECIAL COVERAGES - INSURANCE						0.00				
1070	BUILDING PERMITS & FEES				FACTOR: 0.28 SF		0.00				
SUB-TOTAL (ACTUAL COST)					38,184.78						
1030	BOND PREMIUM - SUBCONTRACTORS				FACTOR: 3 %		756.00				
1020	BOND PREMIUM - GENERAL CONTRACT						546.00				
MAINTENANCE BOND							85.80				
SUB-TOTAL (ADJUSTED JOB COST)					39,572.58						
OVERHEAD/PROFIT 15 %							5,936.00				
TOTAL					45,508.58						

EXTENDS PROJECT TO SPRING FOR LEAD TIME AND SLOWS DOWN
PROGRESS ON DOORS TO ADD 15 DAYS TO SUPERVISION/GC

QUOTATION

All
Commercial
Openings, Inc.

DATE: 11/9/2022

To: **WYNN**

Job: CIVIC CENTER

Attn: **RICKY**

Location: OKLAHOMA CITY, OK

THIS QUOTE IS VALID FOR 15 CALENDAR DAYS

DUE TO THE VOLATILITY OF RAW MATERIAL AND THE RISING COST OF FREIGHT, ALL QUOTES ARE SUBJECT TO REVISION AT ANYTIME BASED UPON THE CURRENT MARKET.

FOLLOWING THE 15 DAYS PRICES ARE SUBJECT TO CHANGE DUE TO SURCHARGES IMPOSED ON PRICING, FREIGHT, OR DELIVERY AT THE TIME OF PURCHASE.

ITEM DESCRIPTION	AMOUNT
PR 02	
DEDUCT FOR CHANGES TO HOLLOW METAL FRAMES	
2" FACES - 22 TOTAL (OUTSIDE LEGS)	
3" CENTER POSTS - 25 TOTAL	
NO HEADERS	<2,239.00>

THIS QUOTE SUPERCEDES ALL PREVIOUS QUOTES FOR CHANGES TO HOLLOW METAL
PREVIOUS QUOTED DEDUCTS NOT ALLOWED
ALL FIELDWORK & WELDING BY OTHERS

NO CHANGES TO DOORS OR HARDWARE

QUOTE MUST BE SIGNED AND RETURNED WITH PURCHASE ORDER / CONTRACT. THIS WILL SERVE AS
ACKNOWLEDGEMENT THAT YOU HAVE READ AND AGREE TO OUR TERMS AS STATED BELOW.
IN THE EVENT OF CONFLICT OUR TERMS WILL SUPERCEDE ANY / ALL OTHER VERBAL OR WRITTEN
CONTRACTS, AGREEMENTS OR COMMUNICATION.

WE ACKNOWLEDGE ADDENDUM #:

PAYMENT TERMS ARE NET 30 FOR ESTABLISHED ACCOUNT HOLDERS

THIS IS A MATERIAL ONLY BID. THEREFORE, BONDS, CO-INSURANCE, INSTALLATION, FIELD WORK,
TAXES, LIQUIDATED DAMAGES AND RETAINAGE ARE EXCLUDED UNLESS NOTED OTHERWISE. IF ANY
OF THESE TERMS ARE REQUIRED THERE MAY BE ADDITIONAL CHARGES.

DELIVERY WILL BE ADDITIONAL COST AND WILL BE F.O.B. JOB-SITE

TERMS: See Above

ACCEPTED _____
DATE: _____

BY: Stacey Slade
Stacey Slade

All Commercial Openings, Inc.
4605 N. Stiles ▪ Oklahoma City, OK 73105 ▪ 405-789-6396 ▪ Fax 405-789-0175
staceyaco6396@yahoo.com

QUOTATION

All
Commercial
Openings, Inc.

DATE: 8/25/2022

To: **WYNN**

Job: CIVIC CENTER

Attn: **RICKY THOMPSON/STVEHAL**

Location: OKLAHOMA CITY, OK

THIS QUOTE IS VALID FOR **15** CALENDAR DAYS

DUE TO THE VOLATILITY OF RAW MATERIAL AND THE RISING COST OF FREIGHT, ALL QUOTES ARE SUBJECT TO REVISION AT ANYTIME BASED UPON THE CURRENT MARKET.

FOLLOWING THE **15** DAYS PRICES ARE SUBJECT TO CHANGE DUE TO SURCHARGES IMPOSED ON PRICING, FREIGHT, OR DELIVERY AT THE TIME OF PURCHASE.

ITEM DESCRIPTION		AMOUNT
ADD PER RETURNED SUBMITTALS	LUMP SUM	\$4,377.00
ADD LCN 4642 REGARM AUTO OPERATOR TO OPENING # E109		

NOTE: ARCHITECT SPEC'D OPERATOR 4060 - THAT IS NO LONGER A VALID PART #.

QUOTE DOES **NOT** INCLUDE ANY ACCESSORIES; SUCH AS ACTUATORS, POWER SUPPLIES, ETC.

QUOTE MUST BE SIGNED AND RETURNED WITH PURCHASE ORDER / CONTRACT. THIS WILL SERVE AS ACKNOWLEDGEMENT THAT YOU HAVE READ AND AGREE TO OUR TERMS AS STATED BELOW. IN THE EVENT OF CONFLICT OUR TERMS WILL SUPERCEDE ANY / ALL OTHER VERBAL OR WRITTEN CONTRACTS, AGREEMENTS OR COMMUNICATION.

WE ACKNOWLEDGE ADDENDUM #:

PAYMENT TERMS ARE NET 30 FOR ESTABLISHED ACCOUNT HOLDERS

THIS IS A MATERIAL ONLY BID. THEREFORE, BONDS, CO-INSURANCE, INSTALLATION, FIELD WORK, TAXES, LIQUIDATED DAMAGES AND RETAINAGE ARE EXCLUDED UNLESS NOTED OTHERWISE. IF ANY OF THESE TERMS ARE REQUIRED THERE MAY BE ADDITIONAL CHARGES.

DELIVERY WILL BE ADDITIONAL COST AND WILL BE F.O.B. JOB-SITE

TERMS: See Above

ACCEPTED _____
DATE: _____

BY: Stacey Slade
Stacey Slade

All Commercial Openings, Inc.
4605 N. Stiles ▪ Oklahoma City, OK 73105 ▪ 405-789-6396 ▪ Fax 405-789-0175
staceyaco6396@yahoo.com



*****JOB BID SHEET*****

JOHNSTON WELDING & FABRICATION
14501 SW 104TH STREET
MUSTANG, OK 73064
(405) 476-8673 OFFICE
(405) 361-4886 CELL

johnstonwelding@aol.com / www.johnstonwelding.com

PROJECT: CIVIC CENTER
GC: WYNN CONSTRUCTION CO.
PM: RICKY THOMPSON

BID DATE: 11/18/22

DESCRIPTION OF WORK TO BE COMPLETED: BID IS PER DETAIL BELOW. IF BID IS ACCEPTED / AWARDED JOB WILL BE BUILT PER BELOW DETAILED BID AND/OR SHOP DRAWINGS IF REQUIRED. SHOULD BELOW DETAILED BID AND/OR SHOP DRAWINGS NOT REFLECT ACTUAL INTENT, AND/OR MATERIALS FOR CONSTRUCTION PER SPECS OR DIRECTION OF GENERAL CONTRACTOR, CONSTRUCTION MANAGER, ARCHITECT, AND/OR OWNER, AND/OR IF ENGINEER STAMP IS REQUIRED FOR DRAWINGS IT IS THE RESPONSIBILITY OF THE ABOVE MENTIONED, WHICHEVER IS APPLICABLE, TO REQUEST A REVISED BID WITH ACTUAL MATERIALS FOR CONSTRUCTION REQUIRED AND RESPONSIBILITY OF GC/ CONSTRUCTION MANAGER / ARCHITECT /OWNER TO OBTAIN ENGINEER STAMP FOR DRAWINGS.

BID ITEM A -

QTY 47 – DOOR FRAME SECTIONS REMOVE & INSTALL NEW. MULTIPLE TRIPS EACH LOCATION HAS 4-5 OPENINGS AND EACH LOCATION HAS TO BE DONE SEPARATELY PER GC. GC PROVIDING ALL MATERIALS. GC/OWNER TO PROVIDE ANY NECESSARY EQUIPMENT/LIFTS FOR INSTALL. BID FOR LABOR ONLY: \$12,750.00

(IF THERE IS ANYTHING IN OUR SCOPE WE OVERLOOKED PLEASE LET US KNOW AND WE WILL BE HAPPY TO PROVIDE A BID FOR THOSE ITEMS.)

PLEASE NOTE: ALL ITEMS TO BE SHOP FABRICATED, PRIMED, AND INSTALLED UNLESS OTHERWISE SPECIFICALLY NOTED. ALL ITEMS HAVE BEEN BID WITH HIS BRAND PRIME & PAINT PRODUCTS. IF SPECS REQUIRE OTHER FINISH PRICE WILL BE ADJUSTED ACCORDINGLY. GC/OWNER IS RESPONSIBLE FOR PROVIDING ANY EQUIPMENT/LIFTS NECESSARY FOR INSTALL AND/OR ANY ENGINEER STAMPS UNLESS SPECIFICALLY QUOTED IN BID. QUOTE IS VALID FOR 10 DAYS FROM BID DATE ABOVE AND IS SUBJECT TO CHANGE DUE TO ANY MODIFICATIONS MADE TO MATERIALS, PRICE INCREASE IN STEEL/MATERIALS, DESIGN AND/OR INSTALL PRIOR TO COMPLETION AND PAYMENT IN FULL. ANY CHANGES THAT INCREASE WC, GL, OR CA INSURANCE POLICIES WILL BE SUBMITTED AS EXPENSES TO BE PAID BY GC/OWNER. GC/OWNER(S) THAT HAVE REQUIREMENTS FOR CERTIFICATES OF INSURANCE MUST DO SO PRIOR TO ANY AND ALL WORK COMMENCING. PAYMENT IS NOT TO BE DELAYED/DENIED FOR INSURANCE REQUIREMENTS ONCE WORK COMMENCES ALL JWF CURRENT INSURANCES ARE CONSIDERED ACCEPTED PER THIS BID WHICH IS MADE A PART OF ANY APPLICABLE CONTRACT/AGREEMENT/PURCHASE ORDER. COMMERCIAL CONTRACT JOBS W/GC OR CM PAYMENT DUE IN MONTHLY PROGRESS PAYMENTS & REMAINING BALANCE DUE UPON COMPLETION. PRIVATE OWNER OR RESIDENTIAL WITHOUT GC OR CM WITH CONTRACT PAYMENT IS DUE ½ PRIOR TO START DATE OF JOB AND REMAINING BALANCE UPON ARRIVAL TO INSTALL.

ACCEPTED AND AGREED TO BY:

SIGNATURE

DATE

5500 N Western Ave, Suite 146 Oklahoma City, OK 73118 - Off: 405-227-9412 Fax 405-213-1492

Change Order Request

GC: Wynn Construction

Project: CIVIC CENTER MUSIC HALL EXTERIOR IMPROVEMENTS

Address: 11901 N Eastern Ave OKC OK 73131

Location: 201 N Walker Ave Oklahoma City OK

Attn: Ricky Thompson

Supply and Install the following Items

1. Supply and install - additional labor and material for the new paint system as indicated

Labor:

\$3,440.00

Material

\$4,508.00

Total: \$7,948.00

Inclusions	Exclusions & Qualifications
<p>Clean up to a central location.</p> <p>All sealants per our scope to create smooth paint transitions.</p> <p>Removal of hazardous materials from sites.</p>	
<p>* ACP will provide supervision and management of its work, equipment for its use and clean up of our debris for disposal into an on-site receptacle. The Trash receptacle and its expense are to be -provided by others.</p> <p>* Hourly rate \$43.00</p>	<p>*Any premium expense for shift of overtime labor, or unnecessary and unproductive labor required as a result of any acceleration of schedule or as a result of delays caused by others is excluded. All temporary enclosure, lighting ventilation, heating and/or utilities are exclude from bid, though they may be required for proper installation of certain materials</p>
Acknowledgements	Sales Tax: Included

Submitted by: *Gerson Vasquez*

Company Rep. Wynn Construction

Signature to proceed _____



Date 11/4/2022

Spreadsheet Civic Center CO #1

Bid date MATERIALS		Quantity	cost	Total
Primer - Shop Primer - Spot primer		7	\$ 45.00	\$ 315.00
Paint (Pro Industrial Urethane Alkyd Enamel)		15	\$ 43.64	\$ 654.60
				Total \$ 969.60
New Paint system				
Extreme Bond Primer		7	\$ 70.00	\$ 490.00
Medium Alkyd Enamel color Non Leafing#624-10		15	\$ 182.50	\$ 2,737.50
Clear coat		15	\$ 150.00	\$ 2,250.00
				ToTal \$5,477.50
				ADD \$4,507.90
Additional Labor Man				
Clear Coat		2	8	5 \$43.00 ADD \$3,440.00

Thank you

5500 N Western Ave, Suite 146 Oklahoma City, OK 73118 - Off: 405-227-9412 Fax 405-213-1492

Change Order Request# 2.1

GC: Wynn Construction

Project: CIVIC CENTER MUSIC HALL EXTERIOR IMPROVEMENTS

Address: 11901 N Eastern Ave OKC OK 73131

Location: 201 N Walker Ave Oklahoma City OK

Attn: Ricky Thompson

Supply and Install the following Items

1. Supply and install - Paint system for the interior Windows Frames above the doors

Labor:

\$6,400.00

Material

\$2,200.00

Total: \$8,600.00**Inclusions****Exclusions & Qualifications**

Clean up to a central location.

All sealants per our scope to create smooth paint transitions.

Removal of hazardous materials from sites.

* ACP will provide supervision and management of its work, equipment for its use and clean up of our debris for disposal into an on-site receptacle. The Trash receptacle and its expense are to be -provided by others.

* Hourly rate \$43.00

*Any premium expense for shift of overtime labor, or unnecessary and unproductive labor required as a result of any acceleration of schedule or as a result of delays caused by others is excluded. All temporary enclosure, lighting ventilation, heating and/or utilities are exclude from bid, though they may be required for proper installation of certain materials

Acknowledgements**Sales Tax: Included**Submitted by: *Gerson Vasquez*

Company Rep. Wynn Construction

Signature to proceed _____