



The City of Oklahoma City
Development Services Department, Subdivision and Zoning
420 West Main Street, Suite 910, Oklahoma City, Oklahoma, 73102
Phone: (405) 297-2623 – Web: <https://www.okc.gov>

APPLICATION FOR REZONING

Central Avenue and East Wilshire Blvd.

Project Name 7722 North Central Avenue

13 lots located East of Cental Ave and South of East Wilshire Blvd.

Address / Location of Property to be Rezoned

Industrial Development

Purpose Statement / Proposed Development

I-2

Proposed Zoning District

Staff Use Only:	10970
Case No.: PC -	
File Date:	2-27-25
Ward No.:	W7
Nbhd. Assoc.:	-----
School District:	OKC
Extg Zoning:	R-1
Overlay:	

Undeveloped; R-1

Present Use of Property

3.22 Acres

ReZoning Area (Acres or Square Feet)

REQUIREMENTS FOR SUBMITTAL:

- ☐ One (1) Typed Legal Description of Proposed Rezoning area in MS Word file (.doc or .docx) format.
- ☐ One (1) copy of Recorded Deed(s), with Exhibit(s), listing current Property Owner in .pdf format.
- ☐ One (1) copy of Letter of Authorization from Property Owner listing Designated Representative, if Applicant is not the Property Owner of record.
- ☐ One (1) copy of Property Owners Report listing all property owners who own property within a 300-foot buffer area of the property to be rezoned. The list **MUST** include the mailing address and the legal description of their property and **MUST** be current to within 30 days of the date of submittal of the application. A minimum of 10 separate individual property owners is required. If there are less than 10 individual owners within the 300-foot buffer, the radius must be extended by increments of 100 feet until the list contains no less than 10 owners. Provide One (1) PDF (.pdf) file version, AND one (1) MS Excel (.xls or .xlsx) file version.
- ☐ One (1) Signed and Notarized copy of "Affirmation" that the Property Owners Report listings are true and correct unless the list is prepared by a Certified Abstractor or County official.
- ☐ Maps, Site Plan and, or Survey Exhibits must be Letter size (8.5" x 11"), 600dpi minimum resolution, and in a .pdf file format. Photographic file formats of drawings, maps, or other documents will not be accepted.
- ☐ A filing fee of \$1500.00 must be remitted within One (1) business day of submittal confirmation.

Property Owner Information (if other than Applicant):

Name

Mailing Address

City, State, Zip Code

Phone

Email

David Box
Signature of Applicant

Box Law Group, PLLC, on behalf of Applicant
Applicant's Name (please print)

525 NW 11th St., Ste. 205

Applicant's Mailing Address

Oklahoma City, OK 73103

City, State, Zip Code

405-652-0099

Phone

mckenna@boxlawgroup.com; kaitlyn@boxlawgroup.com; david@boxlawgroup.com
Email

Submit your Application by Email to Subdivisionandzoning@OKC.gov
Compressed files (.zip, etc..) or links to FileShare services (Dropbox, etc..) can not be accepted for security purposes.

FEB-21-78

14104

Aad —

58.40

300 4439 PG1331

This Space Reserved For
Filing StampWARRANTY DEED
Special Form

KNOW ALL MEN BY THESE PRESENTS:

That Richard William Garrett a/k/a R. W. Garrett and Aline J. Garrett,
husband and wife; and Otis Garrett a/k/a S. O. Garrett and Elba J.
Garrett, husband and wife of Oklahoma County, State of Oklahoma,
parties of the first part, in consideration of the sum of
TEN AND NO/100 - - - - - DOLLARS

in hand paid, the receipt of which is hereby acknowledged, does hereby
 Grant, Bargain, Sell and Convey unto GARRETT COMPANY (A
General Partnership)

of 4409 N. Classen Blvd., Okla. City, Oklahoma County, State of
Oklahoma, parties of the second part the following described real
 property and premises situate in Oklahoma County, State of
Oklahoma, to-wit:

Alta Vista Second Block 1 Lots 11 & 12
 Alta Vista Second Block 2 Lots 24 - 25 - 26 - 27
 Altavue Addition Block 7 Lot 17
 Apex Addition Block 6 Lots 5 & 6
 Arcadia Addition Block 8 Lot 22
 Arcadia Addition Block 19 Lot 2
 Arcadia Addition Block 26 Lot 21
 Augusta Heights Addition Block 4 Lots 25 - 26
 Aungst Addition Block 4 Lot 9
 Aungst Addition Block 4 Lot 11
 Ayers Place Sub. Block 2 Lot 15 Except Railroad R/W

Bath Orchard Addition Block 8 Lot 30
 Belforts Addition Block 2 Lots 20-21
 Belle View Addition - Block 4 Lots 29 - 30
 Belle Isle View Addition - Block 8 Lots 15 - 16 - 17 - 18
 Belle View Addition - Block 3 Lots 43 - 44
 Belle View Addition - Block 4 Lots 11 - 12 - 13 - 14
 Belle View Addition - Block 4 Lots 17 - 18
 Belle View Addition - Block 4 Lots 25 - 26 - 27 - 28

STATE OF OKLAHOMA
 OKLAHOMA COUNTY
 REC'D FEB 21 9 16 AM '78
 CECIL PARHAM
 OKLA. COUNTY CLERK

Belle View Addition - Block 4 Lots 33 - 34 - 35
Belle View Addition - Block 4 Lot 38
Belle View Addition - Block 4 Lot 39
Belle View Addition - Block 5 - Lots 7 - 8
Belle View Addition - Block 5 Lots 9 - 10
Belle View Addition - Block 5 Lot 27
Belle View Addition - Block 5 Lots 32 - 33
Belle View Addition - Block 7 Lots 11 - 12 - 13
Belle View Addition - Block 7 Lot 22
Belle View Addition - Block 9 Lots 1 - 2 - 3 - 4
Belle View Addition - Block 9 Lots 29 - 30
Belle View Addition - Block 9 Lots 33 - 34
Belle View Addition - Block 9 Lots 43 - 44
Belle View Addition - Block 12 Lot 22
Belle View Addition - Block 12 - Lots 24 - 25
Belle View Addition - Block 12 Lot 27
Belle View Addition - Block 16 Lot 9
Belle View Addition - Block 16 Lot 40
Biltmore Heights Addition - Block 3 Lot 51
Boulevard Heights Addition - Block 2 Lots 8 - 9
Boulevard Heights Addition - Block 2 Lots 24 - 25
Boulevard Heights Addition - Block 3 Lots 19 - 20
Boulevard Heights Addition - Block 3 Lots 38 - 39
Boulevard Heights Addition - Block 4 Lots 32 - 33
Boulevard Heights Addition - Block 5 Lots 33 - 34
Boulevard Heights Addition - Block 6 Lots 1 - 2
Boulevard Heights Addition - Block 6 Lots 11 - 12
Britton City Second Addition - Block 31 Lots 13 - 14 - 15
Britton City Second Addition - Block 31 Lot 16
Britton City Second Addition - Block 36 Lots 3 - 4
Britton City Second Addition - Block 36 Lot 18
Britton City Second Addition - Block 41 Lots 1 - 2
Britton City Second Addition - Block 41 Lot 3
Britton City Second Addition - Block 41 Lots 13 thru 18
Britton Park Addition - Block 3 Lots 15 - 16 - 17 - 18

Britton Park Addition - Block 6 Lots 1 - 2
Britton Park Addition - Block 7 Lots 5 - 6
Britton Park Addition - Block 7 Lots 11 - 12
Britton Park Addition - Block 9 Lots 5 - 6
Britton Park Addition - Block 9 Lot 13
Britton Park Addition - Block 9 Lot 16
Britton Park Addition - Block 9 Lots 58 - 59
Britton Park Addition - Block 9 Lots 60 - 61
Britton Park Addition - Block 9 Lot 67
Britton Park Addition - Block 12 - Lots 8 - 9
Britton Park Addition - Block 12 Lot 10
Britton Park Addition - Block 12 Lots 50 - 51 - 52 - 53
Britton Park Addition - Block 17 Lots 32 - 33
Burnham Addition - Block 1 Lots 11 - 12 - 13 - 14
Burnham Addition - Block 1 Lot 38
Burtondale Addition - Block 7 Lots 25 - 26 - 27 - 28
Burtons Sub. of Blk 133/138 North Omaha City, Block 3 Lots 14 - 15
Burtons Sub. Blk 133/138 N OC - Block 3 Lot 22
Burtons Sub. Blk 133/138 N OC - Block 3 Lot 23
Burtons Sub. Blk 133/138 N OC - Block 6 Lots 19 - 20
Burtons Sub Blk 133/138 N OC - Block 6 Lots 21 - 22
Burtons Sub. Blk 133/138 N OC - Block 8 Lots 1 - 2 - 3
Capitol Courts Addition - Block 6 Lot 13
Capitol Place Sub. - Block 8 Lots 7 - 8 - 9 - 10
Capitol Place Sub - Block 8 - Lots 19 - 20 - 21
Capitol View Third Add. Block 16 - W 38 ft. Lot 10 & E 15 ft. Lot 11
Caulks Victory Sub. Block 000 - Lot 418
Central Addition - Block 2 Lots 10 - 11
Central Addition - Block 2 Lots 23 - 24
Central Addition - Block 4 Lot 7
Central Addition - Block 4 Lot 8
Central Addition - Block 4 Lots 10 - 11 - 12 - 13 - 14 - 15
Central Addition - Block 4 Lot 18
Central Addition - Block 4 Lots 46 - 47
Central Addition - Block 4 Lot 48

BOOK 4459 PG 1334

Central Addition - Block 7 Lot 7
 Central Addition - Block 8 Lots 3 - 4 - 5
 Central Addition - Block 8 Lot 6
 Central Addition - Block 8 Lot 7
 Central Addition - Block 8 Lots 30 - 31
 Central Addition - Block 8 Lots 37 - 38
 Central Addition - Block 8 Lots 44 - 45
 Central Addition - Block 8 Lots 49 - 50
 Central Addition - Block 9 Lots 26 - 27 South 90'
 Central Addition - Block 9 Lots 10 - 11 - 12 - 13
 Central Addition - Block 9 Lots 15 - 16
 Central Addition - Block 2 Lots 27 - 28
 Central Addition - Block 9 Lots 26 - 27 N 45 ft.
 Central Addition - Block 9 Lots 37 - 38 - 39
 Central Addition - Block 10 Lot 14
 Central Addition - Block 11 Lot 13
 Central Addition - Block 12 Lot 21
 Central Addition - Block 15 Lots 7 - 8
 Central Addition - Block 15 Lot 27
 Central Addition - Block 15 Lots 28 - 29 - 30
 Central Addition - Block 15 Lots 32 - 33
 Central Addition - Block 16 Lots 6 - 7
 Central Addition - Block 16 Lot 8
 Central Addition - Block 16 Lots 9 - 10 - 11
 Central Addition - Block 16 Lot 37
 Central Addition - Block 17 Lots 39 - 40
 Central Addition - Block 18 Lots 22 - 23 - 24
 Central Addition - Block 23 Lots 1 - 2 - 3
 Central Addition - Block 23 Lots 6 - 7 - 8 - 9 - 10 - 11
 Central Addition - Block 23 Lot 12
 Central Addition - Block 23 Lots 13 - 14 - 15
 Central Addition - Block 23 - Lots 16 - 17
 Central Addition - Block 23 Lots 18 - 19
 Central Addition - Block 23 Lots 20 - 21 - 22 - 23
 Central View Heights - Block 2 Lots 44 - 45

Chester Hill Addition - Block 1 Lots 19 - 20
Chester Hill Addition - Block 1 Lot 41
Chester Hill Addition - Block 1 Lots 42 - 43
Chester Hill Addition - Block 2 Lot 15
Chester Hill Addition - Block 2 Lot 18
Chester Hill Addition - Block 2 Lots 43 - 44 - 45
Chester Hill Addition - Block 2 Lot 48
Chester Hill Addition - Block 4 Lot 22
Chester Hill Addition - Block 4 Lots 23 - 24
Chester Hill Addition - Block 4 Lots 43 - 44
Chester Hill Addition - Block 5 Lots 5 - 6
Chester Hill Addition - Block 5 Lots 13 - 14
Chester Hill Addition - Block 5 Lots 19 - 20
Chester Hill Addition - Block 5 Lots 41 - 42
Chester Hill Addition - Block 5 Lots 47 - 48
Chester Hill Addition - Block 7 Lots 7 - 8
Chester Hill Addition - Block 7 Lots 41 - 42
Chester Hill Addition - Block 10 Lots 1 - 2
Chester Hill Addition - Block 10 - Lots 5 - 6
Chester Hill Addition - Block 10 Lots 15 - 16
Choctaw Old Town Addition - Block C Lot 000
Choctaw Old Town Addition - Block D Lot 000
Choctaw Old Town Addition - Block 28 Lot 18
Choctaw Old Town Addition - Block 28 Lot 22
City View Addition - Block 2 Lots 29 - 30
City View Addition - Block 2 Lots 43 - 44
City View Addition - Block 3 Lots 1 - 2
City View Addition - Block 3 Lots 11 - 12
City View Addition - Block 4 - Lots 3 - 4
City View Addition - Block 4 Lots 41 - 42
City View Addition - Block 6 Lot 42
Classen Third Addition - Block 002 Lots 31 - 32
Coleys Sub. Addition - Block 32 Lots 21 - 22
Coleys Sub. Addition - Block 32 Lots 23 - 24

Coleys Sub Addition - Block 32 Lots 25 - 26
Coleys Sub Addition - Block 32 Lots 29 - 30
Coleys Sub Addition - Block 32 Lots 31 - 32
Coleys Sub Addition - Block 33 Lots 17 - 18 - 19 - 20
Coleys Sub Addition - Block 41 Lots 15 - 16
College Hill Add. - Block 5 Lots 1 - 2
College Hill Add. - Block 5 Lot 4
College Hill Add. - Block 5 Lot 5
College Hill Add. - Block 5 Lots 6 - 7
College Hill Add. - Block 5 Lot 8
College Hill Add. - Block 5 Lot 9
College Park Addition - Block 13 - Lots 30 - 31 - 32
Belle Isle View Addition - Block 8 Lot 14
Britton City First - Block 16 N 24 ft. of E 50 ft of W 416.3 ft of S 164 ft.
Central Addition - Block 9 Lots 28 - 29 - 30
City View Addition - Block 4 Lots 47 - 48
Belle View Addition - Block 4 Lots 21 - 22 - 23 - 24
College Park Addition - Block 14 - Lots 13 - 14 - 15 - 16
College Park Addition - Block 17 Lot 31
College Park Addition - Block 21 Lots 22 - 23
College Park Addition - Block 28 Lots 19 - 20
College Park Addition - Block 34 Lots 1 - 2 - 3 - 4 - 5 - 6
College Park Addition - Block 34 Lots 31 - 32 - 33 - 34
College Park Addition - Block 35 Lots 27 - 28
College Park Addition - Block 36 Lots 19 - 20
College Park Addition - Block 37 Lots 10 - 11
College Park Addition - Block 37 Lots 20 - 21
College Park Addition - Block 45 Lots 35 - 36
College Park Addition - Block 54 Lots 11 - 12
College Park Addition - Block 55 Lots 20 - 21
College Park Addition - Block 55 Lots 26 - 27
College Park Addition - Block 56 Lots 1 - 2 - 3 - 4
College Park Addition - Block 70 Lots 1 - 2 - 3 - 4
College Park Addition - Block 70 Lots 45 - 46
College Park Addition - Block 76 Lots 41 - 42

College Park Addition - Block 87 Lots 9 - 10 - 11 - 12
College Park Addition - Block 87 Lots 25 - 26 - 27 - 28
College Park Addition - Block 91 Lots 15 - 16
College Park Addition - Block 91 Lots 39 - 40
College Park Addition - Block 103 - Lots 28 - 29 - 30
College Park Addition - Block 105 Lots 25 - 26
College Park Addition - Block 105 Lots 31 - 32
Colonial Heights Addition - Block 9 Lots 26 - 27
Corbin Park Addition - Block 16 Lots 43 - 44
J. W. Craig Sub. Addition - Block 001 Lots 7 - 8
J. W. Craig Sub. Addition - Block 001 Lots 15 - 16
Creamer Heights Addition - Block 7 Lots 19 thru 30 Ex. W Pt. to State
Being 75 ft. on N. Line and 102 ft on S. Line
Creamer Heights Addition - Block 7 Lots 35 - 36 - 37 - 38
Culbertson E. Highland - Block 10 Lots 31 - 32
Days Hassman Pk. Addition - Block 3 Lots 8 - 9
Delaporte Second Addition - Block 6 Lot 1
Delaporte Second Addition - Block 7 Lot 2
Deluxe Sub. Addition - Block 000 Lots 118 - 119
Deluxe Sub. Addition - Block 000 Lot 310
Deluxe Sub Addition - Block 000 Lot 317 W/2
Douglas Pl. Addition - Block 28 All of Lots 35 - 36
East Britton Addition - Block 33 Lots 41 - 42
East Britton Addition - Block 34 - Lots 3 - 4
East Britton Addition - Block 34 Lots 26 - 27
East Britton Addition - Block 34 - Lots 28 - 29 - 30 - 31 - 32 - 33
East Britton Addition - Block 43 - Lots 24 - 25 - 26 - 27
East Grand Avenue Addition - SW 4 of SE 4 Sec. 34 12N 3W Desc. as Fols - Beg.
at 1/4 Sec Cor of the S. line of Sec 34 12N 3W which
Pt. is 2672.4 ft. W of the SE/C of Sd Sec TH in a
Dir toward Center of Sd Sec 34 to the S line of the
R/W of Co & G RY TH E Along S Line of Sd R/W a
distance of 20.85 Ft to W Line of 2nd Riverside
and TH E Along Sd W Side to S Line of Sec. 34 TH W
a Dist of 32.4 ft to Sd 1/4 Sec Cor & Pt of Beg Ex
that portion land included in the NK&T Ry..The above
land was not included in Plat of 2nd Riverside Add.
Eckdol Heights Addition - Block 3 Lots 17 - 18
Eckdol Heights Addition - Block 4 Lots 9 - 10
Eckdol Heights Addition - Block 4 Lots 15 - 16 - 17 - 18 - 19 - 20
Eckdol Heights Addition - Block 4 Lots 23 - 24
Eckdol Heights Addition - Block 4 - Lots 31 thru 36 Ex a Tri on Sly Side of
Lot 36 being 25 ft on E side & 35.27 ft on N LY side.

Eckdol Heights - Block 11 Lot 1
Eckdol Heights - Block 11 Lot 2
Eckdol Heights - Block 11 Lot 3
Eckdol Heights - Block 11 Lot 4
Eckdol Heights - Block 11 Lots 5 - 6 - 7 - 8
Eckdol Heights - Block 11 Lots 11 thru 20
Eckdol Heights - Block 11 Lots 25 thru 40
Eckdol Heights - Block 12 - Lots 5 - 6
Eckdol Heights - Block 12 Lots 13 - 14
Eckdol Heights Sub. - Block 12 Lots 21 - 22
Eckdol Heights Sub. - Block 12 Lots 43 - 44
Electric Heights Addition - Block 1 Lots 23 - 24 - 25
Electric Heights Addition - Block 2 Lots 7 - 8
Electric Heights Addition - Block 2 Lots 33 - 34
Electric Heights Addition - Block 3 Lots 1 - 2 - 3 - 4
Electric Heights Addition - Block 3 Lots 28 - 29
Electric Heights Addition - Block 4 Lots 4 - 5
Electric Heights Addition - Block 4 Lots 6 - 7 - 8
Electric Heights Addition - Block 4 Lots 12 - 13
Electric Heights Addition - Block 4 Lot 18
Electric Heights Addition - Block 4 Lots 26 - 27
Electric Heights Addition - Block 5 Lots 27 - 28 - 29 - 30
Electric Heights Addition - Block 6 Lots 1 - 2
Electric Heights Addition - Block 6 Lots 3 - 4
Electric Heights Addition - Block 6 Lots 13 - 14
Electric Heights Addition - Block 6 Lot 15
Electric Heights Addition - Block 6 Lots 16 - 17 - 18
Electric Heights Addition - Block 6 Lots 19 - 20
Electric Heights Addition - Block 6 Lot 21
Electric Heights Addition - Block 7 Lot 5 - 6
Electric Heights Addition - Block 7 Lots 19 - 20 - 21 - 22 - 23 - 24
Estes Park Addition - Block 3 Lots 25 - 26 - 27 - 28
Estes Park Addition - Block 7 Lots 27 - 28 - 29 - 30
Estes Park Addition - Block 9 Lot 3
Estes Park Addition - Block 9 Lot 4

Estes Park Addition - Block 9 Lots 8 - 9
Estes Park Addition - Block 9 Lots 10 - 11
Estes Park Addition - Block 9 Lots 12 - 13
Estes Park Addition - Block 9 Lots 14 - 15 - 16
Estes Park Addition - Block 9 Lots 17 - 18
Estes Park Addition - Block 9 Lots 19 - 20
Estes Park Addition - Block 9 Lot 21
Estes Park Addition - Block 9 Lots 27 - 28
Estes Park Addition - Block 9 Lots 41 - 42 - 43 - 44
Ethels Park Place - Block 6 Lots 1 - 2 - 3 - 4
Ethels Park Place - Block 6 Lots 45 - 46 - 47 - 48
Evans Heights Addition - Block 6 Lots 43 - 44 - 45 - 46
Evans Heights Addition - Block 7 Lots 17 - 18
Evans Heights Addition - Block 8 Lots 1 - 2 - 3 - 4
Evans Heights Addition - Block 8 Lots 11 - 12
Evans Heights Addition - Block 8 Lots 13 - 44
Evans Heights Addition - Block 8 Lots 47 - 48
Floral Park Addition - Block 1 Lot 13
Floral Park Addition - Block 1 Lots 14 - 15 - 16
Floral Park Addition - Block 3 Lots 7 - 8
Floral Park Addition - Block 3 Lots 9 - 10
Floral Park Addition - Block 3 Lots 17 - 18 - 19 - 20
Floral Park Addition - Block 3 Lots 21 - 22
Floral Park Addition - Block 3 Lots 33 - 34
Floral Park Addition - Block 4 Lots 17 - 18
Floral Park Addition - Block 4 Lot 37
Floral Park Addition - Block 4 Lot 38
Floral Park Addition - Block 5 Lots 1 - 2
Floral Park Addition - Block 5 Lot 5
Floral Park Addition - Block 7 Lot 10
Floral Park Addition - Block 7 Lots 15 - 16
Floral Park Addition - Block 7 Lots 17 - 18
Floral Park Addition - Block 8 Lot 5
Floral Park Addition - Block 8 Lot 26
Floral Park Addition - Block 9 Lot 12
Floral Park Addition - Block 10 Lots 9 - 10
Floral Park Addition - Block 11 Lots 21 - 22

BC 4439 PC 1340

Floral Park Addition - Block 11 Lot 41
Forest Park Sub Addition - Block 000 Lot 82
Frost Heights Addition - Block 7 Lots 5 - 6
Fruitland Addition - Block 000 Vine St. Vacated 33 ft by 300 ft N of E
300 Ft. of Lot 17
Fruitland Addition - Block 18 Lot 000
Glenaire Addition - Block 9 Lot 20
Glenaire Addition - Block 9 Lot 23 - 24 - 25 - 26
Glenaire Addition - Block 17 Lots 1 - 2 except North 7 ft.
Glenaire Addition - Block 27 Lots 19 - 20
Glenaire Addition - Block 32 Lot 1
Glenaire Addition - Block 32 Lots 2 - 3 - 4
Glenaire Addition - Block 32 - Lot 5
Glenaire Addition - Block 32 Lot 6
Glenaire Addition - Block 32 Lots 7 - 8 - 9 - 10
Glenaire Addition - Block 36 Lots 17 - 18 except North 17 ft/
Glenaire Addition - Block 36 Lots 18 - 39 - 40 - 41
Grand View Addition - Block 1 Lot 19
Green Pasture Addition - Block 000 Lot 33
Green Pastures Addition - Block 000 Lot 101
Green Pastures Addition - Block 000 Lot 593 W/2
Green Pastures Addition - Block 000 Lot 601
Green Pastures Addition - Block 000 Lot 602
Green Pastures Addition - Block 000 Lot 916
Hampton Place Addition - Block 2 E 16 ft. Lot 18 and W 17 ft. Lot 19
Hampton Place Addition - Block 002 East 8 ft. Lot 19 and All Lot 20
Hardy Acres Addition - Block 003 Lot 008 N/ 1/3
Harrah City Addition - Block 004 Lot 024
Hassman Heights Addition - Block 2 Lot 13
Hatchers Sub Addition - Block 2 Lot 2
Hatchers Sub Addition - Block 2 Lot 4
Hatchers Sub Addition - Block 2 Lot 23 except S 10 ft.
Hatchers Sub Addition - Block 2 Lot 24 except S. 10 ft.
Henderson Heights - Block 6 Lots 3 - 4

Henderson Heights - Block 6 Lots 33 - 34 Henderson Heights - Block
Henderson Heights - Block 6 Lots 49 - 50
Henderson Heights - Block 9 Lots 17 - 18
Hicks Addition - Block 2 Lot 10
Hicks Addition - Block 2 Lot 11
Highland View Addition - Block 1 Lot 63
Highland View Addition - Block 8 W 40 ft. of Lots 7 thru 12 & 10 ft.
strip adj. on W.
Highland View Addition - East 50 ft. Block 8 - Lots 7 - 8 - 10 - 11 - 12
Highland View Addition - Block 17 Lots 7 - 8 - 9 - 10
Highland View Addition - Block 17 Lots 11 - 12
Highland View Addition - Block 24 Lots 1 - 2
Highland View Addition - Block 24 Lots 3 - 4 - 5 - 6
Highland View Addition - Block 25 W 40 ft. Lots 1 - 2 - 3 - 4 - 5 - 6
and 5' of alley
Highland View Addition - Block 25 Lot 61
Hillwood Farms Addition - Block 80 Lot 00
Hillwood Farms Addition - Block 80 Lot 000
Homedale Addition - Block 2 Lots 50 - 51
Homedale Addition - Block 6 Lots 41 - 42
Homedale Addition - Block 7 Lots 23 - 24
Homedale Addition - Block 7 Lots 41 - 42 - 43 - 44
Homedale Addition - Block 8 Lots 21 - 22 except North 12 ft.
Homedale Addition - Block 12 Lots 7 - 8
Homedale Addition - Block 12 Lots 19 - 20
Homedale Addition - Block 12 Lots 21 - 22
Homedale Addition - Block 18 Lots 9 - 10
Houghton Heights Addition - N 37.5 ft of W 1/2 Block 3 Lot 9
Hughes Park Addition - Block 9 Lots 41 - 42 - 43 - 44
Hughes Park Addition - Block 12 Lots 5 - 6
Hurst Addition - Block 1 Lots 7 - 8
Hurst Addition - Block 1 Lots 13 - 14
Hurst Addition - Block 1 Lots 18 - 19
Hurst Addition - Block 1 Lots 37 - 38
Hurst Addition - Block 2 Lots 1 - 2
Hurst Addition - Block 2 Lots 3 - 4
Hurst Addition - Block 2 Lots 5 - 6

4439 PG 1342

Hurst Addition - Block 2 Lots 9 - 10
Hurst Addition - Block 2 Lots 11 - 12
Hurst Addition - Block 2 Lots 13 - 14
Hurst Addition - Block 2 Lots 15 - 16
Hurst Addition - Block 2 Lots 33 - 34 - 35 - 36
Hurst Addition - Block 2 Lots 37 - 38 - 39 - 40
Hurst Addition - Block 2 Lots 41 - 42
Hurst Addition - Block 2 Lots 43 - 44
Hurst Addition - Block 2 Lots 45 - 46
Hurst Addition - Block 2 Lots 47 - 48
Hurst Addition - Block 4 Lots 38 - 39
Hurst Addition - Block 4 Lots 43 - 44
Hurst Addition - Block 4 Lots 45 - 46 - 47 - 48
Industrial Blvd. Replat. Except W 12 ft. Block 6 Lot 29
Industrial Addition - Block 54 Lots 15 - 16 - 17
Industrial Addition - Block 69 Lot 45
Ingleside Second Addition - Block 4 Lots 1 thru 32
Ingleside Second Addition - Block 9 Lots 17 thru 26
Iowa Addition - Block 6 Lot 29
Irvington Addition - Block 1 Lot 40
Irvington Addition - Block 2 Lots 37 - 38
Jackson Sub Addition - Block 1 Lots 25 - 26 Except N 17 ft.
Kanalys First Addition - Block 2 Lot 6
Kanalys N.E. 38th Oak Park - Block 1 Lot 18
Kirkwood Addition - Block 4 Lots 1 - 2 - 3 - 4 - 5
LaBorn Addition - Block 14 Lot 15 EX A Triangular Tract in SW/4 Being 20.16 ft
on W and 39 ft on S
Lake View Park Addition - Block 2 Lots 35 - 36
Lake View Park Addition - Block 7 Lot 33
Lawrence Place Addition - Block 2 Lots 27 - 28
Lewis Sub Addition - Block 2 Lots 26 - 27 - 28
Lewis Sub Addition - Block 2 Beg At SE/4 Lot 31 NW L Y 229.33 ft S -
181.4 ft East 140 ft to Beg.
Liberty Addition - Block 5 Lot 6
Liberty Addition - Block 5 Lot 7

Liberty Addition - Block 5 Lot 10
 Liberty Addition - Block 5 Lot 11
 Louis Heights Sub Eckdol - Block 9 Lots 13 - 14 - 15 - 16 - 17 - 18
 Louis Heights Sub Eckdol - Block 9 Lots 25 - 26
 McNabb Park Addition - Block 10 - Lot 11
 McNabb Park Addition - Block 10 Lot 15
 McNabb Park Addition - Block 14 Lot 5
 McNabb Park Addition - Block 15 Lot 2
 Markland Heights Addition - Block 16 Lot 39
 Maywood Addition - Block 11 Lots 19 - 20
 Milam Place Addition - S 50' Block 7 Lot 21
 Milams Sub Addition - Block 1 Lot 13
 Milams N. W. Highlands - Block 18 Lot 29
 Military Addition - S 22.86 ft Block 2 Lot 7
 Military Addition - Block 6 Lots 20 - 21 N 50'
 Military Addition - S 90 ft Block 6 Lots 20- 21
 Military Addition - Block 16 Lot 27 - W. 10'
 Military Addition - E 15 ft Block 16 Lot 27
 Military Park Addition - Block 36 Lots 33 - 34
 Mitchers Lincoln Park - N 50' of S 90' of Block 13 Lots 1 thru 5
 Moores Boulevard Addition - Block 12 Lots 7 - 8 - 9
 Moores Boulevard Addition - Block 13 Lots 28 - 29
 Moores Heights Addition - Block 19 Lots 4 - 5 - 6
 Morgans Addition - Sub of Jewel Heights - Block 2 Lots 16 - 17
 Morning View Heights - Block 000 Lot 90
 Morris Heights Addition - Block 3 Lots 5 - 6 - 7 South 85'
 Morris Heights Addition - Block 3 Lots 8 - 9 South 85'
 Morris Heights Addition - Block 3 Lot 10 S 85'
 Morris Place Addition - Block 2 Lots 20 - 21
 Morrison Addition - Block 6 Lots 29 - 30 S 1/2 of Vacated Alley adj.
 on North
 Neas Addition - Block 23 Lots 23 - 24 S/2
 Neffs Capitol Addition - Block 4 Lots 13 - 14
 Newalla City Addition - Block 1 Lots 1 thru 48
 Newalla City Addition - Block 2 Lots 1 thru 10

Newalla City Addition - Block 2 Lot 26
Newalla City Addition Block 9 Lots 10 thru 24
Newalla City Addition - Block 10 E 1/2 Less RR
Newalla City Addition - Block 12 Lot All
Newalla City Addition - Block 16 Lot 7
Newalla City Addition - Block 21 Lot 32
Newalla City Addition - Block 22 Lots 1 thru 21 & 23 thru 30 & 32
Newalla City Addition - Block 24 Lots 1 - 2
Newalla City Addition - Block 24 Lots 3 - 4
Newalla City Addition - Block 24 Lots 5 thru 7
Newalla City Addition - Block 24 Lot 8
Newalla City Addition - Block 24 Lots 9 - 10 - 11
Newalla City Addition - Block 25 Lot 5
Newalla City Addition - Block 25 Lots 6 - 7 and 9
Newalla City Addition - Block 25 Lot 26
Newalla City Addition - Block 26 Lots 17 - 18 - 19 - 20 - 21
Newalla City Addition - Block 29 Lots 1 thru 10 and 12 thru 24
Newalla City Addition - Block 62 Lots 1 thru 25 and 27 thru 32
Newalla City Addition - Block 70 Lots 1 thru 7
Newalla City Addition - Block 70 Lots 9 thru 32
Newalla City Addition - Block 70 Lots 33 - 34
New Chance City Addition - Block 000 Lot 9
New Chance City Third Addition - Block 000 Lot 401
North Oklahoma City Addition - Block 113 Lots 5 - 6
North Oklahoma City Addition - Block 114 Lot 29
North Oklahoma City Addition - Block 114 Lot 30
North Oklahoma City Addition - Block 119 Lots 20 - 21
Northeast Heights Addition - Block 1 Lots 5 - 6
Northeast Heights Addition - Block 1 Lots 11 - 12
North Highland Addition - Block 20 Lot 29
North Highland Addition - Block 38 Lot 12
Oak View Addition - Block 2 Lots 4 - 5 - 6
Oak View Addition - Block 2 Lots 11 thru 18
Oak View Addition - Block 2 Lots 27 thru 34
Oak View Addition - Block 4 Lots 5 thru 15

4439 PC1345

Oak View Addition - Block 4 Lots 24 - 25 - 26
 Oak View Addition - Block 4 Lots 31 - 32 - 33
 Oak View Addition - Block 4 Lots 40 - 43
 Offields Addition - Block 2 Lots 20 - 21 - 22 - 23 - 24
 Oklahoma Heights Addition - Block 2 Lot 14
 Orndale Addition - Block 2 Lots 16 - 17
 Orndale Addition - Block 10 Lot 10 N 22.5 ft.
 Orndale Addition - Block 23 Lots 1 and E/2 of Lot 2
 Packinghouse Park - Block 5 Lots 7 - 8
 Packinghouse Park Addition - Block 5 Lot 9
 Packinghouse Park Addition - Block 6 Lots 43 - 44
 Packinghouse Park Addition - Block 6 Lots 45 - 46
 Packinghouse Park Addition - Block 8 Lots 11 - 12
 Packinghouse Park Addition - Block 13 Lots 25 - 26
 Packinghouse Park Addition - Block 13 Lot 27
 Packinghouse Park Addition - Block 13 Lots 30 - 31
 Packinghouse View Addition - Block 5 W 15 ft of Lot 1 and all of Lot 2 and
 E 10 ft. of Lot 3
 Packinghouse View Addition - Block 15 E 10' Lot 40, All Lot 41, W15' Lot 42 ex
 S 5' of Lots 43 - 41 - 42
 Park Heights Addition - Block 3 Lots 11 - 12
 Patrick Moore Sub Addition - Block 3 Lots 36 - 37
 Patrick Moore Sub Addition - Block 3 Lots 39 - 40 - 41
 Patrick Moore Sub Addition - Block 3 Lots 44 - 45
 Patrick Moore Second Addition - Block 2 Lots 9 - 10 - 11 - 12
 Patrick Moore Third - Block 1 Lots 26 - 27
 Patrick Moore Third - Block 1 Lots 28 - 29 - 30 - 31 - 32
 Patrick Moore Third - Block 3 Lots 20 - 21
 Pattens First Addition - Block 1 Lot 24
 Plain View Heights - Block 11 Lots 23 - 24
 Powells Sub Addition - Block 1 Lots 1 - 2
 Powells Sub Addition - Block 1 Lot 3 ex 15' by 15' and all of Lot 4
 Prime Sub Addition - Block 5 Lots 13 - 14
 Prime Sub Addition - Block 5 Lot 16
 Putnam Heights Addition - Block 70 Lot 36
 Railway to Choctaw City - Block 17 Lots 1 - 2
 Reeds Addition - Block 3 Lots 1 thru 4
 Reeds Addition - Block 5 Lots 16 - 17 - 18
 Reeds Addition - Block 5 Lots 19 - 20 - 21

Richolsons Heights Addition - Block 2 Lots 1 thru 6
 Richolsons Heights Addition - Block 2 Lots 7 thru 11
 Richolsons Heights Addition - Block 2 Lots 47 - 48 - 49
 Rossmore Addition Edmond - Block 2 Lots 1 - 2 - 3 - 4 - 5
 Rossmore Addition Edmond - Block 2 Lots 6 - 7 - 8
 Sadlers Industrial Heights Addition - Block 16 Lot 17
 Sadlers Industrial Heights Addition - Block 16 Lot 18
 Sadlers Sub Addition - Block 1 Lots 17 - 18
 Sadlers Sub Addition - Block 2 Lots 15 - 16
 Schillings Addition - Block 2 Lots 11 - 12
 Schillings Addition - Block 2 Lots 26 - 27
 Schillings Addition - Block 11 Lot 6
 Schillings Addition - Block 11 N 20 ft Lot 10
 Schillings Addition - Block 12 Lot 5
 Schillings Addition - Block 34 All Lot 18 except R/W of AT&SF Ry.
 Shaws Heights Sub. Div - Block 23 S 18' Lot 1 - N 82 ft Lot 2
 Shaws Heights Sub. Division - Block 23 Lot 13
 Shaws Heights Sub. Div. - Block 32 Lots 41 - 42
 Sherwood Park Addition - Block 4 Lot 18
 Sherwood Park Addition - Block 4 Lot 19
 Sherwood Park Addition - Block 5 Lots 13 - 14
 Shields South Oklahoma - Block 81 Lots 5 - 6
 Shields South Oklahoma City - Block 87 Lots 4 thru 9
 Shields South Okla. City - Block 87 Lots 10 - 11
 Shields South Oklahoma City - Block 87 30' strip adj. lots 9-10-11 on E.
 South Highland Addition - Block 8 Lots 5 - 6 - 7 - 8
 South Highland Addition - Block 8 - Lots 11 - 12 - 13 - 14.
 South Highland Addition - Block 8 Lots 23 - 24
 South Highland Addition - Block 9 Lots 21 thru 24
 South Highland Addition - Block 18 - Lots 21 - 22
 South Highland Addition - Block 19 Lots 23 - 24
 South Highland Addition - Block 20 Lots 1 - 2
 South Okla. City Addition - Block 23 Lot 14
 South Park Addition - Block 8 Lot 6
 South Park Addition - Block 14 Lot 15
 South Park Addition - Block 14 Lot 16

4439 PC1347

South Park Addition - Block 14 Lot 17
 South Park Addition - Block 15 Lot 26
 Spence Addition - Block 2 Lot 33
 Spencer Revised Plat - Block A Lot 0
 Spencers South Oklahoma - Block 7 Lots 21 thru 24 ex W 18' 22 - 23
 Spencers South Oklahoma - Block 7 Lot 44
 Spencers South Oklahoma - Block 8 Lots 7 - 8 - 9
 Standers Blvd., - Block 19 Lot 14
 Standers First Addition - Block 3 Lot 1
 Standers First Addition - Block 3 Lot 12
 Stouts Sub Addition - Block 1 - Lot 12 except a tract 12 ft x 12 ft In NE/C
 Sunset Park Addition - Block 5 - Lot 3
 Sunset Park Addition - Block 6 Lot 1
 Surbers First Addition - Block 1 Lot 25
 Tappons Hights Addition - Block 13 Lots 1 thru 5
 Tappons Hights Addition - Block 13 Lots 6 - 7
 Tappons Heights Addition - Block 13 Lots 8 - 9
 Tappons Heights Addition - Block 20 Lot 41
 Teams Sub Addition Alta Vista - Block 6 Lots 23 - 24
 Teams Sub Addition - Block 6 Lots 45 thru 48
 Teams Sub Addition - Block 16 Lots 1 - 2
 Teams Sub Addition - Block 21 Lots 22 - 23
 Terrace Lawn Addition - Block 17 Lots 16 - 20
 Terrace Lawn Addition - Block 17 - Lots 21 - 22
 Terrace Lawn Addition - Block 17 Lots 29 thru 31
 Terrace Lawn Addition - Block 17 Lots 32 - 33
 Terrace Lawn Addition - Block 17 All Lot 42 and W 21.8 ft Lot 43
 Terrace Lawn Addition - Block 17 East 6' Lot 43 and All Lots 44 - 45
 Terrace Lawn Addition - Block 21 Lots 19 - 20
 Terrace Lawn Addition - Block 21 Lot 21
 Terrace Lawn Addition - Block 32 Lots 3 - 4
 Thomas Blvd. Amd Addition - Block 4 Lots 24 thru 26
 Thomas Blvd. Amd Add. - Block 4 Lots 27 - 28
 Thomas Blvd. Amd Add - Block 5 Lots 17 - 18
 Thomas Blvd. Amd Add - Block 15 Lots 27 - 28

4439 PC1348

Thomas Blvd. Amd Add - Block 17 Lots 1 - 2
 Thomas Blvd. Amd Addition - Block 22 Lots 17 - 18
 Thomas Blvd. Amd Add. Block 22 Lots 25 - 26
 Thomas Blvd. Amd Add - Block 28 Lots 17 - 18
 Thomas Blvd. Amd Add - Block 28 Lots 19 - 20
 Thomas Blvd. Amd Add - Block 28 Lots 23 - 24
 Thomas Blvd. Amd Add - Block 28 Lots 25 - 26
 Thomas Blvd. Amd Add - Block 28 Lots 27 - 28
 Thomas Blvd. Amd Add. - Block 28 Lots 29 - 30
 Tontz & Cooper Add. - Block 1 Lots 1 thru 7
 Tontz & Cooper Add. - Block 1 Lots 8 - 9
 Tontz & Cooper Add. Block 1 Lots 10 thru 15
 Tontz & Cooper Add. - Block 1 Lots 17 thru 23
 Tontz & Cooper Add. - Block 1 Lot 24
 Tontz & Cooper Add. - Block 1 Lots 25 thru 36
 Tontz & Cooper Add. - Block 1 Lot 43
 View Point Addition - Block 1 Lots 14 - 15
 Walnut Grove Addition - Block 2 Lots 23 - 24
 Walnut Grove Addition - Block 15 Lots 5 - 6
 Webbs Heights Sub - Block 11 Lot 11
 Webbs Heights Sub. - Block 9 Lot 49
 West End Sub. Div. Addition - Block 2 E 2 ft Lot 21
 West End Sub Div. Add - Block 2 Lot 34
 West Lawn Park Amended - Block 0 Lot 173
 Westminster Replat - Block 0 Lot 7
 West Point Addition - Block 21 W 10 ft of S 139 ft of E 150 ft of N 278 ft.
 Winans Second Addition - Block 2 Lot 5
 Winans Highland Terrace - Block 13 W 25' of Lot 9 & E 25' of Lot 10
 Winans Highland Terrace - Block 13 W 25 ft Lot 10 & E 25' Lot 11
 Witcher Addition - Block 5 Lot 15
 Wright Place Addition - Block 1 Lots 3 thru 12 14 thru 37
 Wright Place Addition - Block 3 Lots 3 thru 11 and 13 thru 42
 Wright Place Addition - Block 3 Lots 12
 Wright Place Addition - Block 7 Lots 13 thru 72
 Wright Place Addition - Block 9 Lots 1 thru 84
 Wright Place Addition - Block 12 Lots 1 thru 5
 Wright Place Addition - Block 12 Lots 13 thru 59
 Wright Place Addition - Block 12 Lots 61 thru 72

P-19

ACQ: 4439 PC1349

Wright Place Addition - Block 12 - Lots 80 thru 84

Wright Place Addition - Block 18 - Lots 13 thru 21

Wright Place Addition - Block 18 - Lots 27 thru 44

Wright Place Addition - Block 18 - Lots 47 thru 74

Wright Place Addition - Block 19 - Lots 1 thru 20 and 23 thru 82

Zedna Ann 3rd Addition - Block 3 - Lot 20

SW/4 Sec 1 - 11N 1E

S/2 of N/2 of N/2 of N/2 of SE4 of NE4 Sec. 8 11N 1E

S/2 of SE4 of NW4 of NE4 Sec. 26 11N 1W

W/2 of SE4 of SW4 of NE4 except N 25 ft of W/2 TR 22 Ramseys Unrecorded
Plat Sec 26 11N 1W

Eckroats 2nd Addn. - Block 2 Beg. 175 ft W SE/C Lot 14 Blk. 2 S125 ft
W 40 ft S100 ft W to R/W NELY to SW/C Lot 14 Blk 2
E to Beginning Point of Sec. 10 11N 3W

Unplatted Part Sec 10 11N 3W Beginning at a Point in NW4 Sec. 10 11N
3W upon the W line of the R/W of the Okla. Ry. Co.
sometimes known as Okla. Juns. Co. Directly W of the
SW/C of Blk. 2 Eckroat 2nd Add. TH in a SWTLY Directly
along W Line of Said R/W to a Point which would be in
the center of 18th St. S projected W Thence W to the
Center of Lightning Creek Thence in a NELY Dir. along
the Center of Lightning Creek to a point Directly W
of Point of Beginning.

Unplatted Part Sec. 10 11N 3W Part of NW4 Sec. 10 - 11N 3W Beginning 50'
W of Intersection of E line of Okla. RR R/W and Center
of Elm Street Thence Southerly to N line Blk. 1 Lyman's
Add. Thence W to Center of Lightning Creek Thence
NELY following Center of Said Creek to Center of Elm
Street if produced W Thence E to Beginning.

Unplatted Part Sec. 10 11N 3W 8/10 Acre - A Strip of Land 50 ft wide
in NW4 Running from N Line Blk. 4 Eckroats 2nd Add.
produced W to Point 363 ft S of N Line of 1/4 Sec.
except Part to Okla. City for S.E. 17th Street/

Unplatted Part Sec. 34 11N 3W Point NE4 Sec. 34 11N 3W Beginning
2640 ft S 2619.3 ft W and 461.26 ft. NWLY Along
N. of NE/C Thence E629.64 ft NWLY 112.82 ft W 629.64
ft SELY 112.82 to Beginning

Unplatted Part Sec. 32 12N 1W Beginning 376 ft E of NW/C of NW4 Thence
S 458 ft E977 ft. N458 ft W977 ft to Beginning

SE SW Sec. 26 12N 1W

Unplatted Part Sec. 32 12N 1W Point Beginning 33 ft S and 33 ft E of
NW/C Thence E 150 ft Thence S200 ft thence W150 ft
Thence N200 ft to Beginning less 7 ft of N40 ft to
County

Unplatted Part Sec. 32 12N 1W Point Beginning 33 ft S and 183 ft E
of NW/C Thence E193 ft Thence S425 ft Thence W343 ft
Thence N225 ft Thence E150 ft Thence N200 ft to
Beginning

REC-4439 PC1350

together with all the improvements thereon and the appurtenances thereunto belonging, and warrant the title to the same to be free, clear and discharged of and from all former grants, charges, taxes, judgments, mortgages and other liens and incumbrances of whatsoever nature made or suffered to be made by the party of the first part.

Consideration for this conveyance is less than \$100.00 and is given to correct and vest title in the beneficial owner, the grantee partnership herein, with whose funds said above described real property was initially purchased as a partnership asset, notwithstanding title was originally conveyed to the grantor herein individually.

TO HAVE AND TO HOLD said described premises unto the said parties of the second part, their heirs and assigns forever.

Signed and delivered this 3rd day of January, 1978

R. W. Garrett
Aline J. Garrett
Otis Garrett
Elba J. Garrett

STATE OF OKLA
COUNTY OF Oklahoma

SS

Individual Acknowledgment
Oklahoma Form

Before me, the undersigned, a Notary Public in and for said County and State on this 3rd day of January, 1978, personally appeared R. W. Garrett, Aline J. Garrett, Otis Garrett and Elba J. Garrett

to me known to be the identical persons who executed the within and foregoing instrument and acknowledged to me that they executed the same as their free and voluntary act and deed for the uses and purposes therein set forth.

Given under my hand and seal the day and year last above written.

My commission expires May 10, 1980 Henry M. Conquest Notary Public

OFFICE OF THE SECRETARY OF STATE



CERTIFICATE OF MERGER

WHEREAS, GARRETT & COMPANY, L.L.C.

State of Oklahoma
County of Oklahoma
Doc Number 2000060751
Bk 7839 Pg 54-54
DATE 05/15/00 13:22:45
Filing Fee \$8.00
Documentary Tax \$0.00
Catalynn Caudill
Oklahoma County Clerk

a limited liability company organized under the laws of the State of OKLAHOMA,
has filed in the office of the Secretary of State duly authenticated evidence of a merger
whereby said limited liability company is the surviving entity, as provided by the laws
of the State of Oklahoma.

NOW THEREFORE, I, the undersigned Secretary of State of Oklahoma, by
virtue of the powers vested in me by law, do hereby issue this Certificate evidencing
such merger.

IN TESTIMONY WHEREOF, I hereunto set my hand and cause to be affixed
the Great Seal of the State of Oklahoma.

RET TO: Garrett & Company
9701 N. Broadway Ext.
OKC, OK 73114

Filed in the City of Oklahoma City this 20TH
day of NOVEMBER, 1926.



Sam Cole
Secretary of State

By: Patricia Caudill

UN



Rec. & Ret. to:

American Eagle Title Group
421 NW 13th St, Suite 320
Oklahoma City, OK 73103

GENERAL WARRANTY DEED

KNOW ALL MEN BY THESE PRESENTS:

That Svoboda Family Trust dated December 19, 1997 ("Grantor"), whose mailing address is 13707 Crossing Way East, Edmond Oklahoma, 73013 in consideration of the sum of Ten and No/100 dollars and other valuable consideration in hand paid, the receipt and sufficiency of which are hereby acknowledged do/does grant, bargain, sell and convey unto Gulf Exploration, LLC an Oklahoma limited liability company ("Grantee") whose mailing address is 9701 N Broadway Ext., Oklahoma City, Oklahoma, the real property and premises situated in Oklahoma County, State of Oklahoma, to-wit:

THE SURFACE ONLY

Lots Seven (7), Eight (8), Forty-nine (49), & Fifty (50) in Block one (1) In Northeast Heights to Oklahoma City , Oklahoma County, Oklahoma according to the plat thereof together with all the improvements thereon and the appurtenances thereunto belonging, and warrant the title to the same.

TO HAVE AND TO HOLD said described premises unto the said part of the second part, its heirs and assigns forever, free, clear and discharged of and from all former grants, charges, taxes, judgments, mortgages and other liens and incumbrances of whatsoever nature.

Signed and delivered this 26th day of January, 2024.

BY:

Mark S. Svoboda
Mark S. Svoboda, Trustee

BY:

Julie G. Svoboda
Julie G. Svoboda, Trustee



PATRICIA L. PANTKE
Notary Public
State of Florida
Comm# HH272056
Expires 6/30/2026

2401-0708-55

COURTESY FILING. NO
LIABILITY IS ASSUMED

4/24

ACKNOWLEDGMENT

STATE OF OKLAHOMA) ~~OKLAHOMA~~ Florida
COUNTY OF OKLAHOMA) ~~OKLAHOMA~~ SS. Seminole

This instrument was acknowledged before me on this 20 day of January, 2024,
by Mark S. Svoboda, Trustee.

Patricia L. Pantke
Notary Public

My Commission Expires:

My Commission No:



PATRICIA L. PANTKE
Notary Public
State of Florida
Comm# HH272056
Expires 6/30/2026

ACKNOWLEDGMENT

STATE OF OKLAHOMA) ~~OKLAHOMA~~ Florida
COUNTY OF OKLAHOMA) ~~OKLAHOMA~~ SS. Seminole

This instrument was acknowledged before me on this 20 day of January, 2024,
by Julie C. Svoboda, Trustee

Patricia L. Pantke
Notary Public

My Commission Expires:

My Commission No:



PATRICIA L. PANTKE
Notary Public
State of Florida
Comm# HH272056
Expires 6/30/2026

OAG 2023-2 – NON-EXEMPT BUSINESS/TRUST

Exhibit to Deed

AFFIDAVIT OF LAND OR MINERAL OWNERSHIP: BUSINESS OR TRUST

[illegible]

TO: THE ATTORNEY GENERAL OF THE STATE OF OKLAHOMA

Before me, the undersigned William P. Gidnett
(list legal name and any aliases) (the "Affiant"), who, having been first duly sworn, deposes and states:

1. I am eighteen (18) years of age or older and have personal knowledge of the statements made herein.
2. I am a/an Manager (role, such as titled officer or trustee) of Gulf Exploration LLC (legal name, along with any trade or fictitious names, of business, trust, or other legal entity) (referred to herein as the "Entity"). I am duly authorized to record this Affidavit on behalf of the Entity, which is taking title to the real property identified in the Deed to which this Affidavit is attached (the "Property"), and to bind the Entity for the consequences of any false statements in this Affidavit.
3. This Affidavit is executed in accordance with and pursuant to 60 O.S. § 121, which provides in part as follows:

No alien or any person who is not a citizen of the United States shall acquire title to or own land in this state either directly or indirectly through a business entity or trust, except as hereinafter provided, but he or she shall have and enjoy in this state such rights as to personal property as are, or shall be accorded a citizen of the United States under the laws of the nation to which such alien belongs, or by the treaties of such nation with the United States, except as the same may be affected by the provisions of Section 121 et seq. of this title or the Constitution of this state. Provided, however, the requirements of this subsection shall not apply to a business entity that is engaged in regulated interstate commerce in accordance with federal law.

4. The Entity acquired title to the Property in compliance with the requirements of 60 O.S. § 121 and no funding source was used in the sale or transfer of the Property in violation of section 121 or any other state or federal law
5. If the Entity is a trust, its grantor(s), trustees and all direct and contingent beneficiaries are United States citizens or bona fide residents of the State of Oklahoma. If the Entity is a business, its direct and indirect owner(s) is/are United States citizens(s) or bona fide residents of the State of Oklahoma.

OAG 2023-2 – NON-EXEMPT BUSINESS/TRUST

6. I acknowledge and understand that making or causing to be made a false statement in this affidavit may subject me to criminal prosecution for perjury and/or subject me and/or the Entity to being liable for actual damages suffered or incurred by any person or other entity as a result or consequence of the making of or reliance upon such false statement.

FURTHER AFFIANT SAYETH NOT

William P. Garrett
AFFIANT, individually and as authorized agent of the Entity Date 1/26/2024

The foregoing instrument was acknowledged before me this 26 day of January, 2024
by William P. Garrett.



My Commission Expires: 7-20-2025

My Commission Number: 05006401

Rec. & Ret. to:
American Eagle Title Group **WARRANTY DEED**
421 NW 13th St, Suite 320
Oklahoma City, OK 73103

Statutory Form

COURTESY FILING NO
LIABILITY IS ASSUMED

KNOW ALL MEN BY THESE PRESENTS:

That Eddie Baker and Shirley Baker, husband and wife, parties of the first part, in consideration of the sum of Two Thousand and One Hundred and No/100 Dollars in hand paid, the receipt of which is hereby acknowledged, does hereby Grant, Bargain, Sell and Convey unto Garrett and Company, LLC, party of the second part, the following described real property and premises situate in Oklahoma County, State of Oklahoma, to-wit:

Lots 9 and 10, in Block 1,

Northeast Heights Addition to Oklahoma City, Oklahoma County, according to the recorded plat thereof.

together with all the improvements thereon and the appurtenances thereunto belonging, and warrant the title to the same.

TO HAVE AND TO HOLD said described premises unto the said parties of the second part, their heirs and assigns forever, free, clear and discharged of and from all former grants, charges, taxes, judgments, mortgages and other liens and encumbrances of whatsoever nature.

Signed and delivered this 12th day of August, 2016.

20160912011285760
09/12/2016 01:16:36 PM
Bk:RE13225 Pg:589 Pgs:1 DEED
State of Oklahoma
County of Oklahoma
Oklahoma County Clerk
Carolynn Caudill

Eddie F. Baker
Eddie Baker

Shirley Baker
Shirley Baker

NOTARY ACKNOWLEDGMENT

Oklahoma Form

State of Oklahoma

County of Oklahoma

Before me, the undersigned, a Notary Public in and for said County and State on this 12th day of August 2016, personally appeared Eddie Baker and Shirley Baker to me known to be the identical persons who executed the within and foregoing instrument as his free and voluntary act and deed for the uses and purposes therein set forth.

Given under my hand and seal the day and year last above written.

My Commission expires:

July 21, 2017



Kay Webb
Notary Public

Rev. Stamp 05-08-32
3.75

20160912011285760
Filing Fee: \$13.00
Doc. Stamps: \$3.75
09/12/2016 01:16:36 PM
DEED



Record & Return to:
American Eagle Title Group
421 NW 13th St, Suite 320
Oklahoma City, OK 73103
File # 1511-0002-1001-1

COURTESY FILING. NO
LIABILITY IS ASSUMED

2021062201110741 B: 14791 P: 1946
06/22/2021 11:11:47 AM Pgs: 1
Fee: \$18.00 Doc Stamp: \$21.00
David B. Hooten, County Clerk
Oklahoma County - State of Oklahoma



GENERAL WARRANTY DEED

KNOW ALL MEN BY THESE PRESENTS:

That Missouri Province Educational Institute of the Society of Jesus ("Grantor"), whose mailing address is 4511 West Pine Blvd, St Louis, Missouri, in consideration of the sum of Ten and No/100 dollars and other valuable consideration in hand paid, the receipt and sufficiency of which are hereby acknowledged do/does grant, bargain, sell and convey unto Garrett and Company LLC, an limited liability company ("Grantee") whose mailing address is 9701 North Broadway Ext., Oklahoma City, Oklahoma, the real property and premises situated in Oklahoma County, State of Oklahoma, to-wit:

Northeast Heights Addition to Oklahoma City, Oklahoma, Block 1 Lots 13, 14, 15, 16, 17, 18, 35, 36, 37, 38, 45, 46

together with all the improvements thereon and the appurtenances thereunto belonging, and warrant the title to the same.

TO HAVE AND TO HOLD said described premises unto the said part of the second part, its heirs and assigns forever, free, clear and discharged of and from all former grants, charges, taxes, judgments, mortgages and other liens and incumbrances of whatsoever nature.

Signed and delivered this 14th day of May, 2021.

BY:

J. Daniel Daly, S.J.
J. Daniel Daly, S.J., Treasurer
Missouri Province Educational Institute
of the Society of Jesus

ACKNOWLEDGMENT
STATE OF MISSOURI

COUNTY OF ST LOUIS)

This instrument was acknowledged before me on this 14th day of May, 2021,
by J.P.R. Smetana

TERRI SMETANA
Notary Public

My Commission Expires.

My Commission No:



TERRI SMETANA
My Commission Expires
October 5, 2022
St. Louis County
Commission #14550893



GENERAL WARRANTY DEED

KNOW ALL MEN BY THESE PRESENTS:

That Phillip Moss and Kathleen Moss, whose mailing address is 11120 SE 49th Street Oklahoma City, Oklahoma, 73150 in consideration of the sum of Ten and No/100 dollars and other valuable consideration in hand paid, the receipt and sufficiency of which are hereby acknowledged do/does grant, bargain, sell and convey unto Gulf Exploration, L.L.C. an Oklahoma limited liability company ("Grantee") whose mailing address is 9701 N Broadway Ext., Oklahoma City, Oklahoma, the real property and premises situated in Oklahoma County, State of Oklahoma, to-wit:

LOT FORTY SEVEN (47), AND LOT FORTY EIGHT (48), IN BLOCK ONE (1) NORTHEAST HEIGHTS TO THE CITY OF OKLAHOMA CITY, OKLAHOMA COUNTY, OKLAHOMA according to the plat thereof together with all the improvements thereon and the appurtenances thereunto belonging, and warrant the title to the same.

TO HAVE AND TO HOLD said described premises unto the said part of the second part, its heirs and assigns forever, free, clear and discharged of and from all former grants, charges, taxes, judgments, mortgages and other liens and Incumbrances of whatsoever nature.

Signed and delivered this 9th day of April, 2024.

BY:

Phillip Moss

BY:

Kathleen Moss

ACKNOWLEDGMENT

STATE OF OKLAHOMA)
)SS.
COUNTY OF OKLAHOMA)

This instrument was acknowledged before me on this 9th day of April, 2024, by Phillip Moss.

My Commission No: 12006442
My Commission Expires: 7-11-24

Notary Public

ACKNOWLEDGMENT

STATE OF OKLAHOMA)
)SS.
COUNTY OF OKLAHOMA)

This instrument was acknowledged before me on this 9th day of April, 2024, by Kathleen Moss.

My Commission Expires: 7-11-24
My Commission No: 12006442

Notary Public

OAG 2024-2 - NON-EXEMPTBUSINESS/TRUST

Exhibit to Deed

AFFIDAVIT OF LAND OR MINERAL OWNERSHIP: NON-EXEMPT BUSINESS OR TRUST

STATE OF OKLAHOMA

SS

COUNTY OF OKLAHOMA

TO: THE ATTORNEY GENERAL OF THE STATE OF OKLAHOMA

Before me, the undersigned William P. Garrett (list legal name and any aliases) (the "Affiant"), who, having been first duly sworn, deposes and states:

1. I am eighteen (18) years of age or older and have personal knowledge of the statements made herein.
2. I am a/an manager (role, such as titled officer or trustee) of Gulf Exploration, L.L.C., an Oklahoma limited liability company (legal name, along with any trade or fictitious names, of business, trust, or other legal entity) (referred to herein as the "Entity"). I am duly authorized to record this Affidavit on behalf of the Entity, which is taking title to the real property identified in the Deed to which this Affidavit is attached (the "Property"), and to bind the Entity for the consequences of any false statements in this Affidavit.
3. This Affidavit is executed in accordance with and pursuant to 60 O.S. § 121, which provides in part as follows:
No alien or any person who is not a citizen of the United States shall acquire title to or own land in this state either directly or indirectly through a business entity or trust, except as hereinafter provided, but he or she shall have and enjoy in this state such rights as to personal property as are, or shall be accorded a citizen of the United States under the laws of the nation to which such alien belongs, or by the treaties of such nation with the United States, except as the same may be affected by the provisions of Section 121 et seq. of this title or the Constitution of this state. Provided, however, the requirements of this subsection shall not apply to a business entity that is engaged in regulated interstate commerce in accordance with federal law.
4. The Entity acquired title to the Property in compliance with the requirements of 60 O.S. § 121 and no funding source was used in the sale or transfer of the Property in violation of section 121 or any other state or federal law.
5. If the Entity is a trust, its grantee(s), trustees and all direct and contingent beneficiaries are United States citizens or bona fide residents of the State of Oklahoma. If the Entity is a business, its direct and indirect owner(s) is/are United States citizens(s) or bona fide residents of the State of Oklahoma.
6. I acknowledge and understand that making or causing to be made a false statement in this affidavit may subject me to criminal prosecution for perjury and/or subject me and/or the Entity to being liable for actual damages suffered or incurred by any person or other entity as a result or consequence of the making of or reliance upon such false statement.

FURTHER AFFIANT SAYETH NOT.

William P. Garrett
AFFIANT, individually and as authorized agent of the Entity

4/12/2024
Date

The foregoing instrument was subscribed and sworn to before me this 12th day of April 2024 by Joshua T. Bailey

My Commission Expires: 04-02-27

My Commission Number: 23007550

JB
NOTARY PUBLIC



Record & Return to:
American Eagle Title Group
421 N.W. 13th St, Suite 120
Oklahoma City, OK 73103
File # 1909-0011-08

20181217011730580
DEED 12/17/2018
02:55:30 DM Book:13909
Page:1553 PageCount:3
Filing Fee:\$17.00
Doc. Tax:\$67.50
State of Oklahoma
County of Oklahoma
Oklahoma County Clerk
David B. Hooker

WARRANTY DEED

KNOW ALL MEN BY THESE PRESENTS:

That, Mary Pauline Jodlowski, also known as Mary P. Jodlowski, a single person, (herein "Grantor"), in consideration of the sum of Ten and No/100 Dollars and other valuable consideration in hand paid, the receipt and sufficiency of which are hereby acknowledged, does hereby grant, bargain, sell and convey unto Gulf Exploration, L.L.C., an Oklahoma limited liability company (herein "Grantee"), whose mailing address is 9701 N. Broadway Ext., Oklahoma City, Oklahoma 73114, the following real property and premises situated in Oklahoma County, State of Oklahoma, described on Exhibit A attached hereto, together with the improvements thereon and the appurtenances thereunto belonging (herein "the Land").

Grantor warrants the title to the Land to be free, clear and discharged of and from all former grants, charges, taxes, judgments, mortgages, and other liens and encumbrances of whatsoever nature, SUBJECT TO easements and restrictive covenants of record and any interest in the oil, gas and other minerals within and underlying the Land, previously reserved or conveyed.

To have and hold the Land unto the Grantee and its successors and assigns forever.

Signed and delivered this 14th day of November, 2018.

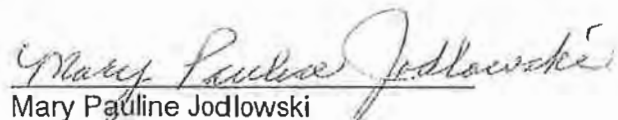
Mary Pauline Jodlowski

ACKNOWLEDGMENT

STATE OF OKLAHOMA)
)
COUNTY OF OKLAHOMA) SS.

This instrument was acknowledged before me this 14th day of November, 2018
by Mary Pauline Jodlowski.

Notary Public

My Commission No:

My Commission Expires:

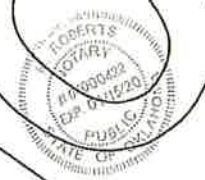

Exhibit A

Tract 1

Lots 19, 20, 21, 22, 23, 24, 25, 26, 27, 28, 29 and 30, in Block 1, of Northeast Heights, a Subdivision of Block 2, Interurban Heights, an Addition to Oklahoma City, Oklahoma County, Oklahoma, according to the plat recorded in Book 17 of Plats, page 54.

Tract 2

Lots 31, 32, 33, 34, 39, 40, 41 and 42, in Block 1, of Northeast Heights, a Subdivision of Block 2, Interurban Heights, an Addition to Oklahoma City, Oklahoma County, Oklahoma, according to the plat recorded in Book 17 of Plats, page 54.

Tract 3

The South half of Block 4, of Interurban Heights, an Addition to Oklahoma City, Oklahoma County, Oklahoma, according to the plat recorded in Book 6 of Plats, page 87.



1. NORTHEAST HEIGHTS ADDITION TO OKLAHOMA CITY, OKLAHOMA COUNTY, OKLAHOMA, BLOCK 1 LOTS 5 THRU 6
2. NORTHEAST HEIGHTS ADDITION TO OKLAHOMA CITY, OKLAHOMA COUNTY, OKLAHOMA, BLOCK 1 LOTS 7 THRU 8
3. NORTHEAST HEIGHTS ADDITION TO OKLAHOMA CITY, OKLAHOMA COUNTY, OKLAHOMA, BLOCK 1 LOTS 9 THRU 10
4. NORTHEAST HEIGHTS ADDITION TO OKLAHOMA CITY, OKLAHOMA COUNTY, OKLAHOMA, BLOCK 1 LOTS 11 THRU 12
5. NORTHEAST HEIGHTS ADDITION TO OKLAHOMA CITY, OKLAHOMA COUNTY, OKLAHOMA, BLOCK 1 LOTS 13 THRU 18
6. NORTHEAST HEIGHTS ADDITION TO OKLAHOMA CITY, OKLAHOMA COUNTY, OKLAHOMA, BLOCK 1 LOTS 19 THRU 24
7. NORTHEAST HEIGHTS ADDITION TO OKLAHOMA CITY, OKLAHOMA COUNTY, OKLAHOMA, BLOCK 1 LOTS 25 THRU 30
8. NORTHEAST HEIGHTS ADDITION TO OKLAHOMA CITY, OKLAHOMA COUNTY, OKLAHOMA, BLOCK 1 LOTS 31 THRU 34
9. NORTHEAST HEIGHTS ADDITION TO OKLAHOMA CITY, OKLAHOMA COUNTY, OKLAHOMA, BLOCK 1 LOTS 35 THRU 38
10. NORTHEAST HEIGHTS ADDITION TO OKLAHOMA CITY, OKLAHOMA COUNTY, OKLAHOMA, BLOCK 1 LOTS 39 THRU 42
11. NORTHEAST HEIGHTS ADDITION TO OKLAHOMA CITY, OKLAHOMA COUNTY, OKLAHOMA, BLOCK 1 LOTS 45 THRU 46
12. NORTHEAST HEIGHTS ADDITION TO OKLAHOMA CITY, OKLAHOMA COUNTY, OKLAHOMA, BLOCK 1 LOTS 47 THRU 48
13. NORTHEAST HEIGHTS ADDITION TO OKLAHOMA CITY, OKLAHOMA COUNTY, OKLAHOMA, BLOCK 1 LOTS 49 THRU 50

LETTER OF AUTHORIZATION

I, Garrett and Company, LLC or,
Property Owner of Record
William P. Garrett authorize,
Agent of the Property Owner of Record and Title Manager
Box Law Group, PLLC.
Designated Representative

to make application for municipal approvals and do all things necessary for the advancement of such application with respect to property per the Deed(s) of record submitted.

By: William P. Garrett
Signature
Title: Manager
Manager / Proprietor
Date: 2-24-25
MM/DD/YYYY

LETTER OF AUTHORIZATION

I, Gulf Expiration LLC or,
Property Owner of Record
William P Gannett authorize,
Agent of the Property Owner of Record and Title
Box Law Group, PLLC.
Designated Representative

to make application for municipal approvals and do all things necessary for the advancement of such application with respect to property per the Deed(s) of record submitted.

By: William P Gannett
Signature
Title: Manager
Manager / Proprietor
Date: 2-24-25
MM/DD/YYYY

Larry Stein Oklahoma County Assessor's Office



Ownership Radius Report

This Non-Official Report is for Account Numbers contained in **NORTHEAST HEIGHTS ALL BLK 1** and is a 500-foot radius from the outside of the polygon. If the minimum number of different owners was not reached it was extended by 100-foot increments until the required number of different owners was reached, or the maximum distance was reached. This report does not constitute a legal survey or document, for definitive description of real property and ownership; consult the deeds recorded in the Oklahoma County Clerks Office. **Official Record of this Certified Radius Report will expire 30 days from the date of creation stamped on the back of this sheet.**

STATE OF OKLAHOMA } ss:
COUNTY OF OKLA.

I, the duly elected, qualified and acting
County Assessor, in and for the County
and State aforesaid, do hereby certify that
the within and foregoing is a full, true and
complete copy of SCOTT Radins Report

filed in the office of the County Assessor
on the 20th day of February, 2025

Given under my hand and official seal this
20th day of February, 2025

K. Burch County Assessor
Deputy

**Oklahoma County Assessor's
500ft Radius Report
2/20/2025**

accountno	name1	name2	name3	mailingaddress1	city	state	zipcode	subname	block	lot	legal	location
R146433640	CHURCH OF LIVING GOD	TEMPLE 290	No Data	555 E WILSHIRE BLVD	OKLAHOMA CITY	OK	73105-1011	MUSGRAVES GOLD MEDAL HILLS	23	0	MUSGRAVES GOLD MEDAL HILLS 023 000 LOT 1 & E 1/2 OF LOT 2 EXEMPT	555 E WILSHIRE BLVD NICHOLS HILLS
R146433645	CHURCH OF THE LIVING GOD	TEMPLE 290	No Data	555 E WILSHIRE BLVD	OKLAHOMA CITY	OK	73105-1011	MUSGRAVES GOLD MEDAL HILLS	23	0	MUSGRAVES GOLD MEDAL HILLS 023 000 W 1/2 LOT 2 EXEMPT	555 E WILSHIRE BLVD OKLAHOMA CITY
R146433650	CHURCH OF THE LIVING GOD	No Data	No Data	555 E WILSHIRE BLVD	OKLAHOMA CITY	OK	73105-1011	MUSGRAVES GOLD MEDAL HILLS	23	0	MUSGRAVES GOLD MEDAL HILLS 023 000 LOT 3 EXEMPT	555 E WILSHIRE BLVD NICHOLS HILLS
R146433655	REWILSHIRE LLC	No Data	C/O SAVAGE SAVAGE AND BROWN	PO BOX 22845	OKLAHOMA CITY	OK	73123	MUSGRAVES GOLD MEDAL HILLS	23	0	MUSGRAVES GOLD MEDAL HILLS 023 000 LOTS 4 THRU 6	505 E WILSHIRE BLVD OKLAHOMA CITY
R146433335	RNGD WILSHIRE LLC	No Data	No Data	3141 S BROADWAY, Unit A	ENGLEWOOD	CO	80113	MUSGRAVES GOLD MEDAL HILLS	0	0	MUSGRAVES GOLD MEDAL HILLS 000 000 LOTS 14 THRU 22 BLK 18 & LOTS 1 THRU 8 BLK 21 & LOTS 1 THRU 16 BLK 22	701 E WILSHIRE BLVD OKLAHOMA CITY
R102975400	GULF EXPLORATION LLC	No Data	No Data	9701 N BROADWAY EXT	OKLAHOMA CITY	OK	73114	NORTHEAST HEIGHTS	1	0	NORTHEAST HEIGHTS 001 000 LOTS 31 THRU 34	0 UNKNOWN OKLAHOMA CITY
R102976000	GARRETT AND COMPANY LLC	No Data	No Data	9701 N BROADWAY EXT	OKLAHOMA CITY	OK	73114	NORTHEAST HEIGHTS	1	0	NORTHEAST HEIGHTS 001 000 LOTS 35 THRU 38	0 UNKNOWN OKLAHOMA CITY
R102976600	GULF EXPLORATION LLC	No Data	No Data	9701 N BROADWAY EXT	OKLAHOMA CITY	OK	73114	NORTHEAST HEIGHTS	1	0	NORTHEAST HEIGHTS 001 000 LOTS 39 THRU 42	0 UNKNOWN OKLAHOMA CITY
R102977200	BONIFAS S M	C/O SALLY A CONWAY	C/O SALLY A CONWAY	1700 WENTWORTH PL	PLANO	TX	75075-6243	NORTHEAST HEIGHTS	1	0	NORTHEAST HEIGHTS 001 000 LOTS 43 & 44	0 UNKNOWN OKLAHOMA CITY
R102977800	GARRETT AND COMPANY LLC	No Data	No Data	9701 N BROADWAY EXT	OKLAHOMA CITY	OK	73114	NORTHEAST HEIGHTS	1	0	NORTHEAST HEIGHTS 001 000 LOTS 45 & 46	0 UNKNOWN OKLAHOMA CITY
R102978600	GULF EXPLORATION LLC	No Data	No Data	9701 BROADWAY EXT	OKLAHOMA CITY	OK	73114-6316	NORTHEAST HEIGHTS	1	0	NORTHEAST HEIGHTS 001 000 LOTS 47 & 48	0 UNKNOWN OKLAHOMA CITY
R102979200	GULF EXPLORATION LLC	No Data	No Data	9701 BROADWAY EXT	OKLAHOMA CITY	OK	73114	NORTHEAST HEIGHTS	1	0	NORTHEAST HEIGHTS 001 000 LOTS 49 & 50	0 UNKNOWN OKLAHOMA CITY
R102974800	GULF EXPLORATION LLC	No Data	No Data	9701 N BROADWAY EXT	OKLAHOMA CITY	OK	73114	NORTHEAST HEIGHTS	1	0	NORTHEAST HEIGHTS 001 000 LOTS 25 THRU 30	0 UNKNOWN OKLAHOMA CITY
R102974200	GULF EXPLORATION LLC	No Data	No Data	9701 N BROADWAY EXT	OKLAHOMA CITY	OK	73114	NORTHEAST HEIGHTS	1	0	NORTHEAST HEIGHTS 001 000 LOTS 19 THRU 24	0 UNKNOWN OKLAHOMA CITY
R102973600	GARRETT AND COMPANY LLC	No Data	No Data	9701 N BROADWAY EXT	OKLAHOMA CITY	OK	73114	NORTHEAST HEIGHTS	1	0	NORTHEAST HEIGHTS 001 000 LOTS 13 THRU 18	0 UNKNOWN OKLAHOMA CITY
R102973000	GARRETT AND COMPANY LLC	No Data	No Data	9701 BROADWAY EXT	OKLAHOMA CITY	OK	73114-6316	NORTHEAST HEIGHTS	1	0	NORTHEAST HEIGHTS 001 000 LOTS 11 & 12	0 UNKNOWN OKLAHOMA CITY
R102972400	GARRETT AND COMPANY LLC	No Data	No Data	9701 BROADWAY EXT	OKLAHOMA CITY	OK	73114-6316	NORTHEAST HEIGHTS	1	0	NORTHEAST HEIGHTS 001 000 LOTS 9 & 10	0 UNKNOWN OKLAHOMA CITY

**Oklahoma County Assessor's
500ft Radius Report
2/20/2025**

R102971800	GULF EXPLORATION LLC	No Data	No Data	9701 BROADWAY EXT	OKLAHOMA CITY	OK	73114	NORTHEAST HEIGHTS	1	0	NORTHEAST HEIGHTS 001 000 LOTS 7 & 8	0 UNKNOWN OKLAHOMA CITY
R102971200	GARRETT AND COMPANY LLC	No Data	No Data	9701 BROADWAY EXT	OKLAHOMA CITY	OK	73114-6316	NORTHEAST HEIGHTS	1	0	NORTHEAST HEIGHTS 001 000 LOTS 5 & 6	0 UNKNOWN OKLAHOMA CITY
R102970600	WEST COAST DEVELOPMENT	No Data	No Data	6600 NEWMAN DR	OKLAHOMA CITY	OK	73162-7440	NORTHEAST HEIGHTS	1	0	NORTHEAST HEIGHTS 001 000 LOTS 1 THRU 4	0 UNKNOWN OKLAHOMA CITY
R132941505	CITY OF NICHOLS HILLS	No Data	No Data	6407 AVONDALE DR	NICHOLS HILLS	OK	73116-6431	UNPLTD PT SEC 03 12N 3W	0	0	UNPLTD PT SEC 03 12N 3W 000 000 PT NW4 SEC 3 12N 3W BEG 690FT W & 295.75FT S NE/C SD NW4 THW55FT S165FT E55FT N165FT TO BEG FORMERLY LOTS 1 & 2 BLK 15COLUMBIA HEIGHTS ADDN EXEMPT	0 UNKNOWN OKLAHOMA CITY
R132941500	O G & E	No Data	No Data	PO BOX 321	OKLAHOMA CITY	OK	73101-0321	UNPLTD PT SEC 03 12N 3W	0	0	UNPLTD PT SEC 03 12N 3W 000 000 PT NW4 SEC 3 12N 3W BEG 690FT W NE/C SD NW4 TH S295.75FT W55FT S165FT E55FT S1251.25FT MORE OR LESS W630FT N1547FT MORE OR LESS E TO BEG FORMERLY BLK 12 WOOD WHEELER ADDN & BLKS 13 14 15 & 16 COLUMBIA HEIGHTS ADDN CONT 22ACRS MORE OR LESS	220 E WILSHIRE BLVD OKLAHOMA CITY
R140890900	CHRISTIAN FAITH MISSIONARY	BAPTIST CHURCH	No Data	500 E WILSHIRE BLVD	OKLAHOMA CITY	OK	73105	UNPLTD PT SEC 03 12N 3W	0	0	UNPLTD PT SEC 03 12N 3W 000 000 PT NE4 SEC 3 12N 3W 5ACRS PT NE4 BEG AT NW/C TH E263.47FT S826.75FT W263.47FT N826.75FT TO BEG SUBJ TO ESMTS OF RECORD	500 E WILSHIRE BLVD OKLAHOMA CITY
R102810900	NORTHEAST THIRTY SIX ST	CHURCH OF CHRIST INC	No Data	1501 NE 36TH ST	OKLAHOMA CITY	OK	73111-5226	INTERURBAN HEIGHTS	1	0	INTERURBAN HEIGHTS 001 000 EX N7FT EXEMPT	400 E WILSHIRE BLVD OKLAHOMA CITY
R140891000	COOKSEY RITA M	No Data	No Data	PO BOX 36104	OKLAHOMA CITY	OK	73136	UNPLTD PT SEC 03 12N 3W	0	0	UNPLTD PT SEC 03 12N 3W 000 000 PT NE4 SEC 3 12N 3W BEG 263.47FT E OF NW/C NE4 TH E200FT S350FT W200FT N350FT TO BEG SUBJ TO ESMTS OF RECORD	0 UNKNOWN OKLAHOMA CITY
R140890910	COOKSEY RITA M	PARKER VICKIE R	No Data	PO BOX 36104	OKLAHOMA CITY	OK	73136	UNPLTD PT SEC 03 12N 3W	0	0	UNPLTD PT NE4 SEC 3 12N 3W BEG 263.47FT E OF NW/C NE4 TH E538.53FT S827.25FT W539.45FT N826.75FT TO BEG EX N350FT OF W200FT SUBJ TO ESMTS OF RECORD	600 E WILSHIRE BLVD OKLAHOMA CITY
R102814000	GULF EXPLORATION LLC	No Data	No Data	9701 N BROADWAY EXT	OKLAHOMA CITY	OK	73114	INTERURBAN HEIGHTS	4	0	INTERURBAN HEIGHTS 004 000 S 1/2	0 UNKNOWN OKLAHOMA CITY

**Oklahoma County Assessor's
500ft Radius Report
2/20/2025**

R102812700	GULF EXPLORATION LLC	No Data	No Data	9701 BROADWAY EXT	OKLAHOMA CITY	OK	73114	INTERURBAN HEIGHTS	4	0	INTERURBAN HEIGHTS BLK 004 W1 1/2ACRES OF N 1/2	0 UNKNOWN OKLAHOMA CITY
R102813100	BOYLES CAROL DAWN	No Data	No Data	8517 E 92ND ST	TULSA	OK	74133	INTERURBAN HEIGHTS	4	0	INTERURBAN HEIGHTS 004 000 E1ACRES OF N 1/2	0 UNKNOWN OKLAHOMA CITY
R140891200	GOUDEAU PHYLLIS TRS	GOUDEAU FAMILY REVOCABLE TRUST	No Data	601 NE 73RD ST	OKLAHOMA CITY	OK	73105-5632	UNPLTD PT SEC 03 12N 3W	0	0	UNPLTD PT SEC 03 12N 3W 000 000 PT NE4 SEC 3 12N 3W BEG 2056.01FT W & 828.1FT S OF NE/C NE4 TH W602.84FT S720.2FT E604.42FT N720.2FT TO BEG SUBJ TO ESMTS OF RECORD	601 NE 73RD ST OKLAHOMA CITY
R102811800	WILSHIRE CHURCH OF CHRIST	No Data	No Data	400 E WILSHIRE BLVD	OKLAHOMA CITY	OK	73105-1010	INTERURBAN HEIGHTS	3	0	INTERURBAN HEIGHTS 003 000	0 UNKNOWN OKLAHOMA CITY
R146451060	INDEPENDENT SCHOOL DISTRICT 89	No Data	No Data	PO BOX 36609	OKLAHOMA CITY	OK	73136	MUSGRAVE GOLD MEDAL HILLS B24	24	7	MUSGRAVE GOLD MEDAL HILLS B24 BLK 024 LOT 007 & PT OF ADELE HTS & NORTHWOODS SHADY SIDE ADDN & EAST BROADWAY HTS & NORTH BROADWAY HTS DESC AS PT OF SEC 34 13N 3W BEG 1683FT E & 33FT N OF SW/C SW4 SD SEC TH N1982.03FT E955.77FT S517.91FT W49.14FT S166.50FT E50.23FT S463.52FT E120.02FT LEFT ON CURVE NE340.67FT NE18FT SE362FT RIGHT ON CURVE S28.27FT LEFT ON CURVE SW384.56FT S80FT W548.19FT S268.33FT W968.75FT TO BEG CONT 52.00ACRS MORE OR LESS	8301 GOLD MEDAL DR OKLAHOMA CITY

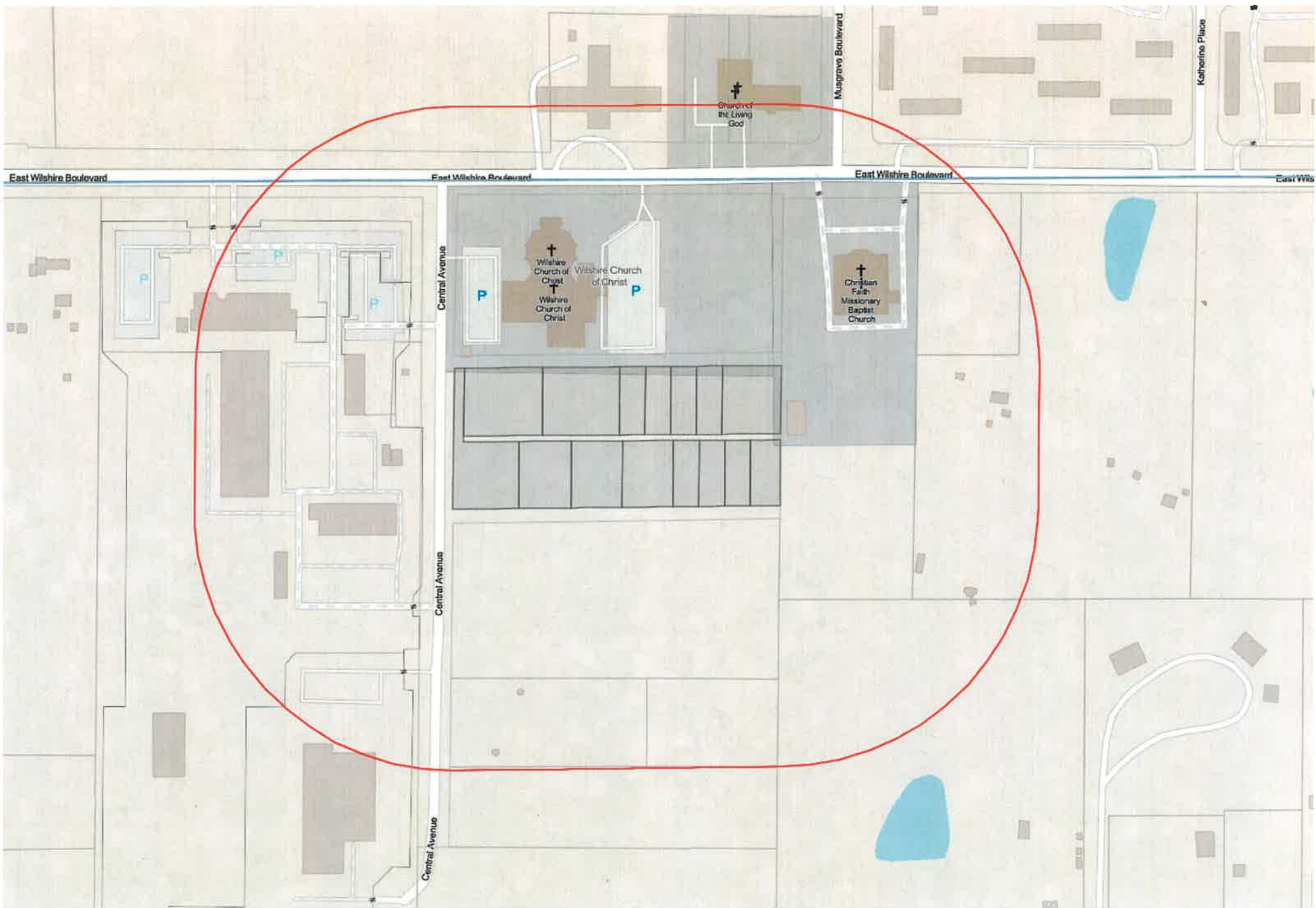

East Wilshire Boulevard

East Wilshire Boulevard

East Wilshire Boulevard

East Wilshire Boulevard

Central Avenue

Central Avenue

Central Avenue

Musgrave Boulevard

Katherine Place

Church of the Living God

Wilshire Church of Christ

Wilshire Church of Christ

Christian Faith Missionary Baptist Church

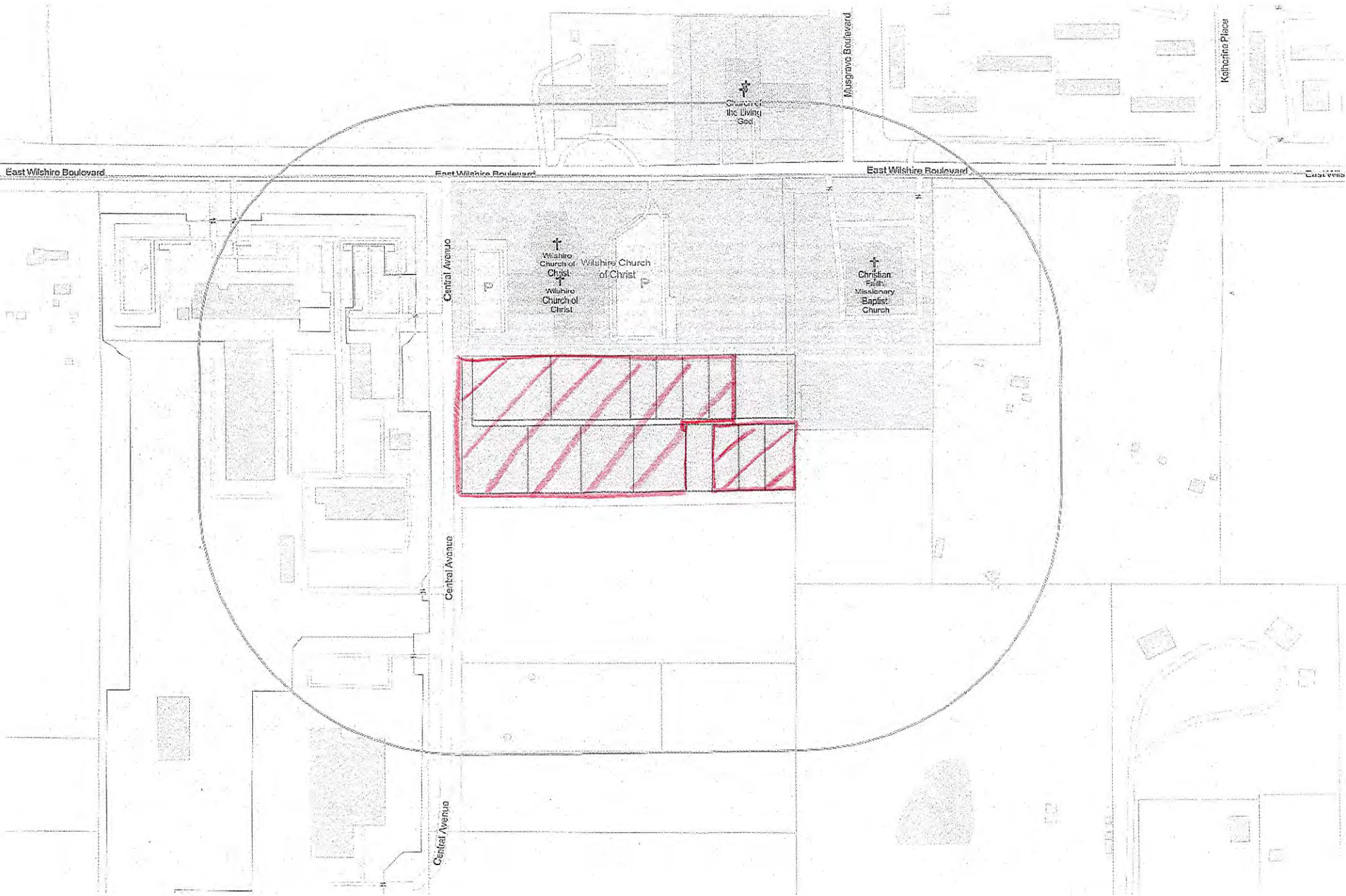

East Wilshire Boulevard

East Wilshire Boulevard

East Wilshire Boulevard

East Wilshire Boulevard

Central Avenue

Central Avenue

Central Avenue

Musgrave Boulevard

Kelton Place

Church of the Living God

Wilshire Church of Christ

Wilshire Church of Christ

Christian Faith Missionary Baptist Church