

Case No: C-7739

Final Plat of Amelia's Brasswood

Developer: Brasswood Construction, LLC

Engineer: Grey Massey, Red Plains Engineering

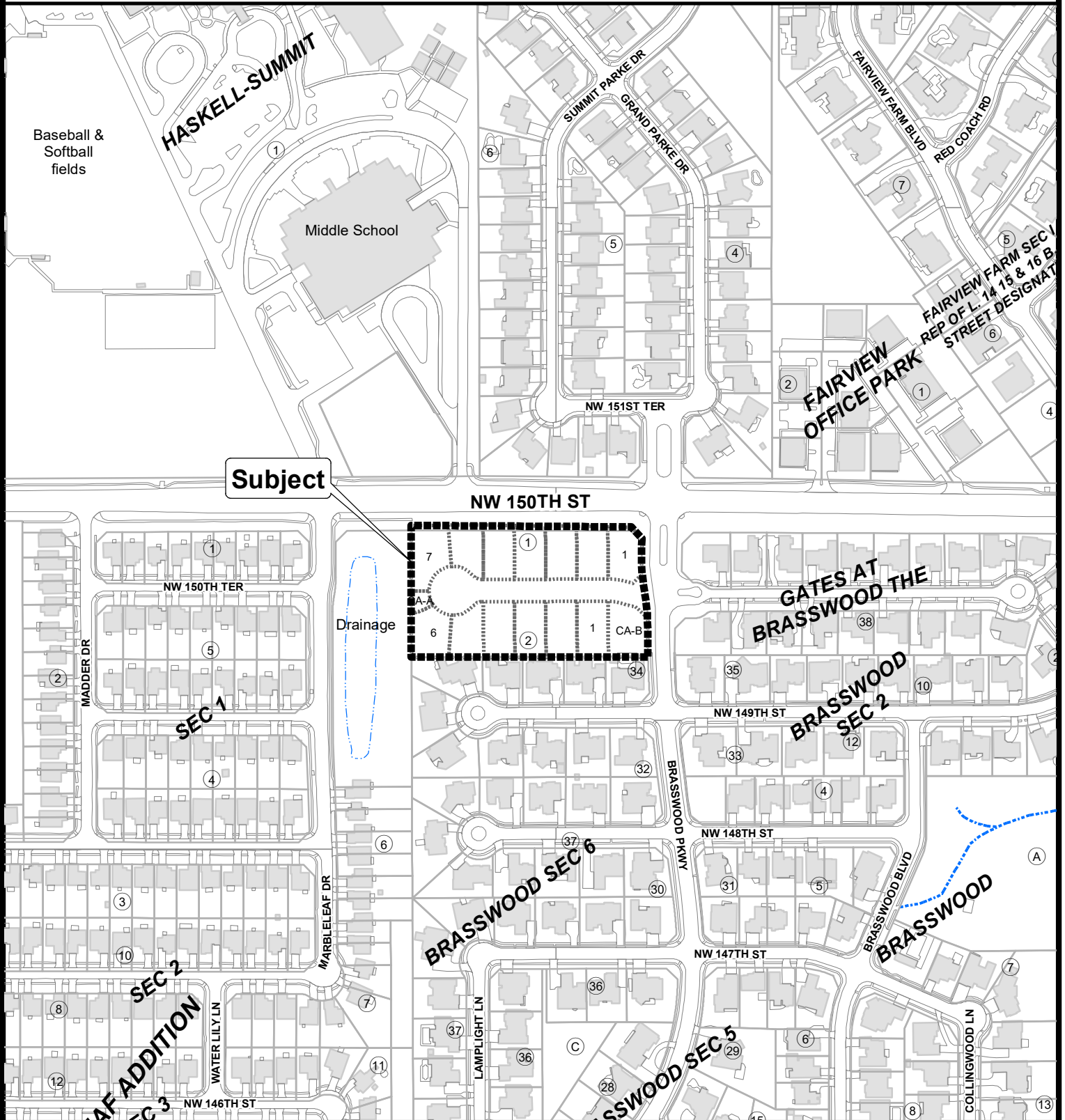

Note: "Subject" is located approximately 2,487' East of N. Pennsylvania Ave.



The City of
OKLAHOMA CITY

Final Plat Application



0 150 300
Feet