

Case No: PC-10955

Applicant: The Gayle Townley 2024 Family Trust and Sam A. Townley Living Trust

Existing Zoning: R-1 / AE-2

Proposed zoning: I-2 / AE-2

Location: 715 E. Grand Blvd. & 700 Townley

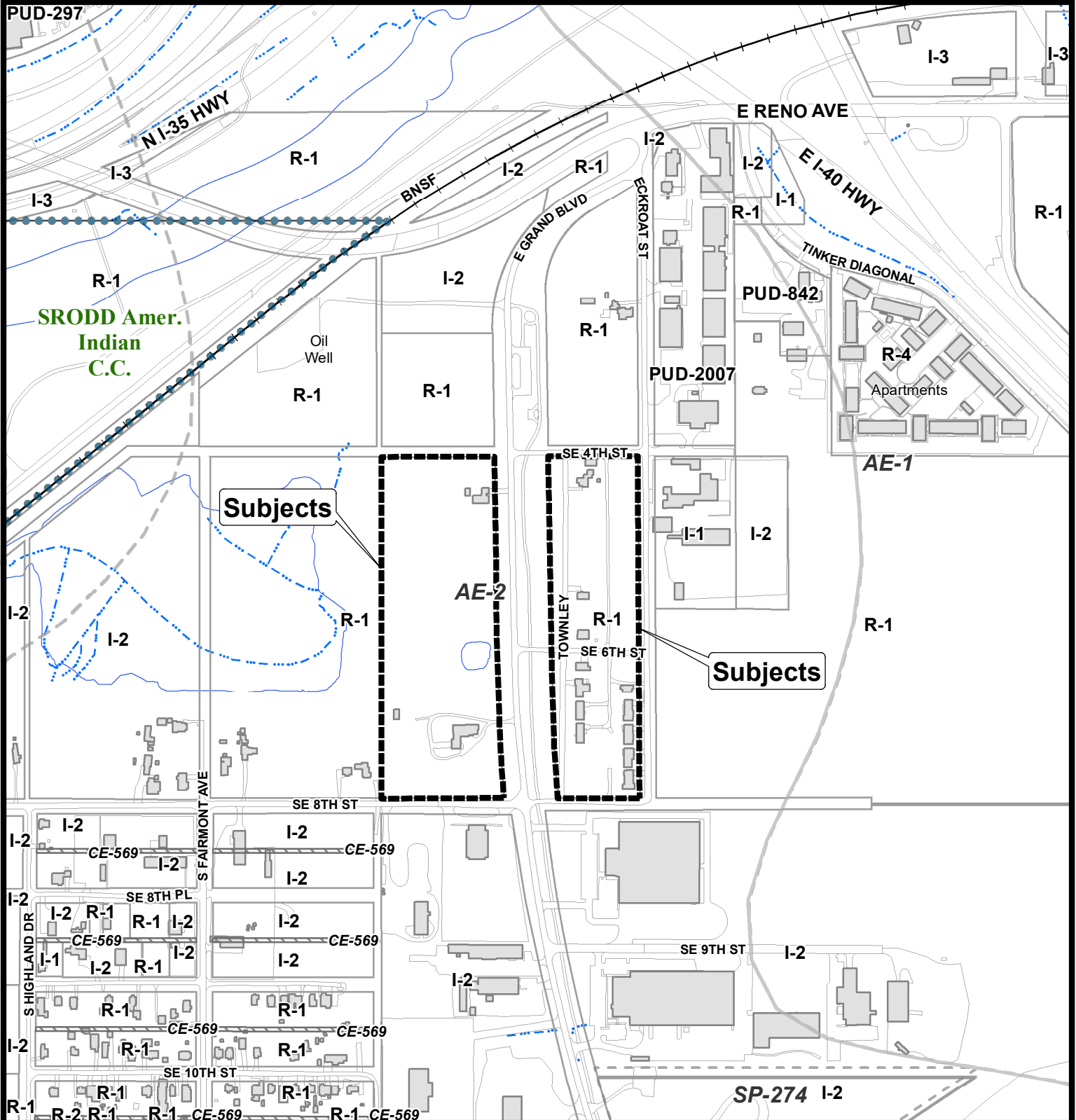

Note: "Subject" is located approximately 1,635.6' West of S. Bryant Ave.

Rezoning Application



The City of
OKLAHOMA CITY



0 250 500
Feet