

**A PART OF THE SW/4 OF SEC. 10, T.12N., R.3W., I.M., CITY OF
OKLAHOMA CITY, OKLAHOMA COUNTY, OKLAHOMA**

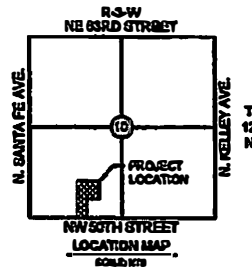
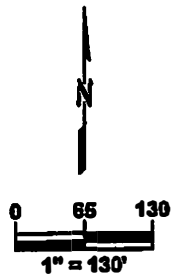

**wallace
design
collective**

wallace design collective, pc
structural-tilt-lenscope-survey
419 north walnut ave.
oklahoma city, oklahoma 73104
405.236.0550
wallace.design
ok or 1400 exp. 05-30-2022

REV.	DESCRIPTION	DATE

PROJECT NO. 2260099.01 SHEET 1 OF 4

A PART OF THE SW/4 OF SEC. 10, T.12N., R.3W., I.M., CITY OF
OKLAHOMA CITY, OKLAHOMA COUNTY, OKLAHOMA

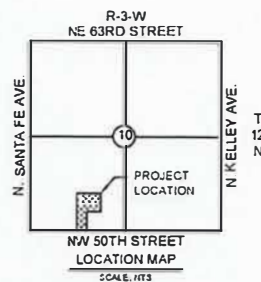
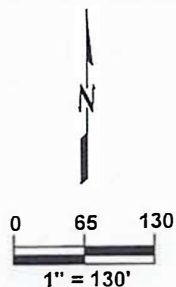

wallace
design
collective

wallace design collective, pc
structural civil landscape survey
410 north walnut ave.
oklahoma city, oklahoma 73104
405.236.5858
wallace.design
ok ca 1460 exp. 06-30-2025

SUPPLEMENTAL EXHIBIT

REV	DESCRIPTION	DATE

PROJECT NO. 2280098.01