

MORTGAGE INSPECTION REPORT

Not a Land or Boundary Survey

Schedule B, Part II (DNA - Does Not Affect, BL - Blanket, AAS - Affects as Stated)

#9) Dedication Deed recorded in Book 40, Page 523, DNA

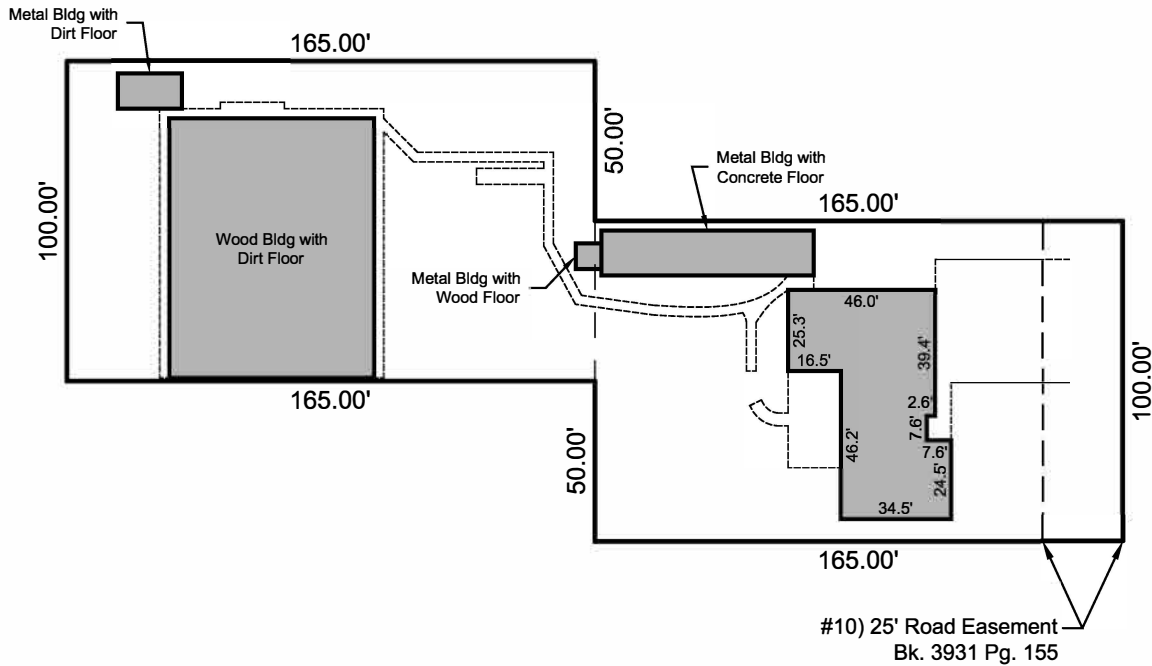

- 1107-  
N Purdue Ave

Sketch Legend

	SUBJECT PROPERTY
	LOT LINE
	BUILDING LINE
	EASEMENT LINE
	RIGHT-OF-WAY LINE
	FENCE LINE
	PROPERTY LINE
	BUILDING LINE
	UTILITY EASEMENT
	DRAINAGE EASEMENT
	RIGHT-OF-WAY
	DECK
	CONCRETE

I, Curtis Lee Hale, a Registered Land Surveyor, do hereby state that a careful inspection has been made under my supervision on the following described property, to wit;

The South 100 feet of the North 150 feet of the South Four-fifths (S 4/5) of the East Half (E/2) of the East Half (E/2) of the Southeast Quarter (SE/4) of the Southwest Quarter (SW/4) of the Southwest Quarter (SW/4) of Section Twenty-seven (27), Township Twelve (12) North, Range Four (4) West of the Indian Meridian, Oklahoma County, Oklahoma.

AND

The North 100 feet of the South Four-fifths (S 4/5) of the West Half (W/2) of the East Half (E/2) of the Southeast Quarter (SE/4) of the Southwest Quarter (SW/4) of the Southwest Quarter (SW/4) of Section Twenty-seven (27), Township Twelve (12) North, Range Four (4) West of the Indian Meridian, Oklahoma County, Oklahoma. Known as 1107 N Purdue Ave...

This Mortgage Inspection Report was prepared for Chicago Title Oklahoma Co. It is not a land or a boundary survey plat, and it is not to be relied upon for the establishment of fence, building or other future improvement lines. The accompanying sketch is a representation of the conditions that were found at the time of the inspection and the linear and angular values shown on the sketch, if any, are based on record or deed information and have not been verified unless noted.

Hale & Associates Survey Co., Inc. assumes no liability for any encroachments, encumbrance, violation, or adverse circumstance affecting the subject property that would be identified by a land or boundary survey.

Curtis Lee Hale      Electronically Signed - 3/1/2023

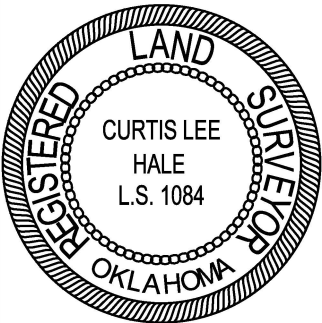

FINALIZED: 1st of March, 2023

Inspection Number: 20231109  
Buyer: Central Oklahoma Winnelson Co Inc  
File Number: 714052300295

Hale & Associates Survey Company

Land Surveying and Planning  
1601 SW 89th Street, Building C, Suite 200  
Oklahoma City, Oklahoma 73159  
Tel.: (405) 686-0174 - Fax: (405) 681-4881  
C. A.: 819 - Exp.: June 30, 2023  
www.halesurvey.com