

Planning Commission Minutes
October 24, 2024

(The agenda was filed with the City Clerk of The City of Oklahoma City at 7:35 a.m. on October 21, 2024)

8. (PUD-2037) Application by Westpoint Developers, LLC and Specht Family, LLC to rezone 15601 North County Line Road from R-1 Single-Family Residential and AA Agricultural Districts to PUD-2037 Planned Unit Development District. Ward 1.

Technical Evaluation:

1. Future plats shall show access to common areas on the west, and include centrally located recreational amenities throughout the subdivision.

The applicant was present. There were no protestors present.

RECOMMENDED APPROVAL SUBJECT TO TECHNICAL EVALUATION.

MOVED BY NOBLE, SECONDED BY MEEK

AYES: CLAIR, POWERS, MEEK, PRIVETT, NEWMAN, GOVIN, NOBLE,
LAFORGE

ABSENT: PENNINGTON



STAFF REPORT
The City of Oklahoma City
Planning Commission
October 24, 2024

Item No. IV. 8.

(PUD-2037) Application by Westpoint Developers, LLC and Specht Family, LLC to rezone 15601 North County Line Road from R-1 Single-Family Residential and AA Agricultural Districts to PUD-2037 Planned Unit Development District. Ward 1.

I. GENERAL INFORMATION

A. Contacts

Applicant's Representative

Kendall Dillon
Crafton Tull
405-787-6270
Kendall.dillon@craftontull.com

B. Case History

This is a new application.

C. Reason for Request

The purpose of this application is to allow single-family residential with modified lot requirements.

D. Existing Conditions

1. Size of Site: 122.44 Acres

2. Zoning and Land Use

	Subject Site	North	East	South	West
Zoning	AA/R-1	AA	AA	R-1	AA/R-1
Land Use	Undeveloped	Undeveloped	Undeveloped	Undeveloped	Undeveloped

3. Comprehensive Plan Land Use Typology Area: Urban – Low Intensity (UL)

UL applies to the least intensively developed areas of the city that still receive urban water, sewer, police, park and fire services. Development in this area should provide horizontal integration of land uses, connectivity within and between individual developments, and design that facilitates pedestrian and bicycle transportation.

II. SUMMARY OF PUD

8.1.....USE AND DEVELOPMENT REGULATIONS

The use and development regulations of the **“R-1” Single-Family Residential District** shall govern this tract, except as herein modified, including conditional, special permit, special exception, and/or accessory uses subject to their appropriate conditions and review procedures for public hearings where applicable, unless otherwise noted herein.

9.0.....SPECIAL CONDITIONS

9.1MODIFIED LOT REQUIREMENTS

The following special conditions shall be made a part of this PUD:

Minimum lot size: 4,400 square feet

Minimum lot width from the platted front building line: 40 feet

Minimum lot depth: 110 feet.

Minimum depth of the front yard building line: 20 feet.

Coverage: Main and accessory buildings shall not cover more than 65% of the lot area.

9.2.....FAÇADE REGULATIONS

Exterior building wall finish on all primary structures, exclusive of windows and doors, shall consist of a minimum 60% brick veneer, rock, concrete board or stone masonry. No more than 40% EIFS, stucco, or wood shall be permitted. Exposed metal or exposed concrete block buildings shall not be permitted on primary structures.

9.3 LANDSCAPING REGULATIONS

The subject site shall meet all requirements of the City of Oklahoma City’s Landscaping Ordinance in place at the time of development.

9.4LIGHTING REGULATIONS

The site lighting in this PUD shall be in accordance with Chapter 59, Article XII, Section 59-12350 of the Oklahoma City Municipal Code, 2020, as amended.

9.5 SCREENING REGULATIONS

Screening shall conform with the Oklahoma City Municipal Code, 2020, as amended.

9.6 SUBDIVISION REGULATIONS

Subdivision shall conform to the Oklahoma City Subdivision Regulations, as amended.

9.7 DRAINAGE REGULATIONS

Drainage improvements, if required, will be in accordance with applicable sections of the Oklahoma City Code of Ordinances. Drainage-ways may be permitted and constructed in accordance with Chapter 16 of the Oklahoma City Municipal Code, which includes certain allowances in construction standards for PUD's, provided the PUD is platted with drainage areas confined to common areas. Such drainage-ways must be designed to handle adequate flows and cannot be built without specific approval of the City Engineer. The maintenance will be the responsibility of the property owners.

9.8 ACCESS REGULATIONS

Access shall be per the Subdivision Regulations, as amended. Additionally, this PUD shall have access to Dove Crossing's Section One, in five locations: Willow Blvd., Dove Crossing Dr., and Cordia Ln., N.W. 151ST Street, and White Ash Lane.

Streets or driveways on adjacent property within two hundred feet of this Planned Unit Development shall be shown on the Master Development Plan Map.

9.9PARKING REGULATIONS

The design and number of all parking facilities within this PUD shall be in accordance with Chapter 59, Article X of the Oklahoma City Municipal Code, 2020, as amended.

On-street queuing and maneuvering into parking spaces shall be permitted within the public rights-of-way. The location of the on-street maneuvering shall only be permitted within the frontage of a common area lot. All parking spaces shall be located on private property.

9.10 SIGNAGE REGULATIONS

Signage shall conform to the Oklahoma City Municipal Code, 2020, as amended.

9.11 ROOFING REGULATIONS

Roofing for all structures shall conform to adopted building code at the time of development.

9.12 SIDEWALK REGULATIONS

Five-foot sidewalks shall be constructed along the N. County Line Road. Six-foot sidewalks shall be required if the sidewalk is constructed adjacent to the curb. Sidewalks along the interior streets shall be four feet in width. All sidewalks shall be subject to the policies and procedures of the Public Works Department and ADA requirements.

9.13 HEIGHT REGULATIONS

The base zoning district regulations shall regulate heights of structures in this PUD.

9.14 SETBACK REGULATIONS

Unless modified herein, yard requirements in this PUD shall be the same as the base-zoning district.

9.15 PUBLIC IMPROVEMENTS

Public improvements shall be made by the property owner throughout the PUD as required by the City of Oklahoma City Public Works Department or other City, County, or State Department or agency. All Local, State, and Federal ordinances as they shall apply to the site will be adhered to fully.

9.16..... COMMON AREAS

Maintenance of the common areas, private drainage easements, and islands / medians in the development shall be the responsibility of the property owner or Property Owners Association. No structures, storage of material, grading, fill, or other obstructions, including fences, either temporary or permanent, that shall cause a blockage of flow or an adverse effect on the functioning of the storm water facility, shall be placed within the common areas intended for the use of conveyance of storm water, and/or drainage easements shown. Certain amenities such as, but not limited to, walks, benches, piers, and docks, shall be permitted if installed in a manner to meet the requirements specified above.

10.0 DEVELOPMENT SEQUENCE

Developmental phasing shall be allowed as a part of the development of this PUD.

11.0 EXHIBITS

The following exhibits are hereby attached and incorporated into this PUD. These exhibits are:

Exhibit A – Legal Description

Exhibit B – Master Development Plan

Exhibit C – Topographic Map

III. REVIEW COMMENTS

This application was submitted to the following agencies, departments, and/or divisions for review and comment. An asterisk * indicates that the agency, department, and/or division responded with no adverse comments.

A. Outside Agencies

- 1. Oklahoma City-County Health Department (OCCHD):**
- 2. Oklahoma City Urban Renewal Authority (OCURA):**
- 3. Oklahoma Gas and Electric (OGE):**
- 4. Oklahoma Natural Gas (ONG):**
- 5. Oklahoma Water Resources Board (OWRB):**
- 6. School District(s): Piedmont**
- 7. Oklahoma Department of Transportation (ODOT):**

B. City Departments

- 1. Airports:**
- 2. Central Oklahoma Transportation and Parking Authority (COTPA):**
- 3. Fire (OCFD) ***
- 4. Information Technology/Geographic Support (IT/GIS):**
- 5. Parks and Recreation:**
- 6. Police (OCPD):**
- 7. Public Works:**

a. Engineering

Storm Sewer Availability

- 1) The Public Works Drainage Division staff has reviewed the subject application. All development, new construction, and/or substantial improvements planned within the proposed area shall be subject to chapter 16 of the Oklahoma City Municipal Code.
- 2) Storm sewers in accordance with the City's Drainage Ordinance will be required. Development abutting section line roads with drainage flows that exceed the capacity of OKC standard ditch detail (D-100) will necessitate the installation of enclosed storm sewer and/or concrete channel. These improvements shall be placed to provide a minimum of 35' clearance distance from the centerline of the section. Concrete channels must be entirely outside public right-of-way.
- 3) A flood and/or drainage study will be required to establish finished floor elevations, common lot areas or private drainage easements. A final plat should not be submitted until the study has been reviewed and approved by the Public Works Department.
- 4) Flood Study will be required to show no rise in FEMA Q 100 and the City of Oklahoma City Q 100 water surface elevation, compared pre-and post-development.

- 5) A portion of subject property is situated within a F.E.M.A. Flood Plain. Therefore, the establishment of Minimum Finish Floor Elevation for each lot within the flood plain will be required (100-year) frequency plus 1'. The Public Works Department Engineering staff shall approve these elevations prior to the filing of the final plat.
- 6) A floodplain activity permit must be submitted for any work contemplated in The Waters of the United States.
- 7) A Corps of Engineers 404 permit must be submitted with plans for any work contemplated within the floodplain, creek, or channel (waters of the United States) included in the case limits.
- 8) Plans for drainage improvements within the private drainage reserves and/or common areas must be submitted for review, and payment of inspection fees shall be made prior to construction. Building permits will not be issued until construction is complete. If a subdivision abuts a stream, the private drainage easements and/or common area along stream shall extend to flow line of stream at a minimum.
- 9) Place the following note on the plat and construction plans: Maintenance of the Common Areas and/or Private Drainage Easements shall be the responsibility of the property owner. No structures, storage of material, grading, fill or other obstructions, including fences, either temporary or permanent shall be placed within the common areas and/or drainage easements shown.
- 10) Drainage easements shall be clearly denoted as public or private in owner's dedication, on the plat, and/or in the plat notes.
- 11) Construction within the limits of this PUD will require an erosion control plan in accordance with EPA Storm Water Discharge permitting: CFR Vol. 57, No. 175, September 9, 1992. A copy of the EPA Notice of Intent (NOI) will be required prior to the issuance of work orders or permits for construction activities disturbing an area of 1/2 acre or greater.
- 12) Sidewalk shall be installed for all new construction and/or at the time of a residential use to a more intense use on all lots having frontage on public streets classified as a major or minor arterial.
- 13) All private roads /streets will have private storm sewer systems.
- 14) Engineer/developers will be contacting PW for detention determination before they submit their final plat and plans.
- 15) Amend Section 9.7 Drainage Regulations: Drainage improvements, if required, will be in accordance with applicable sections of the Oklahoma City Code of Ordinances.

b. Streets, Traffic and Drainage Maintenance

c. Stormwater Quality Management

d. Traffic Services *

8. Utilities

a. Engineering

b. Solid Waste Management

- 1) The City can provide service, providing there is sufficient space for the truck to maneuver to service the addition.

c. Water/Wastewater Quality

Water Availability

- 1) An existing 12" water main(s) is located adjacent to the subject site(s).
- 2) A 12-inch water main is required to be loop through the development to provide adequate water supply and fire flow protection. Connection to two (2) separate active water mains is required to prevent partial or total shut-off of water supply when a pipeline failure occurs.
- 3) Minimum ten (10) feet horizontal separation required from wastewater mains and five (5) feet for other utilities. Minimum two (2) foot vertical separation required for all utility crossings. All water mains must have a minimum cover of five (5) feet along section line roads and four (4) feet elsewhere.
- 4) Proposed and/or existing water mains must be located centrally within a twenty (20) feet wide or larger utility easement or right-of-way. No trees, signs, dumpster, fence, and/or structures shall be permitted over any proposed or existing utility main. An approved revocable permit must be obtained to have any private improvement located within any utility easement and/or right-of-way.
- 5) Dead-end water mains must be avoided when possible. All existing unused water services must be capped and abandoned at the water main in accordance with the City Standard Specifications.
- 6) In accordance with ODEQ regulations, the City provides water at a minimum pressure of 25 psi. The developer is responsible for designing and construction of all fixtures to provide adequate domestic and fire protection under minimum pressure conditions. The developer will be responsible for any failure of domestic or fire protection systems which require water pressure in excess of 25 psi. The developer is responsible for installing pressure reducers if necessary for protection of developer's service lines, plumbing, and fixtures.
- 7) All existing and/or proposed water meters must be located in the right-of-way and/or utility easement within grassy areas outside of sidewalks, driveways, streets, and paving.
- 8) All domestic and fire suppression services must have a separate water service connection. Fire hydrant spacing shall not exceed 500 feet and must be located within ten (10) of a hard surface (i.e. sidewalk, street, paving).

- 9) Supply capacity for development is not guaranteed and will be reviewed at time of review of construction documents.
- 10) Plat may be revised after review and approval of utility plans.

Wastewater Availability

- 1) An existing 8” wastewater main(s) is located adjacent to the subject site(s).
- 2) Line capacity is not guaranteed and must be checked by the Engineer of Record and reviewed by the City.
- 3) The developer will be required to extend the City wastewater collection system to and across each lot or site within the subdivision in accordance with the City Standard Specifications and Private Development Design Manual.
- 4) Minimum ten (10) feet horizontal separation is required from water mains and five (5) feet for other utilities. Minimum two (2) feet vertical separation required for all crossings. All wastewater mains must have a minimum cover of four (4) feet and depth no greater than eighteen (18) feet. Developer is responsible for remediating any failure to maintain the minimum four (4) feet of cover.
- 5) Wastewater main(s) must be centrally located in a twenty (20) feet wide easement or larger if necessary. No trees, signs, dumpster, fence, and/or structures shall be permitted over any proposed or existing utility main. An approved revocable permit must be obtained to have any private improvement located within any utility easement and/or right-of-way.
- 6) All existing unused private wastewater service connections must be abandoned and capped at the main in accordance with City Standard Specifications and Private Development Design Manual.
- 7) Plat may be revised after review and approval of utility plans.

9. Planning

a. Comprehensive Plan Considerations

1) LUTA Development Policies:

Site Design:

- Avoid developing within or modification of 100-year floodplains or floodways.
- Large-scale (20+ acres or 50 or more single family units) residential subdivisions should provide a diversity of home sizes, lot sizes, price points, architectural styles, and density ranges.
- Where possible, provide a continuous system of open space along stream corridors or other appropriate areas that link neighborhoods and park lands.
- Utilize Best Management Practices (BMP) for stormwater whenever possible.
- Developments should be served by urban water and sewer utility systems.

Floodway and 100-year floodplain for Deer Creek are present on northern portion of the subject site. Plan conformance could be strengthened by providing a continuous system of open space along the creek corridor. The development is required to comply with all City, State, and Federal requirements within the floodplain. The conceptual plan indicates that lots would be located outside of floodway and floodplain areas. Public water and sewer are available.

Location:

- Locate uses that generate high traffic volumes along arterial streets, frontage roads, and interstates.

The subject site is located along North County Line Road and NW 150th Street, both arterial streets in the Urban Low Intensity LUTA.

Density: The Urban Low Intensity LUTA outlines a density range of 4 to 8 dwelling units per acre for single family residential. *The PUD proposes single-family residential development with a modified R-1 base. The PUD would allow a minimum lot size of 4,400 sf compared to the standard 6,000 sf for the R-1 District. The site was included in a larger area preliminarily platted as Dove Crossing in 2021 (C-7325). Land between the two portions of the subject site was platted as Dove Crossing Section 1 in 2021 (C-7368) and is not included in the rezoning request. The conceptual plan illustrates a different lot configuration than submitted with the previous preliminary plat. The PUD regulations could provide for densities within the Urban Low Intensity LUTA range.*

Automobile Connectivity:

- Maintain, create, and enhance a street network that is highly connected to increase number of viable commercial locations and the effectiveness of the transportation system.
- Limit number of dead-end streets and cul-de-sacs.
- Limit curb cuts on arterial streets, and where possible concentrate access at shared entrance points.
- Development fronting arterials should take access from intersecting streets where possible.
- Primary entrance points should be aligned with access points immediately across the street.
- Provide vehicular connectivity between adjacent developments.
- Subdivisions with more than 50 units should have at least two points of entrance / egress no closer than 300 feet apart.

The subject site does not currently have improved access from a public street. The Master Design Statement specifies access will be per the Subdivision Regulations. Access is specifically allowed to the platted Dove Crossing Section One at Willow Boulevard, Dove Crossing Drive, Cordia Lane, NW 151st Street, and White Ash Lane. The conceptual plan for the development illustrates that the southern portion of the subject site would utilize access from the north and west, with no new access points along North County Line Road or NW 150th Street. The northern portion of

land would utilize one new access point along North County Line Road and otherwise connect to planned streets to the south.

Pedestrian Connectivity:

- Provide sidewalk connections to adjacent development.

Sidewalks are not currently available on the subject site. The PUD requires sidewalks along North County Line Road and along interior streets.

- 2) **Compatibility:** The comprehensive plan includes a land use compatibility matrix used to identify potential conflicts between major land use categories. When locating the proposed uses adjacent to existing Agricultural or Low Intensity Residential, “Building Scale and Site Design” is a potential compatibility issue identified by the comprehensive plan.

Building Scale and Site Design: The comprehensive plan calls for mitigation measures for new projects if residential lot sizes in UL are less than 60% of directly adjacent residential lots, the setbacks are significantly deeper or more shallow than the predominant character of adjacent development; the building’s orientation to the street differs from the predominant character of adjacent development; building size or street frontage dramatically differs from that of adjacent uses, the lot coverage (including buildings and paved areas) dramatically exceeds that of adjacent uses, or if buildings within 40 ft. of a single-family residential structure exceed a 3:1 ratio in height. *No triggers requiring mitigation were identified.*

- 3) **Service Efficiency:**

- Water: *Served – Close to Service / Served*
- Sewer: *Served – Open Sewer Sheds or Served*
- Fire Service: *Rural or Urban Response*

- 4) **Environmentally Sensitive Areas:** The following apply to the proposed development site:

- **Riparian Areas:** Riparian areas are vegetated areas adjacent to streams, lakes, ponds, and wetlands that are composed of a mixture of trees, shrubs, and grasses. These areas may also contain floodplain. The comprehensive plan recommends a 100-foot buffer from stream banks. *Riparian area is present on the northern portion of the subject site where Deer Creek abuts the site. Floodway and 100-year floodplain are present. Plan conformance could be strengthened by providing a continuous system of open space along the creek corridor. The development is required to comply with all City, State, and Federal requirements within the floodplain. The conceptual plan indicates that lots would be located outside of floodway and floodplain areas.*
- **Upland Forests:** N/A
- **Vulnerable Aquifers:** N/A

- 5) **Transportation System:** This site is located along North County Line, a Major Arterial Street, and NW 150th Street a Minor Arterial Street, both in the Urban Low LUTA. Transit (bus) service is not available nearby. According to Streetlight data, last collected in 2022, North County Line had 1,633 average daily trips, with a

capacity of 10,000 and NW 150th Street had 754 average daily trips, with a capacity of 10,000.

6) Other Development Related Policies

- Support diversity and integration of housing unit types and sizes in all land use typology areas in order to meet the diverse needs of households of different sizes, generational needs, incomes, and preferences. New residential subdivisions should achieve a mixture of housing types within a unified development. (SU-4)
- Require sidewalks on both sides of all streets in urban LUTAs. (C-7)
- Improve the functionality and efficiency of the street network by:
 - Providing direct connections from residential developments to nearby places and to each other.
 - Providing street and sidewalk stubs to adjacent vacant land in anticipation of future development.
 - Connecting new development to existing street and sidewalk stubs, and to existing trail, open space, and bicycle networks.
 - Reducing block sizes and use of dead-end streets.
 - Maintaining the existing street grid to preserve connectivity and mobility options. (C-11)
- Limit driveways on arterials and collectors and increase connections between uses to improve safety and traffic efficiency. (C-30)
- Ensure proper access to and between subdivisions in order to offer a choice in routes for residents, multiple access points for emergency responders, and to reduce vehicle congestions at arterial intersections. (C-32)
- Avoid under-grounding streams to the greatest extent possible. Where feasible, encourage the re-surfacing of buried streams. Limit the use of culverts or other structures that alter natural streams, and require designs that minimize impacts to stream health and function. (G-11)
- Preserve mature, healthy trees and incorporate them into the design of new development or redevelopment projects to the greatest extent possible. (G-26)
- Incorporate natural features (such as ponds, lakes, streams, rock outcroppings, stands of mature trees, and/or sizeable individual trees) into the design of all residential, commercial, and industrial projects rather than eliminating, hiding, or limiting access to those features. (E-31)
- Encourage unified planning for all adjoining land owned or controlled by a project's developer to ensure proper circulation and land use relationships (SU-47)

b. Plan Conformance Considerations

The subject site consists of two portions of land along the west side of North County Line Road, partially located at the northwest corner of North County Line Road and NW 150th Street. The site is undeveloped and zoned R-1. The northern portion of land surrounds a 2.5-acre parcel which is zoned AA and utilized for oil and gas operations. The corner of the arterial intersection was rezoned from PUD-1599, which had a C-3

base zone and allowed commercial / office development, to the R-1 District in 2021. The site was included in a larger area preliminarily platted as Dove Crossing in 2021 (C-7325). Land between the two portions of the subject site was platted as Dove Crossing Section 1 in 2021 (C-7368) and is not included in the rezoning request. Deer Creek runs along the northern boundary of the site and includes floodway and floodplain. North of Deer Creek are 26- and 80-acre AA zoned parcels that are primarily used for agricultural purposes. To the east of the site, across North County Line Road, are 76- and 157-acre AA parcels that are used for agriculture. To the south is the Montereau subdivision (PUD-1095) which has been partially developed as single-family residential but also allows the R-1ZL and C-3 Districts within currently undeveloped tracts. Land to the west of the subject site would remain zoned as a mixture of AA and R-1 with portions of the land having been platted previously.

The PUD proposes single-family residential development with a modified R-1 base. The PUD would allow a minimum lot size of 4,400 sf compared to the standard 6,000 sf for the R-1 District; a minimum lot width of 40 feet instead of 50 feet; and lot coverage of 65 percent instead of 50 percent in the R-1 District. The floodplain surrounding the site provides opportunity for open space and recreational amenities for residents. Future plats should show access to the stream bank common areas from the subdivision, and centrally placed amenities and green space for all residents.

IV. STAFF RECOMMENDATION

Staff recommendations are advisory only and do not constitute Planning Commission decisions. Staff recommendations are based on a technical evaluation of information submitted at the time of review. Determination of conformance with policies contained in the comprehensive plan is the purview of the Planning Commission. Planning Commission decisions require a vote of five members to approve or deny an item. The Planning Commission may consider in its decision-making process any additional relevant information presented at the public hearing by the public, applicant, and/or City departments.

Approval of the application subject to the following Technical Evaluations:

1. Future plats shall show access to common areas on the west, and include centrally located recreational amenities throughout the subdivision.

All Engineering Division and Water/Wastewater Utilities Division requirements must be met. Additional changes to the PUD may be required during either Divisions review of construction plans and prior to City Council approval.

taj

Case No: PUD-2037

Applicant: Westpoint Developers, LLC and Specht Family, LLC

Existing Zoning: R-1 / AA

Location: 15601 N. County Line Rd.

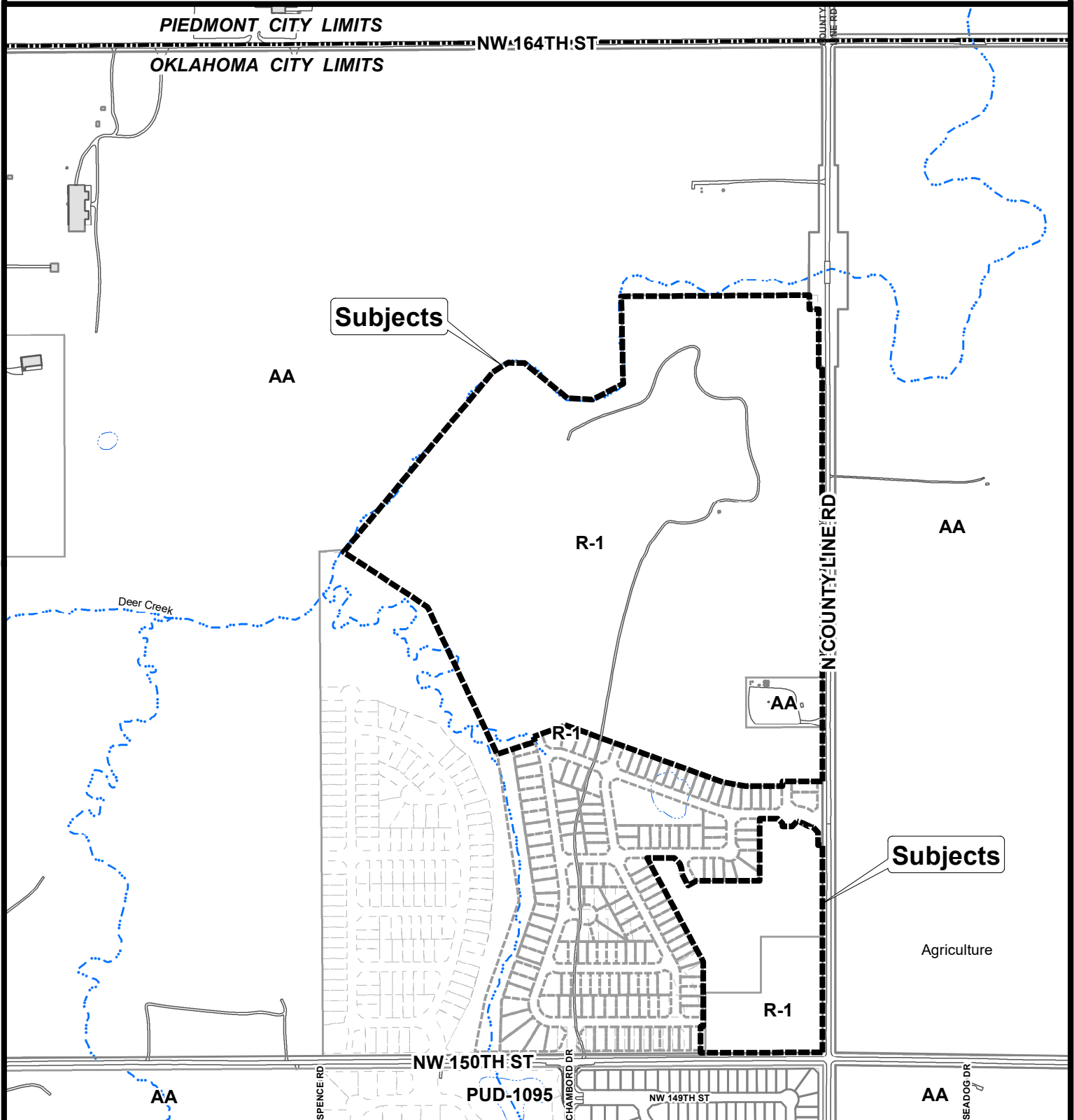

The City of
OKLAHOMA CITY

Planned Unit Development



0 350 700
Feet

DOVE CROSSING
A PART OF THE E/2 OF SECTION 1, T13N, R5W, I.M.
OKLAHOMA CITY, CANADIAN COUNTY, OKLAHOMA

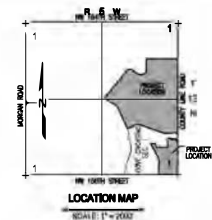

80
LEGAL DESCRIPTION

A tract of and situated within the Southeast Quarter (SE/4) of Section 06 of (T), Township Thirteen North (T13N) Range Five West (R5W) of the 6th Principal Meridian (6M) in Oklahoma City, Canadian County, Oklahoma being more particularly described by metes and bounds as follows:

BEGIN 310 at the Southwest corner of old Southwest Quarter; thence S89°32'25"W along South line of said SE/4 of \square 3.40 feet same being the Southwest corner of DOW CROSSING SECTION 1, according to the record plat thereof; thence along said boundary line the following:

- [illegible]

TOGETHER WITH

TOGETHER WITH

t Half (E/-) of Section One (1) Township Thirteen North
(T13N) Range 10 West (R10W) of Third on Meridian (3-M) in Oklahoma City, Canadian County, Oklahoma,
hereinafter particularly described by metes and bounds as follows:

DEB 11050 at the Southwest corner of the South of Davis (SE/4) of said E/2: there

NDDM: 30'W along the East line of said SE/4 of d. 1446.04 feet to a point being the Northwest E of corner of DOME CROSSING SECTION 1, according to the recorded plat thereof; thence along the exterior boundary line of said plat the following Nine (9) courses:

- [illegible]

EXHIBIT 11

OWNER/DEVELOPER
WESTPOINT DEVELOPERS, LLC
 2731 S. I-35 SERVICE RD. □
 MOORE, OK



SHEET NO.: 1 OF 2
DATE: 8/28/2024
PROJECT NO.: 216088-00

MASTER DEVELOPMENT PLAN OF DOVE CROSSING

A PART OF THE E/2 OF SECTION 1, T13N, R5W, I.M.
OKLAHOMA CITY, CANADIAN COUNTY, OKLAHOMA

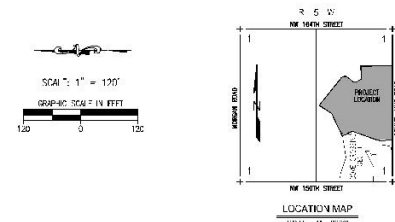

LEGAL DESCRIPTION

A tract of land situated within a portion of the East Half (E/2) of Section One (1), Township Thirteen North (13N), Range Five West (5W) of the Indian Meridian (1816) in Oklahoma City, Canadian County, Oklahoma, being more particularly described by metes and bounds as follows:

BECKING at the Southeast corner of the Southeast Quarter (SE/4) of said E/2, thence

N00°04'59"W along the East line of said SE/4 a distance of 1446.04 feet to a point being the Northeast corner of said SE/4, thence S00°04'59"E a distance of 1210.41 feet to the POINT OF BEGINNING.

1. S88°55'01"W a distance of 235.00 feet; thence
2. S00°04'59"E a distance of 23.34 feet; thence
3. S88°55'01"W a distance of 192.85 feet; thence
4. N82°05'35"W a distance of 115.70 feet; thence
5. N00°04'59"E a distance of 510.04 feet; thence
6. S08°39'34"W a distance of 2.30 feet; thence
7. S102°22'01"W a distance of 174.26 feet to a point on a non-tangent curve to the right; thence
8. 26.51 feet along the arc of said curve being a circle of 310.52 feet, subtended by a chord of 26.51 feet which bears S88°17'24"E, thence
9. S102°02'01"W a distance of 285.79 feet; thence
10. S00°04'59"E a distance of 544.12 feet; thence
11. S08°42'16"E a distance of 12'54" feet; thence
12. S08°42'16"E a distance of 92.20 feet; thence
13. S88°25'05"E a distance of 45.30 feet; thence
14. S56°42'38"E a distance of 388.70 feet; thence
15. S88°47'44"E a distance of 133.37 feet; thence
16. S88°56'07"E a distance of 150.53 feet; thence
17. S01°24'19"W a distance of 455.57 feet; thence
18. S08°17'54"E a distance of 102.57 feet to a point on the East line of the Northeast Quarter (NE/4) of said E/2; thence
19. S00°04'59"E along the East line of said NE/4 a distance of 1210.41 feet to the POINT OF BEGINNING.

Said tract contains 4.561,013 Ac. Ft. or 104.71 Acres, more or less.

LINE TABLE			
LINE #	LENGTH	DIRECTION	
1	23.34'	S00°04'59"E	
2	2.30'	S88°39'34"W	

CURVE TABLE					
CURVE #	LENGTH	RADIUS	DELTA	CHORD DIRECTION	CHORD LENGTH
1	26.51'	310.52'	00°49'30"	S88°17'24"E	26.51'

OWNER/DEVELOPER
WESTPOINT DEVELOPERS, LLC
2731 S. I-35 SERVICE RD.
HOUSTON, TX 77058



SHEET NO. 1 OF 1
DATE 8/28/2024
PROJECT NO. 216088-00

EXHIBIT A

Case No: PUD-2037

Applicant: Westpoint Developers, LLC and Specht Family, LLC

Existing Zoning: R-1 / AA

Location: 15601 N. County Line Rd.



Aerial Photo from 2/2022



The City of
OKLAHOMA CITY

Planned Unit Development



0 350 700
Feet