

Project MP-0629

Bricktown Canal Lighting Improvements

Preliminary Report

Prepared For:

The City of Oklahoma City
Public Works Department
420 W. Main Street, Suite 700
Oklahoma City, OK 73102

Prepared On:

04/23/2024

PREPARED BY:



wallace
design
collective

Wallace Design Collective, PC
410 N. Walnut Avenue, Suite 200
Oklahoma City, OK 73104
405.236.5858

THE CITY OF OKLAHOMA CITY

APPROVAL SHEET

MP-0629 BRICKTOWN CANAL LIGHTING IMPROVEMENTS

PREPARED BY:

Wallace Design Collective, PC
410 N. Walnut Avenue, Suite 200
Oklahoma City, OK 73104
405.236.5858





Christopher R. Savage, P.E.

Recommended for Approval



Melinda McMillan-Miller, Director

Parks and Recreation Department



Deborah K. Miller, P.E.

Public Works Director/City Engineer

APPROVED by the Council of the City of Oklahoma City this 21ST day of MAY, 2024

ATTEST:

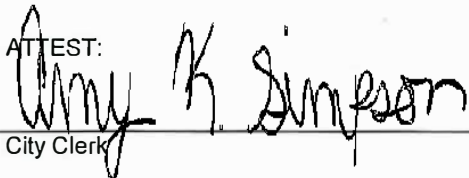

City Clerk





Table of Contents

1.	Executive Summary	1
2.	Project Description	2
3.	Scope of Work	3
4.	Existing Conditions	3
5.	Survey and Assessment Overview	4
6.	Proposed Improvements	4
7.	Project Budget and Proposed Construction Costs	7
8.	Project Schedule	8
9.	Conclusions and Recommendations	8

List of Figures

Figure 1: Project Limits	2
Figure 2: Electrical Service Locations	5
Figure 3: Existing Panel 'EX'	6
Figure 4: Existing Panel 'EH2'	6
Figure 5: Existing Panels 'H1' and 'L1'	6
Figure 6: Existing Panel 'H2'	6

List of Tables

Table 1: Engineer's Estimate of Probable Cost – Base Bid	7
Table 2: Estimated Schedule for Completion of Project.....	8

List of Appendices

- A. Preliminary Plan Set
- B. Engineer's Estimate of Probable Cost
- C. Proposed Light Fixture Information

1. Executive Summary

The City of Oklahoma City (the City) has a goal of updating the site lighting system serving the Lower Bricktown Canal. The area is currently lined with too few and outdated lighting fixtures, making the area dark, uninviting, and unsafe. Lighting improvements to the Upper Canal completed in 2022 have resulted in a boost to the local economy by encouraging residents and visitors to explore everything from shops and eateries to the Bricktown canal water taxi. Project MP-0629 addresses similar updates to the lighting system from the Reno Avenue bridge to the Oklahoma City Boulevard bridge.

Wallace Design Collective was retained to assess the Lower Canal lighting system with a focus on safety, aesthetics, and general ambiance.

Project budget information and proposed constructions costs are summarized below:

- Funding appropriations
 - American Rescue Plan Act (ARPA) Funds - **\$500,000**
 - Oklahoma City Parks and Recreation Department - **\$1,000,000**
- Total fixed limit of construction - **\$1,245,000**
- Estimated cost of construction - **\$1,240,864**

The project schedule is summarized below:

1. Final Plans – Summer 2024
2. Begin Construction – Fall 2024
3. Project Completion – Fall 2025

Recommendations align with the City's desire to improve the lighting system serving the Lower Bricktown Canal. Improvements include replacement of existing lighting features from the Reno Avenue bridge to the Oklahoma Boulevard bridge with fixtures similar to those currently installed along the Upper Canal and providing ancillary accent lighting for landscape features and wall packs beneath bridges. All fixtures are vandal-resistant and use the latest LED technology and the same control systems implemented on the Upper Canal. These upgrades will improve safety, aesthetics, and general ambiance, making the area more attractive and ultimately boosting the local economy.

2. Project Description

The Oklahoma City Parks Department (the City), in conjunction with several Bricktown stakeholders, desires to replace and update the site lighting system serving the Lower Bricktown Canal and retained Wallace Design Collective to assist with improving illumination, aesthetics, public safety, and to provide options regarding the use of technologically advanced lighting features. The area for this project starts at the Reno Avenue bridge and extends to Oklahoma Boulevard Bridge as shown in Figure 1 below.

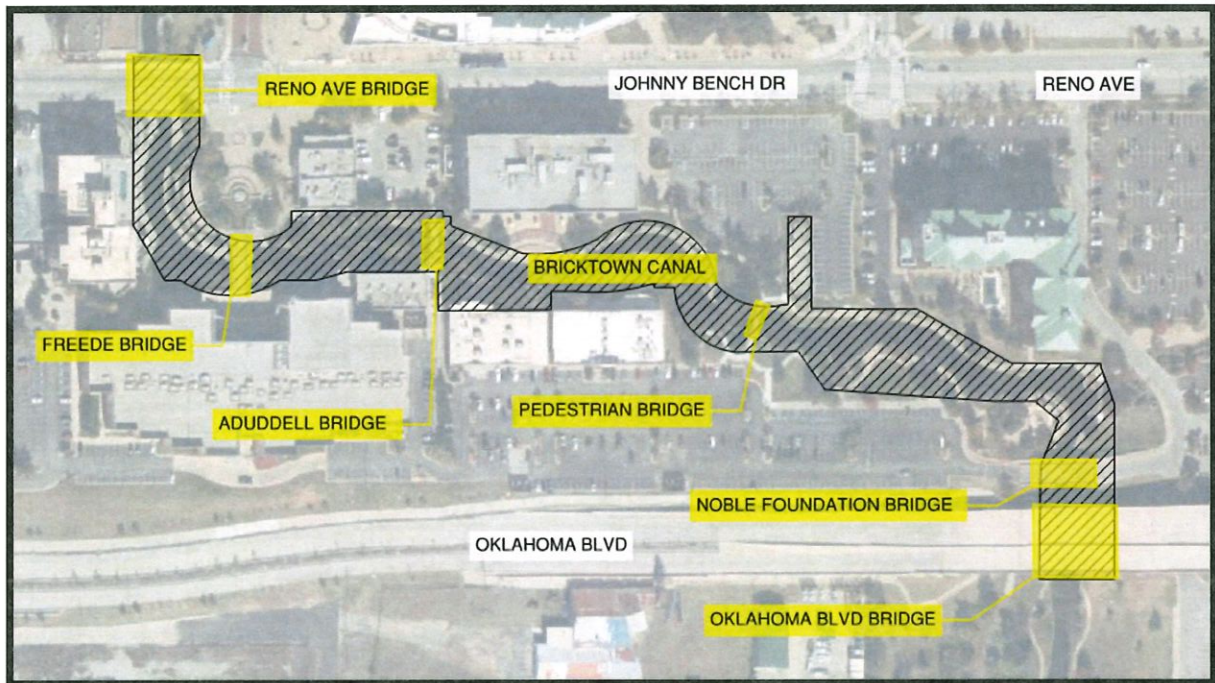

Figure 1: Project Limits

Design includes lighting recommendations to enhance existing elements of the canal's infrastructure including architecture, landscape, water-scape, and other elements to broaden the appeal of the Lower Canal. Fixtures in use on the north zone of the Upper Canal are to be implemented to the extent possible with new fixtures added as necessary. Design is to be coordinated with other improvements planned by the various stakeholders.

3. Scope of Work

The following items are included with the scope of work:

- Field observation of the existing lighting during daytime and nighttime conditions
- Identifying and cataloguing existing light fixtures and electrical infrastructure
- Assembling a base plan from record-drawing information provided by the City and from readily available aerial photography
- Identifying proposed private stakeholder improvements
- Developing a lighting master plan and schematic access plans
- Recommending two (2) alternate lighting schemes at the Reno Avenue bridge and the Noble Foundation bridge
- Identifying rights-of-way required
- Assessing and preparing an itemized cost estimate for all improvements
- Preparation of a design narrative addressing proposed improvements, alternates, entitlement requirements, and costs
- Meeting with and assisting stakeholders with ranking improvements and determining a preferred Project scope of work

4. Existing Conditions

Lighting improvements were completed along the Canal north of the Reno Ave bridge in 2022. When comparing the Upper Canal with the lower section, it is clear that lighting upgrades should extend south and east to the Oklahoma Blvd bridge.

The City has identified several concerns related to the specific visual needs of visitors to the Lower Canal as it relates to safety, security, and suitability to activity at nighttime. Aspects of those needs include:

- Overall light quality with regards to pedestrians
- Suitability of the lighting for reinforcing the desired look and feel of the Lower Canal and its surroundings
- Functional lighting needs with respect to pathways and other gathering spaces
- Functional lighting needs with respect to recreational needs and special events
- Aesthetic lighting needs for the nighttime visual enhancement of architecture and landscape
- Understanding of costs

The purpose of this report is to define lighting and lighting control approaches that will enhance nighttime usability and appeal. The existing lighting system for the Bricktown Canal is a mixture of bollards, pole lights, and uplights. Not all fixtures are working and/or are damaged. The existing bollards are currently utilizing screw-in light bulbs in which not all are the same color temperature or wattage. The current lighting photometric situation is that there is light right by the individual bollards, but the light levels are down to zero

between each bollard. There are several not working, which creates long, unlit distances difficult for pedestrians to navigate.

The north portion of the Bricktown Canal was renovated recently to newer more efficient LED lighting, and the lighting levels are at a more desirable level north of Reno Ave. After visiting the site to understand light levels on the north side, it was found that the north side ranges from 1fc to 6fc at ground level depending on proximity of the meter to the pole light.

5. Survey and Assessment Overview

The evaluation of the Lower Canal was conducted by Wallace Design Collective and DA Engineering, electrical engineering consultants. The survey had a number of specific goals.

- Gain a comprehensive understanding of daytime and nighttime lighting conditions.
- Take lighting measurements needed to assess technical compliance with recommended illumination guidelines.
- Consider impact on subjective concerns of pedestrians.
- Consider impact on security concerns of stakeholders and Oklahoma City Police.

The lighting review provided a basis from which the design process began. Observations of existing lighting are summarized below:

- The principal light sources along the canal from the Reno Ave bridge to the unnamed pedestrian bridge consist of waist-high light bollards.
- Currently there is no dedicated lighting from the pedestrian bridge to the Oklahoma Blvd bridge. Lighting at night in this area is almost non-existent, except for spill from 30'-tall OG&E light poles (five(5) total) located south of the canal.
- Vandalism of existing fixtures is evident along the full length of the canal.

6. Proposed Improvements

The key elements in a successful lighting design include:

- Providing adequate functional illumination of pathways, gathering areas, and pedestrian interaction zones.
- Exercising precise control over stray light and glare can erode visibility and compromise perception.
- Incorporating, where practical, the use of accent illumination and highlight to reveal landscape, hardscape, and architectural features.
- Furnishing specialty lighting for artwork and other feature elements requiring acknowledgment.

Standards and Codes

Standards and Codes from the 2017 National Electric Code were referenced for the basis of design.

Power Distribution

Power distribution for Lower Canal lighting is summarized below:

- The existing electrical system is fed from four different areas (Panel Group #1, Panel Group #2, Panel Group #3, and Panel Group #4) as shown in Figure 2 below.

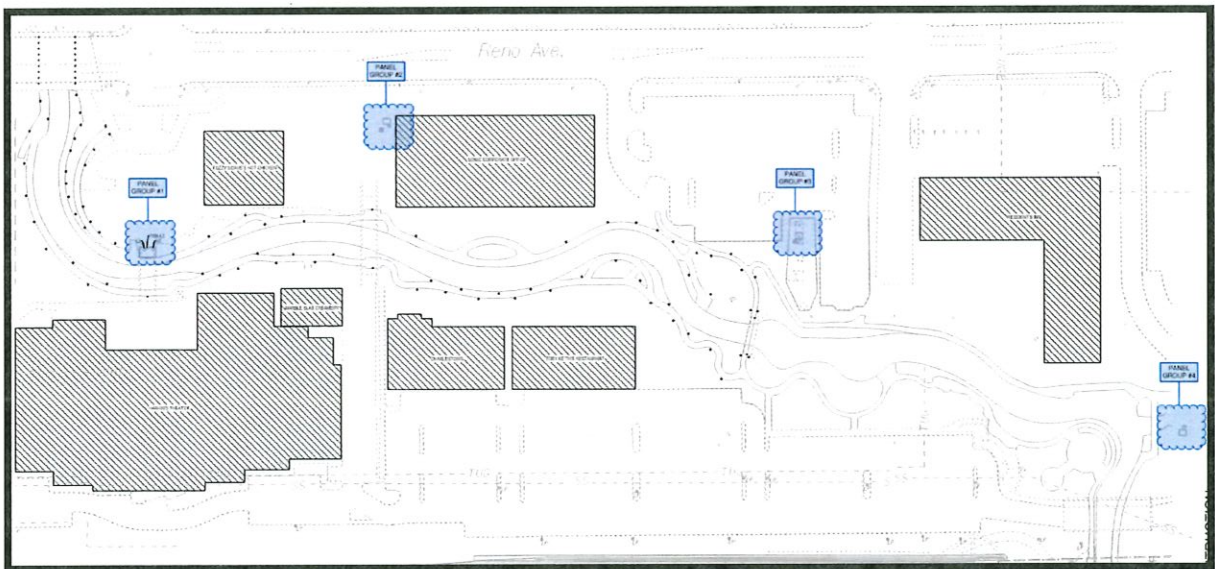

Figure 2: Electrical Service Locations

- Panel Group #1 and #2 are 480V, 3-phase electrical services while Panel Groups #3 and #4 are 208V, 3-phase electrical services. For Panel Group #2, Panel 'H1' is a 600A, 480V, 3-phase panelboard that provided power to the majority of the lighting and power around the Bricktown Canal. From the existing 'HP' it serves:
 - T1: 45kVA step down transformer to 208V, 3-phase. 'T1' serves Panel 'L1': 125A, 208V, 3-phase panel.
 - Panel 'H-2': 400A, 480V, 3-phase panel. 'H-2' serves 'T2' a 45kVA step down transformer. 'T2' serves 'L-2' a 125A, 208V, 3-phase panel.
- 'H1', 'T1', and 'L1' are located at Panel Group #2.
- 'H2', 'T2', and 'L2' are located at Panel Group #1.

- Panel Group #3 has an existing 208V utility transformer serving Panel 'EH2'. This panel provides power to lighting and receptacles from the Sonic Building to the unnamed pedestrian bridge.
- The design intent is to reuse these panels to serve all the new lighting. Figures of the existing panels are provided below:



Figure 3: Existing Panel 'EX'



Figure 4: Existing Panel 'EH2'

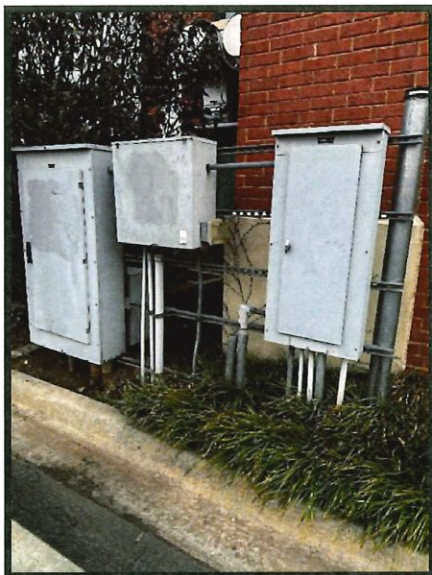

Figure 5: Existing Panels 'H1' and 'L1'



Figure 6: Existing Panel 'H2'

- For the furthest east segment of the scope of work, from the pedestrian bridge to the Oklahoma Blvd bridge, the lights will be powered from the existing 208V, 3-phase electrical panel 'EX' located at Panel Group #4.
- AFCI and GFI breakers shall be provided as required by code.
- Branch circuit conductors shall be no smaller than #12 AWG copper.
- Provide tamper proof receptacles as required per NEC (National Electrical Code)
- All receptacles shall be grounding type.
- All receptacles installed outdoors shall have ground-fault circuit interrupter protection as required by the National Electric Code.

Conduit

- Design intent is to reuse existing conduit and wire for light fixtures. The electrical contractor will extend wire and conduit into new pole lights. All new electrical conduits for site lighting shall be a minimum 1" in diameter PVC routed 24" below grade unless indicated otherwise on the drawings.
- Buried in concrete or outdoors, conduit shall be PVC with rigid steel elbows.
- Service entrance conduit shall be galvanized rigid steel.

7. Project Budget and Proposed Construction Costs

The project budget limits the quantity of poles to be provided for the scope of work. The design includes 36 poles that will provide a .5fc to 6fc along the canal walkway and more of an ambience feel of .1fc to .5fc in adjacent landscaped areas by bringing in tree uplights to the design. Ancillary lighting, including tree fixtures, in-grade fixtures, and wall packs for bridges are also proposed. The estimate of probable construction costs is presented in Table 1.

Table 1: Engineer's Estimate of Probable Cost – Base Bid

Description	Estimated Cost
General Conditions	\$136,435.00
Electrical Lighting & Replacement	\$815,452.00
SUBTOTAL	\$951,887.00
Insurances (1.00%)	\$9,519.00
Builders Risk (0.65%)	\$6,187.00
Bond (1.40%)	\$13,326.00
SUBTOTAL	\$980,920.00
Fee (10.00%)	\$98,092.00
SUBTOTAL	\$1,079,012.00
Contingency (15.00%)	\$161,852.00
TOTAL	\$1,240,864.00

8. Project Schedule

The estimated schedule for completion of this project is presented in Table 2.

Table 2: Estimated Schedule for Completion of Project

COKC Review and Approval	4 weeks
Constructions Documents	8 weeks
Bidding Phase	8 weeks
Construction Activities	12 months

9. Conclusions and Recommendations

The existing pathways along the Lower Canal are far too non-uniform, brought about by improperly spaced light poles. Safety and security are significantly compromised due to this situation. The overall look of the Lower Canal at night is unattractive, uninviting, and unsafe. Upgrades to the lighting in this area should be made for reasons of safety, security, and visual appeal.

It is recommended that lighting along the entire canal be illuminated in a consistent manner. These upgrades should include:

- Remove the existing bollard luminaires and replace them with a new pedestrian lighting system south of the Reno Avenue bridge for general illumination, wayfinding, and to remove the current ominous look of the entire area.
- Provide lighting between the pedestrian bridge and the Oklahoma Boulevard bridge using fixtures of the same type currently along the Upper Canal.
- Provide accent lighting for landscape features.
- New fixtures should include vandal-resistant properties.

The Contractor will need to work closely with property owners in the area to determine appropriate laydown and storage areas while coordinating closure of areas during construction activities.

Due to the current inflationary conditions and supply chain interruptions, holding the line on construction costs and minimizing schedules may be problematic. Minimum evaluation criteria for bid selections should include cost, equipment delivery schedules, and good references for both bidders and suppliers.

Finally, inflated pricing for sole source lighting packages is expected. It is recommended that alternates be accepted for certain light fixtures that meet design requirements.

APPENDIX A
PRELIMINARY PLAN SET

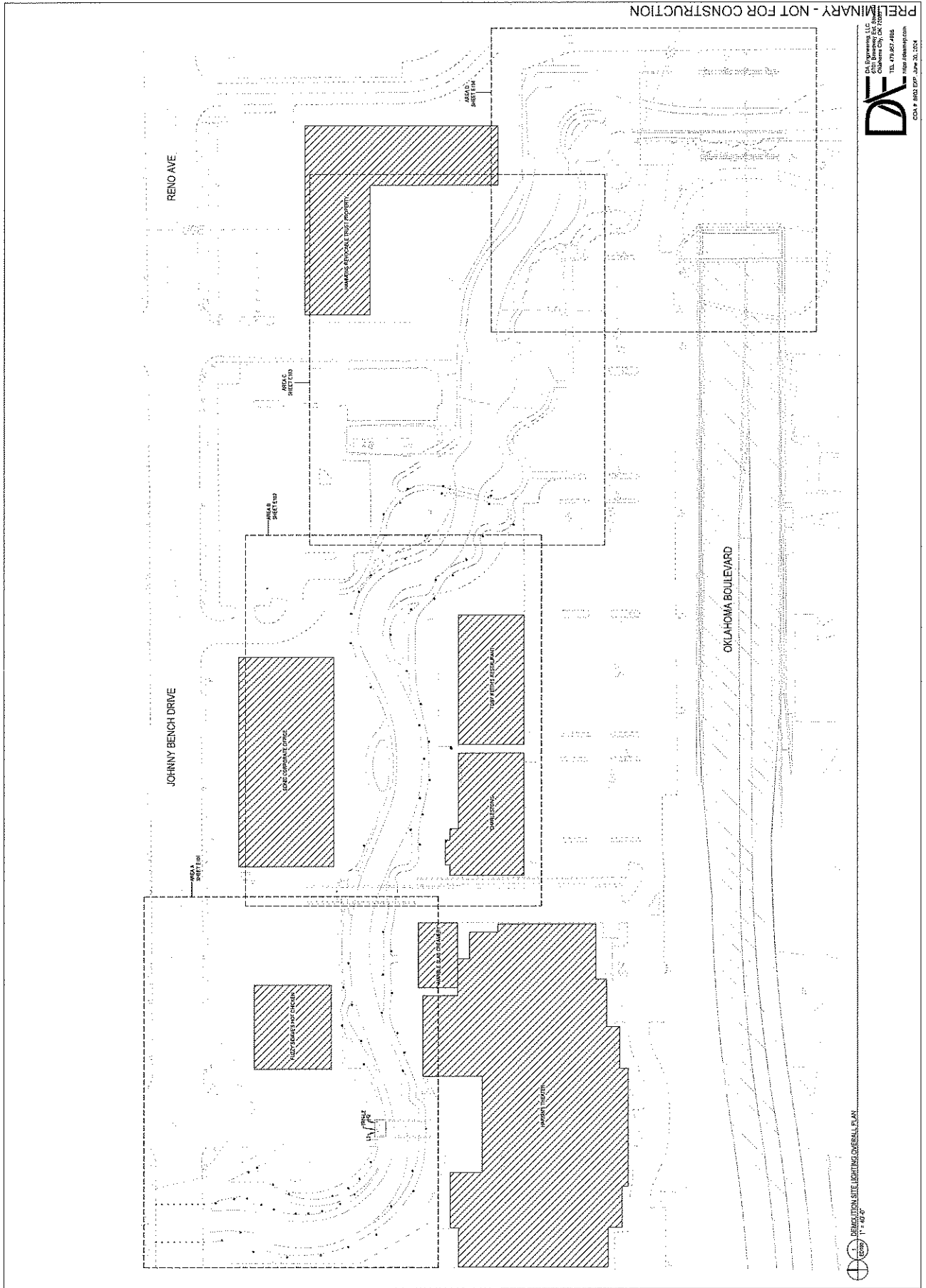

DEMOLITION GENERAL NOTES

- [illegible]

DEMOLITION SITE KEYED NOTES

1. E.C. SPALL: REPLACE EXISTING BOLLARD LIGHT WITH NEW PRESERVE WARE BOLLARD LIGHT. REMOVE, HANG UP TO SHEETS E.C. THRU EXISTING PARTNER DETAILS.
2. E.C. SPALL: REMOVE EXISTING BOLLARD AND CONCRETE BASE. PRESERVE EXISTING BOLLARD LIGHT. HANG UP TO SHEETS E.C. THRU EXISTING PARTNER DETAILS.
3. E.C. SPALL: REMOVE EXISTING WALL PINK AND REPLACE WITH NEW CONCRETE. HANG UP TO SHEETS E.C. THRU EXISTING PARTNER DETAILS.
4. EXISTING GAGE POLE LIGHT TO REMAIN.

4. EXISTING GAGE PILE LIFT TO REMAIN.

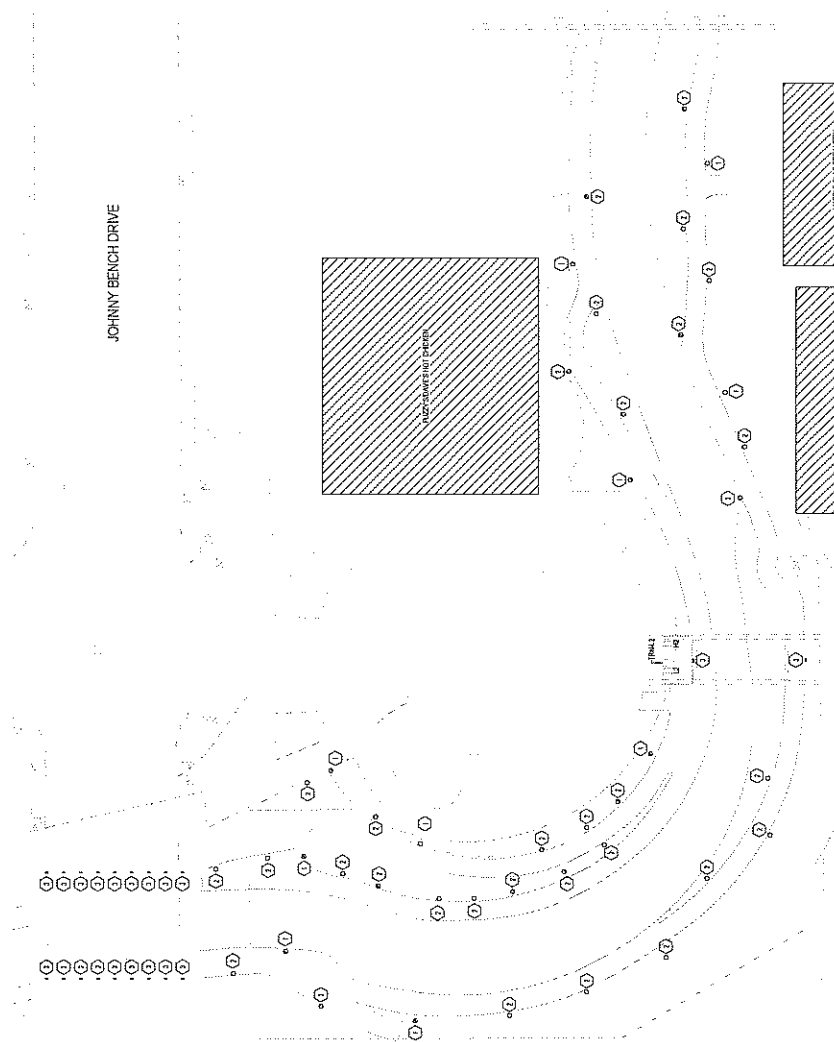

DEMOLITION SITE LIGHTING - AREA A

1' = 20' - 40''

FE
 OA Engineering, LLC
 6101 Broadway East, Suite 200
 Olathe, KS 66061
 TEL: 475-967-4306
<http://danielap.com>

COA # 8802 EXP JUN 30, 2024

PRELIMINARY - NOT FOR CONSTRUCTION

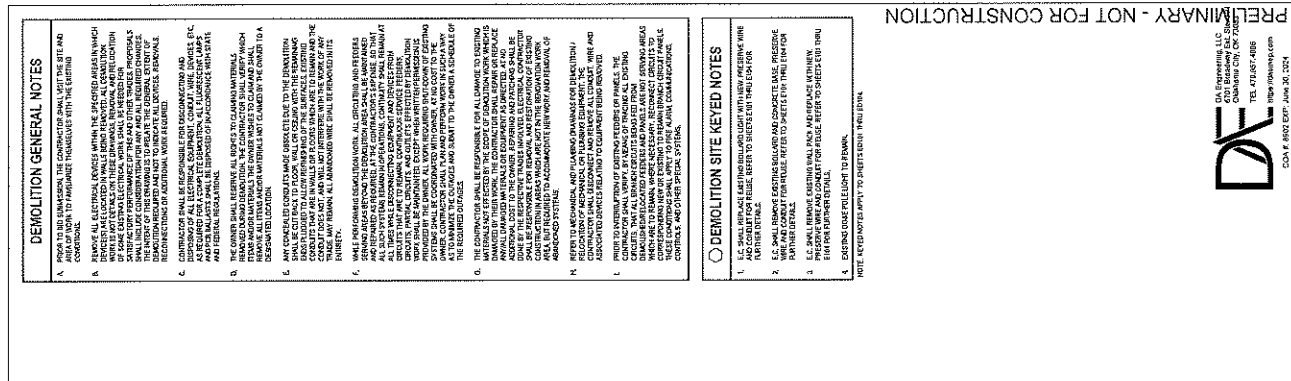
[illegible]

PRELIMINARY - NOT FOR CONSTRUCTION

DATE	DESCRIPTION	REV	DATE	PROJECT NO.	03/29/2024
				235-0055	
				SHEET NAME	
				DEMOLITION SITE	
				LIGHTING-AREA C	
				SHEET NO.	
				ED103	

BRICKTOWN CANAL LIGHTING
IMPROVEMENTS, MP-0629
OKLAHOMA CITY, OKLAHOMA

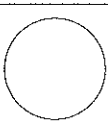

DEMOLITION GENERAL NOTES

- [illegible]

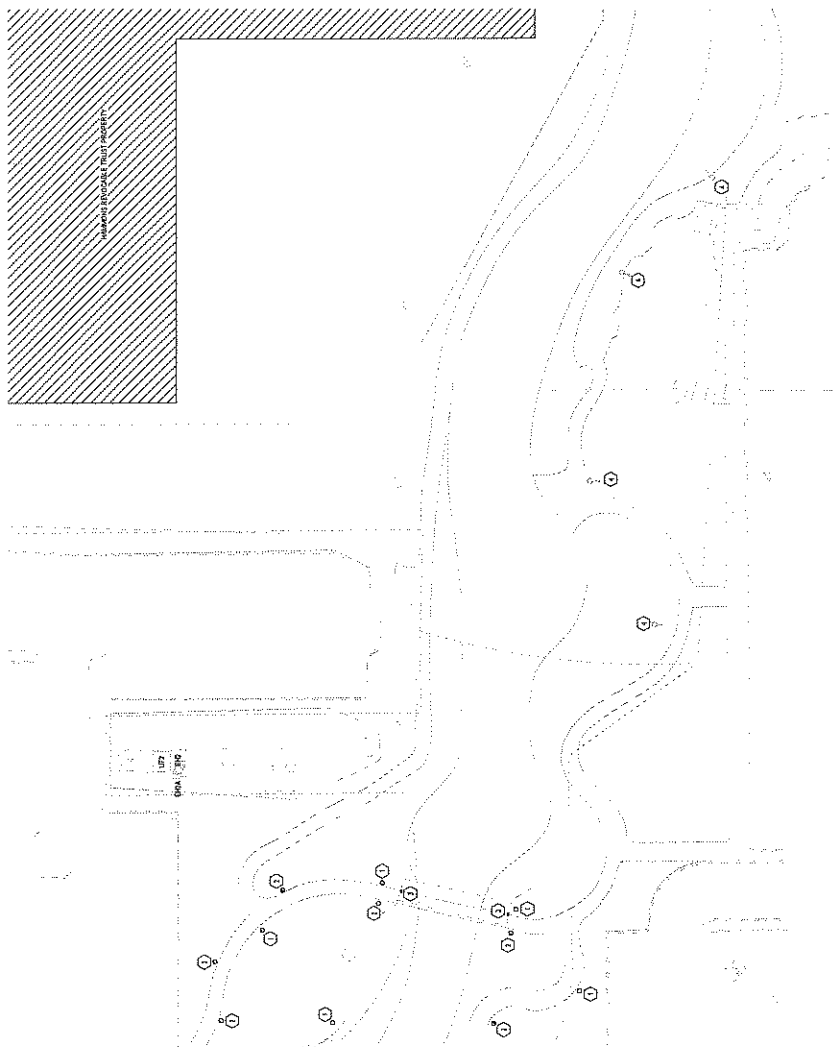

ED 103 1' = 20'-0"

DEMOLITION GENERAL NOTES

- [illegible]

DEMOLITION SITE KEYED NOTES

1. I.C. SHALL REPLACE EXISTING BOLLARD LIGHT WITH NEW PRESERVE WRE AND CONDUIT FOR REUSE. REFER TO SHEETS E101 THRU E104 FOR FURTHER DETAILS.
2. I.C. SHALL REMOVE EXISTING INLAND AND CONDUITS BASE PRESERVE WRE AND CONDUIT FOR REUSE. REFER TO SHEETS E101 THRU E104 FOR FURTHER DETAILS.
3. I.C. SHALL REMOVE EXISTING WALL PACT AND REPLACE WITH NEW PRESERVE WRE AND CONDUIT FOR REUSE. REFER TO SHEETS E101 THRU E104 FOR FURTHER DETAILS.
4. EXISTING OF THE SITE IS LEFT TO REMAIN.

NOTE: INFORMATION APPLIES TO SHIFTS A-D ONLY. HOURS FOR E AND F CHANGING DUE TO OCCUPATIONAL HEALTH.

2021年11月

DA Engineering, LLC
6301 Broadway East, Suite
Columbus, OH 43213
TEL 479.857.4505
<https://daemep.com>

COA # 2802 EXP. JUN 30, 2024

PRELIMINARY - NOT FOR CONSTRUCTION

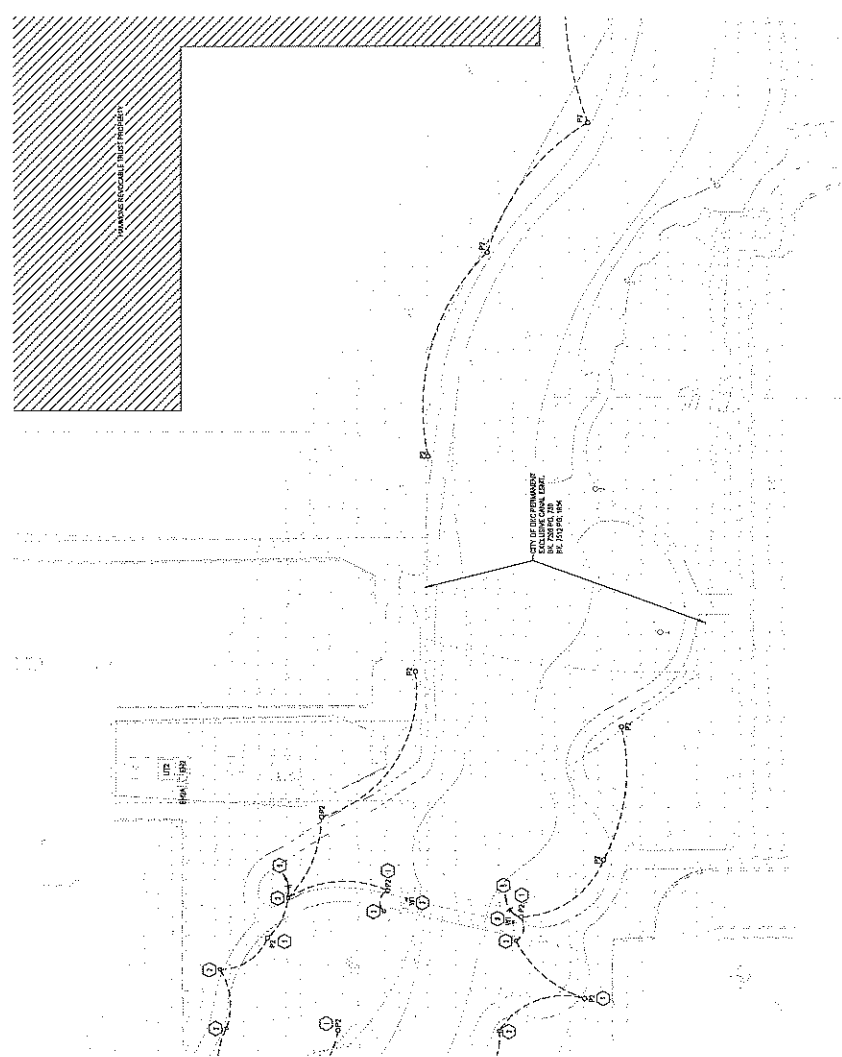

SITE GENERAL NOTES

- [illegible]

SITE KEYED NOTES

- [illegible]

NOTE: KEYED NOTES APPLY TO SHEETS E101 THROUGH E104.

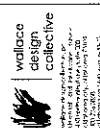

BRICKTOWN CANAL LIGHTING
IMPROVEMENTS, MP-0629
OKLAHOMA CITY, OKLAHOMA

DATE	DESCRIPTION	REV	DATE
			02/27/2024
			PROJECT NO. 2300068
			SHEET NAME
			BITE LIGHTING - AREA C
			SHEET NO.
			E103

DA Engineering, LLC
8701 Broadway Ext. Ste 200
Durham, NC 27603
TEL 470.257.8966
<https://daeng.com>

PRELIMINARY - NOT FOR CONSTRUCTION

LIGHT FIXTURE SCHEDULE

[illegible]

CONFIDENTIAL SYSTEMS

BRANCH PANEL - H1

ALC: RNTD8 C057910	VOLTS: 140/277
BOARD TYPE: MCB	PHASES: 3
BOARD RATING: 600 A	WAPES: 4
	LOCATION:
	APPLY FROM: U1
	Mounting: SURFACE

407E

[illegible]

BRANCH PANEL - H2

LOCATION:	VOLTE: 40V077	A.C. RATING: 600VAC
SUPPLY FROM: HI	PHASE: 3	WIND TYPE: 1A2
HOUSING: SURFACE	WIRES: 4	WIND RATING: 400 A

Note:

[illegible]

BRANCH PANEL - EHS

VOLTS: 200V~20
PHASES: 3
WATTS: 4
ALC RATING: DISTINO
NAME TYPE: MCB
RATING: 100 A

NOTES:-

[illegible]

BRANCH NAME - FY

LOCATION:	VOLTS: 200V/120	ALL RATING EXISTING
APPLY FROM: UG	PHASES: 3	WAVE TYPE: MCS
MOUNTING: SURFACE	WIRING: 4	WIRING RATING: 175 A

ਸਰੋਤ:

[illegible]

APPENDIX B
ENGINEER'S ESTIMATE OF PROBABLE COST

Bricktown Canal Improvements
Oklahoma City, Oklahoma
Wallace Design
William White and Associates, LLC
29-Mar-24
90 day project with 90 day lag for material delivery
DD Estimate

Base Bid

Totals

General Conditions									
Site supervision and general conditions	3.00	Mon	\$	16,345.00	\$	49,035.00			
Property owner coordination leader	3.00	Mon	\$	7,500.00	\$	22,500.00			
Submittals	1.00	LS	\$	1,200.00	\$	1,200.00			
Temporary Offices	3.00	Mon	\$	2,400.00	\$	7,200.00			
3rd Party Testing	1.00	LS	\$	1,000.00	\$	1,000.00			
Laydown and storage area	1.00	LS	\$	5,000.00	\$	5,000.00			
Wayfinding and signage	3.00	Mon	\$	6,500.00	\$	19,500.00			
Landscape and hard surface repair allowance	1.00	LS	\$	26,000.00	\$	26,000.00			
Site utility location confirmation	1.00	LS	\$	5,000.00	\$	5,000.00			
									\$ 136,435.00
Electrical lighting and replacement									
Demo note 1	120.00	Hrs	\$	85.00	\$	10,200.00			
Demo note 2	420.00	Hrs	\$	85.00	\$	35,700.00			
Demo note 3	80.00	Hrs	\$	85.00	\$	6,800.00			
Temporary lighting during renovation - 6 stands	3.00	Mon	\$	9,250.00	\$	27,750.00			
Panels checkout runs and rewire	460.00	Hrs	\$	85.00	\$	39,100.00			
Lighting package	1.00	LS	\$	463,352.00	\$	463,352.00			
Pole base and install	28.00	CY	\$	1,985.00	\$	55,580.00			
Conduit red concrete	46.00	CY	\$	925.00	\$	42,550.00			
Lighting install	660.00	Hrs	\$	85.00	\$	56,100.00			
Equipment - crane, pump truck, and operator	3.00	Mon	\$	19,440.00	\$	58,320.00			
Material allowance pending site investigation	1.00	Allow	\$	20,000.00	\$	20,000.00			
									\$ 815,452.00
Sub- Total					\$	951,887.00			
Insurances	1.00%				\$	9,518.87			
Builders Risk	0.65%				\$	6,187.27			
Bond	1.40%				\$	13,326.42			
Subtotal					\$	980,919.55			
Fee	10.00%				\$	98,091.96			
Sub-Total					\$	1,079,011.51			
Contingency	15.00%				\$	161,851.73			
Total					\$	1,240,863.24			
Alternate #1 - Bridge Alternate	Add				\$	61,240.00			
Bid Alternate Total					\$	1,302,103.24			

APPENDIX C
PROPOSED LIGHT FIXTURE INFORMATION

Project Name _____

Qty _____

Type _____

Catalog / Part Number _____

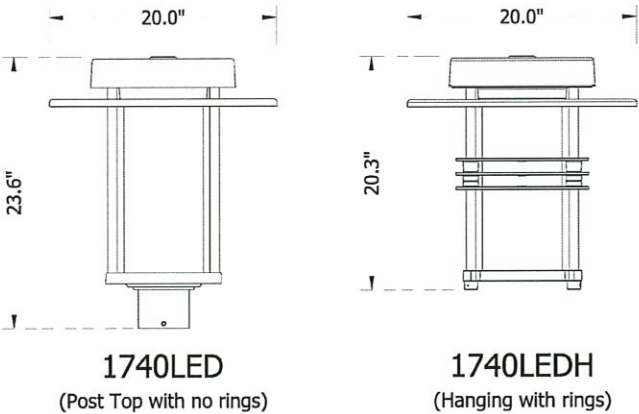

Distribution Type

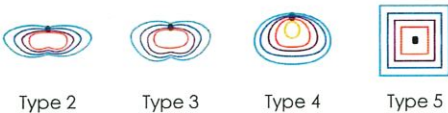

CCT - Color Temp (K)

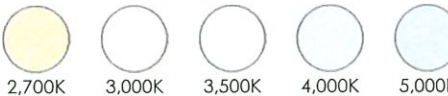

7 Year Warranty



IP Rating



Certifications



Description

The 1740LED Chateau™ series luminaire is a small scale, dramatic design fixture featuring a tall, cylindrical body made up of a cast aluminum top, round lens and flat, spun aluminum shade. Offered with optional external rings and internal diffusing lens.

EPA: .75 (ft²) | WEIGHT: 28 LBS

Features

Mounting Configuration	1W: Wall Mount	PT: Post Top
	1A: 1 Arm Mount	1APT: 1 Arm & Post Top
	2A: 2 Arm Mount @ 180°	2A90: 2 Arm Mount @ 90°
	2APT: 2 Arm @ 180° & Post Top	3A: 3 Arms @ 120°
	3APT: 3 Arm @ 120° & Post Top	3A90: 3 Arms @ 90°
		4A: 4 Arms @ 90°
	1AM: 1 Arm Mid-Mount	4APT: 4 Arm @ 90° & Post Top
		2AM: 2 Arm Mid-Mount @ 180°
	450PB: Pier Base	SH44: Stem Hung
	CAT: Catenary	
Optional Control Receptacle	R7: 7-Pin control receptacle only	
Optional Control	PE: Twist-Lock Photocontrol (120V-277V)	
	PE4: Twist-Lock Photocontrol (347V-480V)	
	SC: Shorting Cap	
	PEC: Electronic Button Photocontrol (120V-277V)	
Optional Fuse	FHD: Double Fuse and Holder	
Optional Hangstraight	HSHS: Standard Horizontal Hangstraight, Spike Finial	
	HSHN: Standard Horizontal Hangstraight, No Finial	
	HSHB: Standard Horizontal Hangstraight, Ball Finial	
	EZ: Vertical Hangstraight, Large, "EZ" Mount	
Optional House Side Shield	HSS: 120° House Side Shield	

Physical

Fixture	1740LED: Post Top 1740LEDH: Hanging	
Rings	DR: Decorative Rings RL: Ring-less	
Fitter	R3: To slip fit 3" OD x 3" tall tenon R4: To slip fit 4" OD x 3" tall tenon	
Lens	CA: Clear Acrylic WA: White Acrylic SV1D: Clear Acrylic exterior lens, Light diffused internal dome SV2D: Clear Acrylic exterior lens, Moderate diffused internal dome	
Finish	UGMT: Urban Gun Metal Textured UBT: Urban Bronze Textured USLT: Urban Silver Textured UWHT: Urban White Textured BKT: Black Textured	UGM: Urban Gun Metal Matte UB: Urban Bronze Matte USL: Urban Silver Matte UWH: Urban White Matte CM: Custom Match

Light Source

LED	1L: 1 LED	
CCT - Color Temp (K)	27: 2,700K 35: 3,500K 50: 5,000K	30: 3,000K 40: 4,000K
Distribution Type	T2: Type 2 T4: Type 4	T3: Type 3 T5: Type 5

Electrical and control

Driver	MDL04: 120V-277V, 400mA MDL06: 120V-277V, 600mA MDL08: 120V-277V, 800mA	MDH04: 347V-480V, 400mA MDH06: 347V-480V, 600mA MDH08: 347V-480V, 800mA
--------	---	---

Specifications

Fitter	The fitter shall be heavy wall die cast aluminum for high tensile strength. It includes 4 stainless steel Allen-head set screws for attachment to a pole/tenon. The fixture can slip-fit a 3"OD (R3) or 4"OD (R4) x 3" tall tenons/poles.
Hang-Straight	<p>A hang-straight transition is required for most hanging mounting configurations.</p> <p>The Standard (HSHx) is a cast aluminum ball and swivel horizontal hang-straight. Available with a spike (S), a ball (B), or no finial (N). The hang-straight slips a 4" long by 2-3/8" OD horizontal tenon.</p> <p>The (EZ) is a cast stainless steel ball and swivel vertical hang-straight. The special 2-part design allows for easy installation. It is factory installed under an arm and on the fixture.</p>
Catenary Mount	The Catenary mount option includes a cast aluminum span wire clamp, which accommodates cables 1/4"-5/8" in diameter. Below the clamp is a decorative cast aluminum wire box and cover which transitions to the EZ vertical Hangstraight for fixture attachment. Aircraft Cable by others.
Decorative Rings	Optional decorative cast aluminum 3 Ring set



Internal Lens	An optional internal diffusing dome lens can be added for visual comfort. Suggested for use with a clear lens, but can be used in addition to any other external lens. Optional (SV1D) light diffused acrylic dome lens. Optional (SV2D) moderate diffused acrylic dome lens.
Hardware	Includes Stainless steel hardware. Most finishes will include hardware with a Black Oxide conversion coating. Light finishes will get non-color coated hardware (Whites and Silvers)
UL Listing	UL listed per UL1598 and CSA 22.2 No. 250.0 for the United States and Canada. Suitable for Wet Locations.
Electronic Driver	The LED driver is UL recognized and will be securely mounted inside the fixture, for optimized performance and longevity. It will be supplied with a quick-disconnect electrical connector on the power supply, providing easy power connections for fixture installation and maintenance. It will have DC voltage output and be a constant current design. It runs at 50/60HZ and will have overload, overheat, and short circuit protection. It will be supplied with a supplemental line-ground, line-neutral and neutral-ground electrical surge protection in accordance with IEEE/ANSI C62.41.2 guidelines. It will be a high efficiency driver with a THD less than 20% and a high-power factor greater than .9. It will be dimming capable using a 0-10V signal, consult factory for more information.
IP Rating	IP66 rated
Finish	Our 6 Stage Polyester Powder coat paint system offers a beautiful high-end finish that holds up to even the most extreme environments. Each part is inspected for quality and consistency before being released for shipment. Our system exceeds AAMA 2604, AAMA 2605, ASTM D523 and ASTM D4214 requirements.
Urban Finish	The Urban finish palette was created to highlight a modern, elegant aesthetic. All finishes are a 1 part powder coat with metallic flakes for a superior appearance. Finishes are available in textured or matte. Available finishes include: Black Textured, Urban Gun Metal, Urban Bronze, Urban Silver and Urban White
Custom Finish	Custom finishes are offered to adapt to any application. Custom Match option is available to blend sternberg product with the site, consult factory for more information.
Warranty	7-year limited warranty. See Website for Terms and Conditions.
Lens	Optional SoftVue™ lens provides optimal visual comfort.
LEDs	The LED's in this system will be fully shielded in a direct downward position to maximize efficiency. The luminaire shall use high output, high brightness LED's, consisting of a two piece assembly complete with Chip on Board (COB) LED component and COB holder frame. The LEDs shall be 100% recyclable; not contain lead, mercury or any other hazardous substances and shall be RoHS compliant. Lumen maintenance shall be determined in accordance with IESNA TM-21, based on LED manufacturer LM-80 test data of no less than 6,000 hours and in-situ testing of the luminaire by an NVLAP accredited Energy Efficient Lighting Products lab. The high-performance white LEDs will have a predicted lumen depreciation of approximately 100,000 hours with greater than 70% of initial output at 25°C. The High Brightness, High Output LED's shall be 4000K (2700K, 3000K, 3500K or 5000K option) correlated color temperature (CCT) with a 70 (minimum) color rendering index (CRI). Consult factory for custom color CCT. The luminaire shall have a minimum _____ (see table) delivered initial lumen rating when operated at steady state with an average ambient temperature of 25°C (77°F). CCT Lumen Derate Values from 4,000K 2,700K (80+ CRI)=.89 3,000K (70+ CRI)=.97 3,500K (80+ CRI)=.93 5,000K (70+ CRI)=1.01
Optics	The luminaire shall be provided with individual, refractor type optics applied to each LED. The luminaire shall provide Type ____ (2, 3, 4 or 5) light distribution per the IESNA classifications. Testing shall be done in accordance with IESNA LM-79.
Backlight Optical Control	Internal House Side Shield (HSS): An optional INTERNAL 120° House Side Shield helps control backlight. Spun aluminum panel painted to match fixture.

Photocontrols

Button Photocell: The photocontrol shall be mounted on the "Catenary Box" and pre-wired to driver. The electronic button type photocontrol is instant on with a 5-10 second turn off, and shall turn on at 1.5 footcandles with a turn-off at 2-3 footcandles. See pole spec sheet for pole mounted version.

Twist-Lock Style (Roof Mount): The photocontrol shall be mounted on the roof and prewired to driver. The twist lock type photocontrol is instant on with a 3-6 second turn off, and shall turn on at 1.5 footcandles with a turnoff at 2-3 footcandles. Photocontrol is 120-277 volt.

Twist-Lock Style (Hangstraight Mount): The photocontrol shall be mounted externally on the hangstraight and pre-wired to driver. The twist lock type photocontrol is instant on with a 3-6 second turn off, and shall turn on at 1.5 footcandles with a turn-off at 2-3 footcandles.

If an **R7** is specified alongside a **BALL** or **SPIKE** style finial on hang-straight, a decorative cap (with window) is included to cover a **STANDARD** photocell. Use the **NO FINIAL** hangstraight option if the **R7** is for use with a **WIRELESS CONTROLLER**.

Lumen Chart(s)

Tested with CA lens

Model #	T2 DELIVERED LUMENS	BUG	EFFICACY (LPW)	T3 DELIVERED LUMENS	BUG	EFFICACY (LPW)	T4 DELIVERED LUMENS	BUG	EFFICACY (LPW)	T5 DELIVERED LUMENS	BUG	EFFICACY (LPW)	WATTAGE
1L40T_-MDL08	5395	B1U1G1	112.4	5395	B1U1G1	112.4	5410	B1U1G1	112.7	5980	B3U1G1	124.6	48
1L30T_-MDL08	5260	B1U1G1	109.6	5260	B1U1G1	109.6	5270	B1U1G1	109.8	5830	B3U1G1	121.5	48
1L27T_-MDL08	4775	B1U1G1	99.5	4775	B1U1G1	99.5	4790	B1U1G1	99.8	5295	B3U1G1	110.3	48
1L40T_-MDL06	4155	B1U1G1	112.3	4155	B1U1G1	112.3	4145	B1U1G1	112.0	4585	B2U1G1	123.9	37
1L30T_-MDL06	4050	B1U1G1	109.5	4050	B1U1G1	109.5	4040	B1U1G1	109.2	4470	B2U1G1	120.8	37
1L27T_-MDL06	3680	B1U1G1	99.5	3680	B1U1G1	99.5	3670	B1U1G1	99.2	4060	B2U1G1	109.7	37
1L40T_-MDL04	2850	B1U1G1	109.6	2850	B1U1G1	109.6	2850	B1U1G1	109.6	3125	B2U1G1	120.2	26
1L30T_-MDL04	2775	B1U1G1	106.7	2775	B1U1G1	106.7	2775	B1U1G1	106.7	3045	B2U1G1	117.1	26
1L27T_-MDL04	2525	B1U1G1	97.1	2525	B1U1G1	97.1	2525	B1U1G1	97.1	2765	B2U1G1	106.3	26

1740LED - Post Top

Model #	T2 DELIVERED LUMENS	BUG	EFFICACY (LPW)	T3 DELIVERED LUMENS	BUG	EFFICACY (LPW)	T4 DELIVERED LUMENS	BUG	EFFICACY (LPW)	T5 DELIVERED LUMENS	BUG	EFFICACY (LPW)	WATTAGE
1L40T_-MDL08	5920	B2U1G1	123.3	5920	B2U1G1	123.3	6010	B2U1G1	125.2	6300	B3U1G1	131.3	48
1L30T_-MDL08	5770	B2U1G1	120.2	5770	B2U1G1	120.2	5855	B2U1G1	122.0	6140	B3U1G1	127.9	48
1L27T_-MDL08	5240	B2U1G1	109.2	5240	B2U1G1	109.2	5320	B2U1G1	110.8	5580	B3U1G1	116.3	48
1L40T_-MDL06	4535	B1U1G1	122.6	4535	B1U1G1	122.6	4625	B1U1G1	125.0	4830	B2U1G1	130.5	37
1L30T_-MDL06	4420	B1U1G1	119.5	4420	B1U1G1	119.5	4505	B1U1G1	121.8	4705	B2U1G1	127.2	37
1L27T_-MDL06	4015	B1U1G1	108.5	4015	B1U1G1	108.5	4095	B1U1G1	110.7	4275	B2U1G1	115.5	37
1L40T_-MDL04	3100	B1U1G1	119.2	3100	B1U1G1	119.2	3170	B1U1G1	121.9	3305	B2U1G1	127.1	26
1L30T_-MDL04	3020	B1U1G1	116.2	3020	B1U1G1	116.2	3090	B1U1G1	118.8	3220	B2U1G1	123.8	26
1L27T_-MDL04	2745	B1U1G1	105.6	2745	B1U1G1	105.6	2805	B1U1G1	107.9	2925	B2U1G1	112.5	26

1740LEDH - Hanging

Dimensions

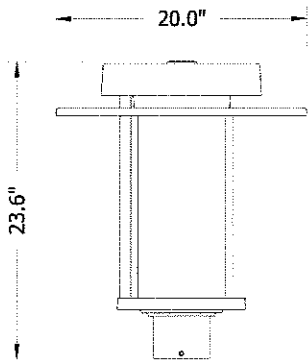

Post Top (1740LED)

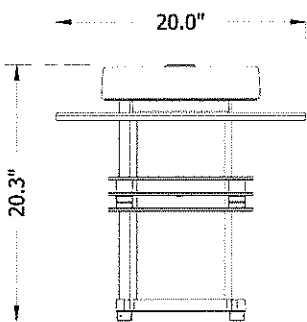

Hanging (1740LEDH)

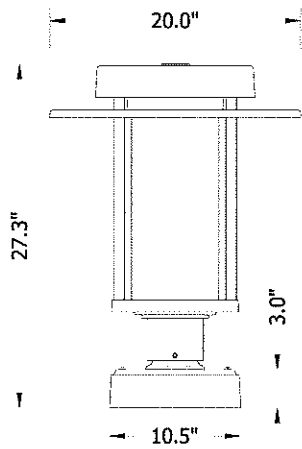

Pier Base (450PB)

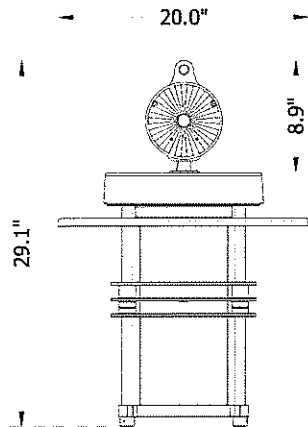

Catenary Mount (CAT)

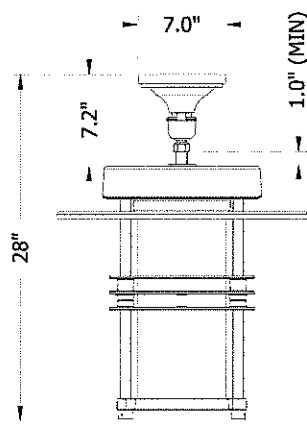

Stem Hung (SH44)

Hangstraight

Horizontal Hang-straight's slip fit 4" long by 2-3/8" OD on horizontal tenon



Standard Horizontal Hangstraight,
Spike Finial (HSHS)

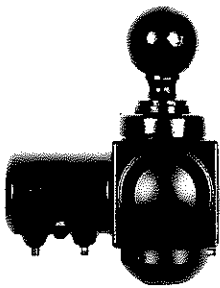

Standard Horizontal Hangstraight, Ball
Finial (HSHB)

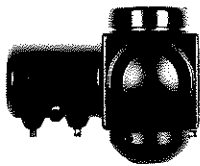

Standard Horizontal Hangstraight, No
Finial (HSHN)

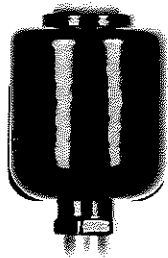

"EZ" Vertical hangstraight (EZ)

Options

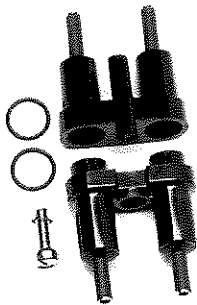

Double Fuse Holder & (2) 3A Fuses
(FHD)

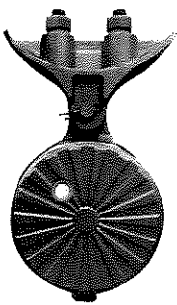

Catenary Mount with Button Photocell
(CAT/PEC)

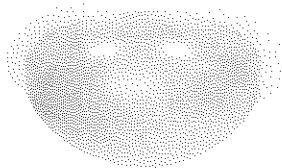

Internal Diffused Soft Vue Dome
(SV1D/SV2D)

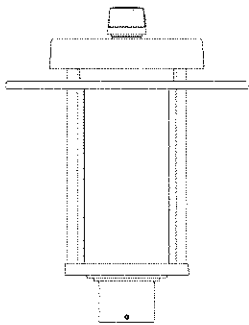

7-Pin Control Receptacle with
Photocell
(R7-PE/PE4)

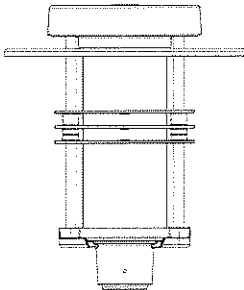

Decorative Rings (DR)

How to Order

Mounting Configuration	Overall Drop Length (in inches) (4) (5)	Fixture	Rings	Fitter (1)	LED	CCT - Color Temp (K)	Distribution Type	Driver	Lens
1W Wall Mount		1740LED Post Top	DR Decorative Rings	R3 To slip fit 3" OD x 3" tall tenon	1L 1 LED	27 2,700K	T2 Type 2	MDL04 120V-277V, 400mA	CA Clear Acrylic
PT Post Top (1)		1740LEDH Hanging	RL Ring-less	R4 To slip fit 4" OD x 3" tall tenon		30 3,000K	T3 Type 3	MDH04 347V-480V, 400mA	WA White Acrylic
1A 1 Arm Mount						35 3,500K	T4 Type 4	MDL06 120V-277V, 600mA	SV1D Clear Acrylic exterior lens, light diffused internal dome
1APT 1 Arm & Post Top (1)						40 4,000K	T5 Type 5	MDH06 347V-480V, 600mA	SV2D Clear Acrylic exterior lens, moderate diffused internal dome
2A 2 Arm Mount @ 180°						50 5,000K		MDL08 120V-277V, 800mA	
2A90 2 Arm Mount @ 90°								MDH08 347V-480V, 800mA	
2APT 2 Arm @ 180° & Post Top (1)									
3A 3 Arms @ 120°									
3A90 3 Arms @ 90°									
3APT 3 Arm @ 120° & Post Top (1)									
4A 4 Arms @ 90°									
4APT 4 Arm @ 90° & Post Top (1)									
1AM 1 Arm Mid-Mount									
2AM 2 Arm Mid-Mount @ 180°									
450PB Pier Base (1) (2)									
SH44 Stem Hung (3)									
CAT Catenary (3)									

Notes:

1. For use with Post Top fixture only.
2. For use with (R3) fitter only.
3. For use with hanging (H) fixture only.
4. Required field for Stem Mounting Configuration.
5. Minimum 28" Overall Drop Length.



How to Order

Optional Control Receptacle ⁽⁴⁾	Optional Control	Optional Fuse ⁽⁹⁾	Optional Hangstraight ⁽³⁾	Optional House Side Shield ⁽¹⁰⁾	Finish
R7 7-Pin control receptacle only	PE Twist-Lock Photocontrol (120V-277V) ⁽⁷⁾ PE4 Twist-Lock Photocontrol (347V-480V) ⁽⁷⁾ SC Shorting Cap ⁽⁷⁾ PEC Electronic Button Photocontrol (120V-277V) ⁽⁸⁾ PEC4 Electronic Button Photocontrol (480V) ⁽⁸⁾	FHD Double Fuse and Holder	HSHS Standard Horizontal Hangstraight, Spike Finial HSHN Standard Horizontal Hangstraight, No Finial HSHB Standard Horizontal Hangstraight, Ball Finial EZ Vertical Hangstraight, Large, "EZ" Mount	HSS 120° House Side Shield	UGMT Urban Gun Metal Textured UGM Urban Gun Metal Matte UBT Urban Bronze Textured UB Urban Bronze Matte USLT Urban Silver Textured USL Urban Silver Matte UWHT Urban White Textured UWH Urban White Matte BKT Black Textured CM Custom Match ⁽¹¹⁾

Notes:

3. For use with hanging (H) fixture only.
4. Not for use with STEM, CAT, or EZ mounting style.
7. Requires control receptacle.
8. Only for use with CAT mounting configuration.
9. Ships loose for installation in base.
10. Not for use with T5 optic.
11. Custom colors require upcharge.



FEATURES

- Sealed IP68 LED light engine
- Bluetooth connectivity for remote control aiming and dimming
- Free Mobile App for Android and iOS
- Easy to install and pair devices
- Advanced thermal management provides long life in excess of 100,000+ hours
- Runs cool to the touch - less than 40°C



CONTROL TECHNOLOGY



SPECIFICATIONS

HOUSING:

- Pour Box rough-in housing for installation below grade
- High temperature UV resistant thermal plastic, 3/16" minimum wall, black
- Includes a splice box with molded plastic splice cover and silicone gasket
- Three 1" NPT in bottom for through wiring on LTV81 and LTV82
- Two 1" NPT in bottom for through wiring on LTV83. 107 cu. in. splice area for LTV81
- 52 cu. in. splice area for LTV82. 24 cu. in. splice area for LTV83
- Rough-in housing supplied with a protective aluminum debris shield and includes an orientation label for proper installation alignment. This allows for clean and easy installation in concrete pad or soil. Pour Box can be shipped separately as a quick-ship if requested
- One-piece impregnated cast bronze component module is fully sealed and secured to the face trim from the underside
- A high temperature, anti-siphon, IP68 sealed cable extends from the component module to the splice box inside the housing
- The fully assembled component module is secured to the housing with (4) ¼-20 tamper-resistant and high grade stainless steel fasteners
- One-piece cast bronze lens ring fastens to the component module from the underside and provides a flat surface
- Slip Resistant Lens (SR) and Rebar Cage Anchor (RCA81)
- When installed in concrete, fixture will withstand drive-over by vehicles weighing up to 4,500 lb.

OPTICS

- Spot (SP), Narrow Flood (NF), and Wall Wash (WW) optical modules are adjustable up to 15° utilizing a Bluetooth enabled motor assembly
- Clear 5/16" thick tempered glass lens and silicone gasket is retained securely within the component module

ELECTRICAL

- All electronic components are UL and CSA recognized and are mounted directly to the component module for maximum heat dissipation and modularity. Driver is IP67 with -30°C minimum temperature rating
- Product comes standard with a UL Recognized 10kA surge protector

CONTROLS

- Standard fixtures dimming range is from 10% to 100% and be compatible with 0-10V, user-defined, control devices

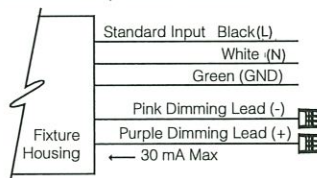

BLUETOOTH:

- Integral Bluetooth module used to adjust optics and dim fixture to desired setting when paired with KIM LTV8 Remote App via cellular/tablet device
- Fully qualified Bluetooth 1.1, 1.2, 2.0, 2.1, Bluetooth v2.0+EDR compatible with Android devices running Android Gingerbread API level 9 forward. Bluetooth 4.0 LE compatible with iOS devices - iPhone 4S and later, 5th generation iPod touch, the iPad Mini and the 3rd generation and later of the full size iPad with iOS 5 or later

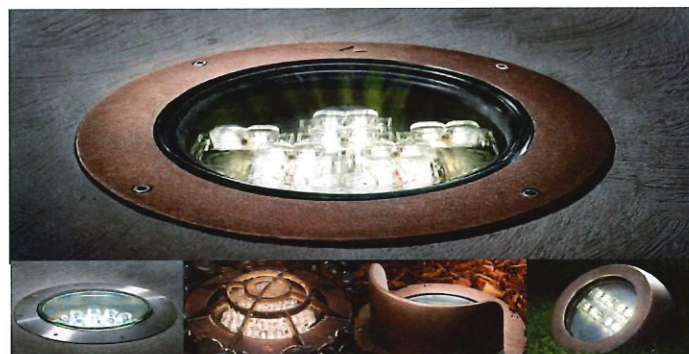

Lightvault8 Flat Frame, Stainless Steel, Rock Guard, Half Shield, Eyeball

RELATED PRODUCTS

LTV8FF RGBW

LTV8SS

LTV8SS RGBW

BLUETOOTH (CONTINUED)

- Bluetooth Apps are available for Apple iOS and Google Android mobile devices and are downloadable via the internet at Apple App Store or Google Play

CAUTION:

- Fixtures must be grounded in accordance with national, state and/or local electrical codes. Failure to do so may result in serious personal injury

CERTIFICATIONS AND LISTINGS

- Listed to UL1598 and UL8750 25°C ambient operation
- SASO Certified for LTV82/83
- IP68 rated
- IEC 66262 Mechanical Impact Code IK09
- CISPR 15 Compliant, per product standard EN 55015:2013
- RoHS compliant

WARRANTY

- 5 year warranty

KEY DATA

KEY DATA	
Lumen Range	988-3878
Wattage Range	14-44
Reported Life (Hours)	L70/60,000

LTV81

INGRADE

DELIVERED LUMENS

LTV81FF

Optical Module	Source	Color Temp.	Absolute Lumens	Center Beam Candle Power*	Voltage	Total System Watts	Max. Amps	Beam Angle (50%) H x V	Field Angle (10%) H x V	NEMA Type
SP	36L	3K	3529	42861	UV	42W	.350 for 120V .202 for 208V .175 for 240V .152 for 277V	12.9 x 12.9	26.4 x 26.4	2H x 2V
		4K	3617	45492						
		5K	3658	46015						
NF		3K	2911	3248				46 x 54.6	79.9 x 83.8	5H x 5V
		4K	2985	3310						
		5K	3020	3379						
WW		3K	3739	6083		44W	.367 for 120V .212 for 208V .183 for 240V .159 for 277V	53.1 x 28.2	102.5 x 61.1	6H x 4V
		4K	3835	6239						
		5K	3878	6309						

LTV81SS

Optical Module	Source	Color Temp.	Absolute Lumens	Center Beam Candle Power*	Voltage	Total System Watts	Max. Amps	Beam Angle (50%) H x V
SP	36L	3K	3529	42861	UV	42W	.350 for 120V .202 for 208V .175 for 240V .152 for 277V	12.9°
		4K	3617	45492				
		5K	3658	46015				
NF		3K	2911	3248				46°
		4K	2985	3310				
		5K	3020	3379				
WW		3K	3739	6083		44W	.367 for 120V .212 for 208V .183 for 240V .159 for 277V	53.1°
		4K	3835	6239				
		5K	3878	6309				

LTV81RG

Optical Module	Source	Color Temp.	Absolute Lumens	Center Beam Candle Power*	Voltage	Total System Watts	Max. Amps	Beam Angle (50%) H x V
SP	36L	3K	2399	26821	UV	42W	.350 for 120V .202 for 208V .175 for 240V .152 for 277V	13.3°
		4K	2462	27423				
		5K	2488	28026				
NF		3K	2036	2368				44.3°
		4K	2088	2436				
		5K	2111	2453				
WW		3K	2522	4097		44W	.367 for 120V .212 for 208V .183 for 240V .159 for 277V	49.3°
		4K	2585	4201				
		5K	2616	4250				

LTV81HS

Optical Module	Source	Color Temp.	Absolute Lumens	Center Beam Candle Power*	Voltage	Total System Watts	Max. Amps	Beam Angle (50%) H x V
SP	36L	3K	3418	42371	UV	42W	.350 for 120V .202 for 208V .175 for 240V .152 for 277V	12.9°
		4K	3507	43660				
		5K	3543	45983				
NF		3K	2627	3228				49.3°
		4K	2695	3317				
		5K	2724	3412				
WW		3K	3489	6032		44W	.367 for 120V .212 for 208V .183 for 240V .159 for 277V	52.3°
		4K	3578	6187				
		5K	3619	6257				

KEY: FF = Flat Frame, SS = Flat Frame, RG = Rock Guard, HS = Half Shield, EB = Eyeball, SP = Spot, NF = Narrow Flood, WW = Wall Wash (PicoPrism™), 36L = 36 LEDs, 18L = 18 LEDs, 16L = 16 LEDs, 12L = 12 LEDs, 3K = 2800K to 3175K, 4K = 3800K to 4600K, 5K = 4600K to 5600K, UV = Universal Voltage shall range from 120V-277V with a ±10% tolerance.
* The SP and NF are based on Candela exiting unit straight up. The WW is for highest candela angle.

DELIVERED LUMENS

LTV81EB

Optical Module	Source	Color Temp.	Absolute Lumens	Center Beam Candle Power*	Voltage	Total System Watts	Max. Amps	Beam Angle (50%) H x V		
SP	18L	3K	1956	42861	UV	42W	.350 for 120V .202 for 208V .175 for 240V .152 for 277V	12.9 x 12.9		
		4K	2007	45492						
		5K	2030	46015						
NF		3K	1612	3248				44W	.367 for 120V .212 for 208V .183 for 240V .159 for 277V	46 x 54.6
		4K	1653	3310						
		5K	1672	3379						
WW		3K	1826	6083		53.1 x 28.2				
		4K	1872	6239						
		5K	1895	6309						

KEY: FF = Flat Frame, SS = Flat Frame, RG = Rock Guard, HS = Half Shield, EB = Eyeball, SP = Spot, NF = Narrow Flood, WW = Wall Wash (PicoPrism™), 36L = 36 LEDs, 18L = 18 LEDs, 16L = 16 LEDs, 12L = 12 LEDs, 3K = 2800K to 3175K, 4K = 3800K to 4600K, 5K = 4600K to 5600K, UV = Universal Voltage shall range from 120V-277V with a ±10% tolerance.
* The SP and NF are based on Candela exiting unit straight up. The WW is for highest candela angle.

DIMENSIONS

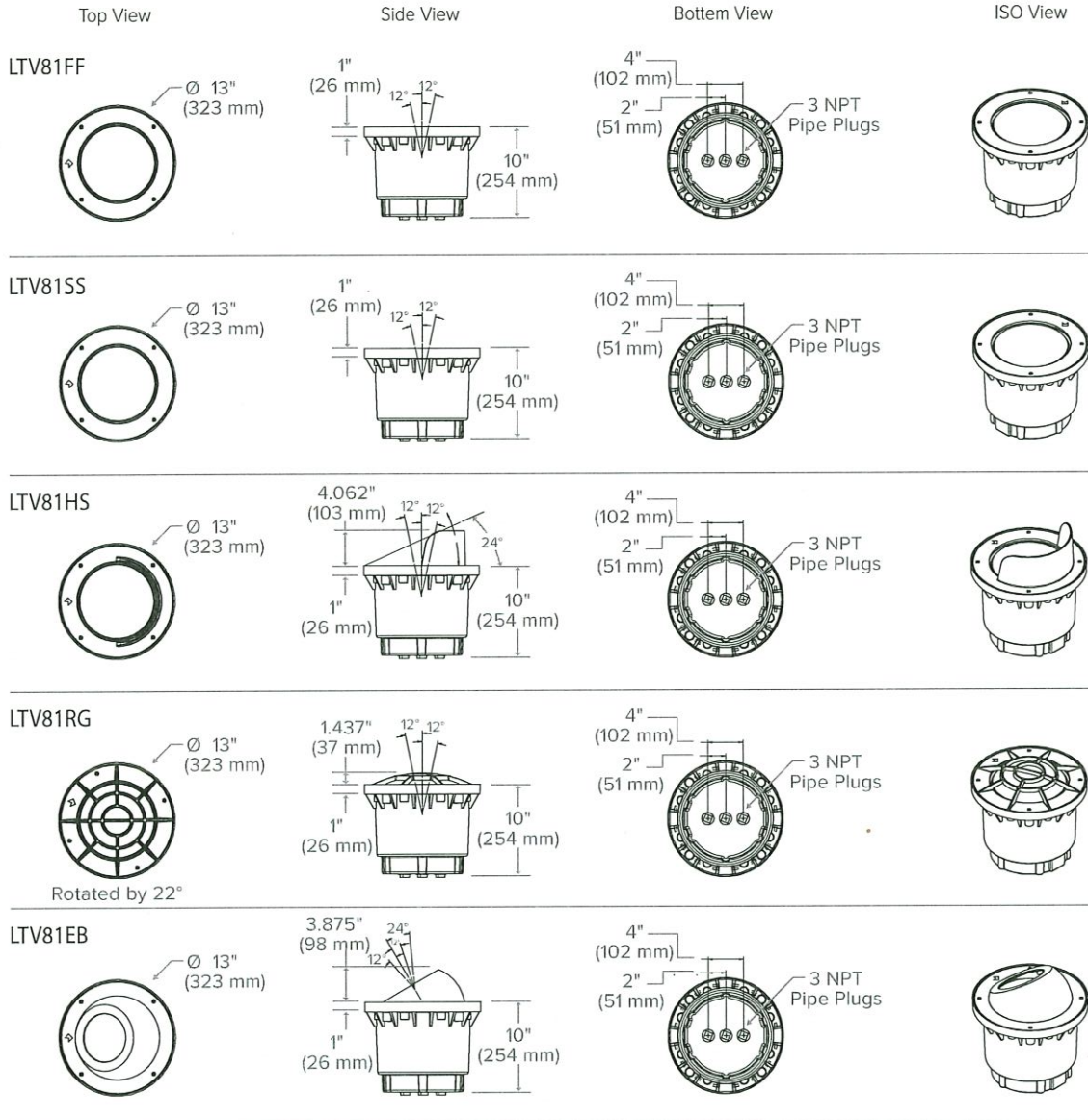

LIGHT DISTRIBUTIONS:



ELECTRICAL DATA

Spectroradiometric

	3K	4K	5K
Correlated Color Temp. CCT (K)	2800K to 3175K	3800K to 4600K	4600K to 5600K
Color Rendering Index (CRI)	≥72	≥72	≥72
Power Factor	>.90	>.90	>.90

L70 Data

	Calculated	Reported*
350 mA	100,000	60,000



Catalog #: _____ Project: _____ Type: _____

Prepared By: _____ Date: _____

BASE BID

Mirada Small Wall Sconce Silicone (XWS SIL)

Outdoor LED Wall Light



OVERVIEW

Lumen Package (lm)	2,000 - 8,000
Wattage Range (W)	13 - 61
Efficacy Range (LPW)	126 - 162
Weight lbs (kg)	10 (4.5)

QUICK LINKS

FEATURES & SPECIFICATIONS

Construction

- Rugged die-cast aluminum housing.
- Fixtures are finished with LSI's DuraGrip® polyester powder coat finishing process. The DuraGrip finish withstands extreme weather changes without cracking or peeling. Other standard LSI finishes available. Consult factory.
- Extended housing available with 1/2" threaded hubs for surface conduit and rated wire.
- Standard luminaire shipping weight: TBD lbs in carton.
- Max luminaire shipping weight: 12 lbs in carton (20 lbs w/EH option)

Optical System

- State-of-the-Art one piece silicone optic provides industry leading optical control while also acting as an integrated gasket reducing system complexity and improving fixture reliability.
- Proprietary silicone refractor optics provide exceptional coverage and uniformity in distribution types 2, 3, and FT.
- Silicone optical material does not yellow or crack with age and provides a typical light transmittance of 93%.
- Zero uplight.
- Available in 5000K, 4000K, and 3000K color temperatures per ANSI C78.377.
- Minimum CRI of 70

Electrical

- High-performance driver features over-voltage under-voltage, short-circuit, and over temperature protection.

- 0-10V dimming (10% - 100%) standard.
- Standard Universal Voltage (120-277 VAC) Input 50/60 Hz or optional High Voltage (347-480 VAC).
- L70 Calculated Life: >60k Hours
- Total harmonic distortion (THD): <20%
- Operating temperature: -40°C to +50°C (-40°F to +122°F).
- Power factor (PF): >.90
- Input power stays constant over life.
- Optional 10kV surge protection device meets a minimum Category C Low operation (per ANSI/IEEE C62.41.2).
- High-efficacy LEDs mounted to metal-core circuit board to maximize heat dissipation
- Driver is fully encased in potting material for moisture resistance. Driver complies with FCC standards. Accessible driver and electrical components.
- Optional battery backup provides 90-minutes of constant power to the LED system, ensuring code compliance. A test switch/indicator button is installed on the housing for ease of maintenance. Standard battery rated for 0°C to 50°C with cold weather battery rated for -20°C to 50°C (40°C max for 8L). 120-277V Only.

Controls

- Optional integral passive infrared Bluetooth™ motion. Fixtures operate independently and can be commissioned via iOS or Android configuration app.
- Optional button photocell turns fixtures on and off based on ambient light levels for dusk to dawn lighting.

- LSI's AirLink Blue wireless control system options allow for fixture and motion sensor grouping while reducing energy and maintenance costs.

Installation

- Universal wall mounting plate mounts directly to vertical surface or 4" junction box (octagonal or square).
- Luminaire hinges to the top of the mounting plate and is secured via two flush mount screws that help to conceal the hardware and prevent over tightening during installation.

Warranty

- LSI luminaires carry a 5-year limited warranty. Refer to <https://www.lsicorp.com/resources/terms-conditions-warranty/> for more information.

Listings

- Listed to UL 1598 and UL 8750.
- Meets Buy American Act requirements.
- IDA compliant; with 3000K color temperature selection.
- Title 24 Compliant; see local ordinance for qualification information.
- Suitable for wet locations.
- IP65 rated luminaire per IEC 60598-1.
- IK08 rated luminaire per IEC 60626 mechanical impact code.
- DesignLights Consortium® (DLC) Premium qualified product. Not all versions of this product may be DLC Premium qualified. Please check the DLC Qualified Products List at www.designlights.org/QPL to confirm which versions are qualified.



Mirada Small Wall Sconce Silicone (XWS SIL)

Type: _____

 **Have questions?** Call us at (800) 436-7800

ORDERING GUIDE

[Back to Quick Links](#)

TYPICAL ORDER EXAMPLE: XWS LED 6L SIL FT UNV DIM 40 70CRI ALBCS1 BLK CWBB						
Prefix	Light Source	Lumen Package	Lens	Distribution	Voltage	Driver
XWS - Mirada Small Wall Sconce	LED	2L - 2,000 3L - 3,000 5L - 5,000 6L - 6,000 8L - 8,000 Custom Lumen Packages ¹	SIL - Silicone	2 - Type 2 3 - Type 3 FT - Forward Throw	UNV - Universal Voltage (120-277V) HV - High Voltage (347-480V)	DIM - 0-10v Dimming (0-10%)
Color Temperature	Color Rendering	Controls			Finish	Options
50 - 5000K 40 - 4000K 30 - 3000K	70CRI - 70 CRI	Blank - None Wireless Controls ALBCS1 - AirLink Blue Wireless Motion & Photo Sensor Controller (8-24' mounting height) ² Standalone Controls EXT - 0-10v Dimming leads extended to housing exterior IMSBT1L - Integral Bluetooth™ Motion Sensor 8-24' MH ^{2,3} Button Type Photocells PCI120 - 120V PCI208-277 - 208-277V PCI347 - 347V			BLK - Black BRZ - Dark Bronze GMG - Gun Metal Gray GPT - Graphite MSV - Metallic Silver PLP - Platinum Plus SVG - Satin Verde Green WHT - White	Blank - None BB - 10w Battery Back-up (0°C) ⁴ CWBB - 10w Cold Weather Battery Backup (-20°C) ⁴ BB20 - 20W Battery Back-up (0°C) ⁴ EH - Extended Housing ⁵ SP1 - 10kV Surge Protection Device



Need more information?
[Click here for our glossary](#)

Have additional questions?
 Call us at (800) 436-7800



ACCESSORY ORDERING INFORMATION*

Part Number	Description
758274CLR	XWS Extended Housing/Surface Conduit Wiring Box
760159CLR	XWS Spacer Plate/Wiring Box

*Accessories are shipped separately and field installed.

Battery Backup

- Emergency battery system provides 90-minutes of constant power to the LED system, ensuring code compliance.
- A test switch/indicator button is installed on the housing for ease of maintenance.
- 10w battery delivers ~1,500 lumens during emergency mode.
- 20w battery delivers ~3,000 lumens during emergency mode.

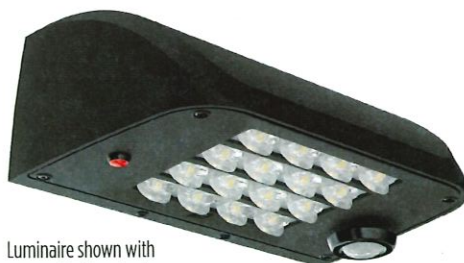

Luminaire shown with sensor & battery backup

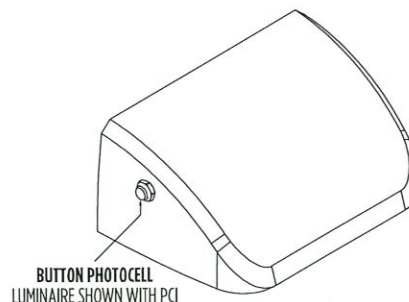

BUTTON PHOTOCCELL
LUMINAIRE SHOWN WITH PCI

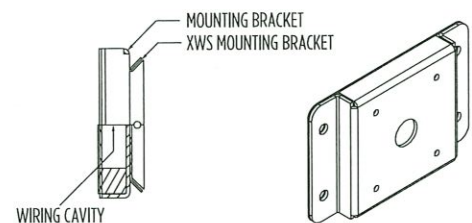

WIRING CAVITY

MOUNTING BRACKET
XWS MOUNTING BRACKET

¹ Custom lumen and wattage packages available, consult factory. Values are within industry standard tolerances but not DLC listed.
² When high voltage (HV) is specified, IMSBT and ALBCS control options are limited to 6L and 8L lumen packages.
³ IMSBTxL is field configurable via the LSI app that can be downloaded from your smartphone's native app store.
⁴ Universal Voltage Only (120-277V). 20W Battery Backup only available 2L - 6L.
⁵ For applications with surface conduit.



Mirada Small Wall Sconce Silicone (XWS SIL)

Type: _____

 **Have questions?** Call us at (800) 436-7800

PERFORMANCE

[Back to Quick Links](#)

Delivered Lumens¹												
Lumen Package	Distribution	CRI	3000K CCT			4000K CCT			5000K CCT			Wattage
			Delivered Lumens	Efficacy	Bug Rating	Delivered Lumens	Efficacy	Bug Rating	Delivered Lumens	Efficacy	Bug Rating	
2L	2	70	1,851	142	B1-U0-G1	1,974	152	B1-U0-G1	1,976	152	B1-U0-G1	13
	3		1,930	148	B1-U0-G1	2,058	158	B1-U0-G1	2,060	158	B1-U0-G1	
	FT		1,889	145	B1-U0-G1	2,015	155	B1-U0-G1	2,017	155	B1-U0-G1	
3L	2	70	2,765	146	B1-U0-G1	2,950	155	B1-U0-G1	2,953	155	B1-U0-G1	19
	3		2,884	152	B1-U0-G1	3,077	162	B1-U0-G1	3,079	162	B1-U0-G1	
	FT		2,822	149	B1-U0-G1	3,010	158	B1-U0-G1	3,012	159	B1-U0-G1	
5L	2	70	4,655	133	B2-U0-G1	4,965	142	B2-U0-G1	4,970	142	B2-U0-G1	35
	3		4,855	139	B1-U0-G1	5,179	148	B1-U0-G1	5,184	148	B1-U0-G1	
	FT		4,750	136	B1-U0-G2	5,067	145	B1-U0-G2	5,072	145	B1-U0-G2	
6L	2	70	5,578	130	B2-U0-G1	5,950	138	B2-U0-G2	5,956	139	B2-U0-G2	43
	3		5,819	135	B1-U0-G2	6,207	144	B1-U0-G2	6,214	145	B1-U0-G2	
	FT		5,693	132	B1-U0-G2	6,073	141	B1-U0-G2	6,079	141	B1-U0-G2	
8L	2	70	7,531	123	B2-U0-G2	8,034	132	B2-U0-G2	8,041	132	B2-U0-G2	61
	3		7,856	129	B2-U0-G2	8,380	137	B2-U0-G2	8,388	138	B2-U0-G2	
	FT		7,687	126	B2-U0-G2	8,199	134	B2-U0-G2	8,207	135	B2-U0-G2	

Electrical Data - Current Draw AMPS ²						
Lumen Package	120V	208V	240V	277V	347V	480V
2L	0.11	0.06	0.05	0.05	0.04	0.03
3L	0.16	0.09	0.08	0.07	0.05	0.04
5L	0.29	0.17	0.15	0.13	0.10	0.07
6L	0.36	0.21	0.18	0.16	0.12	0.09
8L	0.51	0.29	0.25	0.22	0.18	0.13

Recommended Lumen Maintenance - XWS ³					
Ambient Temperature C°	Initial ⁴	25K hrs. ⁴	50K hrs. ⁴	75K hrs. ⁵	100K hrs. ⁵
25	100%	95%	90%	85%	80%
40	100%	91%	82%	73%	65%

¹ LEDs are frequently updated therefore values are nominal

² Electrical data at 25°C (77°F). Actual wattage may differ by +/-10%.

³ Lumen maintenance values at 25°C are calculated per TM-21 based on LM-80 data and in-situ luminaire testing.

⁴ In accordance with IESNA TM-21-11, Projected Values represent interpolated value based on time durations that are within six times (6X) the IESNA LM-80-08 total test duration (in hours) for the device under testing ((DUT) i.e. the packaged LED chip).

⁵ In accordance with IESNA TM-21-11, Calculated Values represent time durations that exceed six times NA LM-80-08 total test duration (in hours) for the device under testing ((DUT) i.e. the packaged LED chip).



Mirada Small Wall Sconce Silicone (XWS SIL)

Type : _____

 Have questions? Call us at (800) 436-7800

PHOTOMETRICS

[Back to Quick Links](#)

Luminaire photometry has been conducted by a NVLAP accredited testing laboratory in accordance with IESNA LM-79-08. As specified by IESNA LM-79-08 the entire luminaire is tested as the source resulting in a luminaire efficiency of 100%.

See the individual product page on <https://www.lsicorp.com/> for detailed photometric data.

XWS-LED-6L-SIL-2-40-70CRI

Luminaire Data	
Type 2 Distribution	
Description	4000 Kelvin, 70 CRI
Delivered Lumens	5,951
Watts	42.5
Efficacy	138
IES Type	Type II - Short
BUG Rating	B1-U0-G1

Zonal Lumen Summary		
Zone	Lumens	% Luminaire
Low (0-30°)	834	20%
Medium (30-60°)	3,379	50%
High (60-80°)	1,647	28%
Very High (80-90°)	91	1%
Uplight (90-180°)	0	0%
Total Flux	5,951	100%

ISO Footcandle

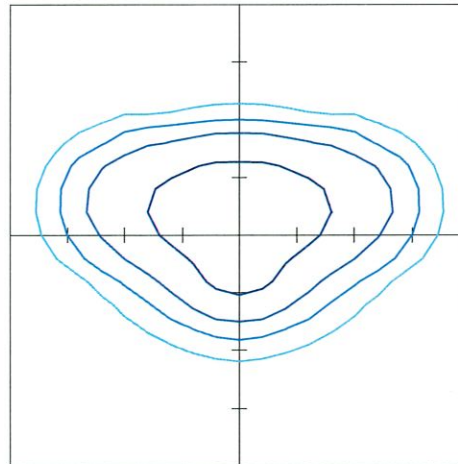

10' Mounting Height / 10' Grid Spacing
 5 FC 2 FC 1 FC 0.5 FC

Polar Curve

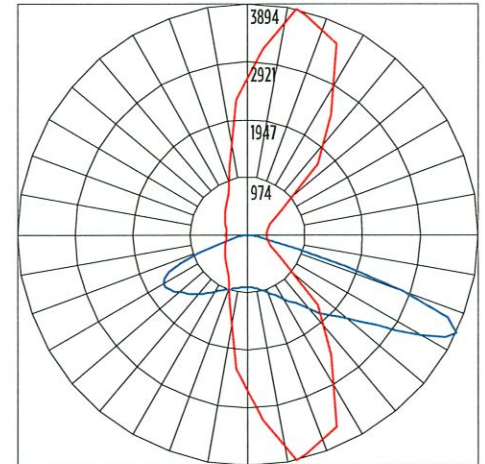

Vertical Plane Horizontal Cone

XWS-LED-6L-SIL-3-40-70CRI

Luminaire Data	
Type 3 Distribution	
Description	4000 Kelvin, 70 CRI
Delivered Lumens	6,208
Watts	42.5
Efficacy	146
IES Type	Type III - Medium
BUG Rating	B1-U0-G2

Zonal Lumen Summary		
Zone	Lumens	% Luminaire
Low (0-30°)	582	9%
Medium (30-60°)	2,997	48%
High (60-80°)	2,506	40%
Very High (80-90°)	124	2%
Uplight (90-180°)	0	0%
Total Flux	6,208	100%

ISO Footcandle

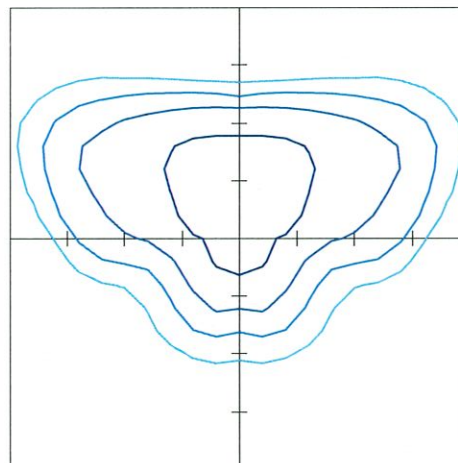

10' Mounting Height / 10' Grid Spacing
 5 FC 2 FC 1 FC 0.5 FC

Polar Curve

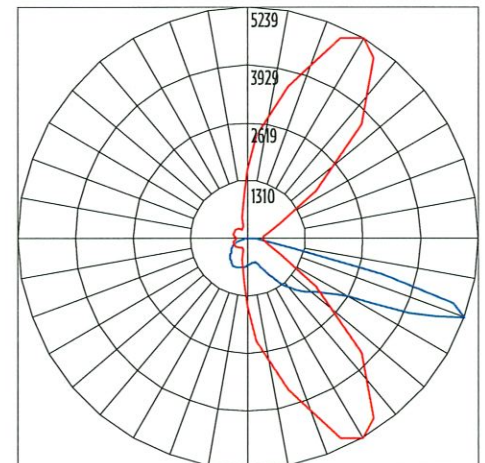

Vertical Plane Horizontal Cone

Mirada Small Wall Sconce Silicone (XWS SIL)

Type : _____

 Have questions? Call us at (800) 436-7800

PHOTOMETRICS

[Back to Quick Links](#)

XWS-LED-6L-SIL-FT-40-70CRI

Luminaire Data	
Type FT Distribution	
Description	4000 Kelvin, 70 CRI
Delivered Lumens	6,073
Watts	42.5
Efficacy	143
IES Type	Type IV - Short
BUG Rating	B1-U0-G2

Zonal Lumen Summary		
Zone	Lumens	% Luminaire
Low (0-30°)	708.3	12%
Medium (30-60°)	2,715.5	45%
High (60-80°)	2,475.4	41%
Very High (80-90°)	173.6	3%
Uplight (90-180°)	0	0%
Total Flux	6,073	100%

ISO Footcandle

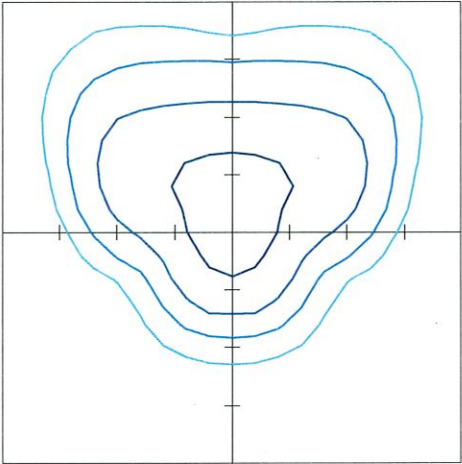

10' Mounting Height / 10' Grid Spacing
5 FC 2 FC 1 FC 0.5 FC

Polar Curve

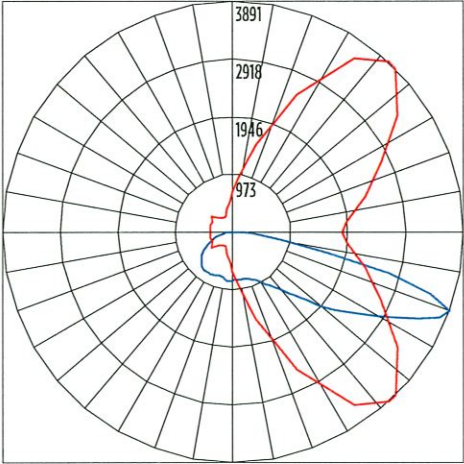

Vertical Plane Horizontal Cone

Mirada Small Wall Sconce Silicone (XWS SIL)

Type : _____

 Have questions? Call us at (800) 436-7800

PRODUCT DIMENSIONS

[Back to Quick Links](#)

STANDARD HOUSING (XWS)

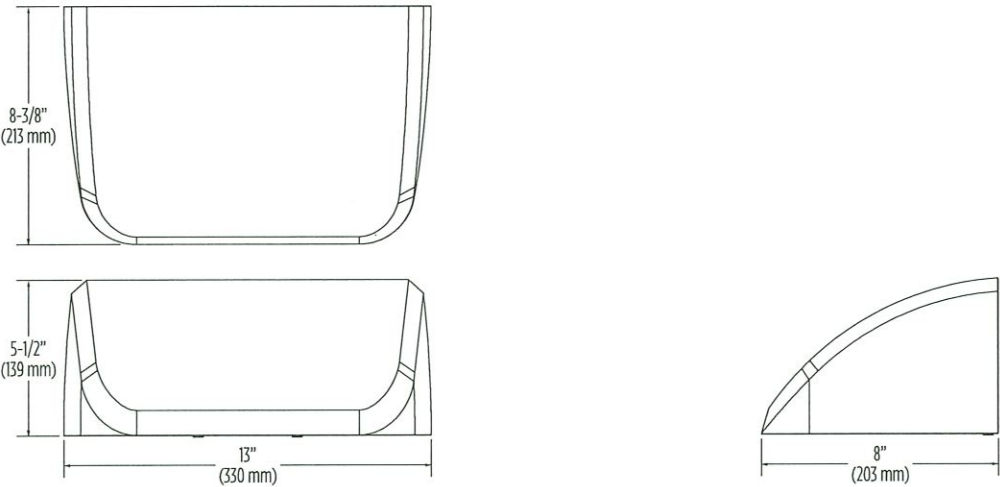

SCWB EXTENDED HOUSING (XWS 758274CLR)

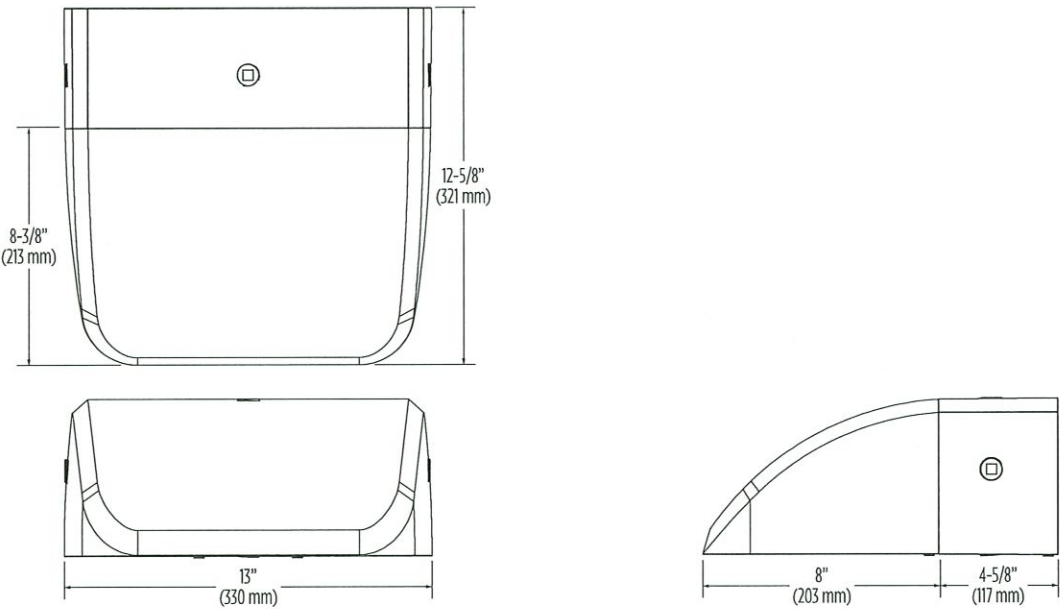

XWS SPACER PLATE/WIRING BOX (XWS 760159CLR)

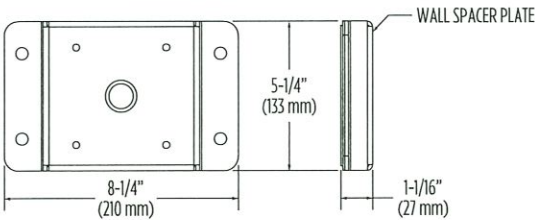

NOTE: Wall spacer plate allows the luminaire to float off the wall and provides space for securing wires (8.25" X 5.25" X 1.07").



Mirada Small Wall Sconce Silicone (XWS SIL)

Type : _____

 **Have questions?** Call us at (800) 436-7800

CONTROLS

[Back to Quick Links](#)

Integral Bluetooth™ Motion and Photocell Sensor (IMSBTxL)

Slim low profile sensor provides multi-level control based on motion and/or daylight. Sensor controls 0-10 VDC LED drivers and is IP66 rated for cold and wet locations (-40°F to 167°F). Two unique PIR lenses are available and used based on fixture mounting height. All control parameters are adjustable via an iOS or Android App capable of storing and transmitting sensor profiles.

[Click here to learn more details about IMSBT](#)



LEVITON App



Apple



Android

AirLink Blue (ALBCSx)

Wireless Bluetooth Mesh Outdoor Lighting Control System that provides energy savings, code compliance and enhanced safety/security for parking lots and parking garages. Three key components; Bluetooth wireless radio/sensor controller, Time Keeper and an iOS App. Capable of grouping multiple fixtures and sensors as well as scheduling time-based events by zone. Radio/Sensor Controller is factory integrated into Area/ Site, Wall Mounted, Parking Garage and Canopy luminaires.

[Click here to learn more details about AirLink Blue](#)



AirLink Blue App



Apple

Sensor Sequence of Operations

Standard Programming	On Event	Off Event	On Light Level	Dim Light Level	Daylight Harvesting	Delay To Off	Sensitivity
IMSBTxL	Motion	No Motion	100%	N/A	On; Auto Calibration	20 minutes	High

Operation	Description
On Event	Trigger that activates lights to turn on; either automatic via motion detected or manually activated via push of button.
Off Event	Trigger that activates lights to turn off; either automatic via no motion detected or manually activated via push of button.
On Light Level	The light level that the fixtures will turn on to when ON EVENT occurs.
Dim Light Level	The light level that the fixtures will dim down to when no motion is detected.
Delay to Dim	The amount of time after which no motion is detected that the fixtures will be triggered to dim down. This sequence is optional, and sensor can be programmed to only trigger the fixture to turn off by entering 100% in this field.
Delay to Off	The amount of time after which no motion is detected that the fixtures will be triggered to turn off. If delay to dim is part of the programmed functionality, this is the amount of time after which no motion is detected after the fixture have already dimmed down.
Sensitivity	The sensitivity can be set to high, medium, low, or auto where applicable. High will detect smaller, simple motions. Low will only detect larger more complex motions. Auto temperature calibration adjusts the PIR sensitivity as ambient temperature rises to increase detection of heat movement through the field of view.





Project Name

Type

Part Number

Quantity

Notes

Product Overview

The dBeam-8 is a practical directional luminaire in 3, 6 or 9LED. Also available in an RGBW version for use with ZDCLink® Controllers.

Features

Total Lumens	665 lm
Power Consumption	4.4 W 9.3 W 12.2 W 11.0 W
Input Voltage	White: 10-15 Vac/dc, 50/60 Hz ZDC: 11-15 Vac, 50/60 Hz
Installation Requirements	Downward Direction Only
Typical Lifetime	White: 72,000 hrs RGBW: 55,000 hrs
Weight	2.0 lb (0.9 kg)
Compliance	
Color Options	

Technology



Written Specifications

Electrical

Power Consumption	Specified power consumption indicates the full apparent power.
Input Voltage	White: 10–15 Vac/dc, 50/60 Hz. RGBW: 11–15 Vac/dc, 50/60 Hz. Remote transformer required (specify separately).
Configuration	Integral driver.
LED	White: Lumileds® RGBW: Cree®
Thermal Management	CoolDrive™ onboard thermal monitoring and control.
Lifetime	White: >72,000 hours (L70, B10, TM21 Reported) RGBW: >55,000 hours (L70, B10, TM21 Reported)
Dimming	Luxor® control or a trailing-edge (reverse phase-cut) dimmer.

Control

Luxor® Control	The ZDClick Controller utilizes Luxor Technology™ to zone luminaires in up to 250 groups, dim each group in 1% increments between 0% and 100%, or change to one of 30,000+ colors with RGBW LEDs. Select the ZD option for zoning/dimming or ZDC for zoning/dimming/color. Standard luminaire is zoneable with ZDClick.
----------------	---

Physical

Construction	Die-cast A380 aluminum housing and shield with stainless steel hardware. Die-cast zinc/aluminum alloy knuckle.
Finish	Two-layer protection of marine-grade anodization and polyester TGIC powder-coat finish, providing superior outdoor weathering in all conditions. Tested to ASTM standards.
Beam Angles	"Specify Spot (20°), Flood (35°), or Wide Flood (60°). For Narrow Spot (10°), specify any beam angle and remove beam angle lens on site. Beam angle is field serviceable."
Installation	Designed for installation in the downward lighting direction only.
Adjustability	Compress-and-lock features prevent slip after installation. Offers 9° increments of adjustability over 220° of vertical alignment.
Wiring	18 AWG (1 mm); SPT-1W; 220°F (105°C); 300 V; 26' (8 m) length, measured from the light aperture. International ("e") length is shorter.
Socket	MicroAntileach™ Technology to prevent moisture from wicking up into sealed areas of the luminaire.
Ambient Operating Temperature	0°F to 140°F (-18°C to 60°C).
Lens	OptiClear™ tempered glass for exceptional optical purity and load strength.
Lens Transparency	White: Clear RGBW: Frosted
Glare Control	60° angled shield or 2" deep 90° straight option.
Hardware	Tamper-resistant stainless steel hardware.

Threads	½"-14 NPSM
Housing Capacity	Round 1LED, 3LED, 6LED, 9LED, or ZDC-L
Weight	2.0 lb (0.9 kg)
Compliance	
IP Rating	IP65
Environment	Dry, Damp, Wet locations
Certifications	UL 1838, CSA C22.2 No. 250.7, IEC 60598-1, IEC 605598-2-4, FCC Part 15, Subpart B, ISED Canada ICES-005, EN 55015, EN 61547, EN 61000-3-2, EN 61000-3-3. Default configuration UL Listed. CE certification is met when the "e" option is selected.
Overview	
About Us	Lumascap transforms spaces with precision-engineered lighting solutions, proven to perform. Since 1991, customers have relied on us as a leading manufacturer of high-quality, innovative luminaires that solve their toughest lighting challenges. Our global experts combine sophisticated design, advanced technologies, quality materials, and rigorous testing to manufacture a comprehensive range of lighting systems that consistently exceed performance expectations. Lumascap is a member of the Hunter Industries Family of Companies. Learn more at lumascap.com .
Manufacturing	ISO 9001:2015 certified facility.
Warranty	5-year limited warranty.

Specifications

Dimensions

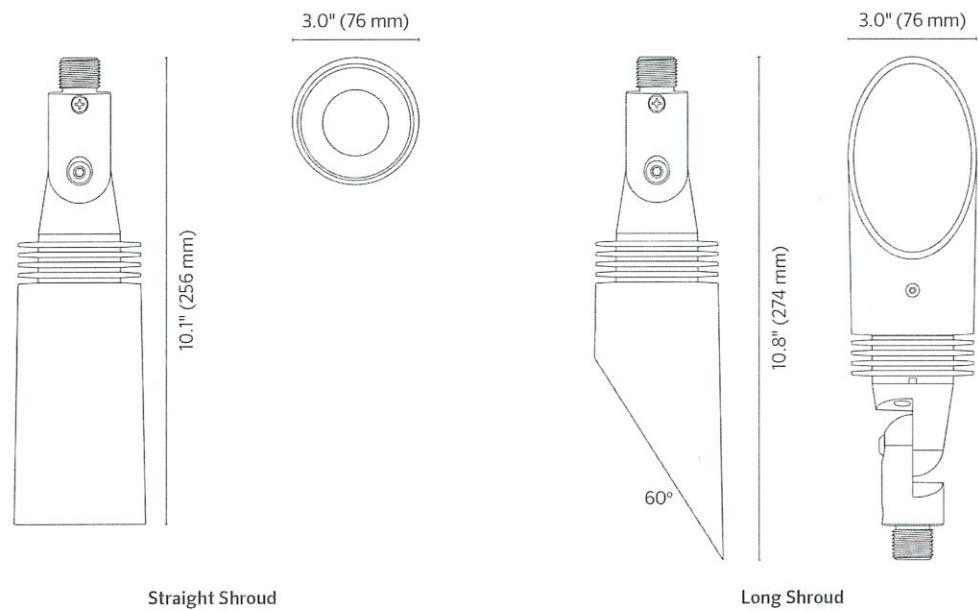

Photometrics 3LED

dBeam-8 3 LED Illuminance at a Distance			
Feet (Meters)	Center Beam	Beam Width	
	Foot-Candles (Lux)	Vertical 35.5°	Horizontal 35.8°
5' (1.5 m)	23 fc (245 lx)	3.2' (1.0 m)	3.2' (1.0 m)
10' (3.0 m)	5.7 fc (61 lx)	6.4' (2.0 m)	6.5' (2.0 m)
15' (4.6 m)	2.5 fc (27 lx)	9.6' (2.9 m)	9.7' (3.0 m)
20' (6.1 m)	1.4 fc (15 lx)	12.8' (3.9 m)	12.9' (3.9 m)
25' (7.6 m)	0.9 fc (10 lx)	16.0' (4.9 m)	16.1' (4.9 m)
30' (9.1 m)	0.6 fc (7 lx)	19.2' (5.9 m)	19.4' (5.9 m)

Note: Photometric data displayed using 2,700 K CCT with a 60° beam angle. ZDC option defaults to Wide Flood.

Photometrics 6LED

dBeam-8 6 LED Illuminance at a Distance

Feet (Meters)	Center Beam	Beam Width	
	Foot-Candles (Lux)	Vertical 32.3°	Horizontal 34.0°
5' (1.5 m)	44 fc (469 lx)	2.9' (0.8 m)	3.1' (0.9 m)
10' (3.0 m)	11 fc (117 lx)	5.8' (1.8 m)	6.1' (1.9 m)
15' (4.6 m)	4.8 fc (52 lx)	8.7' (2.7 m)	9.2' (2.8 m)
20' (6.1 m)	2.7 fc (29 lx)	11.6' (3.5 m)	12.2' (3.7 m)
25' (7.6 m)	1.7 fc (19 lx)	14.5' (4.4 m)	15.3' (4.7 m)
30' (9.1 m)	1.2 fc (13 lx)	17.4' (5.3 m)	18.3' (5.6 m)

Note: Photometric data displayed using 2,700 K CCT with a 60° beam angle. ZDC option defaults to Wide Flood.

Photometrics 9LED

dBeam-8 9 LED Illuminance at a Distance

Feet (Meters)	Center Beam	Beam Width	
	Foot-Candles (Lux)	Vertical 32.9°	Horizontal 34.2°
5' (1.5 m)	58 fc (622 lx)	3.0' (0.9 m)	3.1' (0.9 m)
10' (3.0 m)	15 fc (156 lx)	5.9' (1.8 m)	6.2' (1.9 m)
15' (4.6 m)	6.4 fc (69 lx)	8.9' (2.7 m)	9.2' (2.8 m)
20' (6.1 m)	3.6 fc (39 lx)	11.8' (3.6 m)	12.3' (3.7 m)
25' (7.6 m)	2.3 fc (25 lx)	14.8' (4.5 m)	15.4' (4.7 m)
30' (9.1 m)	1.6 fc (17 lx)	17.7' (5.4 m)	18.5' (5.6 m)

Note: Photometric data displayed using 2,700 K CCT with a 60° beam angle. ZDC option defaults to Wide Flood.

Configuration

For complete and up-to-date product options, configure the dBEM8 using our online product configurator.

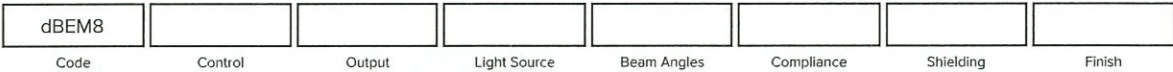

Control

- ☐ **Standard (-)**
1) On/Off, 2) Phase-cut Dimming, or 3) Zone with Luxor® Technology using the ZDClink Lighting Controller.
- ☐ **Zone/Dim (ZD)**
Zone/Dim with Luxor® Technology using the ZDClink Lighting Controller.
- ☐ **Zone/Dim/Color (ZDC)**
Zone/Dim/Color with Luxor® Technology using the ZDClink Lighting Controller.

Output

- ☐ **4.4 W (3LED)**
263 lm
- ☐ **9.3 W (6LED)**
472 lm
- ☐ **12.2 W (9LED)**
665 lm
- ☐ **12.2 W**
665 lm, for ZD control
- ☐ **11.0 W**
For ZDC control

Light Source

- ☐ **Static White (K27)**
2,700 K (80+ CRI)
- 
- ☐ **RGBW**
For ZDC control
- 

Beam Angles

Published angles may vary slightly to photometric data. Please refer to IES files where relevant.

- ☐ **Spot (SP)**
20° beam angle
- ☐ **Flood (FL)**
35° beam angle
- ☐ **Flood**
45° beam angle, for ZDC control
- ☐ **Wide Flood (WF)**
60° beam angle

Compliance

- ☐ North America
UL listed



- ☐ International (E)
Bracket mount, UL listed
and CE approved.
Required for shipment
outside of North
America



Shielding

- ☐ Long Shroud
60° Angled Long
Shroud



- ☐ Straight Shroud (SS)
90° Straight Shroud



Finish

- ☐ Black (BL)
RAL9004 from RAL
Classic collection



- ☐ Anthracite Gray (AG)
RAL7016 from RAL
Classic collection



- ☐ Basalt Gray (BT)
RAL7012 from RAL
Classic collection



- ☐ Graphite Gray (GH)
Graphite Gray powder-
coat finish



- ☐ Anodic Silver (SL)
RAL9006 from RAL
Classic collection



- ☐ White (WT)
RAL9016 from RAL
Classic collection



- ☐ Dark Bronze (DB)
RAL8019 from RAL
Classic collection



- ☐ Latte (LT)
RAL7006 from RAL
Classic collection



- ☐ Dark Aluminium (DA)
RAL9007 from RAL
Classic collection



- ☐ Custom RAL (CC)
A one-off custom color
setup fee applies. Click
on 'More Info' button to
add to your enquiry.
Contact Lumascape for
volume discount on set-
up fee.



Accessories

Mounting & Installation

Specify Separately

- ☐ Mini Mount (MM-050)



- ☐ Versabox® (VB-050)
A 1.5" (38 mm) brass cap with 1/2"-14 NPSM threads.



- ☐ Mini J-Box (MJ-050)
A 1.5" (38 mm) aluminum wall mount with 1/2"-14 NPSM threads and wire compartment.



- ☐ Treebox® (TB)
A dual 1/2"-14 NPSM threads with wire compartment.



- ☐ Gutter Mount (GM-SS)
A 4.4" (112 mm) aluminum cap with 1/2"-14 NPSM threads and wire compartment; 2.0" schedule 40 conduit.



- ☐ Wall Plate 1-Gang (WP-1G-050)
1-gang wall plate with 1/2"-14 NPSM threads.



- ☐ Wall Plate, Round (WP-RD-050)
5" (127 mm) round wall plate with 1/2"-14 NPSM threads.



- ☐ Non-Penetrating Tree Ring (TR)
Adjustable, drill-free, non-penetrating tree ring, accommodates up to six luminaires.



Risers & Coupling

Specify Separately

- ☐ Straight Riser (—)
An aluminum straight riser with 0.8" (12 mm) OD and 1/2"-14 Male NPSM x2 threads.



- ☐ Angled Sign-Light Riser (↘)
An aluminum angled sign-light riser with 0.8" (12 mm) OD, 45° bend, and 1/2"-14 NPSM x2 threads.



- ☐ Straight Coupling (COUP)
An aluminum straight coupling 1.3" (32 mm) x 2.0" (51 mm).



- ☐ Coupling, 90-deg, 1/2" NPSM (ELBW-050)
An aluminum 90° coupling 1.3" (32 mm) x 2.0" (51 mm).



- ☐ Coupling, T, 1/2" NPSM (TMNT-050)
An aluminum T Coupling, 1/2" NPSM Thread.



Lens Accessories

Specify Separately

- ☐ Hex Baffle
(250015260000)
2" (50 mm) diameter
(MR-16)



- ☐ Linear Spread Lens
(250013550000)
2" (50 mm) diameter
(MR-16)



- ☐ Solite Spread Lens
(250015240000)
2" (50 mm) diameter
(MR-16)



Power Supplies

Specify Separately

- ☐ Multi-Tap
Transformer
(PROLINK)
The industry's most
reliable multi-tap
transformer.



- ☐ ZDCLink® Lighting
Controller (ZDCLink)
A combined lighting
controller and
transformer (120 Vac to
14 Vac) that offers
powerline zoning,
dimming, RGBW color
changing, and optional
Wi-Fi control via Luxor
Technology™



- ☐ Dimmable Mini
Transformer (ST-
120-DIM)
60 W, 120 V to 12 Vac
step-down transformer.



- ☐ Non-Dimmable Mini
Transformer (ST-
UV)
30 W universal voltage
step-down transformer.



- ☐ 6 W Plug-in
Transformer (MT-
6W)
Standard North
American Type A, Class
2 transformer with 6 W
capacity and 1' (300 mm)
flying leads.

- ☐ 30 W Plug-in
Transformer (MT-
30W)
Standard North
American Type A, Class
2 transformer with 30 W
capacity and 1' (300 mm)
flying leads.

Supplemental Surge Protection

Specify Separately

- ☐ In-Line Surge
Arrestor (SURGE-
MOD)
Provides two additional
layers of surge
protection (up to 10KW)
to any 12 Vac/dc LED
luminaire.



Wire Connections

Specify Separately

- ☐ Heat Shrink Wire Connectors - Small (WCHSSM20)
Tin-coated copper butt splices with adhesive-filled heat shrink tubes.



- ☐ Heat Shrink Wire Connectors - Medium (WCHSMD20)
Tin-coated copper butt splices with adhesive-filled heat shrink tubes.



Custom Color

A one-off setup fee applies for each custom color per order. Add to your enquiry.

- ☐ Custom Color Setup
Fee: Essential Series (Custom RAL Color Setup)
Custom RAL colour setup fee



Give every landscape the light it deserves



When it comes to lighting design, why should architecture have all the fun? We've added more than 50 new landscape luminaires, offering unmatched performance, simple installation, and compatibility with state-of-the-art Luxor® Technology. Discover endless new possibilities to bring your next landscape lighting project to life at lumascape.com.



ARCHITECTURAL & FACADE LIGHTING
Learn more. Visit lumascape.com

 **LUMASCAPE**

Inspire Neon Flex 0606 Top Bend

24V DC LED Neon Flex



Type

QTY

Part Number

Signature



ALTERNATE

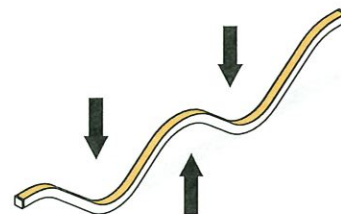
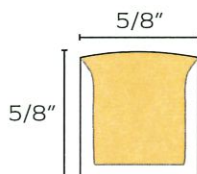

Top Bend (bends up-and-down)

Specifications

Power	4.4 Watts/FT
Max Run Length	22FT
Cut Length	<ul style="list-style-type: none">Single Color & RGB: Every 2"RGBW: Every 3"
Available Colors	2700K, 3000K, 3500K, 4000K, Red, Green, Blue, Pink, Yellow, RGB, and RGBW (RGB + 3000K)
Input Voltage	24V DC
Bend Type	Top Bend (bends up-and-down)
Product Material	UV-Resistant Silicone
Product Color	White
Minimum Bend Diameter	4-3/4"
Beam Angle	120°
Lamp Life	50,000 Hours
Max Ambient Temperature	-13°F to 131°F (-25°C to 55°C)
Max Operating Temperature	32°F to 131°F (0°C to 55°C)
Environment	IP67 Indoor or Outdoor
Dimming	<ul style="list-style-type: none">For Single Colors: 0-10V, MLV, ELV, Incandescent, and CFL/LEDFor RGB & RGBW: Dimmable using Lighting Controls (see pg. 6 for details)
Connector	Pre-Assembled Connectors or In-Field Connectors
Certifications & Safety Standards	<ul style="list-style-type: none">UL Listed for The United States and Canada - File # E467147UL Listed per UL2108 Low Voltage Lighting Systems/CSA C22.2 No 250.0-08-Luminaires/UL8750Title 24 JA8 CompliantAlways review all local and national safety standards before installing any LEDI product(s).

Performance

Color	Lumens/FT	Efficacy	CRI
Single Color			
2700K	162	37 lm/W	90
3000K	168	38 lm/W	80 or 90
3500K	175	40 lm/W	90
4000K	180	41 lm/W	80 or 90
Red	65	15 lm/W	n/a
Green	192	44 lm/W	n/a
Blue	25	6 lm/W	n/a
Pink	88	20 lm/W	n/a
Yellow	291	66 lm/W	n/a
RGB			
RGB White	71	16 lm/W	n/a
Red	16	4 lm/W	n/a
Green	45	10 lm/W	n/a
Blue	7	2 lm/W	n/a
RGBW (RGB + 3000K)			
3000K	46	10 lm/W	80 or 90
RGBW	103	23 lm/W	80 or 90
Red	13	3 lm/W	n/a
Green	35	8 lm/W	n/a
Blue	6	1 lm/W	n/a

Inspire Neon Flex 0606 Top Bend

24V DC LED Neon Flex



Type

QTY

Part Number

Signature

Standard Order Neon Flex

Shorter lead times for a faster turnaround.

Ordering Example

22FT Rolls

Part Number Example	Order QTY	Amount Received
NF1-T0606S-30-2B-22	10	(10) 22ft rolls

Part Number	Color/Color Temperature	Connector (see pg. 3 for details)
NF1-T0606S-27-2E-22	QUICKSHIP 2700K	Double End Exit
NF1-T0606S-30-2E-22	QUICKSHIP 3000K	
NF1-T0606S-35-2E-22	QUICKSHIP 3500K	
NF1-T0606S-40-2E-22	QUICKSHIP 4000K	
NF1-T0606S-RED-2E-22	QUICKSHIP Static Red	
NF1-T0606S-GRN-2E-22	QUICKSHIP Static Green	
NF1-T0606S-BLU-2E-22	QUICKSHIP Static Blue	
NF1-T0606S-RGB-2E-22	QUICKSHIP RGB	
NF1-T0606S-RGBW-2E-22	QUICKSHIP RGBW	Double Back Exit
NF1-T0606S-27-2B-22	QUICKSHIP 2700K	
NF1-T0606S-30-2B-22	QUICKSHIP 3000K	
NF1-T0606S-35-2B-22	QUICKSHIP 3500K	
NF1-T0606S-40-2B-22	QUICKSHIP 4000K	
NF1-T0606S-RED-2B-22	QUICKSHIP Static Red	
NF1-T0606S-GRN-2B-22	QUICKSHIP Static Green	
NF1-T0606S-BLU-2B-22	QUICKSHIP Static Blue	
NF1-T0606S-RGB-2B-22	QUICKSHIP RGB	
NF1-T0606S-RGBW-2B-22	QUICKSHIP RGBW	

QUICKSHIP = Quickship item. Quickship items are available to ship within 48-hours (excluding weekends and holidays).

Ordering Example

Custom Lengths

Part Number Example	Order QTY	Amount Received
NF1-T0606S-30-1B-CUSTOM	10	10ft (continuous run)

Part Number	Color/Color Temperature	Connector (see pg. 3 for details)
NF1-T0606S-27-1E-CUSTOM	2700K	Single End Exit
NF1-T0606S-30-1E-CUSTOM	3000K	
NF1-T0606S-35-1E-CUSTOM	3500K	
NF1-T0606S-40-1E-CUSTOM	4000K	
NF1-T0606S-RED-1E-CUSTOM	Static Red	
NF1-T0606S-GRN-1E-CUSTOM	Static Green	
NF1-T0606S-BLU-1E-CUSTOM	Static Blue	
NF1-T0606S-RGB-1E-CUSTOM	RGB	
NF1-T0606S-RGBW-1E-CUSTOM	RGBW	Single Back Exit
NF1-T0606S-27-1B-CUSTOM	2700K	
NF1-T0606S-30-1B-CUSTOM	3000K	
NF1-T0606S-35-1B-CUSTOM	3500K	
NF1-T0606S-40-1B-CUSTOM	4000K	
NF1-T0606S-RED-1B-CUSTOM	Static Red	
NF1-T0606S-GRN-1B-CUSTOM	Static Green	
NF1-T0606S-BLU-1B-CUSTOM	Static Blue	
NF1-T0606S-RGB-1B-CUSTOM	RGB	
NF1-T0606S-RGBW-1B-CUSTOM	RGBW	

Inspire Neon Flex O6O6 Top Bend

24V DC LED Neon Flex



Type

QTY

Part Number

Signature

Special Order Neon Flex

Available in custom lengths, with additional colors and connector options. Contact our Design Team at designs@ledinspirations.com or (832) 717-2710 for a lead time.

1 Select the Neon Flex

Part Number	Color/Color Temperature
NF1-T0606S-27-FAS	2700K
NF1-T0606S-30-FAS	3000K
NF1-T0606S-35-FAS	3500K
NF1-T0606S-40-FAS	4000K
NF1-T0606S-RED-FAS	Static Red
NF1-T0606S-GRN-FAS	Static Green
NF1-T0606S-BLU-FAS	Static Blue
NF1-T0606S-PNK-FAS	Static Pink
NF1-T0606S-YLW-FAS	Static Yellow
NF1-T0606S-RGB-FAS	RGB
NF1-T0606S-RGBW-FAS	RGBW

2 Select the Pre-Assembled Connector

Part Number	Wire Exit (see pg. 3 for details)	Compatibility
NF1-CON-T0606S-2C-FAS-1E	Single End Exit	Single Color (27K, 30K, 35K, 40K, Red, Green, Blue, Pink, & Yellow)
NF1-CON-T0606S-2C-FAS-1B	Single Back Exit	
NF1-CON-T0606S-2C-FAS-1SR	Single Right Side Exit	
NF1-CON-T0606S-2C-FAS-1SL	Single Left Side Exit	
NF1-CON-T0606S-2C-FAS-2E	Double End Exit	
NF1-CON-T0606S-2C-FAS-2B	Double Back Exit	
NF1-CON-T0606S-2C-FAS-2S	Double Side Exit	RGB
NF1-CON-T0606S-4C-FAS-1E	Single End Exit	
NF1-CON-T0606S-4C-FAS-1B	Single Back Exit	
NF1-CON-T0606S-4C-FAS-1SR	Single Right Side Exit	
NF1-CON-T0606S-4C-FAS-1SL	Single Left Side Exit	
NF1-CON-T0606S-4C-FAS-2E	Double End Exit	
NF1-CON-T0606S-4C-FAS-2B	Double Back Exit	RGBW
NF1-CON-T0606S-4C-FAS-2S	Double Side Exit	
NF1-CON-T0606S-5C-FAS-1E	Single End Exit	
NF1-CON-T0606S-5C-FAS-1B	Single Back Exit	
NF1-CON-T0606S-5C-FAS-1SR	Single Right Side Exit	
NF1-CON-T0606S-5C-FAS-1SL	Single Left Side Exit	
NF1-CON-T0606S-5C-FAS-2E	Double End Exit	
NF1-CON-T0606S-5C-FAS-2B	Double Back Exit	
NF1-CON-T0606S-5C-FAS-2S	Double Side Exit	

Ordering Example

Part Number Example	Order QTY	Amount Received
NF1-T0606S-RED-FAS	12	12ft (continuous run)
NF1-CON-T0606S-2C-FAS-1B	1	1

Inspire Neon Flex 0606 Top Bend

24V DC LED Neon Flex



Type

QTY

Part Number

Signature

Pre-Assembled Connectors

Injection molded connectors pre-assembled with the Neon Flex. See pg. 2 for ordering information.



Single End (1E)

(1) connector that exits out the end of the Neon Flex. The opposite end is sealed.



Single Back (1B)

(1) connector that exits out the back of the Neon Flex. The opposite end is sealed.

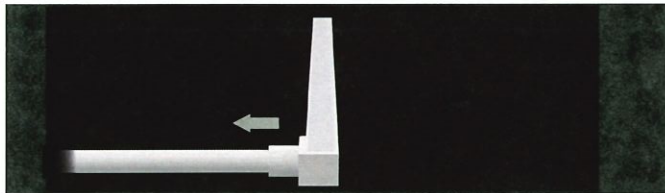

Single Left Side (1SL)

(1) connector exits out the left side of the Neon Flex (with the lens facing up). The opposite end is sealed.

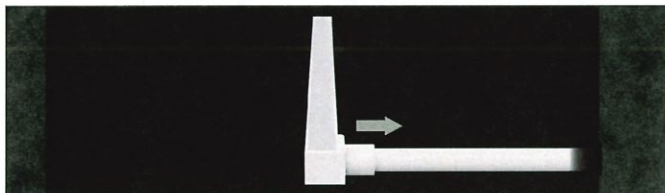

Single Right Side (1SR)

(1) connector exits out the right side of the Neon Flex (with the lens facing up). The opposite end is sealed.



Double End (2E)

(1) connector exits out one end of the Neon Flex. The opposite end, also, has (1) connector that exits out the end of the Neon Flex.



Double Back (2B)

(1) connector exits out the back of the Neon Flex. The opposite end, also, has (1) connector that exits out the back of the Neon Flex.

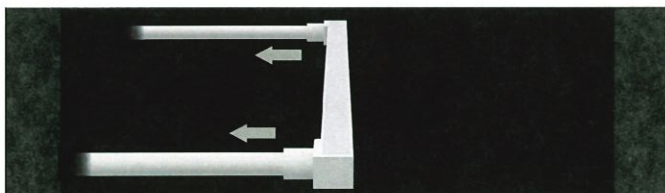

Double Side (2S)

(1) connector exits out the side of the Neon Flex. The opposite end, also, has (1) connector that exits out the side of the Neon Flex.

Inspire Neon Flex 0606 Top Bend

24V DC LED Neon Flex



Type

QTY

Part Number

Signature

In-Field Connectors

For assembly in the field.

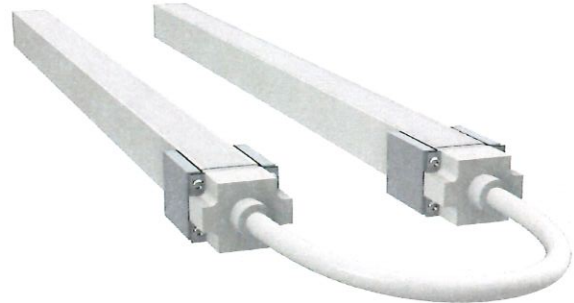
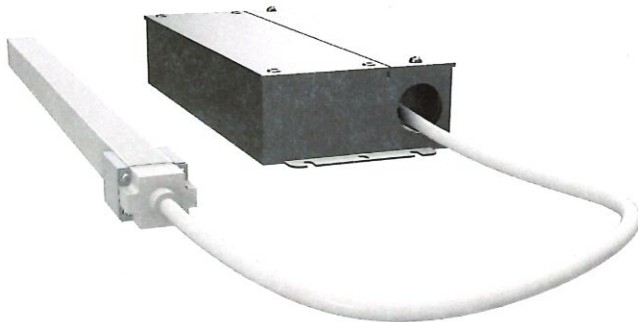

Hardwire Connector

Connects the Neon Flex to an LED driver or lighting control component.

Part Number	Length	Compatibility
NF1-CON-T0606S-2C-IFC-ER-1FT	1FT	Single Color
NF1-CON-T0606S-4C-IFC-ER-1FT	1FT	RGB

Extension (jumper)

Connects one run of Neon Flex to another.

Part Number	Length	Compatibility
NF1-EXT-T0606S-2C-IFC-1FT	1FT	Single Color
NF1-EXT-T0606S-4C-IFC-1FT	1FT	RGB

In-Field Connectors are NOT available for RGBW.

End Caps

Adheres to the end of a cut piece of Neon Flex.

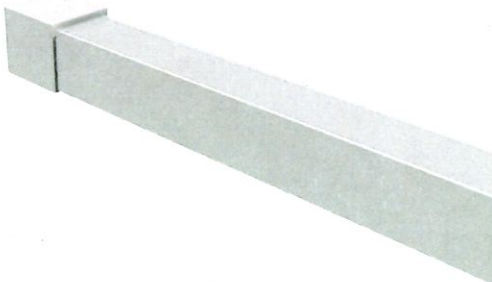

Part Number

NF1-END-0606-SCN

Inspire Neon Flex 0606 Top Bend

24V DC LED Neon Flex



Type

QTY

Part Number

Signature

Mounting Hardware

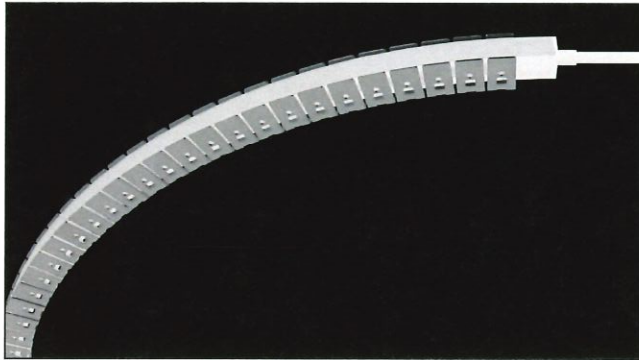

Flexible Channel

For mounting Neon Flex that bends up-and-down. This product is NOT field cuttable.

Part Number	Length	Includes
NF1-CHN-FX2-10CM	11.8"	Channel and screws
NF1-CHN-FX2-50CM	19.7"	Channel and screws
NF1-CHN-FX2-1M	3.28FT	Channel and screws

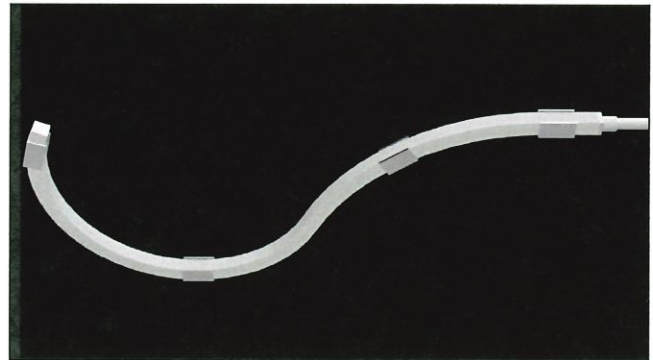

Mounting Clips

For mounting Neon Flex that bends up-and-down.

Part Number	Includes
NF1-MNT-CL2	(10) mounting clips and screws

- For simple bends: Use 3-4 clips per foot
- For more complex bends: Use 5 clips per foot
- Each Mounting Clip includes a pre-installed Lock-In Clip to securely hold the Neon Flex in place.

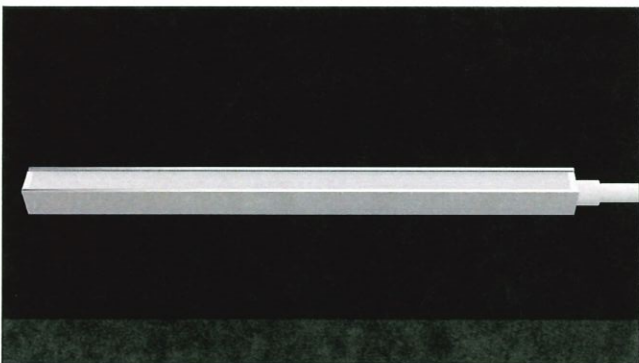

Aluminum Channel

For mounting straight runs of Neon Flex.

Part Number	Length	Includes
NF1-CHN-AL2-1M	3.28FT	Channel and screws

Each Aluminum Channel includes (5) pre-installed Lock-In Clips to securely hold the Neon Flex in place.

Flexible Channel Dimensions

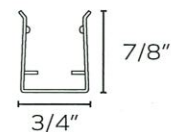

Mounting Clip Dimensions

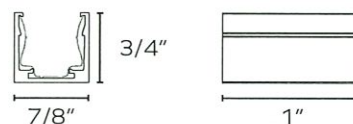

Aluminum Channel Dimensions

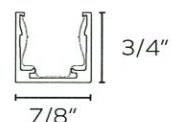

Inspire Neon Flex 0606 Top Bend

24V DC LED Neon Flex



Type

QTY

Part Number

Signature

Drivers & Lighting Controls

For additional parts and specifications, please see the specific product spec sheet.

Drivers

Required to power the Neon Flex.

Part Number	Description
DR-30W-24V-DIMALL	30-watt DimALL™ Driver. 120-277V AC. Compatible with select 0-10V, MLV, ELV, CFL/LED, and incandescent dimmers. Class 2.
DR-60W-24V-DIMALL	60-watt DimALL™ Driver. 120-277V AC. Compatible with select 0-10V, MLV, ELV, CFL/LED, and incandescent dimmers. Class 2.
DR-96W-24V-DIMALL	96-watt DimALL™ Driver. 120-277V AC. Compatible with select 0-10V, MLV, ELV, CFL/LED, and incandescent dimmers. Class 2.
DR-150W-24V-DIMALL	150-watt DimALL™ Driver. 120-277V AC. Compatible with select 0-10V, MLV, ELV, CFL/LED, and incandescent dimmers.
DR-192W-24V-DIMALL	192-watt DimALL™ Driver. 120-277V AC. Compatible with select 0-10V, MLV, ELV, CFL/LED, and incandescent dimmers. Class 2.
DR-200W-24V-DIMALL	200-watt DimALL™ Driver. 120-277V AC. Compatible with select 0-10V, MLV, ELV, CFL/LED, and incandescent dimmers.
DR-288W-24V-DIMALL	288-watt DimALL™ Driver. 120-277V AC. Compatible with select 0-10V, MLV, ELV, CFL/LED, and incandescent dimmers. Class 2.
DR-300W-24V-DIMALL	300-watt DimALL™ Driver. 120-277V AC. Compatible with select 0-10V, MLV, ELV, CFL/LED, and incandescent dimmers.
DR-60W-24VDC-U-2-10-c	60-watt Electronic 0-10V Driver. 120-277V AC. Compatible with most 0-10V dimmers. Class 2.
DR-100W-24VDC-U-2-10-c	100-watt Electronic 0-10V Driver. 120-277V AC. Compatible with most 0-10V dimmers. Class 2.
DR-200W-24VDC-U-2-10-g	200-watt Electronic 0-10V Driver. 120-277V AC. Compatible with most 0-10V dimmers.
DR-36W-24VDC-120V-2-ND-e	36-watt Plug-In Driver. 120-240V AC. Non-dimmable. Includes 3-prong wall plug. Class 2.
DR-96W-24VDC-120V-2-ND-e	96-watt Plug-In Driver. 120-240V AC. Non-dimmable. Includes 3-prong wall plug. Class 2.
DR-144W-24VDC-120V-1-ND-e	144-watt Plug-In Driver. 120-240V AC. Non-dimmable. Includes 3-prong wall plug.

Lighting Controls

Required to control RGB or RGBW Neon Flex.

Part Number	Description	Other Required Components	Compatibility
CONT-CCS-PCM	Communicates wirelessly with the Casambi app and Casambi Wireless Wall Controller.	Electronic Driver	Single Color, RGB, & RGBW
CONT-CCS-WSC	Wall-mounted controller that communicates wirelessly with the Casambi app and Casambi PWM Bluetooth Decoder.	Casambi PWM Bluetooth Decoder	Single Color, RGB, & RGBW
RGB-DMX-CONT-STICK3	Wall-mounted controller that controls multiple areas of lighting independently or together.	DMX Decoder	RGB & RGBW
RGB-DMX-CONT-STICK-CW4	Wall-mounted controller that controls multiple areas of lighting together.	DMX Decoder	RGB
RGB-DMX-DECODER	Translates a DMX signal. For use with DMX wall controllers.	DMX Wall Controller, Electronic Driver	RGB & RGBW
RGB-RF-AMP-T3M	T3M Amplifier that controls multiple areas of lighting independently or together.	T3M Handheld Controller, Electronic Driver	RGB
RGB-RF-CONT-T3M	Handheld RF controller for the T3M Amplifier.	T3M Amplifier	RGB
RGB-RF-CONT-M3	Handheld RF controller that controls multiple areas of lighting together.	Handheld Controller & Amplifier	RGB