

UTILITY STATEMENT:

THE UNDERGROUND UTILITIES SHOWN HAVE BEEN LOCATED FROM FIELD SURVEY INFORMATION AND EXISTING DRAWINGS. THE SURVEYOR & ENGINEER MAKES NO GUARANTEE THAT THE UNDERGROUND UTILITIES SHOWN COMPRISE ALL SUCH UTILITIES IN THE AREA, EITHER IN SERVICE OR ABANDONED. THE SURVEYOR & ENGINEER FURTHER DOES NOT WARRANT THAT THE UNDERGROUND UTILITIES SHOWN ARE IN THE EXACT LOCATION INDICATED ALTHOUGH HE DOES CERTIFY THAT THEY ARE LOCATED AS ACCURATELY AS POSSIBLE FROM INFORMATION AVAILABLE. THE SURVEYOR & ENGINEER HAS NOT PHYSICALLY LOCATED THE UNDERGROUND UTILITIES. CONTRACTOR IS RESPONSIBLE IN VERIFYING LOCATION OF UTILITIES.

THE EXISTING TOPOGRAPHIC SURVEY WAS PROVIDED TO SMITH ROBERTS BALDWIN, LLC (SRB) FOR USE ON THIS PROJECT. SRB MAKES NO WARRANTY AS TO THE ACCURACY OR COMPLETENESS.

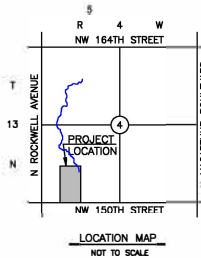
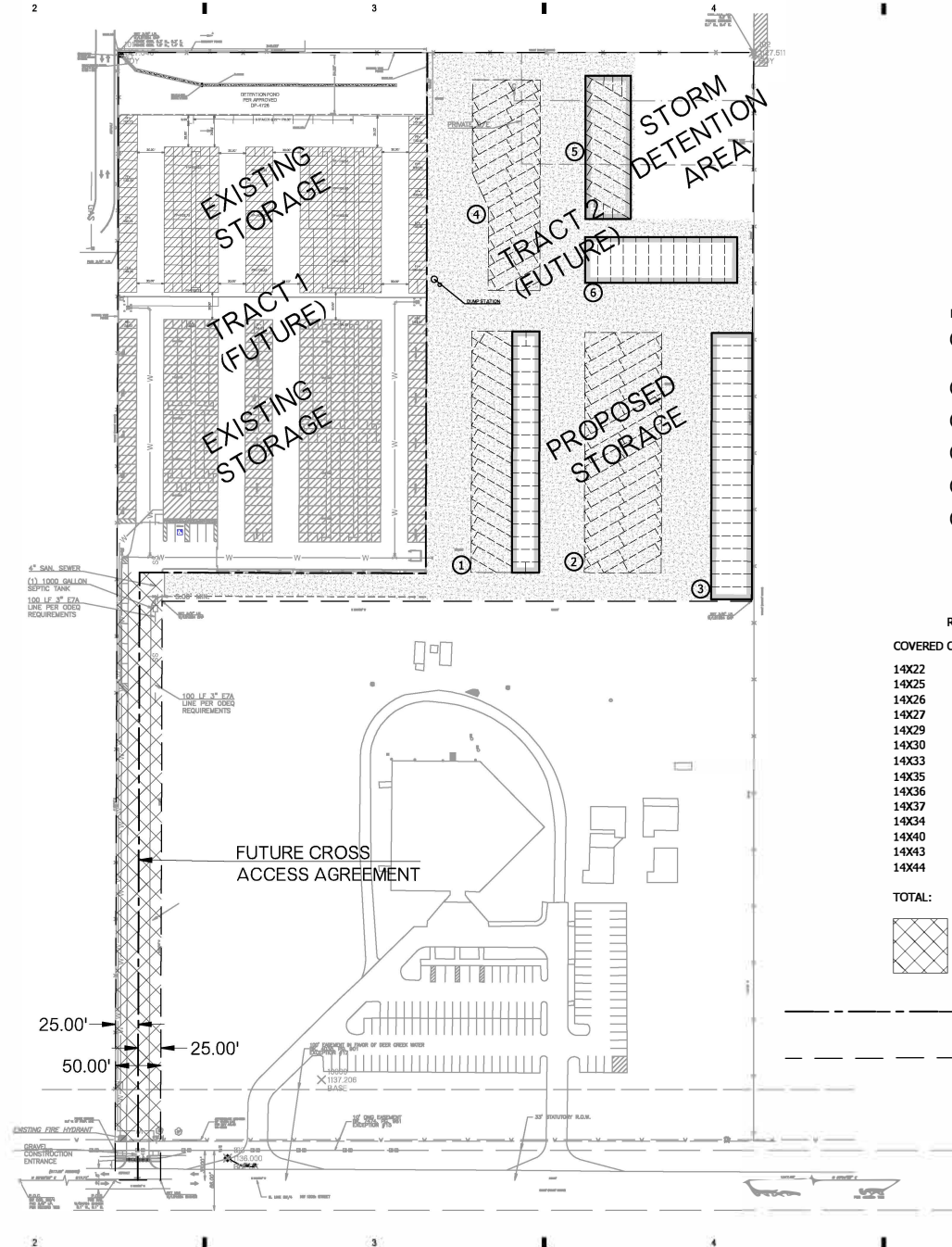
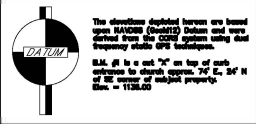

RV STORAGE BUILDING SCHEDULE

- ① 75'X 266' (19,950 S.F.)
(PARTIAL COVERED ONLY)
(PARTIAL TOTALLY ENCLOSED)
- ② 85'X 265' (22,525 S.F.)
(COVERED ONLY)
- ③ 45'X 294' (13,230 S.F.)
(TOTALLY ENCLOSED)
- ④ 75'X 232' (15,415 S.F.)
(COVERED ONLY)
- ⑤ 50'X 158' (7,900 S.F.)
(TOTALLY ENCLOSED)
- ⑥ 50'X 168' (8,400 S.F.)
(TOTALLY ENCLOSED)

(TOTAL: 87,420 S.F.)

RV STORAGE UNIT MIX

COVERED ONLY:	TOTALLY ENCLOSED:
14X22 (1)	10X11 (2)
14X25 (1)	10X17 (2)
14X26 (1)	10X23 (2)
14X27 (7)	15X11.5 (2)
14X29 (1)	15X16.5 (2)
14X30 (6)	20X11 (2)
14X33 (1)	14X30 (17)
14X35 (6)	14X45 (21)
14X36 (1)	14X49 (8)
14X37 (1)	14X50 (12)
14X34 (1)	
14X40 (1)	TOTAL: (70)
14X43 (20)	
14X44 (14)	
TOTAL: (57)	

FUTURE CROSS ACCESS AGREEMENT

FUTURE PROPERTY LINE
 EXISTING PROPERTY LINE

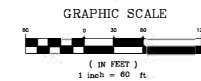

PUD-2012 Exhibit B

ENGINEERING
SURVEYING
PLANNING



SEAL:

SELF STORAGE PROJECT
PHASE 3
7001 NW 150TH STREET OKC, OK 73142

SHEET TITLE:
CONCEPTUAL SITE PLAN
DATE: 3/22/2022
SHEET NUMBER

1