



The City of Oklahoma City
Office of City Clerk
200 North Walker Ave.
Oklahoma City, Oklahoma 73102
(Water/Wastewater) Project No. WA-2022-00018

B#36,548

PERMANENT EASEMENT

KNOW ALL MEN BY THESE PRESENTS THAT OAK PHASE 1 PROPERTY OWNER, LLC, a Delaware limited liability company its successors, and assigns (collectively "Grantor") for and in consideration of Ten Dollars and other good and valuable consideration, receipt of which is hereby acknowledged, does hereby grant and convey unto the **CITY OF OKLAHOMA CITY**, a municipal corporation, and its public trusts (collectively "Grantees") this Permanent Easement over, under, across, through and to the following described property situated in **OKLAHOMA** County, Oklahoma, shown on **Attachment "A" and Attachment "B" ("Subject Property")** for the use of the **Grantees** for the purpose of constructing, operating, maintaining, repairing, expanding, and replacing water and wastewater systems and associated facilities, connections, utilities, and appurtenances thereto (collectively "Utility Systems") and including the right of ingress and egress through Grantor's property to and from the Subject Property and all right, title and interest in and to any soil, earthen material, fixture, and appurtenances within the boundaries of the Subject Property, incidentally removed during the use of this Permanent Easement.

THIS EASEMENT IS MADE SUBJECT TO THE FOLLOWING:

1. Grantor agrees that no building or other similar structure shall be erected on, over or under the Subject Property.
2. Grantor may construct driveways and parking areas on the Subject Property.
3. Grantor agrees that Grantees will not maintain, repair or replace Grantor's improvements, including but not limited to fencing, landscaping, sprinklers, pools, sheds, mailboxes, driveways and parking areas whenever it becomes necessary to move or remove improvements, due to any operation, maintenance, replacement, expansion, or repair of the Utility Systems.
4. This Permanent Easement does not create an obligation upon the Grantees to construct the Utility Systems, or provide services or functions. Once the Utility System is constructed the Grantees agree to operate, maintain, replace, expand, or repair the Utility System in accordance with Grantees' standards and policies.
5. The Grantees do not own the creek, river, lake, detention pond, drainage canal, if any, on or adjacent to the Subject Property and are not legally responsible nor does this Permanent Easement create an obligation upon the Grantees for changes, alterations and modifications to any part or parts of the Subject Property described herein, in the past, present or future, which may be affected in any manner by any change or changes in the course of the creek or waterway, by any accretion or erosion, or evulsion, or alluvion or combination thereof, touching or concerning any part of said Subject Property.

This Permanent Easement shall be perpetual and exclusive to Grantees and shall run in favor of the respective parties, hereto, their successors and assigns.

OAK PHASE 1 PROPERTY OWNER, LLC,
a Delaware limited liability company

Dated this 10th day of August, 2023.

By: [Signature]
Ryan McNeill, Manager of Oak Developer
Manager, LLC, Manager

STATE OF OKLAHOMA, COUNTY OF Tulsa, SS.

This instrument was acknowledged before me on this 10th day of August, 2023 by **Ryan McNeill**, as **Manager of OAK PHASE 1 PROPERTY OWNER, LLC, a Delaware limited liability company**.

My Commission Expires: 6/14/25
My Commission No. 1378677

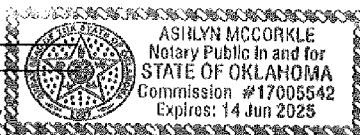

[Signature]
Notary Public

ACCEPTED by [Signature] of City of Oklahoma City
this 27th day of August, 2023

City Clerk

REVIEWED for form and legality
[Signature]

Assistant Municipal Counselor

ATTACHMENT "A" (1 OF 2)

WATERLINE EASEMENT 03

A tract of land, being a part of Lot 1, Block 1, OAK ADDITION to Oklahoma City, Oklahoma County, Oklahoma, according to the plat recorded in Book 82 of Plats, Page 12, lying in the Southeast Quarter of Section 7, Township 12 North, Range 3 West of the Indian Meridian, Oklahoma County, Oklahoma, being more particularly described as follows:

COMMENCING at the southwest corner of said Lot 1;

THENCE South 78°29'28" East, along the south line of said Lot 1 a distance of 16.60 feet to the POINT OF BEGINNING;

THENCE North 11°30'32" East a distance of 10.00 feet;

THENCE South 78°29'28" East, a distance of 10.00 feet;

THENCE South 11°30'32" West, a distance of 10.00 feet;

THENCE North 78°29'28" West, a distance of 10.00 feet to the POINT OF BEGINNING.

Said described tract of land contains an area of 100 square feet or 0.0023 acres, more or less.

The basis of bearings for this description is the Oklahoma State Plane Coordinate System (NAD83-North Zone) using a bearing of South 88°56'32" West on the common line between the Southeast Quarter of Section 7 and the Northeast Quarter of Section 18, Township 12 North, Range 3 West of the Indian Meridian.

Prepared by: Terence L. Haynes, P.E. #16820
SMC Consulting Engineers, P.C.
815 W. Main Street - OKC, OK 73106
August 10, 2023
Revised: August 21, 2023

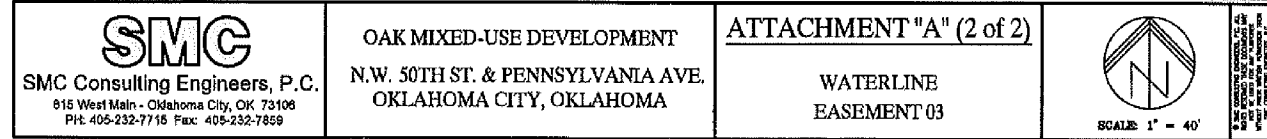

ATTACHMENT "B" (1 OF 2)

WATERLINE EASEMENT 04

A tract of land, being a part of Lot 1, Block 1, OAK ADDITION to Oklahoma City, Oklahoma County, Oklahoma, according to the plat recorded in Book 82 of Plats, Page 12, lying in the Southeast Quarter of Section 7, Township 12 North, Range 3 West of the Indian Meridian, Oklahoma County, Oklahoma, being more particularly described as follows:

COMMENCING at the southwest corner of said Lot 1;

THENCE South 78°29'28" East, along the south line of said Lot 1 a distance of 85.68 feet to the POINT OF BEGINNING;

THENCE North 11°30'32" East a distance of 10.00 feet;

THENCE South 78°29'28" East, a distance of 5.00 feet;

THENCE South 11°30'32" West, a distance of 10.00 feet;

THENCE North 78°29'28" West, a distance of 5.00 feet to the POINT OF BEGINNING.

Said described tract of land contains an area of 50 square feet or 0.0011 acres, more or less.

The basis of bearings for this description is the Oklahoma State Plane Coordinate System (NAD83-North Zone) using a bearing of South 88°56'32" West on the common line between the Southeast Quarter of Section 7 and the Northeast Quarter of Section 18, Township 12 North, Range 3 West of the Indian Meridian.

Prepared by: Terence L. Haynes, P.E. #16820
SMC Consulting Engineers, P.C.
815 W. Main Street - OKC, OK 73106
August 10, 2023
Revised: August 21, 2023

