

FINAL PLAT
of

LEXFORD PARK PHASE 1

BEING A PART OF THE SE/4, SEC. 16, T12N, R3W, L.M.,
AN ADDITION TO OKLAHOMA CITY, OKLAHOMA COUNTY, OKLAHOMA

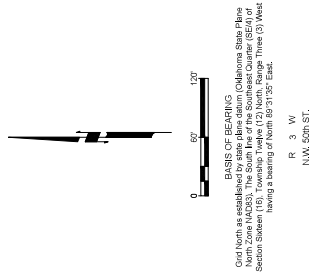
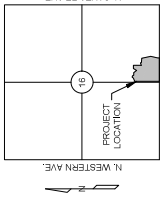

Chart North as established by the Oklahoma State Plane North Zone NAD83. The South line of the Southeast Quarter (SE/4) of Section 16, Township 12N, Range 3W, L.M. is a bearing of North 89° 31' 32" East.

R 3 W
N.W. 36th ST.



N.W. 36th ST.
LOCATION MAP
SCALE 1"=2000'

***** NOTE *****
THIS SURVEY WAS CONDUCTED IN ACCORDANCE WITH THE STANDARDS FOR THE PRACTICE OF LAND SURVEYING AS ADOPTED BY THE OKLAHOMA STATE BOARD OF REGISTRATION FOR LAND SURVEYORS. THE SURVEY WAS CONDUCTED IN ACCORDANCE WITH THE STANDARDS FOR THE PRACTICE OF LAND SURVEYING AS ADOPTED BY THE OKLAHOMA STATE BOARD OF REGISTRATION FOR LAND SURVEYORS. THE SURVEY WAS CONDUCTED IN ACCORDANCE WITH THE STANDARDS FOR THE PRACTICE OF LAND SURVEYING AS ADOPTED BY THE OKLAHOMA STATE BOARD OF REGISTRATION FOR LAND SURVEYORS.

- LEGEND:
- POC = POINT OF COMMENCEMENT
 - BL = BUILDING UNIT LINE
 - UE = PUBLIC UTILITY EASEMENT
 - D & U = DRAINAGE & UTILITY EASEMENT
 - P.S./P.U.E. = PRIVATE STREET & PUBLIC UTILITY EASEMENT
 - NR = NOT RAILROAD
 - CA = COMMON AREA
 - STAT. RW = STATUTORY RIGHT OF WAY
 - RW = RIGHT OF WAY
 - BL = BUILDING UNIT LINE
 - UE = PUBLIC UTILITY EASEMENT
 - D & U = DRAINAGE & UTILITY EASEMENT
 - P.S./P.U.E. = PRIVATE STREET & PUBLIC UTILITY EASEMENT

Curve Table				
Curve #	Length	Radius	Tangent	Chord Direction
C1	78.35'	530.00'	39.25'	N88°46'22"E
C2	54.94'	200.00'	27.66'	S82°36'12"E
C3	54.94'	200.00'	27.66'	S82°36'12"E
C4	29.68'	550.00'	17.86'	N77°01'59"E
C5	85.54'	500.00'	42.87'	S14°57'19"E
C6	100.84'	100.00'	89.19'	S10°52'53"W
C7	146.00'	200.00'	76.66'	S20°42'00"W
C8	89.64'	100.00'	39.73'	N73°23'29"W

Line Table		
Line #	Length	Direction
L1	35.29'	S45°22'02"E
L2	35.42'	N44°37'06"E
L3	36.32'	N53°28'05"W
L4	36.35'	S33°18'41"W
L5	38.51'	N77°00'00"E
L6	33.84'	N22°36'39"W
L7	55.57'	N44°31'35"E
L8	55.57'	N45°28'05"W
L9	13.42'	N55°18'15"W

NOTES:

- All easements within street right-of-way, and aerial landscaping with its irrigation system, shall be maintained by the Property Owners Association within LEXFORD PARK PHASE 1.
- Maintenance of all common areas and private drainage easements within LEXFORD PARK PHASE 1 shall be the responsibility of the Property Owners Association. No easement shall be used for grading, fill, or other obstructions, including fences, either temporary or permanent, that may cause a blockage of flow or an adverse effect on the drainage easement. The easement shall be used for the conveyance of storm water and/or drainage easements shown. Certain antennas such as, but not limited to, satellite antennas, shall be installed in a manner to meet the requirements specified above.

- DENOTES P.O.C. #3 BAR WCAP
- STAMPED .384 1464' UNLESS OTHERWISE NOTED
- DENOTES SET #3 BAR WCAP
- STAMPED .384 1464' UNLESS OTHERWISE NOTED
- SHOWN UNLESS OTHERWISE NOTED

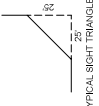

TOTAL NUMBER OF LOTS = 59
TOTAL COMMON AREA ACRES = 4.74 AC

FINAL PLAT of LEXFORD PARK PHASE 1

Johnson & Associates
1 E Sheridan Ave., Suite 200
Oklahoma City, OK 73104
(405) 595-0000
www.johnsonandassociates.com