

NOTICE IS HEREBY GIVEN, that the City Council of Oklahoma City will hold a public hearing on a proposed ordinance, establishing Special Permit No. SP-592 to operate Use Unit 8350.13 Scrap Operations in the I-3 Heavy Industrial District. A public hearing will be held by the City Council on March 11, 2025. **The City Council meets in the Council Chamber, Third Floor, Municipal Building, 200 North Walker Avenue, Oklahoma City, Oklahoma, beginning at 8:30 a.m.**

Agenda and case materials are available online at <https://okc.primegov.com/public/portal>.

Under the terms of said ordinance, the limits of and boundaries of Special Permit No. SP-592 would be extended to include the following described property:

LEGAL DESCRIPTION:

A part of the Southwest Quarter (SW/4) of Section THIRTY-FIVE (35), Township TWELVE (12) North, Range THREE (3) West of the Indian Meridian, Oklahoma County, Oklahoma, being more particularly described as follows: COMMENCING at the Southeast Corner of the Southwest Quarter of said Section 35; THENCE North 00°07'32" East, along the East line of said Southwest Quarter, a distance of 33.00 feet to the POINT OF BEGINNING; THENCE North 88°48'28" West, parallel with the South line of the Southwest Quarter of said Section 35, a distance of 324.96 feet; THENCE North 00°07'32" East, parallel with the East line of said Southwest Quarter, a distance of 897.73 feet to the Northeast Corner of the tract of land described in WARRANTY DEED recorded in Book 4,802, Page 156 of the Oklahoma County Clerk's Office; THENCE North 88°48'28" West, parallel with the South line of the Southwest Quarter of said Section 35 and along the North line of the tract of land described in said WARRANTY DEED recorded in Book 4,802, Page 156, a distance of 710.46 feet to the East Right of Way line of Lottie Avenue; THENCE North 00°12'32" East, along the East Right-of-Way line of Lottie Avenue, a distance of 288.61 feet; THENCE North 53°22'32" East a distance of 31.52 feet to a point of curvature; THENCE Northeasterly along a curve to the right having a radius of 686.27 feet (said curve subtended by a chord bearing North 69°28'33" East a distance of 403.56 feet) and an arc distance of 409.63 feet to a point of intersection with a tangent curve; THENCE North 86°34'32" East a distance of 633.13 feet to a point on the East line of the Southwest Quarter of said Section 35; THENCE South 00°07'32" West, along the East line of said Southwest Quarter of said Section 35, a distance of 1,406.00 feet to the POINT OR PLACE OF BEGINNING.

AND A tract of land being a part of the South Half (S/2) of the Southwest Quarter (SW/4) of Section Thirty-five (35), Township Twelve (12) North, Range Three (3) West of the Indian Meridian, Oklahoma County, Oklahoma, more particularly described as follows: Commencing at a point 324.64 feet West of the Southeast corner of the Southwest Quarter (SW/4) of said Section 35; Thence North 01°04'00" West a distance of 33.02 feet to the Point or Place of Beginning; Thence North a distance of 353.00 feet; Thence West a distance of 555.00 feet; Thence South a distance of 353.00 feet; Thence East a distance of 555.00 feet to the Point or Place of Beginning.

Any person having any interest in the proposed Special Permit may appear before the City Council in the **COUNCIL CHAMBER** on the above date set for hearing and show cause why the proposed Special Permit should or should not be carried out in accordance with said ordinance. Any person may make a written protest by filing the same with the Office of the City Clerk, Second Floor, 200 North Walker Avenue, Oklahoma City, Oklahoma 73102.

Dated this 11th day of February 2025.

SEAL

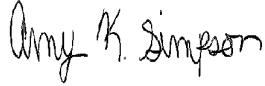
Amy K. Simpson, City Clerk



NOTICE OF REQUEST FOR SPECIAL PERMIT

CASE NUMBER: SP-592

PROPOSED SPECIAL PERMIT USE UNIT: 8350.13 Scrap Operations in the I-3 Heavy Industrial District

LOCATION OF PROPERTY: 1315 East Reno Avenue

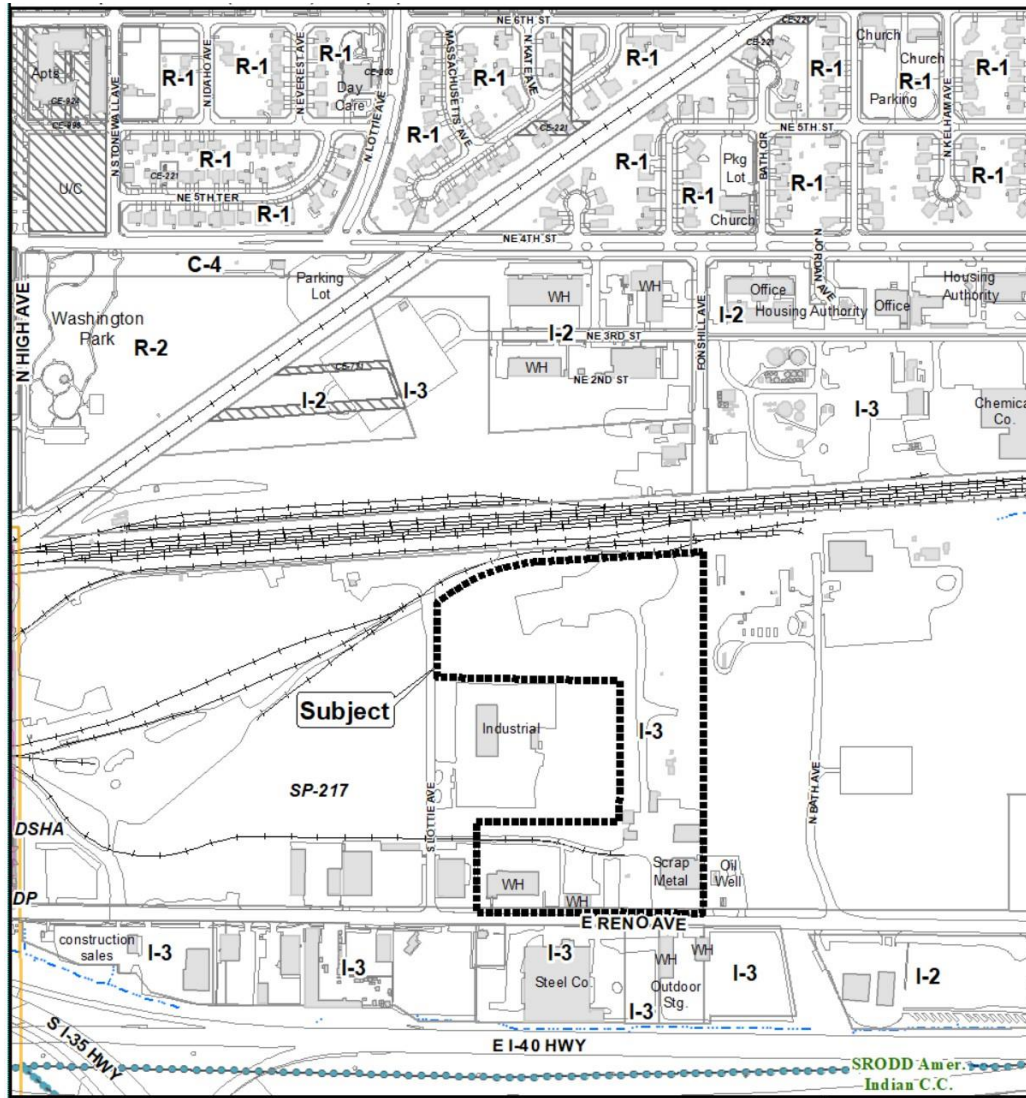

BRIEF DESCRIPTION OF PROPOSED SPECIAL PERMIT:

The purpose of this request is to allow Scrap Operations.

Should you have any questions or concerns regarding this application please call:

The City of Oklahoma City

Planning Department

420 West Main Street, Suite 910

Oklahoma City, Oklahoma 73102

(405) 297-2623

(405) 297-2495

(405) 297-2289

subdivisionandzoning@okc.gov

FOR PUBLICATION ONLY

CASE NUMBER: SP-592

LOCATION: 1315 East Reno Avenue

NOTICE IS HEREBY GIVEN, that the City Council of Oklahoma City will hold a public hearing on a proposed ordinance, establishing Special Permit No. SP-592 to operate Use Unit 8350.13 Scrap Operations in the I-3 Heavy Industrial District. A public hearing will be held by the City Council on March 11, 2025. **The City Council meets in the Council Chamber, Third Floor, Municipal Building, 200 North Walker Avenue, Oklahoma City, Oklahoma beginning at 8:30 a.m.**

Agenda and case materials are available online at <https://okc.primegov.com/public/portal>.

Under the terms of said ordinance, the limits of and boundaries of Special Permit No. SP-592 would be extended to include the following described property:

LEGAL DESCRIPTION:

A part of the Southwest Quarter (SW/4) of Section THIRTY-FIVE (35), Township TWELVE (12) North, Range THREE (3) West of the Indian Meridian, Oklahoma County, Oklahoma, being more particularly described as follows: COMMENCING at the Southeast Corner of the Southwest Quarter of said Section 35; THENCE North 00°07'32" East, along the East line of said Southwest Quarter, a distance of 33.00 feet to the POINT OF BEGINNING; THENCE North 88°48'28" West, parallel with the South line of the Southwest Quarter of said Section 35, a distance of 324.96 feet; THENCE North 00°07'32" East, parallel with the East line of said Southwest Quarter, a distance of 897.73 feet to the Northeast Corner of the tract of land described in WARRANTY DEED recorded in Book 4,802, Page 156 of the Oklahoma County Clerk's Office; THENCE North 88°48'28" West, parallel with the South line of the Southwest Quarter of said Section 35 and along the North line of the tract of land described in said WARRANTY DEED recorded in Book 4,802, Page 156, a distance of 710.46 feet to the East Right of Way line of Lottie Avenue; THENCE North 00°12'32" East, along the East Right-of-Way line of Lottie Avenue, a distance of 288.61 feet; THENCE North 53°22'32" East a distance of 31.52 feet to a point of curvature; THENCE Northeasterly along a curve to the right having a radius of 686.27 feet (said curve subtended by a chord bearing North 69°28'33" East a distance of 403.56 feet) and an arc distance of 409.63 feet to a point of intersection with a tangent curve; THENCE North 86°34'32" East a distance of 633.13 feet to a point on the East line of the Southwest Quarter of said Section 35; THENCE South 00°07'32" West, along the East line of said Southwest Quarter of said Section 35, a distance of 1,406.00 feet to the POINT OR PLACE OF BEGINNING.

AND A tract of land being a part of the South Half (S/2) of the Southwest Quarter (SW/4) of Section Thirty-five (35), Township Twelve (12) North, Range Three (3) West of the Indian Meridian, Oklahoma County, Oklahoma, more particularly described as follows: Commencing at a point 324.64 feet West of the Southeast corner of the Southwest Quarter (SW/4) of said Section 35; Thence North 01°04'00" West a distance of 33.02 feet to the Point or Place of Beginning; Thence North a distance of 353.00 feet; Thence West a distance of 555.00 feet; Thence South a distance of 353.00 feet; Thence East a distance of 555.00 feet to the Point or Place of Beginning.

BRIEF DESCRIPTION OF PROPOSED SPECIAL PERMIT:

The purpose of this request is to allow Scrap Operations.

Any person having any interest in the proposed Special Permit may appear before the City Council in the **COUNCIL CHAMBER** on the above date set for hearing and show cause why the proposed Special Permit should or should not be carried out in accordance with said ordinance. Any person may make written protest by filing the same with the Office of the City Clerk, Second Floor, 200 North Walker Avenue, Oklahoma City, Oklahoma 73102.

For further information call (405) 297-2623.

Dated this 11th day of February 2025.

SEAL

Amy K. Simpson, City Clerk

